

S.S. N<sup>o</sup> 333. (S.P. AUSTIN & SON)

ELECTRIC LIGHTING CIRCUITS.  
BRIDGES & UPPER DECK.

SCALE 8" = 1 FOOT.

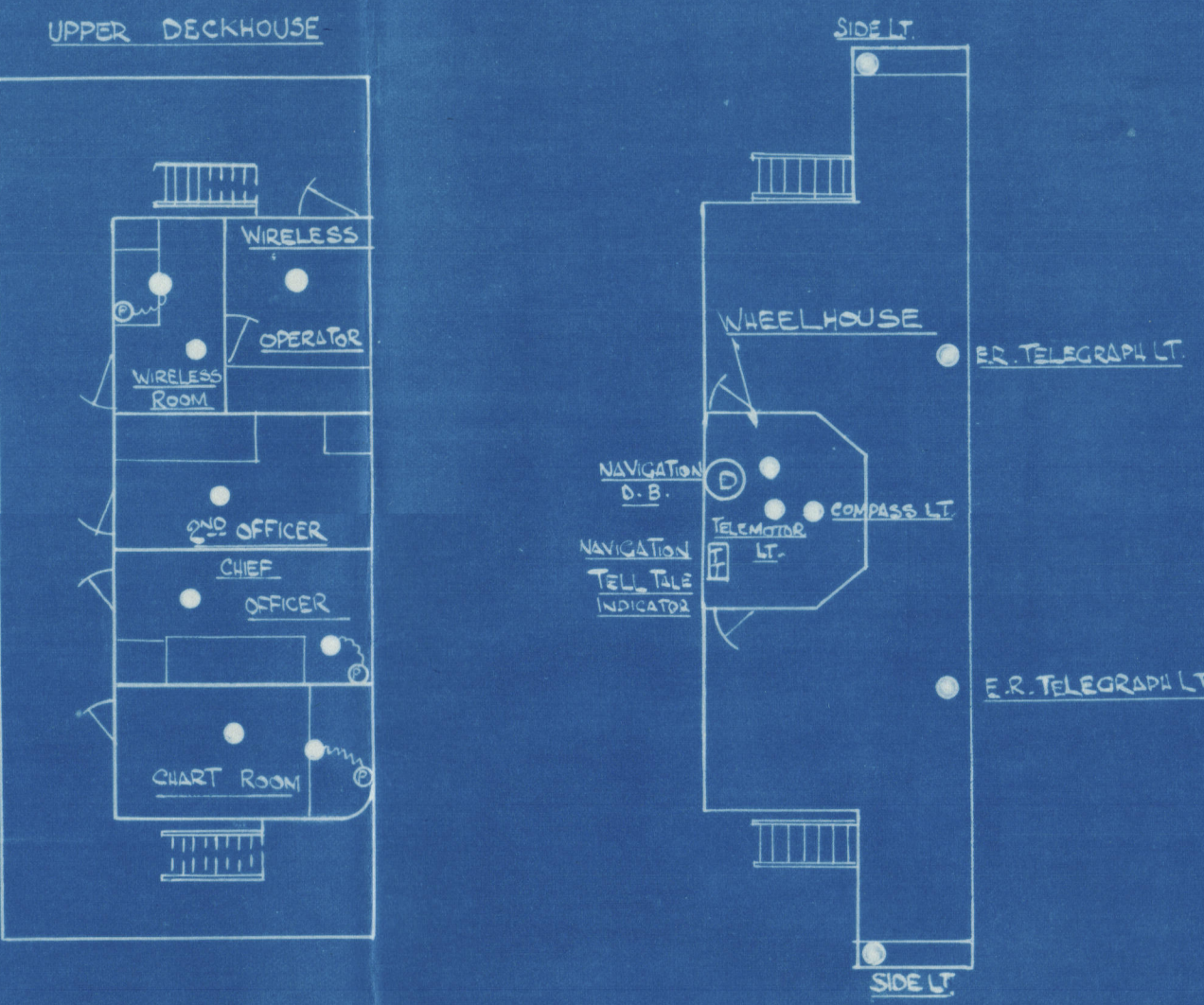
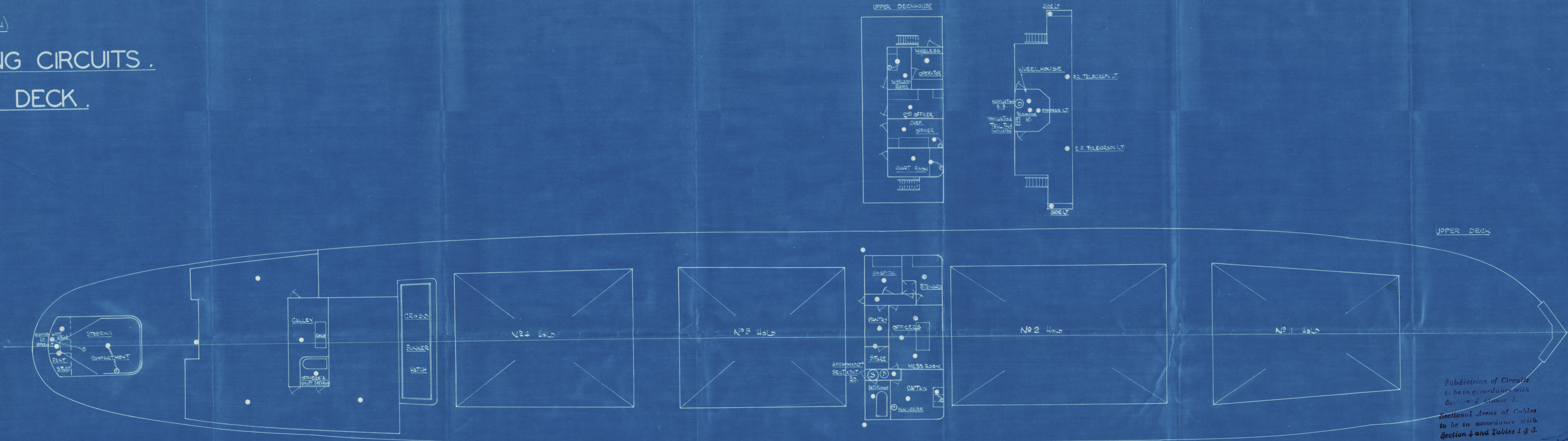

UPPER DECK

Subdivision of Circuits  
to be in accordance with  
Section 7 Clause 1.  
Sectional Areas of Cables  
to be in accordance with  
Section 4 and Tables 1 & 2.

ENGINEERS ACCOMMODATION AFT.

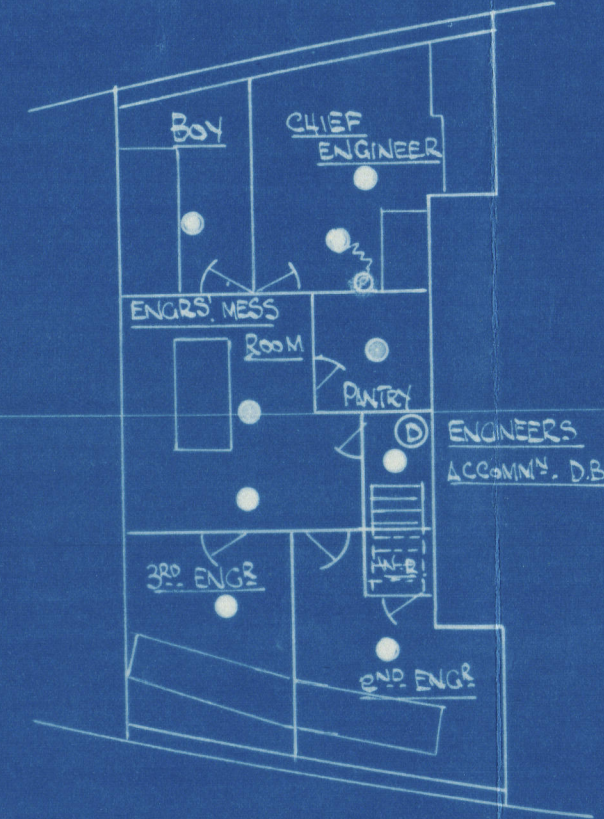

FORECASTLE

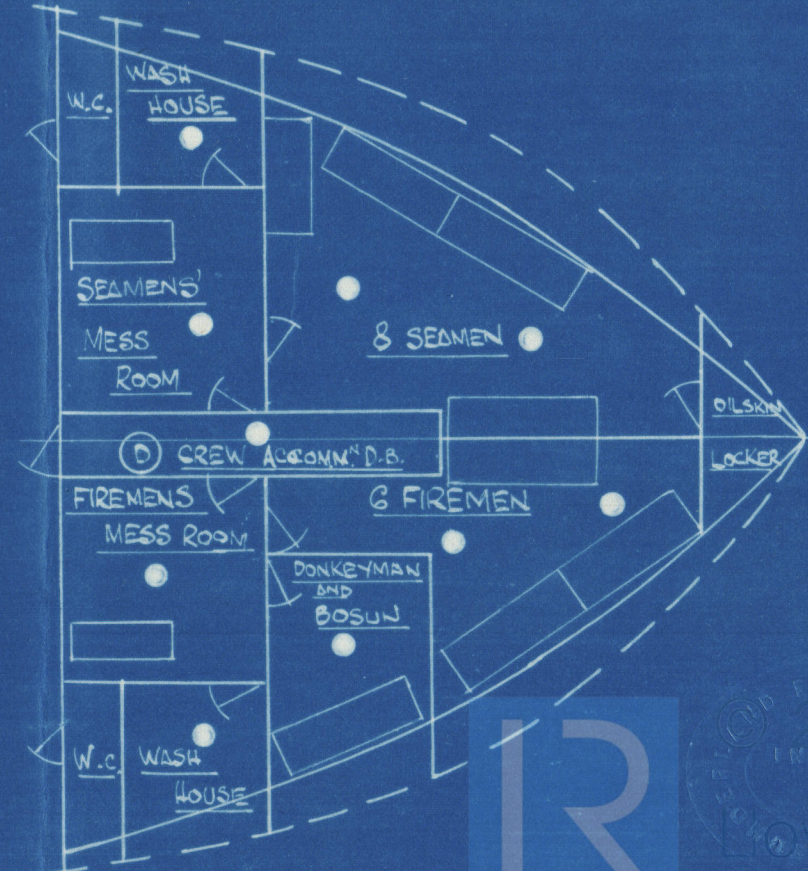

26 JUN 1934



S. S. No 333 (S. P. Austin & Sons)

Electric Lighting

Bridges Upper BK

"Wychwood"

79

14



© 2019

Lloyd's Register  
Foundation

W 99-0060