

Do all the Frames extend to the top Height in the ~~upper~~ deck? *Yes*
 Do all the Frames extend to the top height in the Poop? *✓* Bridge House? *✓* Forecastle? *yes*
 To what height do the Reverse Frames extend? *Bulk angle frames*
 Has the Poop an efficient Iron Bulkhead at the fore end? *✓*
 Give particulars of the means for closing the openings in Bulkhead *Complete*
 Is the Poop connected with the Bridge House? *✓* Has the Bridge House an efficient Bulkhead at the fore end? *Complete*
 Give particulars of the means for closing the openings in Bulkhead *Steel Deck*
 What is the thickness of the Bridge Front plating? *✓* and Coaming plate? *✓*
 Give scantlings and spacing of the Stiffeners *✓*
 Are bracket plates fitted at each end of the Stiffeners? *✓* Are hor'l. brackets fitted connecting Bridge Bulk'd. with Bulwarks? *✓*
 Has the Bridge House an efficient Iron Bulkhead at the after end? *✓*
 How are the openings closed? *✓*
 Is the Forecastle at least as high as the main or top-gallant rail? *7-6* Has the Forecastle an efficient Iron or Wood Bulk'd. at after end? *Steel*
 Are the Engine and Boiler openings covered by a Bridge, Poop, or enclosed by a Strong Iron or Steel Deckhouse? *Casings*
 If the openings are not so protected are the exposed parts of the Casings efficiently constructed? *Yes*
 Give thickness of plating; scantlings and spacing of Stiffeners *44 x 40 coaming, 38 x 26 plating, 3 1/2 x 3 x 40 angle 38" apart.*
 What is the height of the exposed Casings? *7-0* Are suitable means provided for closing all openings in them in bad weather? *Steel doors 2-3 and 3-0 m*
 Are the Weather Deck Hatchways efficiently constructed and at least equal to the requirements of Section 28 of the Rules for 1904-5? Give particulars below: *Yes*

Position and Size.	No. 1. 29-9 x 20-0		No. 2. 29-9 x 20-0		No. 3. 14-10 1/2 x 13-0		No. 4. 34-0 x 20-0		No. 5. 29-9 x 20-0	
Item.	Ship.	Rule.	Ship.	Rule.	Ship.	Rule.	Ship.	Rule.	Ship.	Rule.
COAMING.										
Height above top of DECK	2-8	2-0	2-8	2-0	2-8	2-0	2-8	2-0	2-8	2-0
Thickness { Sides.....	48	48	48	48	44	44	50	50	48	48
{ Ends.....	44	44	44	44	44	44	44	44	44	44
SCUTTLING PLATES OR WEB PLATES.										
Number.....	5	5	5	5	2	2	6	6	5	5
Section and Scantlings.....	18 x 36	18 x 36	18 x 36	18 x 36	16 x 36	16 x 36	18 x 36	18 x 36	18 x 36	18 x 36
Material.....	4 x 3 = 44		4 x 3 = 44		4 x 3 = 44		4 x 3 = 44		4 x 3 = 44	
* FORE AND AFTERS.										
Number.....										
Section and Scantlings.....										
Material.....										
HATCHES Thickness.....	2 1/2	2 1/2	2 1/2	2 1/2	2 1/2	2 1/2	2 1/2	2 1/2	2 1/2	2 1/2
Remarks.....	Bulk angle fitted on side and coaming 1-8 above deck with stops									

* When the Fore and Afters are of wood the depth should be stated from the underside of the hatches.

(If the sill of the lowest side scuttle will be less than 6 inches above the Indian Summer Load Line if assigned under the tables, state vertical distance from top of deck at side amidships to lower edge of lowest side scuttle.)

Displacement = 12143 tons
 Ton per inch = 42.23

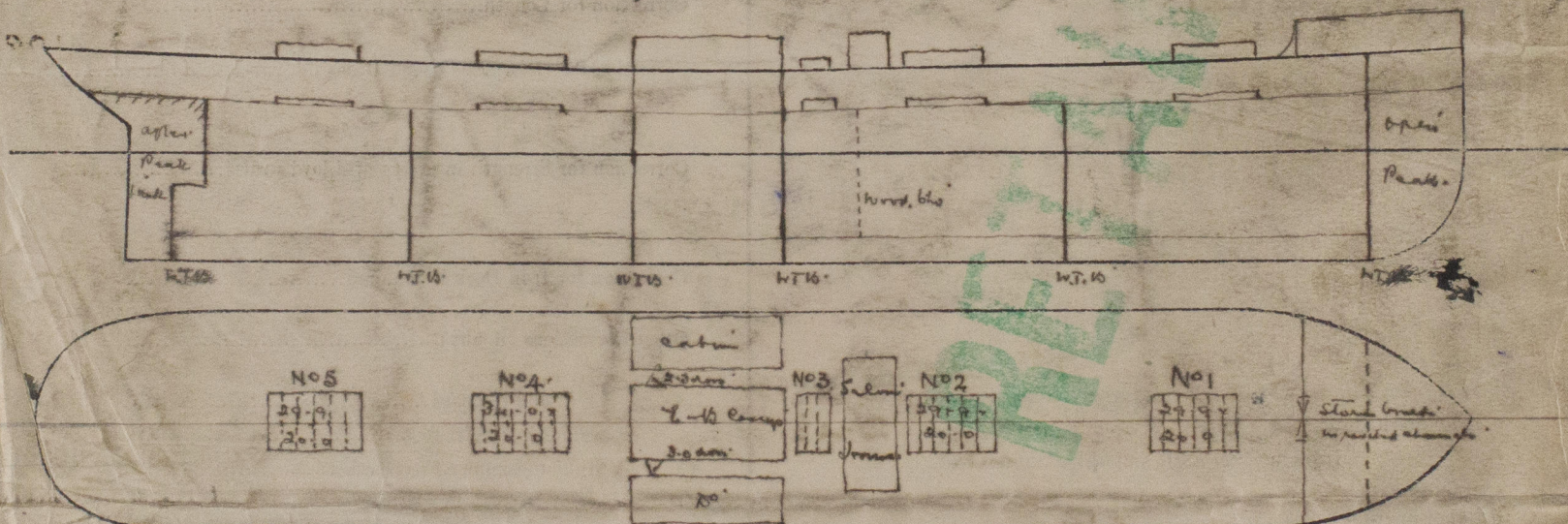

Show hereon line of Floors or Tank Top with position of any Breaks in same; also height of Peak Tank tops, &c., &c.

State any special features in the construction of the Vessel *Complete Shell Deck. Bulk angle frames. alternate to Shell Deck. Cellular double bottom throughout. No ceiling fitted on Tank Tops. Scupper led to bilge from upper deck. This is a sister vessel to S.S. "Benares". Builder. No. 1. Order. No. 10791. The approved plans (5) are furnished herewith for reference.*

Builder: Messrs. J. & C. D. No. 2.

Address: *I shall be glad if you will have assignment as early as possible.*

Fee £ 8 : 8 :

Received by me

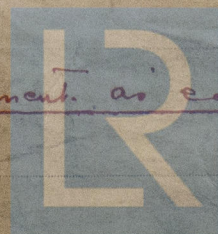

© 2019

Lloyd's Register Foundation