

Lloyd's Register of Shipping.

SURVEYS FOR FREEBOARD.

(CONDITIONS OF ASSIGNMENT.)

SEP 18 1937

Ship's Name **"JAMES STOVE" (ex "BRALANTA")**Port of Survey **WELLINGTON, N.Z.**Official Number **1011**Surveyor's Signature *George D. Lippett*Nationality and Port of Registry **NORWEGIAN OSLO**Date of Survey **10th & 11th AUGUST 1937**

Disposition and dimensions of superstructures, trunks, deckhouses and machinery casings to be inserted in the diagrams and tabular statement:—

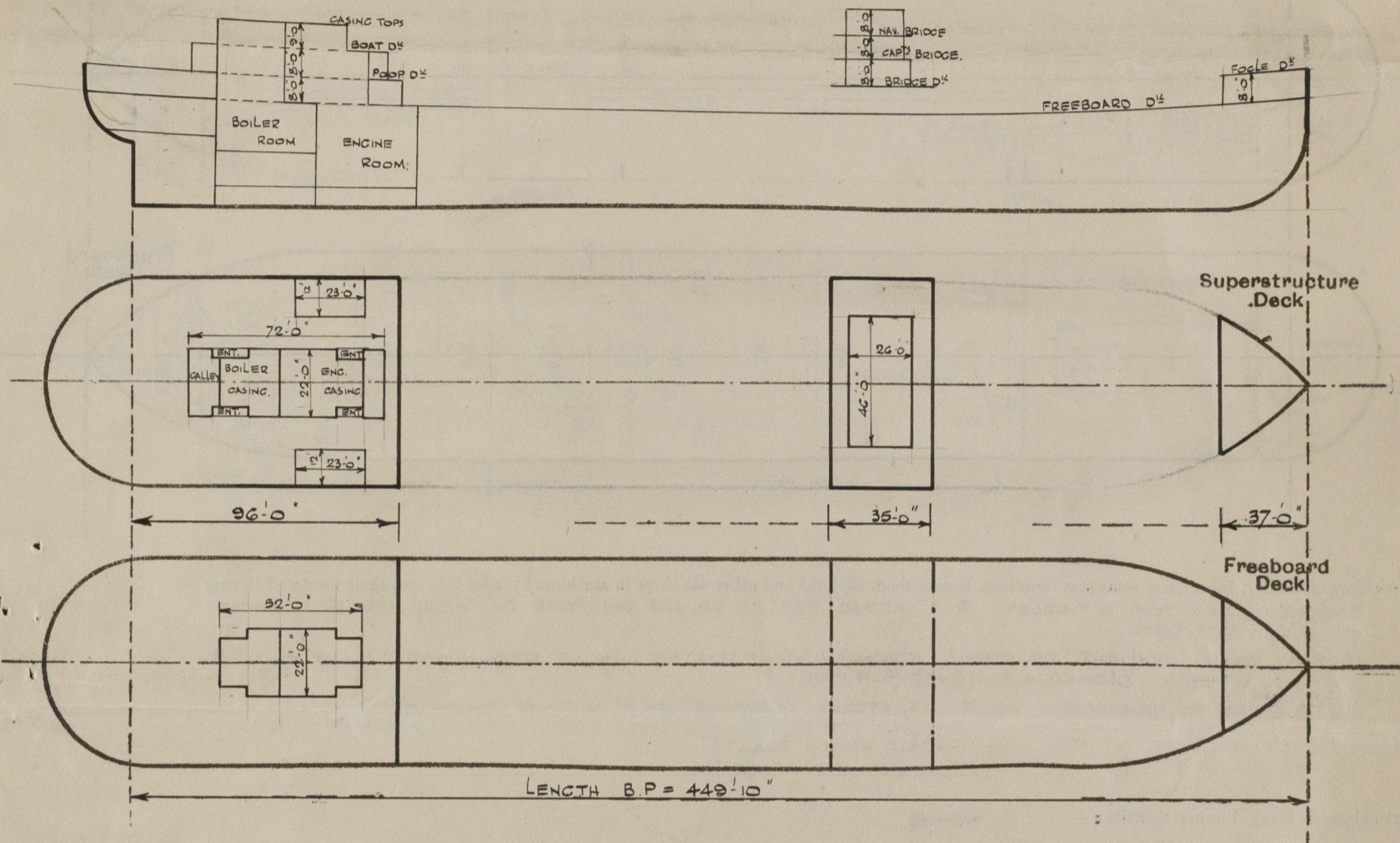

Particulars of Superstructures, Trunks, Casings, Deckhouses.

	Coaming	Plating	Stiffeners	Spacing	End Attachments of Stiffeners	Size of Openings	Height of Sills	Height of Casings
Poop Bulkhead	8" x 3" x 3/8" L	3/8"	10" x 3 1/2" x 1/2" BA	28 1/2"	6" x 8" x 1/2" LUGS TOP & BOTTOM	—	—	8'-0"
Raised Quarter Deck Bulkhead ...	—	—	—	—	—	—	—	—
Bridge, After Bulkhead	—	—	—	—	—	—	—	—
Bridge, Forward Bulkhead	—	—	—	—	—	—	—	—
Forecastle Bulkhead	6" x 2 1/2" x 3/8" L	1/4"	3 1/2" x 2 1/2" x 3/8" L	30"	NONE	2 @ 5'-0" x 2'-0" 1 @ 5'-0" x 2'-7"	18"	8'-0"
Trunk, Aft	—	—	—	—	—	—	—	—
Trunk, Forward	—	—	—	—	—	—	—	—
Exposed Machinery Casings on Freeboard or Raised Quarter Decks ...	—	—	—	—	—	—	—	—
Exposed Machinery Casings on Superstructure Decks	NOT OBTAINABLE	3/8"	5" x 2 1/2" x 3/8" L	32"	NONE AT TOP	4 @ 5'-2" x 2'-5" 2 @ 5'-2" x 2'-5"	12" 16"	8'-0"
Machinery Casings within Superstructures not fitted with Class I Closing Appliances	NOT OBTAINABLE	3/8"	5" x 2 1/2" x 3/8" L	32"	LUGGED TO FREEBOARD DECK BEAMS AT BOTTOM	2 @ 5'-8" x 2'-6"	9"	8'-0"
Deckhouses on Flush Deck Ships ...	—	—	—	—	—	—	—	—

Particulars of Closing Appliances (state if capable of being manipulated from both sides).

Poop Bulkhead	NONE. NO OPENINGS
Raised Quarter Deck Bulkhead ...	NOT FITTED
Bridge, After Bulkhead	" " OPEN
Bridge, Forward Bulkhead	" " OPEN
Forecastle Bulkhead	3 STEEL HINGED DOORS, 2 CLIPS AT TOP & 2 AT BOTTOM. OPERABLE FROM BOTH SIDES.
Exposed Machinery Casings on Freeboard or Raised Quarter Decks ...	—
Exposed Machinery Casings on Superstructure Decks	HINGED STEEL DOORS TO ENGINE ROOM. OPERABLE FROM BOTH SIDES.
Machinery Casings within Superstructures not fitted with Class I Closing Appliances	HINGED STEEL DOORS TO ENGINE ROOM. OPERABLE FROM BOTH SIDES.
Deckhouses on Flush Deck Ships ...	—

PARTICULARS OF PROTECTION TO OPENINGS, ETC.

The following diagrams should be used to indicate the positions of cargo and coaling hatchways, gangway, cargo and coaling ports, ventilators, companionways, etc., which would affect the seaworthiness of the ship.

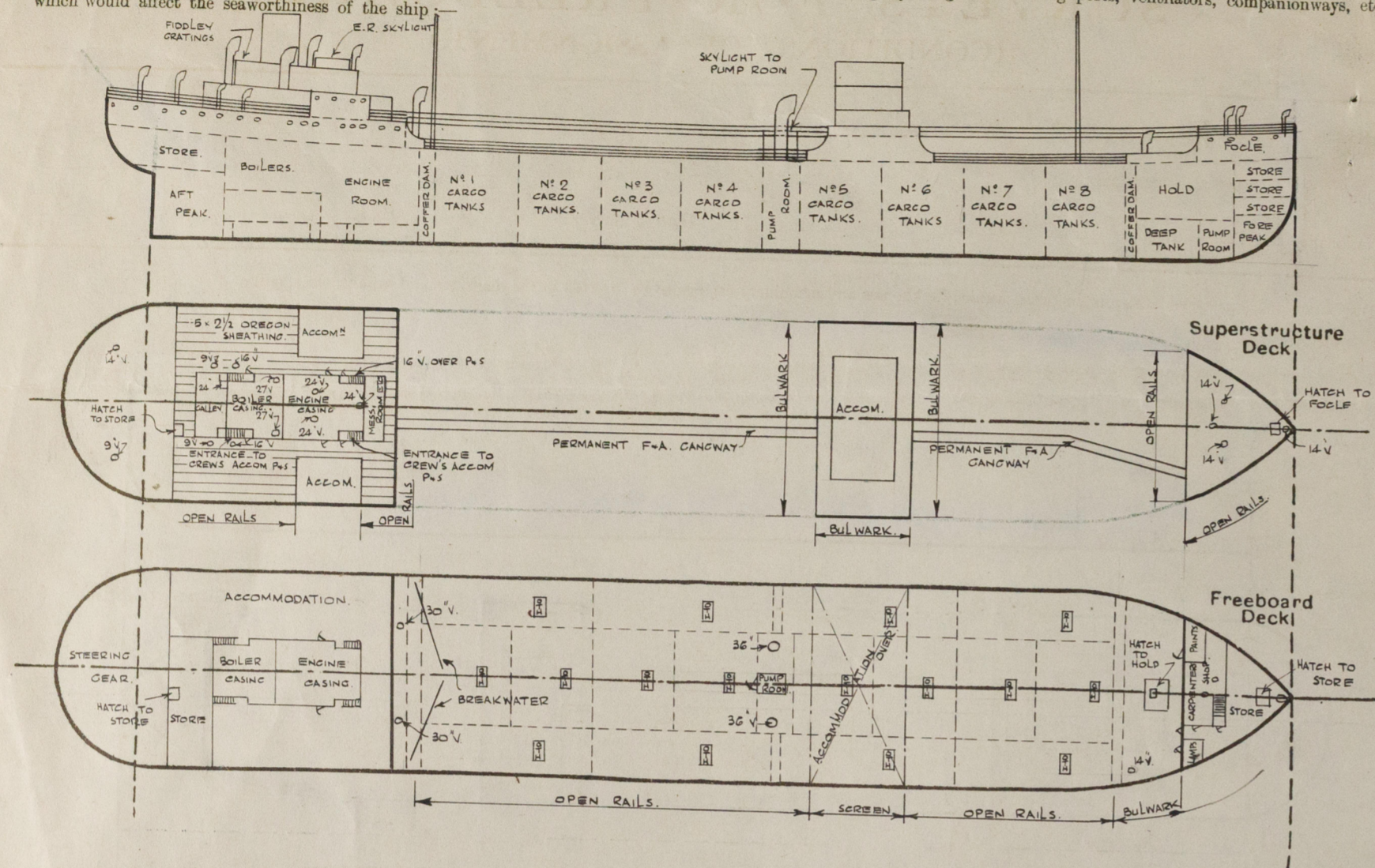

Particulars of fiddley, funnel and ventilator coamings, engine room skylight and other openings in machinery casing tops and their means of closing :-
 ENGINE CASING TOP & FIDDELY 9'-0" ABOVE TOP OF HOUSES ON POOP DECK, WHICH ARE 8'-0" ABOVE
 ENGINE ROOM SKYLIGHT OF STEEL STRONGLY CONSTRUCTED HAVING STEEL HINGED FLAPS CAPABLE
 OF BEING CLOSED & FASTENED FROM INSIDE.
 VENTILATORS TO MACHINERY SPACE OF STRONG CONSTRUCTION & IN GOOD CONDITION.
 FIDDELY CRATINGS FITTED WITH HINGED STORM COVERS.

Particulars of Flush Bunker Scuttles :- NONE

Particulars of Companionways :- ENTRANCE TO MIDSHIP PUMP ROOM STRONGLY CONSTRUCTED OF STEEL HAVING 3"x3 1/2" L COAMING,
 7/8" PLATING, WITH A 5'-0" x 2'-0" OPENING ON AFTER SIDE, SILL 18" HIGH & CLOSED WITH A STEEL HINGED W.T. DOOR OPERABLE
 FROM BOTH SIDES. STEEL SKYLIGHT OVER CAPABLE OF BEING CLOSED & FASTENED FROM INSIDE.
 ENTRANCES TO CREW'S ACCOM. RECESSED IN ENGINE CASING ON POOP DECK & FITTED WITH
 HINGED TEAK DOORS 2" THICK. SIZE OF OPENINGS 5'-2" x 2'-9", 4 OFF. SILL 12". DOORS OPERABLE FROM
 BOTH SIDES.

Particulars of Ventilators in exposed positions on freeboard and superstructure decks :-

ON FORECASTLE:- 4 VENTS @ 14" DIA. COAMING ABOUT 36" HIGH.
 ON FREEBOARD DECK:- 2 " " 16 " " 36 " "
 2 " " 30 " " ABOVE TOP OF HOUSES ON POOP.
 ON POOP DECK:- 2 DERRICK POST VENTS 36" DIA. COAMING ABOUT 20'-0" ABOVE DECK.
 2 VENTS @ 16" DIA. COAMING ABOUT 30" HIGH.
 2 " " 14 " " 30 " "
 3 " " 9 " " 30 " "
 ON TOP OF CASINGS:- 1 " " 24 " " COAMINGS OVER 10'-0" ABOVE CASING TOPS
 2 " " 16 " " 30 " "
 2 " " 27 " " 30 " "

ALL VENTS IN EXPOSED POSITIONS HAVE PLUGS & COVERS.
 ALL VENTS OF STRONG CONSTRUCTION IN GOOD CONDITION.

Particulars of Air Pipes in exposed positions on freeboard, raised quarter, or superstructure decks :-

ON FORECASTLE:- 3 AIR PIPES 5" DIA. HEIGHT TO UNDERSIDE OF OPENING 35"
 " POOP:- 3 " " 5 " " 35 " "
 2 " " 4 1/2 " " 35 " "
 4 " " 4 " " 34 " "
 4 " " 2 1/2 " " 35 " "
 ON FREEBOARD DECK:- 4 " " 7 " " 33 " "
 2 " " 5 " " 35 " "
 3 " " 4 1/2 " " 35 " "
 2 " " 3 3/4 " " 33 " "
 2 " " 3 3/4 " " 32 " "
 2 " " 3 3/4 " " 32 " "

ALL AIR PIPES ARE FITTED WITH PLUGS AND COVERS.

Particulars of Gangway Cargo and Coaling Ports :- NONE FITTED.

Particulars of Scuppers and Sanitary Discharge Pipes :-

FROM ACCOMMODATION AMIDSHIPS:- PORT SIDE - 1'-4" & 1'-2 1/2"
 STAR " - 1'-2 1/2"

FROM ACCOMMODATION AFT:- PORT SIDE 2'-4" & 3'-2"
 STAR " 1'-4" & 2'-2"

ALL DISCHARGES FITTED WITH EFFICIENT STORM VALVES.

Particulars of Side Scuttles :-

SIDE SCUTTLES IN FORECASTLE:- 10" DIA. CLEAR GLASS IN STRONGLY CONSTRUCTED FRAMES.
 " POOP:- 12 " " " " " "
 " ON POOP FRONT:- 12 " " " " " "
 " " 2'-15" " " " " " "

ALL SIDE SCUTTLES FITTED WITH HINGED DEADLIGHTS.
 NO SIDE SCUTTLES FITTED BELOW FREEBOARD DECK.

Vertical distance of Sill of lowest Side Scuttle above top of keel APPROXIMATELY 39'-0"

Particulars of Guard Rails :-

RAILS ON FORECASTLE:- 3'-3" HIGH, TOP RAIL 1 1/8" DIA, 2ND & 3RD RAILS 7/8" DIA, STANCHIONS 1 3/4" DIA AT
 BOTTOM TAPERING TO 1/2" DIA AT TOP & SPACED 3'-11"
 RAILS ON POOP & FREEBOARD DECK:- 3'-6" HIGH, TOP RAIL 1 1/8" DIA, 2ND & 3RD RAILS 7/8" DIA, STANCHIONS 1 3/4" DIA AT
 BOTTOM TAPERING TO 1/2" DIA AT TOP & SPACED ON POOP 4'-3" ON FREEBOARD DECK 5'-6"
 BULKWARKS AROUND ACCOM. AMIDSHIPS:- 3'-6" HIGH, 1/4" PLATING, SURMOUNTED BY 5" x 2 1/2" TEAK WOOD RAIL. STIFFENERS
 3/2 x 3/2 x 1/4 L & SPACED 4'-6"

Particulars of Gangways, Lifelines, etc. :- A STRONGLY CONSTRUCTED STEEL PERMANENT GANGWAY FITTED FROM
 FORECASTLE TO HOUSES AMIDSHIPS, & FROM HOUSES AMIDSHIPS TO POOP DECK BUILT UP OF
 2- 3 1/2" x 6" x 3/8" Ls AND 3/8" CHECKERED STEEL PLATE HAVING RAILS 3'-3" HIGH, TOP & MIDDLE RAIL 1" DIA.
 STANCHIONS 1 1/2" DIA AT BOTTOM TAPERING TO 1 1/4" AT TOP & SPACED 5'-6" GANGWAY WELL SUPPORTED
 BY ANGLE IRON PILLARS FASTENED TO FREEBOARD DECK.

Particulars of Freeing Arrangements.

	Length of Bulwark	Height of Bulwark	Size of Freeing Ports	Number each side	Area each side	Rule area each side
After Well ...						
Forward Well ...						

State position of each freeing port ... (After Well :-

(F. and A. position and height above deck edge) (Forward Well :-

State whether the freeing ports are fitted with shutters, bars, or rails and give particulars of such :-

Additional area where sheer is less than standard.

BULWARKS NOT FITTED EXCEPT FOR 29'-3" ABAFT FORECASTLE.

PARTICULARS OF PROTECTION TO OPENINGS, ETC.

HATCHWAYS ON FREEBOARD AND SUPERSTRUCTURE DECKS.									
Description of Hatchway	ON POOLE HEAD.	INSIDE POOLE.	HATCH TO HOLD.	HATCHES TO CARGO TANKS.	HATCH ON POOP.	HATCH IN POOP.			
Dimensions of Hatchway	24" x 25"	3'8" x 4'1"	9'10" x 6'8"	5'6" x 2'4"	3'4" x 2'9"	3'4" x 2'9"			
COAMINGS	Height above Deck ... 25" Thickness { Sides ... 7/16" { Ends ... Stiffeners ... Brackets, Stays ...	9' x 3" B.A. 3/8"	32" 3/8"	34 1/2" 3/8"	21" 5/16"	3' x 3' 3/8" L			
HATCH BEAMS	Number ... Spacing ... Scantling and Sketch ...	NONE	NONE	NONE	NONE	NONE			
FORE AND AFTERS	Number ... Spacing ... Unsupported Lengths ... Scantling* and Sketch ...	NONE	NONE	NONE	NONE	NONE			
HATCH COVERS	Material ... Thickness ... How fitted ... Bearing Surface ...	HINGED STEEL W.T. COVER 2 PINCHING SCREWS.	HINGED STEEL W.T. COVER 2 PINCHING SCREWS AT ENDS & SIDES	HINGED STEEL W.T. COVER 8 PINCHING SCREWS AT ENDS & 5 AT SIDES MANHOLE IN COVER 30" x 36" WITH STEEL W.T. COVER. 2 DOGS AT ENDS & 1 AT SIDES.	HINGED STEEL W.T. COVERS 5 PINCHING SCREWS AT ENDS & 2 AT SIDES	WOOD 2" F & A 3"	WOOD 2" THWART 3"		
Spacing of Cleats					SIDES 24" ENDS 30"				
Number of Tarpaulins									

*Are wood fore and afters steel shod at all bearing surfaces? NONE FITTED
 Are battens and wedges efficient and in good condition? YES
 Are tarpaulins in good condition and in accordance with rule requirements? YES
 Are lashings provided in accordance with rule requirements? —

Particulars of any special features:— PARTICULARS OF BULWARKS ABAFT FORECASTLE:— HEIGHT 3'6", 1/4" PLATING WITH TOP RAIL 7 3/32 x 3 x 39 B.A. STIFFENERS 6 x 3 x 35 L SPACED 4'8". STAYS 7/8 x 3/16 x 2 3/4 x .43 [SECURED AT TOP TO TOP RAIL BY 5/8 x 3 x 35 LUG. & AT BOTTOM BY 6 x 6 x 5 1/2 LUG ON EVERY STIFFENER. TOTAL LENGTH OF BULWARKS = 29'3"

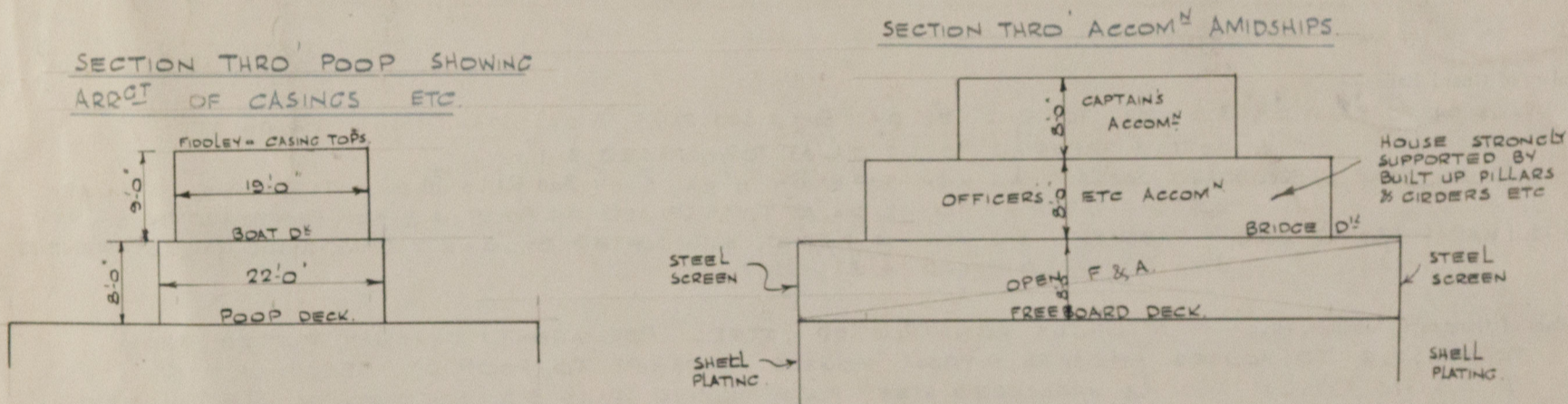

Endorsement at first survey and at surveys for renewal of Certificate:—

The fittings and appliances are in accordance with the particulars shown on this form (or as now modified) and are in good condition.