

6-9-14

N^o 64 & 65
15.1.15

ELEVATION & DECK PLAN OF STEAMER ARCH PRINCIPAL OF CONSTRUCTION (PATENT)

PROPRIETORS MESSRS SWAN, HUNTER & WIGHAM RICHARDSON LTD & MAXWELL BALLARD.

MOULDED DIMENSIONS 287'-0" x 40'-6" x 19'-1" WITH 6'-0" ARCH.

TO CLASS

SCALE $\frac{1}{8}$ " = 1 FOOT.

17.12.14
23.2.15
15.3.15
30.6.15
11.6.15

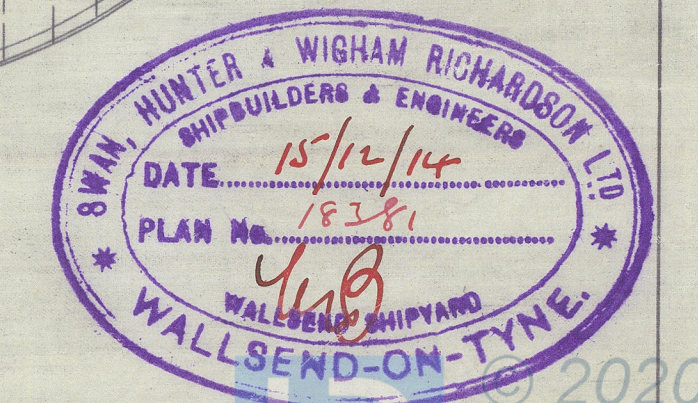
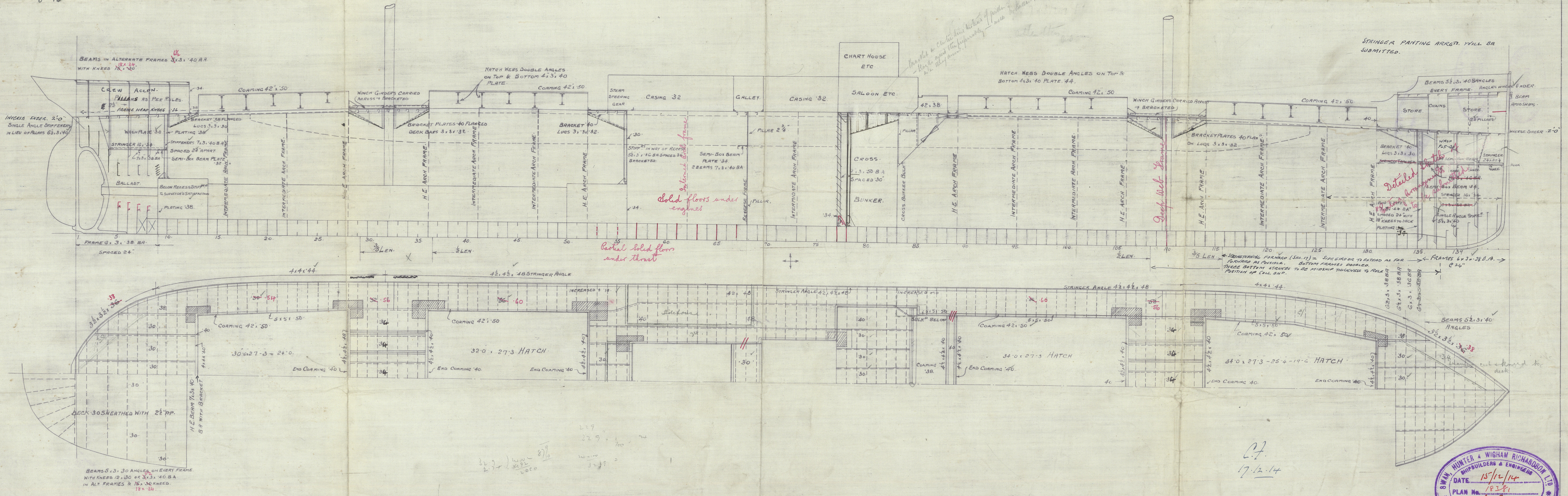

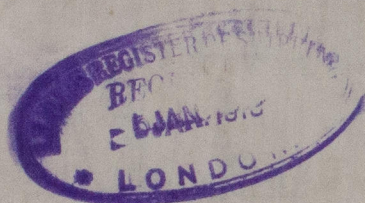
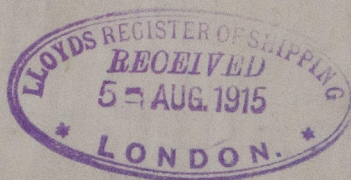
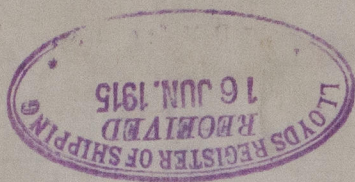

The North of Ireland S.S. Co.

Nos 64 and 65

Profile and Deck Plan.

S.S. ALTO. (8064)

BEL. 7639.



S.S. ARNEWOOD.

BEL. 7721



© 2020

Lloyd's Register
Foundation

W980-0127