

30.1.01
16.8.01 (P 653)

BEAMS MARKED A.	BULBS $11 \times \frac{11}{20}$	DOUBLE ANGLES $6 \times 4 \times \frac{9}{20}$
B.	$9 \frac{1}{2} \times \frac{9}{20}$	$3 \frac{1}{2} \times 3 \frac{1}{2} \times \frac{8}{20}$
C.	$12 \times \frac{11}{20}$	$6 \times 4 \times \frac{9}{20}$
D.	$10 \frac{1}{2} \times \frac{10}{20}$	$3 \frac{1}{2} \times 3 \frac{1}{2} \times \frac{8}{20}$

S.S. N^o 644. Also N^o 653, app. 16/8/01

PROFILE

SCALE $\frac{1}{8}$ " = ONE FOOT.

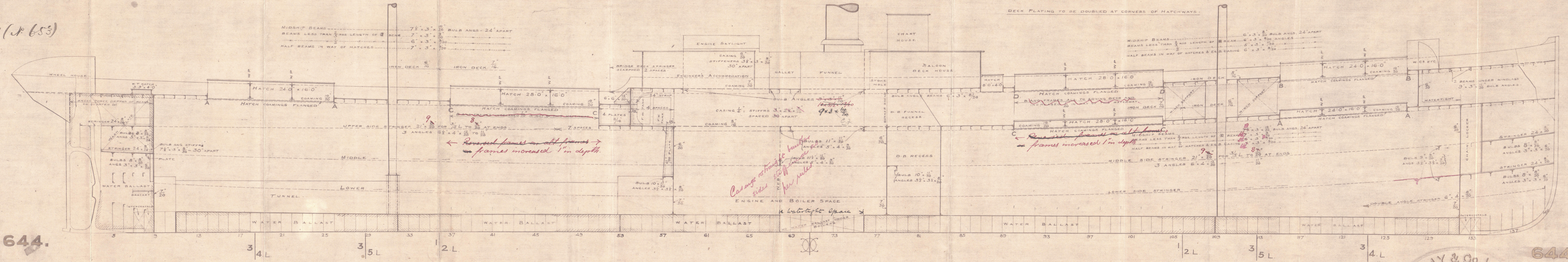

644.

644.



© 2020

Lloyd's Register
Foundation
W924-0020

H.L.
30/1/01

W924-0020

Wray Ho.

No. 644 ~~653~~

Profile

no. 644 "Dalarne"

Hpl. Report no. 11650

Bumaire



W924-0020

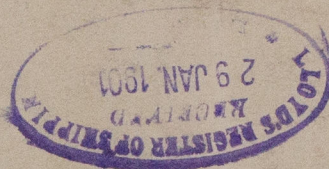
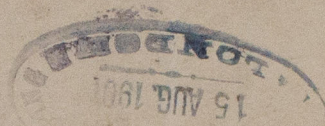

RETAIN



© 2020

Lloyd's Register
Foundation