

17. 10. 06

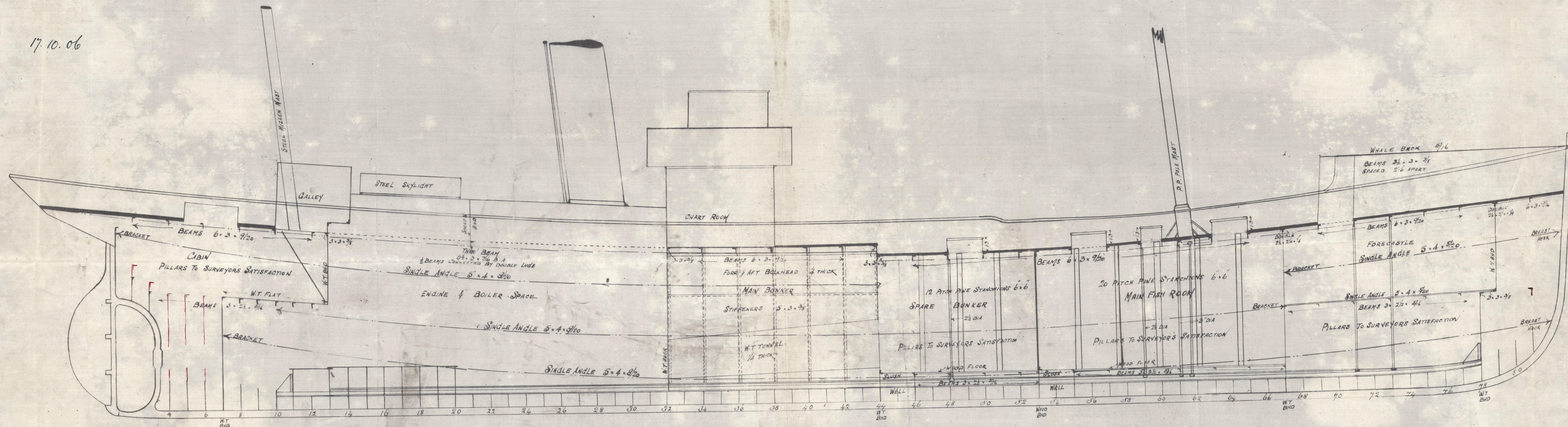

— BEAM ARRANGEMENT —

PILLARS TO SURVEYORS SATISFACTION
SCALE $\frac{1}{4}$ = 1 FOOT

— № 135 —

COOK. WELTON & GEMMELL LTH
SHIPBUILDERS
BEVERLEY
DATE SUB. 12.10.06
APP.

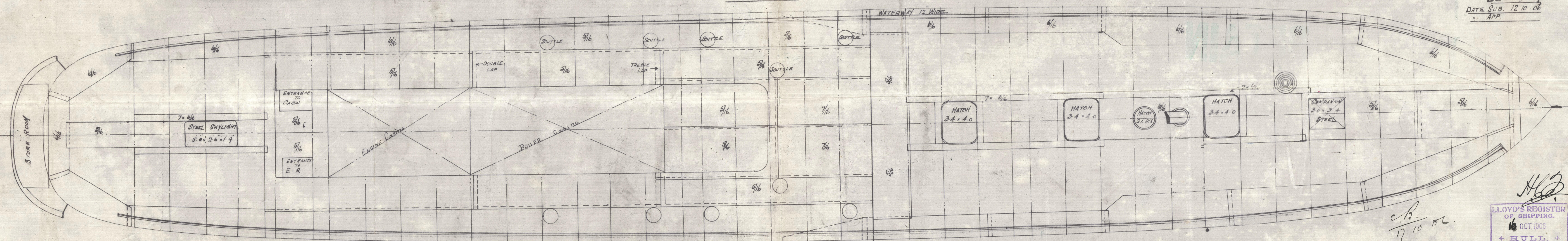

C.B.
17.10.02

W895-0165

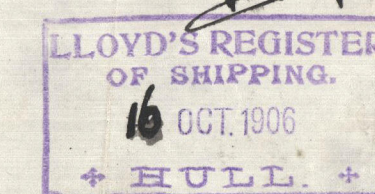

Profile

Cook, Welton & Gemmell's

no 135

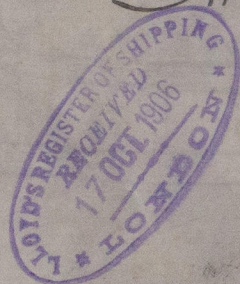

s/s "Fraser"
Hull Report no-19235

RETAIN

W895-0165



© 2020

Lloyd's Register
Foundation