

29.4.12

MIDSHIP SECTION.

Scale 1/2" = one foot

12.5
18.5
12.5
50.5

In way of Bridge
66
Quadruple overlaps

62
Triple overlaps

62
Triple overlaps

Steel Deck 40
Butts Double overlaps

Skidstrake 66 x 94 for L.H. to
H at ends Doubled full width
for 20-0 each end of Bridge

(47 x 80 rule)
11 x 72 for L.H. to H

62 to 44
+ 04 from 85 B 114 to 85 B 114
(66 to 44)

62 to 44
+ 04 from 85 B 114 to 85 B 114
(66 to 44)

62 to 44
+ 04 from 85 B 114 to 85 B 114
(66 to 44)

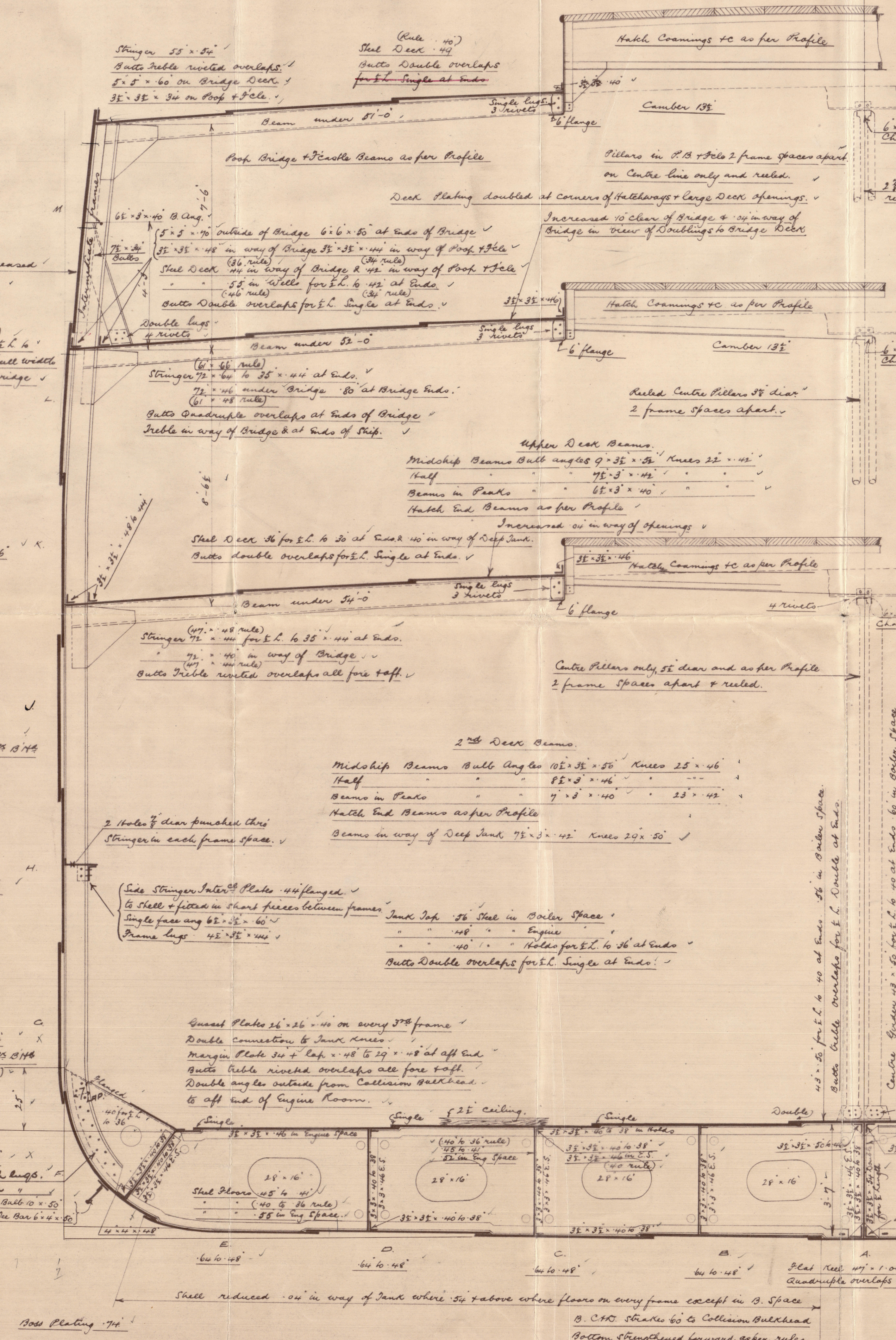

Dimensions	Builders	Lloyds
Length between Perps	400.0	399.85
Breadth extreme	53.6	53.19
Depth moulded	29.75	29.62
Depth frames K ₂	82.91	82.91
Channels Longitudinal K ₂	33.51	33.51
7 1/2" in way of Long Bridge	10.77	
Upper Deck	13.49	
Class 100 A 1 Lloyd's		

399.85 x 82.91	33.51	56	Roof Deck
29.75 x 7.5 x 75	167	34	Bridge
257.83 x x x	1450	29	5th
49.27 x x x	245	80	5th
89.00 x x x	333	75	Houses + Casing
Equip K ₂	35368	74	

2 Power Anchors (Stockless)	63 1/2	Cuts
1 Steam (Ec Stock)	17 1/2	
1 Hedge	7 1/2	
270 Butchins of Stud Chain Cable	2 1/2	
90	1 1/2	or 2 1/2 Steel Wire
120	14	or 5"
90		
90		

2 Power Anchors (Stockless) 63 1/2 Cuts
1 Steam (Ec Stock) 17 1/2
1 Hedge 7 1/2
270 Butchins of Stud Chain Cable 2 1/2
90 1 1/2 or 2 1/2 Steel Wire
120 14 or 5"
90
90

9 1/2 x 3 1/2 x 55 from K₂ 7 1/2 to 46 inclusive in line of Web Frame

Gull Angle Frames without Reverse Bars 35 x 35 x 50 spaced 26" apart
in Peaks 7 x 35 x 44 24

Alternate frames upper to Bridge Decks 4 x 35 x 36 Angles

Bulkhead Frames 5 x 5 x 50 Angles 3 1/2 x 3 1/2 Bars 35 x 35 x 50 Single and as per Profile

Tank Frames on Solid Floors 35 x 35 x 40 to 38 Double forward of 35 L. to Collision Bulkhead from Margin to Margin

Tank Frames on Braced Floors 35 x 35 x 48 to 46

Double Reverse Bars in Engine Space from Centre line to Boiler next outside of Engine Seating

Double on Floor under Boiler Beams

45 J B 4 1/2 36 x 35 x 36 in Iron Deck Stiffs = 9 1/2 x 3 1/2 x 50 Bull Angs (Midship 3 1/2 40) 30 apart and as per Profile

B Head Stiffs in Iron Deck 4 x 3 x 36 Angles spaced 30 apart

Stem 15 x 2 1/2 x 95 x 2 1/2 at Head Rudder Post 9 x 7 1/2 Propeller Post 10 x 7 1/2 Triple riveted below Base

Sole Piece 9 1/2 x 95 Rudder Head 10 1/2 diam Shell 8" diam Rindles 5 1/2 diam

Frame rivets thro' Shell and Plating of Bottom forward of 35 L. 5 1/2" diam apart
Thru frames and plating from Margin to upper Deck not more than 6" diam apart
in way of After Peak Tank

Floors + Cross Deck Plating

	Butt Riveting	Edge Riveting
Stems, Walls, etc. & Ends amidships	Ends	Ends
A 47 1/2 15 Quad 1 Rivets 1 1/2 6 1/2 6		
B 11 1/2 8 1/2 7 1/2 5 1/2 7 1/2 5 1/2		
C		
D		
E		
F 66 1/2		3/4 4 1/2
G	Triple 1/2	
H		
I		
K 11 1/2		
L 66 1/2		
M 87 1/2 1 Quad Rivets		

Arrangement of Bottom under Boilers.
Cross Deck Plating as previously approved.

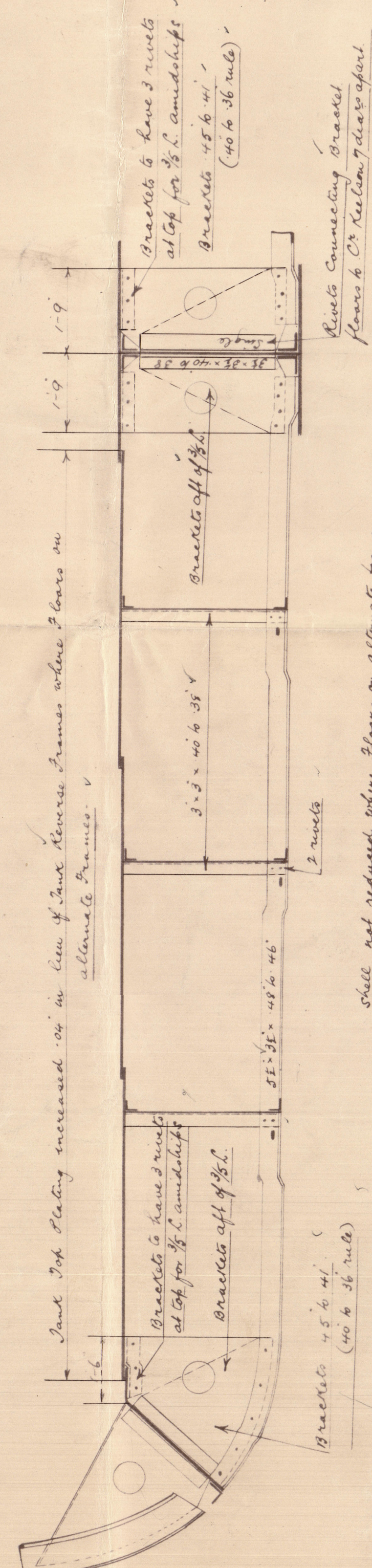
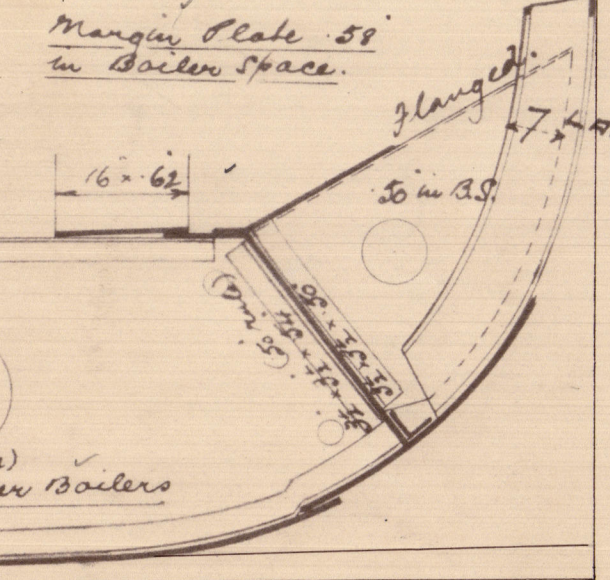

Shell not reduced where floors on alternate frames
Section in way of Intermediate Frames

311

311

Midship section

W. Gray R60.

No. 18-571

No. Arabian

THU. NOV. - 7. 1912

His Report No. 14541.

Cape Comorin

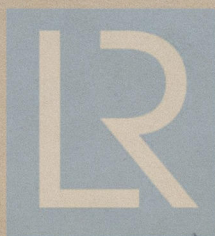
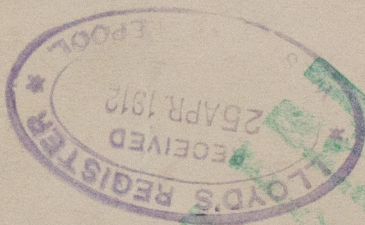
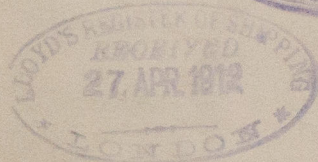

© 2020

Lloyd's Register
Foundation