

RIVETING.

DESCRIPTION	DIMS OF RIVET	PITCH CENTRE TO CENTRE	HEAD	POINT	IRON OR STEEL
STRINGER LAPS 9" TREBLE	7/8"	3 1/8"	PAN	FLUSH	IRON
" " 6 DOUBLE	7/8"	3 1/8"	"	"	"
STRINGER ANGLE TO SHELL	7/8"	4"	COUNTERSUNK	"	"
" " DECK	7/8"	4"	PAN	"	"
PLATE LAPS 2 1/2" SINGLE	5/8"	2 1/2"	"	"	"
" " 5" DOUBLE	3/4"	3"	"	"	"
LANDINGS 2 1/2" SINGLE	5/8"	2 1/2"	"	"	"
" " 2 1/2"	3/4"	3"	"	"	"
" " 3"	7/8"	3 1/2"	"	"	"
HATCHWAY ANGLE TO DECK	3/4"	3 3/8"	"	"	"
CEMENT BAR TO DECK	3/4"	3 3/8"	"	"	"
WATERWAY BAR TO DECK	3/4"	3 3/8"	"	"	"
BEAMS TO STRINGER AND PLATING UNDER WINCHES	7/8"	6"	"	"	"
30 PLATING TO BEAMS	3/4"	5 1/4"	"	"	"

T.S.S. "NIEUW AMSTERDAM."

EXTENSION OF BRIDGE DECK.

SCALE 1/4" = 1 FOOT.

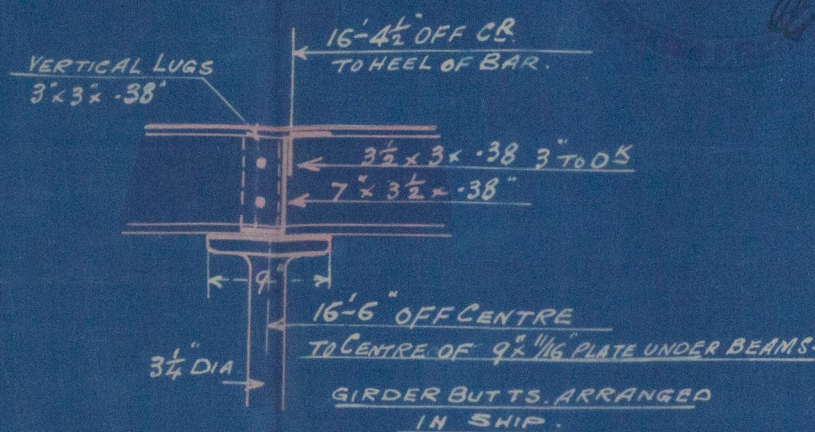

GIRDER UNDER BRIDGE DECK.

AT FORE END

GIRDER UNDER BRIDGE DECK ANGLES.

- 1. BARS. N.A. 30-6 x 7 x 3 1/2 x 38.
- 2. " " 32-0 x 3 1/2 x 3 x 38.
- 1 BAR. " 18-0 x 3 x 3 x 38.
- PLATES 4 PLATES N.A. 17-4 x 9 x 9 x 68.

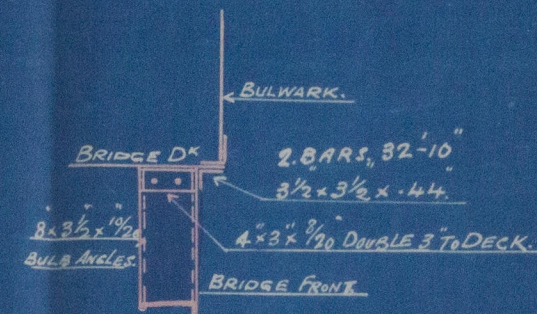

BRIDGE DECK BEAM BRACKETS.

- 2 PLATES N.A. 11-8 x 23 x 23 x 50.
- 1 " 2. 17-6 x 23 x 23 x 50.

BRIDGE DECK

- 13 NEW BEAMS TO BE FITTED AND PLATED OVER.
- GIRDERS IN SALOON TO BE EXTENDED AND ADDITIONAL STANCHIONS FITTED.
- FOUR WINCHES ON AWNING DECK TO BE LIFTED AND FITTED ON BRIDGE DECK. OLD WINCH GIRDERS TO BE USED. STEEL DECK TO BE CAULKED.
- WOOD DECK TO BE FITTED OVER EXTENSION 4 x 3 YELLOW PINE WITH TEAK MARGINS, AND CEMENT UNDER WINCHES.
- NEW HATCH COAMINGS AT BRIDGE DECK TRUNK TO BE BUILT BETWEEN AWNING & BRIDGE DECKS.
- OLD MOULDINGS, REST, IRON, CLEATS, CASTINGS, BEAMS, AND COVERS TO BE USED AT HATCH ON BRIDGE DECK.

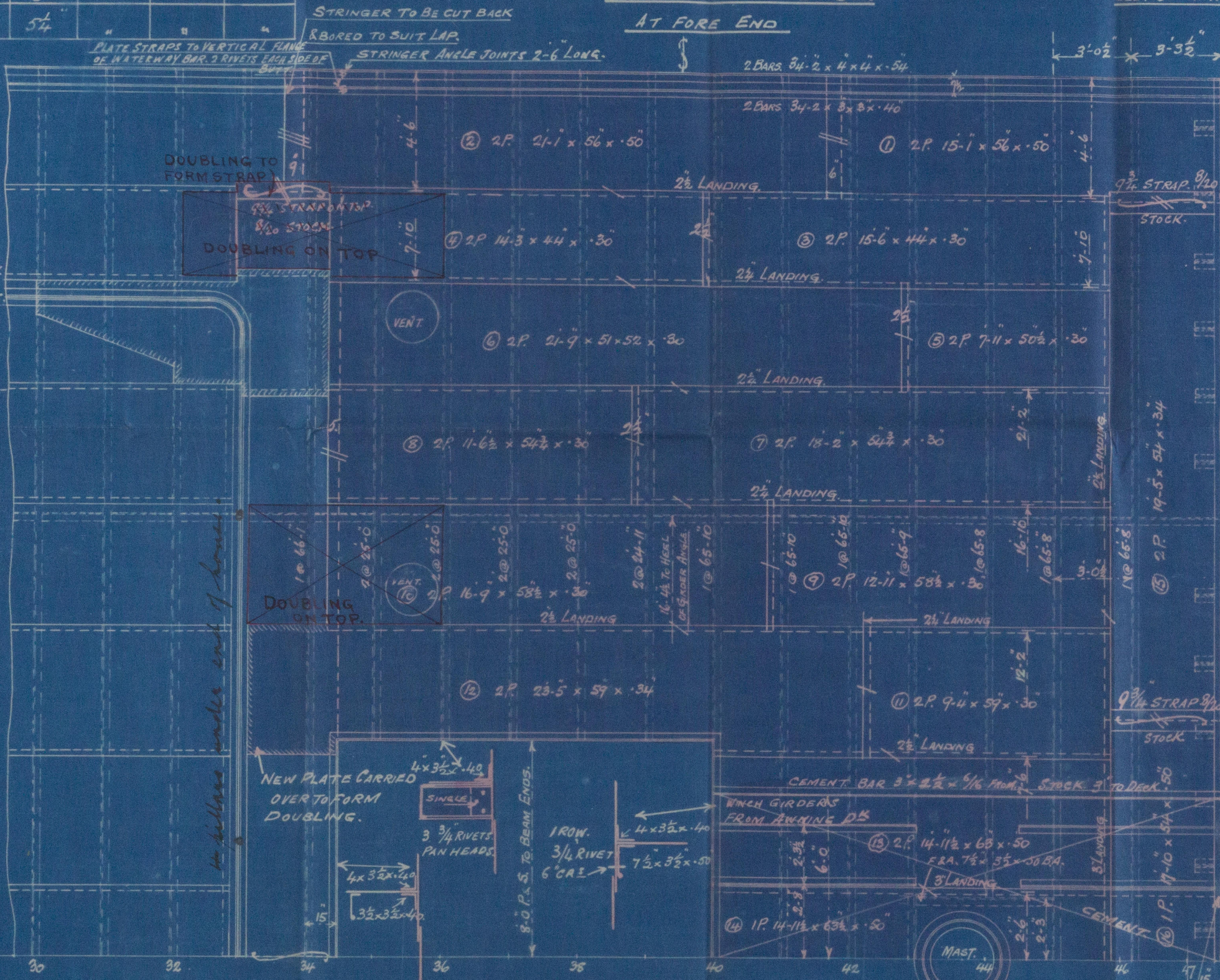

BEAM LUGS TO HATCH COAMING
1 BAR N.A. 7-0 x 4 x 4 x 40.

NEW MAST RING
TO BE FITTED
IN HALVES.

BEAMS AT MAST
CUT IN SHIP

NOTE:- OLD WINCH GIRDERS TO BE USED.
* THIS LANDING TO BE CAULKED BEFORE
WINCH GIRDER IS PUT DOWN.



St. Nieuw Amsterdam

Extension of Bridge

Bridge Deck Plan &
Section

RETAILED

RETAILED



© 2020

Lloyd's Register
Foundation

W673-0027