

# S.S. "ANNIE M. MILLER"

## PROFILE & DECK PLANS.

S.S. N° 355

SCALE  $\frac{1}{8}$ " = ONE FT.

TO CLASS \* 100 A.I. LLOYDS.

DIM. 160'2" B.P. 30'10 $\frac{1}{2}$ " BRTH MLO. 31'0" BRTH EXT. 14'0" DEPTH TO UPPER D'S. 17'6" TO QU. D'S.



CRUISER STERN  
FRAMES 24' APART  
5" x 2 $\frac{1}{2}$ " x 30 B.A.  
PLATING .31

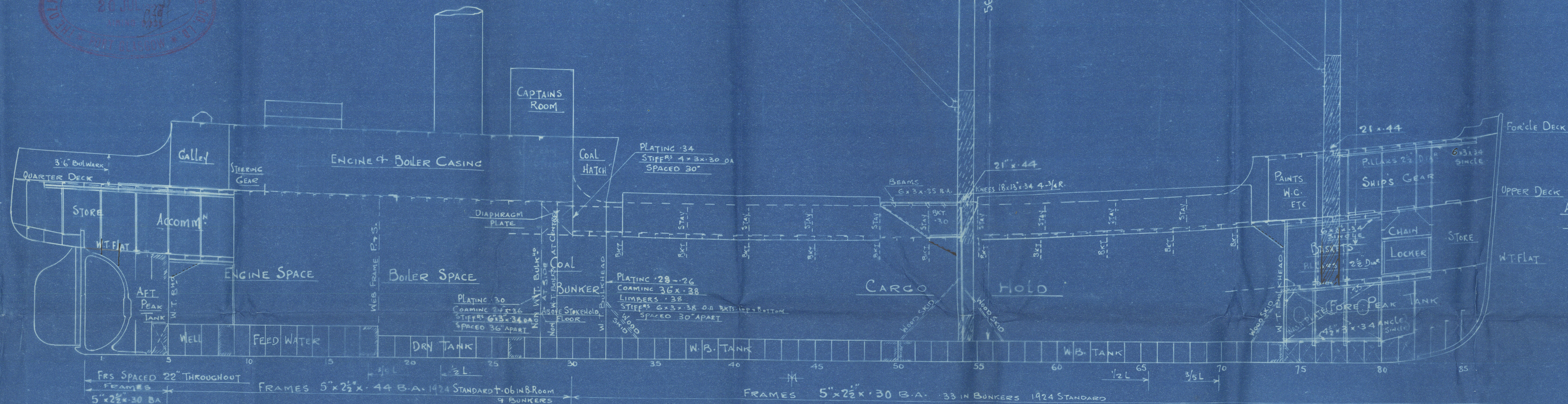

AFT PEAK & COLLISION  
BULKHEADS T.B.  
SUBMITTED

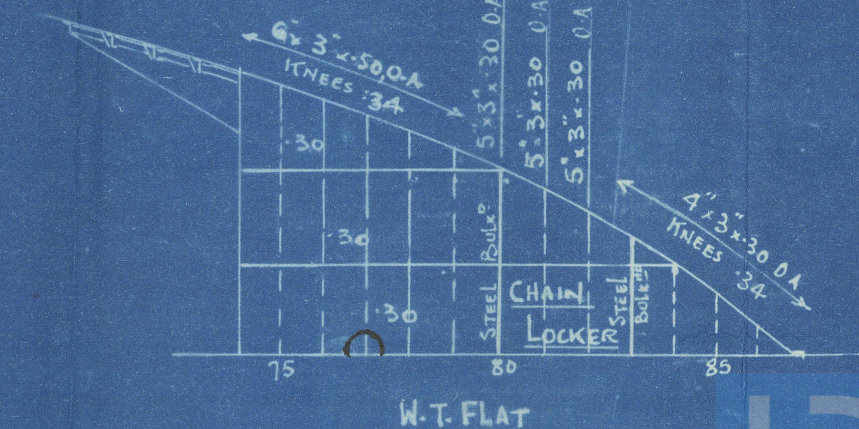
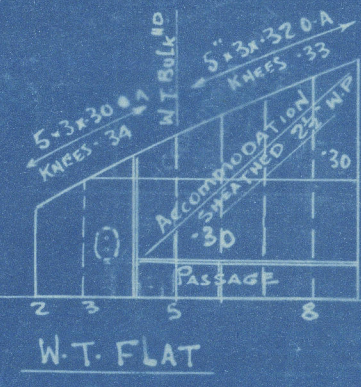
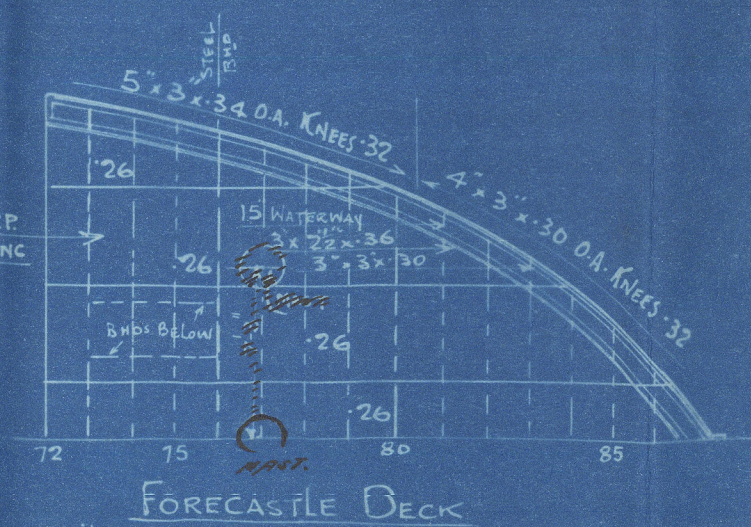
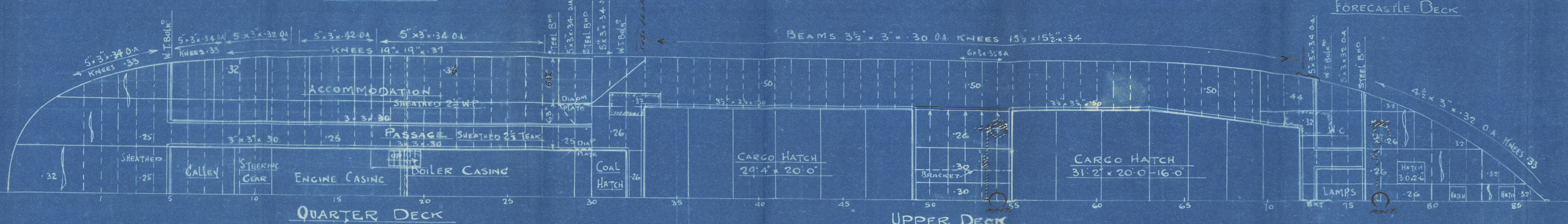
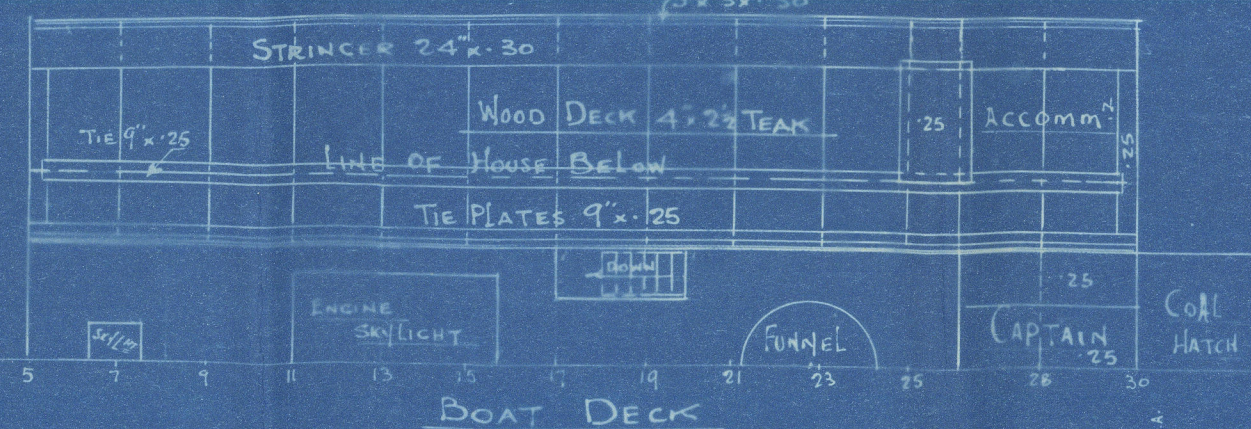



The Clyde S.B. & E.C.

S. S. ANNIE M. MILLER

N. 355.

Profile & E.C. plans  
as Built.

Gen. Rep. N. 18942

RETAIN

© 2021

Lloyd's Register  
Foundation

W638-0022