

Mr. 20. 11. 02

Steamer N°5 (En Construction aux Chantiers de France à Dunkerque) In Building to the Chantiers de France à Dunkerque

Bandière marine

Marchant à tirage Flourens
Force théorique 184.4 hp
Cimble 13
Working pressure 184.4 hp

CAILLARD & C°
INGENIEURS-CONSTRUCTEURS
HAYRE
Plan N° 2008
Exposition 725

Surfaces	1	2
330. Cibles	188.75	270.25
3. Bouteilles à feu	18.60	18.80
3. Tuyaux	11.55	12.05
Plaque à tubes A	3.50	10.50
Plaque à tubes B	2.85	8.55
Total	193.05	299.15
Long. des tubes 1.600		
Surfaces de grille	11.75	14.25
Surfaces de tubes des tubes	2.25	2.25
Surfaces de la section à la surface de grille	0.150	
Vitesse de vapeur à 180°	22.845	

Working pressure = 184.4 lb per sq in
Grating surfaces = 20.8 sq feet
Grate surfaces = 61.4 sq feet

Tube trans - Stay tube
Stay tube thickness 1/8"
Tube trans 8"
Tube stay 8"

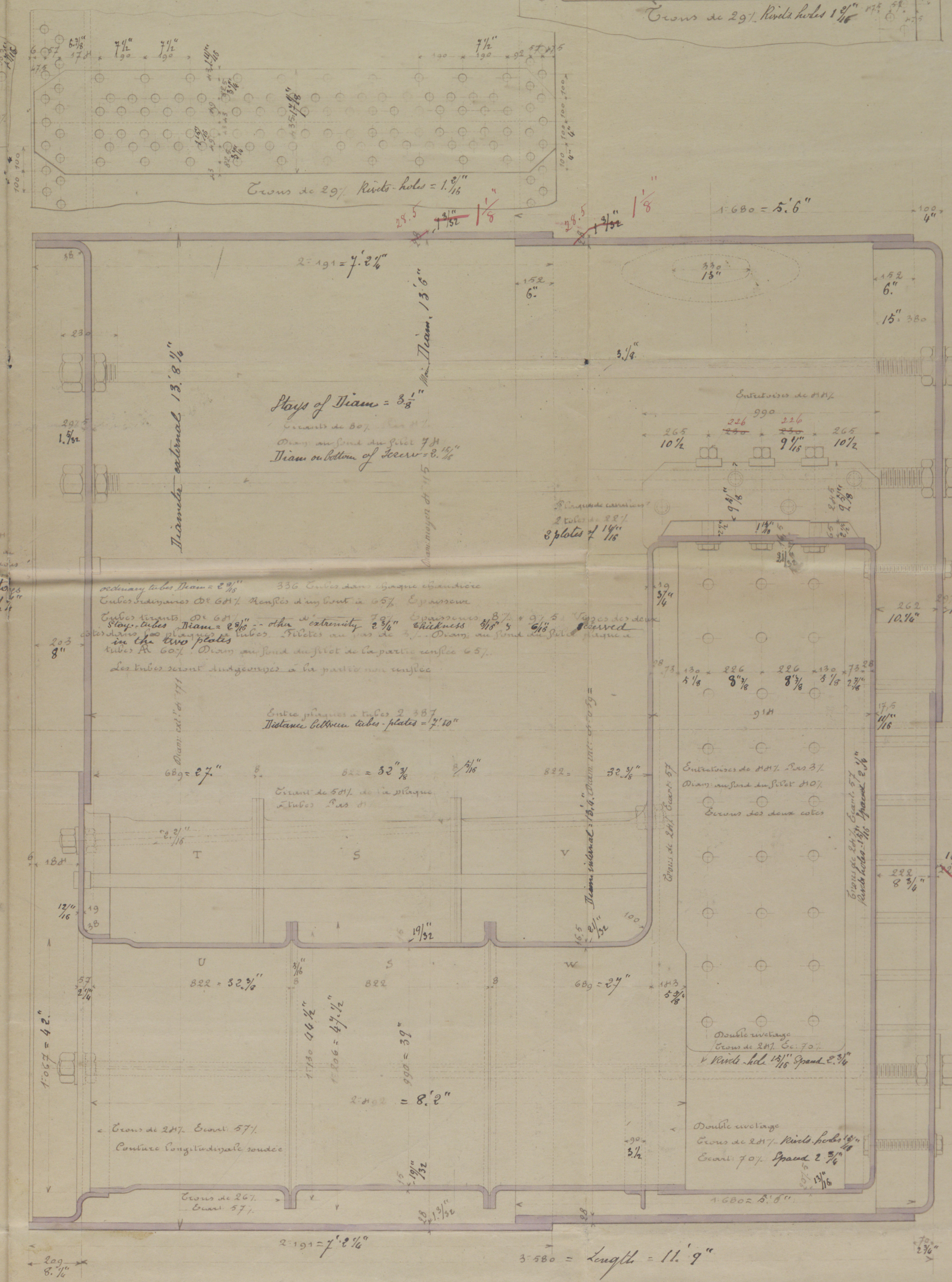
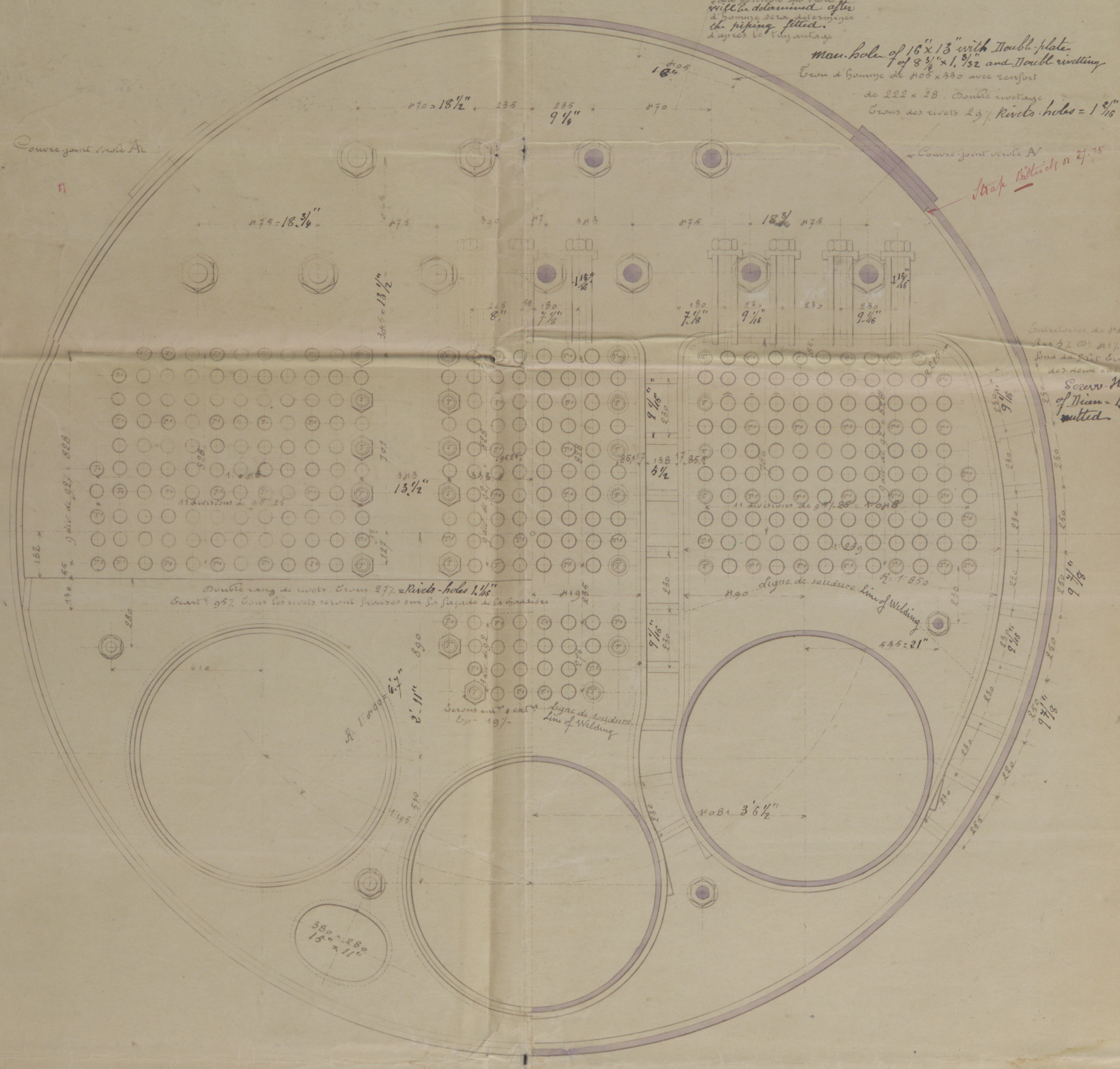
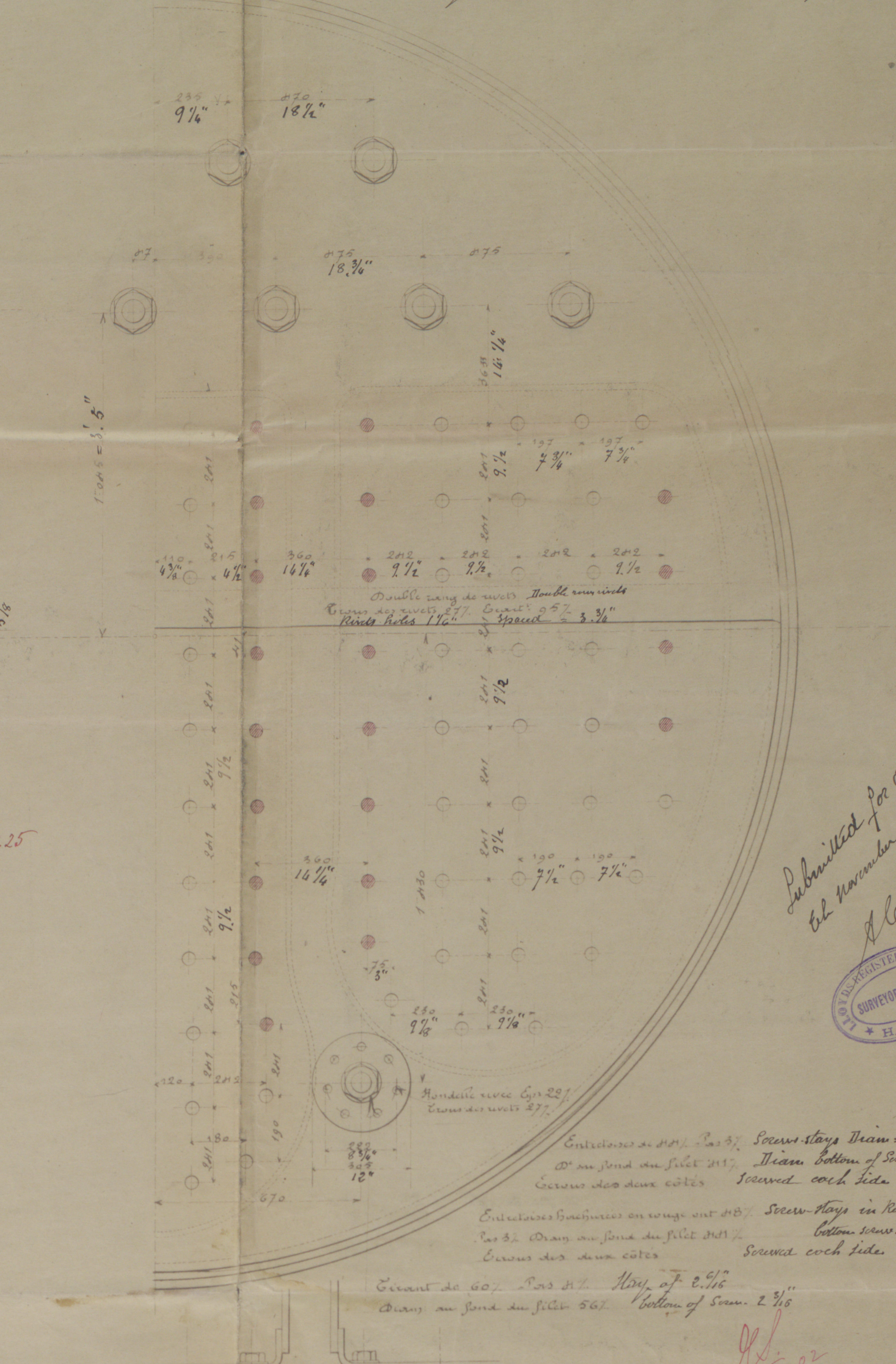

Table of Materials employed in the Building of Boiler

Quantité	Longueur	Epaisseur	Designation	Epaisseur	Designation
A	13.087	2.197	287	287	287
B	12.860	1.252	287	287	287
C	2.197	1.252	287	287	287
D	1.867	1.252	287	287	287
E	1.867	1.252	287	287	287
F	1.867	1.252	287	287	287
G	1.867	1.252	287	287	287
H	1.867	1.252	287	287	287
I	1.867	1.252	287	287	287
J	1.867	1.252	287	287	287
K	1.867	1.252	287	287	287
L	1.867	1.252	287	287	287
M	1.867	1.252	287	287	287
N	1.867	1.252	287	287	287
O	1.867	1.252	287	287	287
P	1.867	1.252	287	287	287
Q	1.867	1.252	287	287	287
R	1.867	1.252	287	287	287
S	1.867	1.252	287	287	287
T	1.867	1.252	287	287	287
U	1.867	1.252	287	287	287
V	1.867	1.252	287	287	287
W	1.867	1.252	287	287	287
X	1.867	1.252	287	287	287

33. Tubes sup. Diam 8.0 Long 3.800 Stay on top same Diam = 8.0"
6. Tubes de plaque à tubes Diam 8.0 Long 2.530 Stay of tube plates = 8.0"
6. Tubes inf. Diam 8.0 Long 3.770 Stay of tube plates = 8.0"
70. Tubes pour entretoises de 18.0 Long 3.660
13. Tubes pour entretoises de 18.0 Long 3.660



Submitted for Approval
20 November 1902
J. Caumont
SUPERVISOR OFFICE
HAYRE

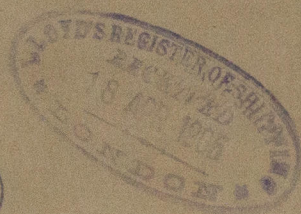
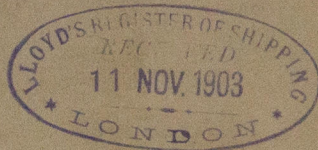
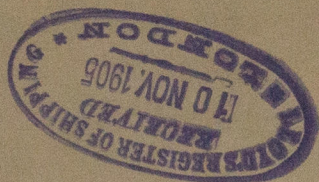

Maing-Boiler. Plan
intended for Vessel N°5 Built by
the Chantiers de France, to Dunkerque.
Also for Vessels N°6-7 & 8.

N°3.	S.S. Ville de Paris.	Dunkirk	1024	x
" 6.	S.S. Ville du Havre	-	1054	
" 7.	S.S. Louisiane	-	1129	
" 8.	S.S. Californie	-	1152	

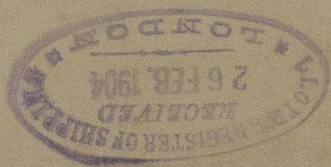

W555-0036

© 2020

Lloyd's Register
Foundation