

EXT
Rpt. No.

Antwerp
2/1/33

18235

MARITIME Lloyd's Register of British & Foreign Shipping.

(MARIETTA) SURVEYS FOR FREEBOARD.—STEAM SHIPS.

PARTICULARS RELATING TO ALL STEAM SHIPS EITHER FLUSH DECKED, OR WITH TOP GALLANT FORECASTLES, SHORT POOPS AND BRIDGE HOUSES DISCONNECTED, OR WITH TOP GALLANT FORECASTLES HAVING LONG POOPS, OR RAISED QUARTER DECKS CONNECTED WITH BRIDGE HOUSES, OR OTHERWISE.

Port of Survey Haarlem
Date of Survey 30th October 1922
Name of Surveyor Henry Davies

Ship's Name. S.S. "SIAM"
Port of Registry and Nationality. Marseille
Official Number. ✓
Gross Tonnage. 5123
Date of Build. 1906-1
Particulars of Classification. ✕ Spar Deck.
Number in Register Book 73150

Registered dimensions from Ship's Register.	LENGTH.	BREADTH.	DEPTH.	UNDER DECK Tonnage.
	<u>395.0</u>	<u>50.0</u>	<u>26.6</u>	<u>4409</u>
Length on LOADLINE	<u>394.46</u>	Frame Depth Rule "	Ceiling <u>filled</u> Sheer <u>+1.16</u>	Peak } Incl'd Tanks }
CORRECTED DIMENSIONS.	<u>394.46</u>	<u>50.0</u>	<u>27.76</u>	<u>4409</u>

Moulded Depth as measured..... 29'-3"

NOTE.—If the depth is measured when vessel is afloat, the details of measurement should be reported

CORRECTION FOR LENGTH.

Length of Ship on Loadline..... 394.46
Length in Table 351.00
Difference 43.46
Correction for 10ft., Table A. 1.5 Table C. .75
× Difference divided by 10 6.516 (if required.) 3.26
If $\frac{1}{10}$ th length covered divide by 2 +6½ +3¼"

CORRECTION FOR IRON DECK.

Proportion covered, if less than $\frac{1}{10}$ th length covered482
Thickness of usual wood deck, less stringer..... 3½" -1¼"

CORRECTION FOR ROUND OF BEAM.

Breadth at Gunwale amidships..... 44' 1½"
Round of Beam..... 12"
Normal round 12"
Difference ✓ ÷ 2 = ✓
Proportion of Deck uncovered (Para. 19)

NOTE.—The round of beam should be reported on the full breadth of vessel at the gunwale.

Efficient of fineness80
Modification necessary }
[Para. 4 (a) to (e) *] } -.01 C.D.B. Deep Framing
Efficient as corrected79

Stem... 122 } 182 ÷ 2 = 91 ... Mean 36½
Sternpost... 60 } 119.44
 $\frac{1}{2}$ of the length from { Stem 67.5 } 100.5 ÷ 2 = 50.25 ... Mean 91.23
 { Sternpost 33.0 } ÷ .55 = 91.46
Mean Sheer 91.23
Mean Sheer (Table, Para. 18) 49.44 Correction ..
Difference..... 41.79 ÷ 4 = -10½
Noted as Para. 18 (f).....

Mean Sheer { At front of bridge house.....
amidships {
Para. 18 (e) } At after end of forecastle

Mean Sheer {
Para. 18 (d) } ÷ 2 = ✓
Deck uncovered Correction

ALLOWANCE FOR DECK ERECTIONS:—

Freeboard, Table C..... 4'-1½"
Correction for Length, if required (Para. 12, 13, and 14) +3¼"
Freeboard by Table A, corrected for sheer, and for length, }
if required (Para. 12, 13, and 14) } 4'-4¾"
Difference 4'-0¾"
Allowance as below..... 2'-4½"
Total 30.74

Correction for R. Q. Dk. if engine and boiler openings not covered by bridge house (Para. 11)
Allowance for Deck Erections -9¾"

	Length.	Length allowed.	Height.
Forecastle.....	<u>33.80</u>	<u>33.80</u>	<u>7.6</u>
Bridge House.....	<u>118.75</u>	<u>118.75</u>	<u>7.6</u>
Raised Q. Dk.....	<u>37.75</u>	<u>37.75</u>	<u>7.6</u>
Total	<u>190.30</u>	<u>190.30</u>	<u>48.2%</u>
Length of Ship	<u>394.46</u>		
Corresponding percentage {			
Para. 11, 12, 13, or 14 } <u>30.74%</u>			

FREEBOARD recommended amidships from centre of Disc to top of Statutory Deck Line, Wood (Iron) Deck:—

<u>14.22</u>	Fresh Water Line	above centre of Disc	...
	Indian Summer Line	" "	...
	Winter Line	below " "	...
	Winter North Atlantic Line	" "	...

Winter Freeboard 6' 0¾"
Summer Freeboard 5' 7¾"
Indian Summer Freeboard 5' 2¾"
N. A. Winter Freeboard
Correction necessary because clearside amidships, measured in accordance with the Statute, is not taken at the intersection of the wood iron deck with side. +1¾"

Winter Freeboard from deck line 6' 2½"
Summer " " " " 5' 9½"
Indian Summer " " " " 5' 4½"
N. A. Winter " " " "
Total 5' 9½"

† If the frames, skin planking, or ceiling are of unusual thickness the breadth of vessel to inside of ceiling should be reported if possible.
† In vessels obtaining an allowance for deck erections under Para. 11 where the sheer drops abaft amidships the height of the R.Q.D. is to be taken from the level of the top of the amidship beam.
† In flush-decked vessels the total standard mean sheer means the sheer measured at the stem and sternpost. In vessels having raised poops and forecastles, it means the sheer measured at points distant one-eighth of the vessel's length from stem and sternpost.

† State dimensions of freeing port area on back of this form.
† The Surveyor shall state whether the fall in sheer as reported is measured relatively to the straight line of keel or to the water line. If measured relatively to water line the vessel's draft at time of survey, and also the usual load draft for sea, should be reported.

11b.

Do all the Frames extend to the top height in the Poop? *yes* Raised Quarter Deck? *—* Bridge House *yes* Forecastle? *yes*

To what height do the Reverse Frames extend? *All frames are of Built angle section and extend to weather decks; No Rev*

Has the Poop or ~~Raised Quarter Deck~~ an efficient Iron Bulkhead at the fore end? *yes*

Give particulars of the means for closing the openings in Bulkhead *Storm boards in channels riveted to bulkhead and covered by*
doors having two hinges and one bolt.

Is the Poop or ~~Raised Quarter Deck~~ connected with the Bridge House? *no* Has the Bridge House an efficient Bulkhead at the fore end? *yes*

Give particulars of the means for closing the openings in Bulkhead *No opening.*

What is the thickness of the Bridge Front plating? *3/8* and Coaming plate? *3/8*

Give scantlings and spacing of the Stiffeners *8" x 3 1/2" x 7/16" B.A. spaced 2'-6" apart.*

Are bracket plates fitted at each end of the Stiffeners? *yes* Are hor'l. brackets fitted connecting Bridge Bulk'd. with Bulwarks? *yes*

Has the Bridge House an efficient Iron Bulkhead at the after end? *yes*

How are the openings closed? *Storm boards fitted in channels riveted to bulkhead*

Is the Forecastle at least as high as the main or top-gallant rail? *yes* Has the Forecastle an efficient Iron or ~~Wood~~ *Bulw.* Bulk'd. at after end? *yes*

Are the Engine and Boiler openings covered by a Bridge, ~~Poop, Raised~~ *yes by a Bridge and Steel house above same, 7'-0" high.*
~~Quarter Deck Deck~~ enclosed by a Strong ~~Iron~~ or Steel Deckhouse? *yes*

If the openings are not so protected are the exposed parts of the Casings efficiently constructed? *yes.*

Give thickness of plating; scantlings and spacing of Stiffeners *Coaming 1-6 x 3/8. Plating 5/16. Stiffeners 5 x 3 x 3/8 angles 4'-2 apart.*

What is the height of the exposed Casings? *7'-0"* Are suitable means provided for closing all openings in them in bad weather? *yes.*

Are they constructed and at least equal to the *yes*

Are the Weather Deck Hatchways efficiently constructed and at least equal to the requirements of Section 28 of the Rules for 1904-5? Give particulars below:—											
Position and Size.		No. 1. 25-4 x 18-0		No. 2. 25-4 x 18-0		No. 3. 12-8 x 18-0 Bunker.		No. 4 & No. 5. 25-4 x 18-0 each.		No. 6 (on Poop)	
Item.		Ship.	Rule.	Ship.	Rule.	Ship.	Rule.	Ship.	Rule.	Ship.	Rule.
COAMING.	Height above top of DECK	3'-0"		3'-0"		1'-6"		3'-0"		1'-0"	
	Thickness {	Sides.....	7/16 full	9/32	7/16 full	7/16	7/16	7/16 full		3/8	
		Ends.....	7/16	9/32	7/16	5/16	5/16	7/16		3/8	
SHIFTING BEAMS OR WEB PLATES.	Number	4		4		2		4		None	
	Section and Scantlings.....	7/16 Plate 2'-2" x 3/8		7/16	7/16 2'-3" x 3/8		7/16 2'-3" x 3/8	7/16		fitted	
	Material.....	1/16 & angles 3 x 3 x 3/8		1/16	1/16 3 x 3 x 3/8		1/16 3 x 3 x 3/8	5/16			
FORE AND AFTERS.	Number.....	None		None		None		None		one	
	Section and Scantlings.....	fitted		fitted		fitted		fitted		7/16 Bull Plate	
	Material.....	-								angles 2 1/2 x 2 1/2	
HATCHES Thickness		2 1/2"		2 1/2"		2 1/2"		2 1/2"		2 1/2"	
Remarks.....		All good.		All good.		All good.		All good.		Good.	

* When the Fore and Afters are of wood the depth should be stated from the underside of the hatches.
(If the sill of the lowest side scuttle will be less than 6 inches above the Indian Summer Load Line if assigned under the tables, state vertical distance from top of deck at side amidships to lower edge of lowest side scuttle.) *No side lights fitted below*

The following information is to be given in all Cases of vessels dealt with under Paras. 11, 12 (under 15 feet Moulded depth) and under Shelter Deck Rules

What is the thickness of the Bridge Sheerstrake? $\frac{1}{2}$ " full Strake between Main and Bridge Sheerstrakes? $\frac{1}{2}$ "

Delete the words that do not apply { The Crew ~~was~~, are not, berthed in the bridge house.
The arrangements to enable them to get backwards and forwards from their quarters are, ~~un~~ satisfactory.

Freezing Ports each 3'-3" x 1'-6" }
4 " " each side in fore wall }
4 " " " " after " }
Freezing Ports " 3'-6" x 1'-6" "

Length of Bulwarks in well			No.	Freeing Ports (each side of vessel)
Ft.	Tenths.	Ft. Tenths.		
x		x	}	
x		x		
x		x		

Freeing Ports = Sq. ft.
(each side of vessel)

Total deficiency or excess = _____ Sq. ft.

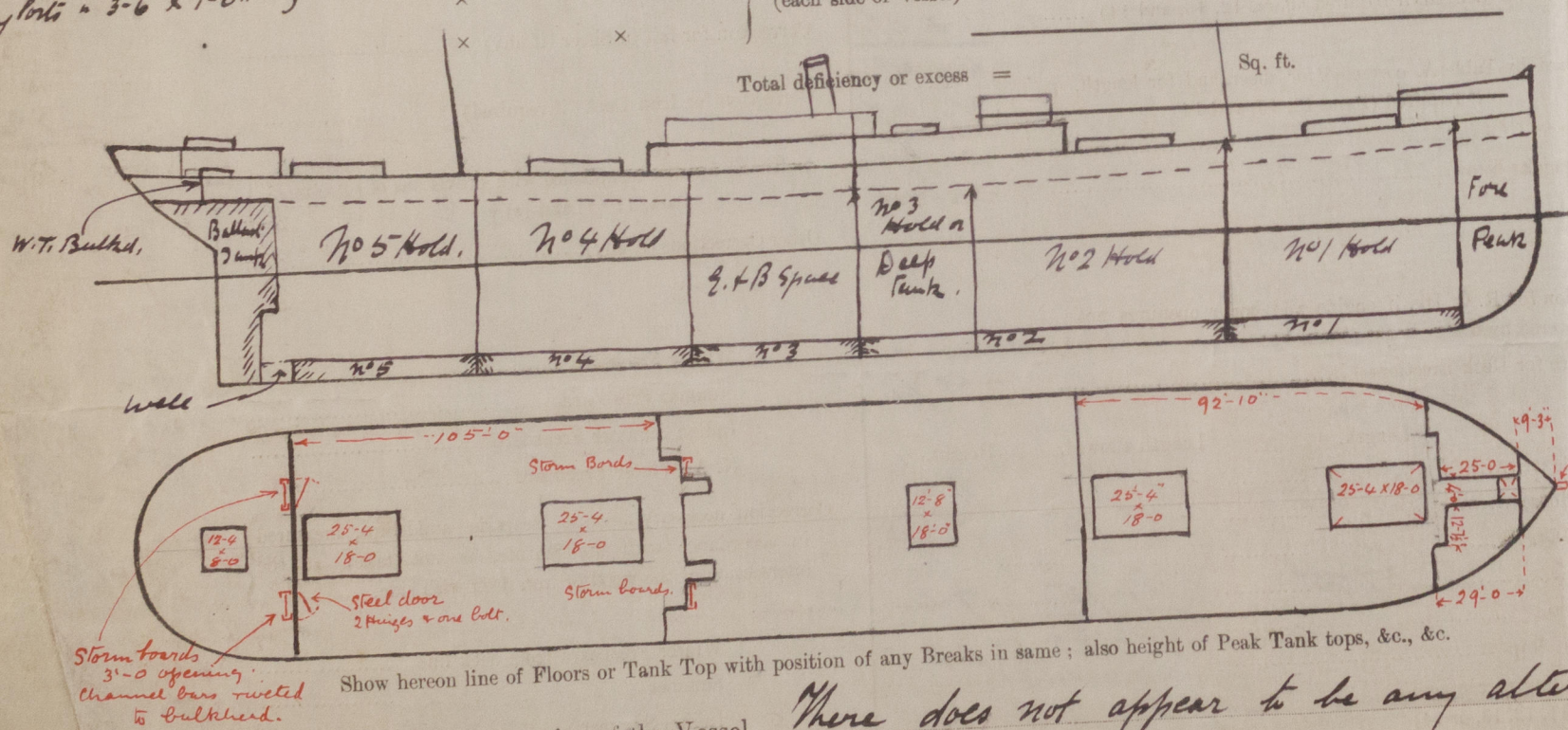

State any special features in the construction of the Vessel *There does not appear to be any alterations or additions since vessel was constructed. The thickness of all scantlings been well maintained and all necessary repairs are well in hand.*

Owners *Virginie John Diakakis.*
Athen.

Address

Received by me

Fee £