

12/1/17  
24.1.17



LONGITUDINAL ELEVATION.

S. S. No 506. 525'62'6" x 44'6" x 8'

SCALE 1/8" = 1'00"

TO CLASS AT LLOYD'S 100 A1 SHUTTER DECK

24.1.17

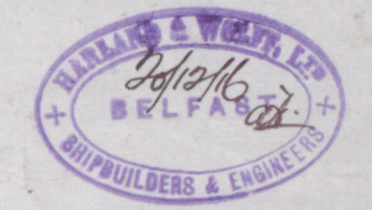



Harland & Wolff Ltd.

No 506

Amended Profile

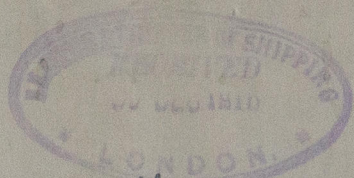

S Oroya

Cal 8892.

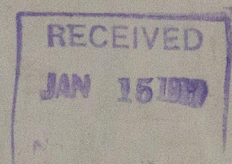

RETAIN

W540-0183



© 2019

Lloyd's Register  
Foundation