

MESSRS ROPNER & SONS S. S. N<sup>o</sup> 451.

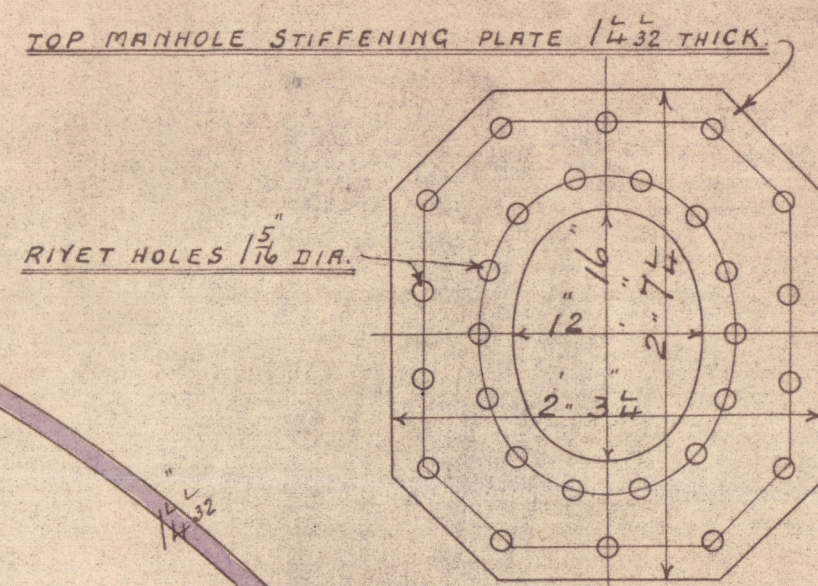

SCALE 1 INCH TO A FOOT.

180. LBS. WORKING PRESSURE. 2-OFF.

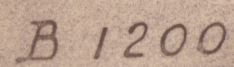
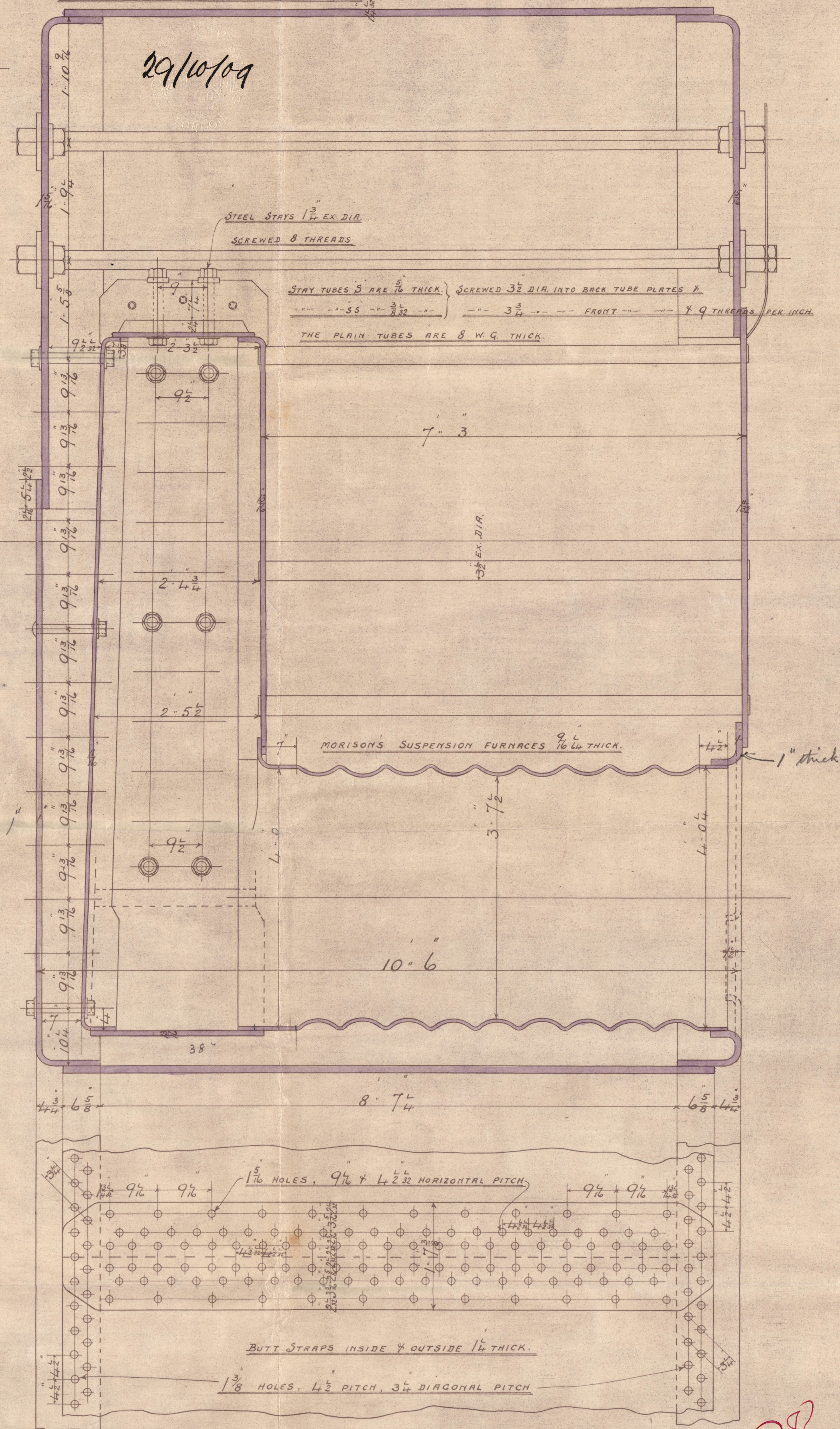

TOTAL HEATING SURFACE IN TWO BOILERS = 4927. SQ. FEET.

GRATE " " " " = 132 " "

THE MINIMUM TENSILE STRENGTH OF SHELL & GIRDER PLATES IS TAKEN AT 28 TONS PER SQ INCH



W 539-0240 2/2

Oct. 26<sup>th</sup> 1909

From BLAIR & CO., Ltd.,  
STOCKTON-ON-TEES.

To Messrs Lloyd's Register Surveyors  
Middlbro

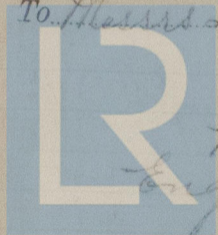

Lloyd's Register  
Boilers  
Engines No 1665  
Foundation

B 1200

W 539-0240 1/2

Thos Blair & Co  
Main Boilers No 1665-  
for

Thos Repner & Sons  
S.S. No. 451

Working Pressure 180 lbs.

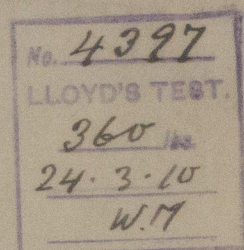
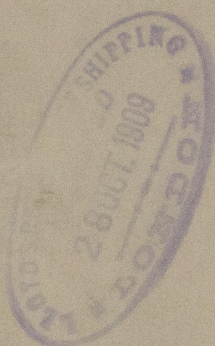

S.S. Spilsby  
Inclt Rpt No 629.

RETAIN



© 2020

Lloyd's Register  
Foundation

W539-0240