

Index No. _____
(For London Office only.)

Lloyd's Register of Shipping.
SURVEYS FOR FREEBOARD.—STEAM SHIPS.

10.515

CLARS RELATING TO ALL STEAM SHIPS EITHER FLUSH DECKED, OR WITH
PLANT FORECASTLES, SHORT POOPS AND BRIDGE HOUSES DISCONNECTED, OR
OF GALLANT FORECASTLES HAVING LONG POOPS, OR RAISED QUARTER DECKS
CONNECTED WITH BRIDGE HOUSES, OR OTHERWISE.

Port of Survey Belfast

Date of Survey *Building* 29/11/30

Name of Surveyor S. H. Kendall

Ship's Name.	Port of Registry and Nationality.	Official Number.	Gross Tonnage.	Date of Build.	Particulars of Classification.
<u>GANBANK</u>	Belfast British	161873	5583	1930	*100A1 (with freeboard) contemplated

	LENGTH.	BREADTH.	DEPTH.	UNDER DECK TONNAGE.
HD BT.	426.8	57.3	25.85	4958.92

Moulded Depth as measured..... 29.10

NOTE. — If the depth is measured when vessel is afloat, the details of measurement should be reported.

Addition for Keel below base line
for draught record.....inches.

CORRECTION FOR LENGTH.

Length of Ship on Loadline.....	425	
Length in Table	358	
Difference	<u>67</u>	
Correction for 10ft., Table A.	1.5	Table C.
× Difference divided by 10	<u>10.5</u>	(if required.)
If $\frac{6}{10}$ ths length covered divide by 2	+ 5.02	+ 5"

CORRECTION FOR IRON DECK.

Proportion covered, if less than $\frac{7}{10}$ this length covered $3\frac{1}{2}$ "
Thickness of usual wood deck, less stringer $3\frac{1}{2}$ " - $3\frac{1}{2}$ "

CORRECTION FOR ROUND OF BEAM.

Breadth at Gunwale amidships.....	5 ² ' -		
Round of Beam	13 ¹ / ₂ "		
Normal round.....	14 ¹ / ₄ "		
Difference	3 ¹ / ₄ "	÷ 2 =	3 ¹ / ₈ " -
Proportion of Deck uncovered (Para. 19)	01		nil -

should be reported
on the full
breadth of vessel
at the gunwale.

NOTE. — The round of beam should be reported on the full breadth of vessel at the gunwale.

Sheer { At front of bridge house.....
 [ships] {
 (e)] { At after end of forecastle

Sheer } $\div 2 =$ ✓
8 (4) }
corrected Correction

ALLOWANCE FOR DECK ERECTIONS:—

Table C.....

For Length, ~~if~~ required (Para. 12, 13, and 14)

by Table A. corrected for sheer, and for length, }
~~if~~ required (Para. 11, 12, 13, and 14) }

.....

as below.....

4-1 $\frac{3}{4}$

6-5 $\frac{1}{2}$
2-3 $\frac{3}{4}$
94-3
26-17

for R. Q. Dk. if engine and boiler openings not
red by bridge house (Para. 11)

for Deck Erections

- 2 - 2 $\frac{1}{4}$

	Length.	Length allowed.	Height.
use } 391.1		391.1 -	8.75
allowing } 6.0		-	-
to be } 27.9		27.9 -	8.76
cal } 425.0		419.0	
Ship } 3.0		3.0 -	
ling percentage } 94.3%		422.0	993.
1. 12. 12. or 14. } 425.0		425.0	

BOARD recommended amidships from centre of Disc to top of Statute.

	Fresh Water Line	above centre of Disc	
	Indian Summer Line	" "	" "
DEC 1930	Winter Line	below	" "
	Winter North Atlantic Line	" "	" "

In vessels having poops and forecasts, it means the sheer measured at points distant from the vessel's length from stem and stern-post.

Correction necessary because clearside amidships, measured in accordance with the Statute is not taken at the intersection of the ~~wood~~ or steel deck with side.

Winter Freeboard from deck line	4' - 6 $\frac{1}{4}$ "
Summer " " " "	4' - 0 $\frac{1}{4}$ "
Indian Summer " " " "	3' - 6 $\frac{1}{4}$ "
N. A. Winter , " " " "	

+ State dimensions of freeing port area on back of this form.

The Surveyor should state whether the fall in sheer as reported is measured relatively to the straight line of keel or to the water line. If measured relatively to water line the vessel's draft at time of survey, and also the usual load draft forward and aft should be reported.

RECEIVED
4 DEC 1980

WS'24-0248

Do all the Frames extend to the top height in the Poop? *yes* - Raised Quarter Deck? *✓* Bridge House? *yes* - Forecastle? *yes* -
 To what height do the Reverse Frames extend? *2nd Dk* -
 Has the Poop or Raised Quarter Deck an efficient Iron Bulkhead at the fore end? *yes* -
 Give particulars of the means for closing the openings in Bulkhead *no openings* -
 Is the Poop or Raised Quarter Deck connected with the Bridge House? *✓* Has the Bridge House an efficient Bulkhead at the fore end? *connected to Forecastle*
 Give particulars of the means for closing the openings in Bulkhead *✓*
 What is the thickness of the Bridge Front plating? *✓* and Coaming plate? *✓*
 Give scantlings and spacing of the Stiffeners *✓*
 Are bracket plates fitted at each end of the Stiffeners? *✓* Are hor'l. brackets fitted connecting Bridge Bulk'd. with Bulwarks? *✓*
 Has the Bridge House an efficient Iron Bulkhead at the after end? *yes* -
 How are the openings closed? *weather boards full height in riveted channels* -
 Is the Forecastle at least as high as the main or top-gallant rail? *yes* - Has the Forecastle an efficient Iron or ~~W~~ Bulk'd. at after end? *yes* -
 Are the Engine and Boiler openings covered by a Bridge, ~~Deep, Raised~~ *yes* -
~~Quarter Deck, or enclosed by a Strong Iron or Steel Deckhouse?~~
 If the openings are not so protected are the exposed parts of the Casings efficiently constructed? *✓*
 Give thickness of plating; scantlings and spacing of Stiffeners *✓*
 What is the height of the exposed Casings? *✓* Are suitable means provided for closing all openings in them in bad weather? *✓*

Are the Weather Deck Hatchways efficiently constructed and at least equal to the requirements of the Rules? Give particulars below: <i>Yes.</i>										
<i>Shelter Deck Hatchways</i>										
<i>2nd Deck Hatchways</i>										
Position.	1	2	3	4	5	1	2	3	4	5
Size.	24'75" x 22'	30'0" x 22'	30'0" x 22'	33' x 22'	33' x 22'	24'75" x 22'	30' x 22'		33' x 22'	33' x 22'
COAMING.	Height above top of DECK	33'	as in No 1				9" 3 1/2" x 40	Bulb Angles		
	Thickness	Sides 44'						W.T. Covers.		
SHIFTING BEAMS OR WEB PLATES.	Number	4	5	5	6	6	4	5	6	6
	Section and Scantlings	19" x 36	19" x 36	19" x 36	18" x 36	18" x 36	19" x 36	19" x 36	18" x 36	18" x 36
	Material	4 1/2" x 3" x 46	all angles 4 1/2" x 3" x 46				all angles			
FORE AND AFTERS.	Number	none				none				
	Section and Scantlings									
	Material									
HATCHES Thickness			2 1/2"				2 1/2"			
Remarks	Eighteen escape hatchways 24" x 24" with hinged bottom covers on 9" 3 1/2" x 40 B.A. Coamings									

* The depth of Fore and Afters should be stated from the underside of the hatches in all cases.

(If the sill of the lowest side scuttle will be less than 6 inches above the Indian Summer Load Line if assigned under the tables, state vertical distance from top of keel to lower edge of lowest side scuttle.)

The following information is to be given in all Cases of vessels dealt with under Paras. 11, 12 (under 15 feet Moulded depth) and under Shelter Deck Rules.

What is the thickness of the Bridge Sheerstrake?

Strake between Main and Bridge Sheerstrakes?

Delete the words { The Crew are, are not, berthed in the bridge house.

that do not apply { The arrangements to enable them to get backwards and forwards from their quarters are, are not satisfactory.

Length of Bulwarks in well 6'0"

Area of Freeing Ports required by Para. 11 (e) each side of vessel = Sq. ft.

Ft. Tenths. Ft. Tenths. No.

2 1 x 1 1 x 1 - Freeing Ports (each side of vessel) = Sq. ft.

x x

Total deficiency or excess = Sq. ft.

Longitudinal opening 22' x 6'0" efficient temporary means of closing provided

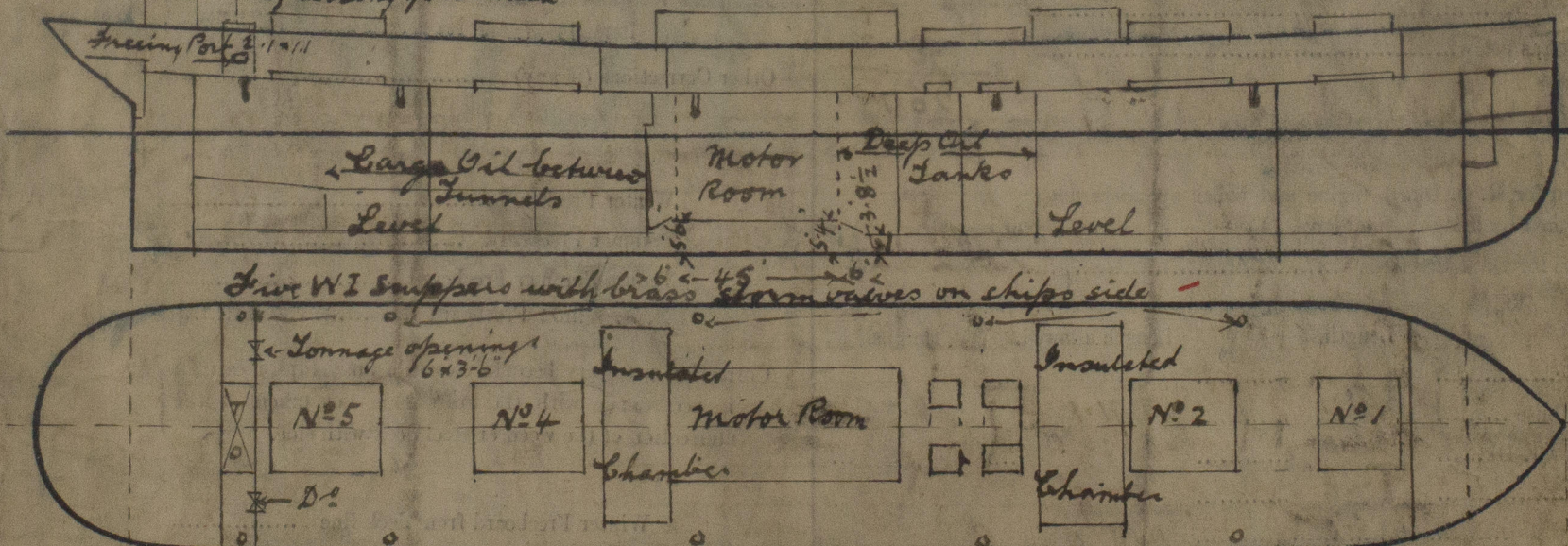

Show hereon line of Floors or Tank Top with position of any Breaks in same; also height of Peak Tank tops, &c., &c.

State any special features in the construction of the Vessel *Verified copies of approved plans filed in London Office*

Builder's name and yard number *Harland & Wolffs N° 879*

Names of sister vessels *MV FOYLEBANK Report N° 10482*

Owners *Bank Line Ltd (a. Weir & Co.)*

Address

Fee £ *9 : 3 : 4*

Received by me

See F.C. Report

To be collected with First Entry



© 2021

Lloyd's Register Foundation