

COUPLING BOLTS THIS

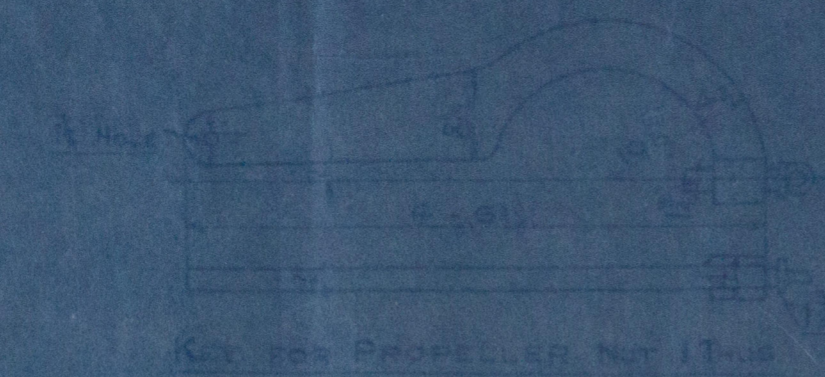

KEY FOR PROPELLER NOT THIS

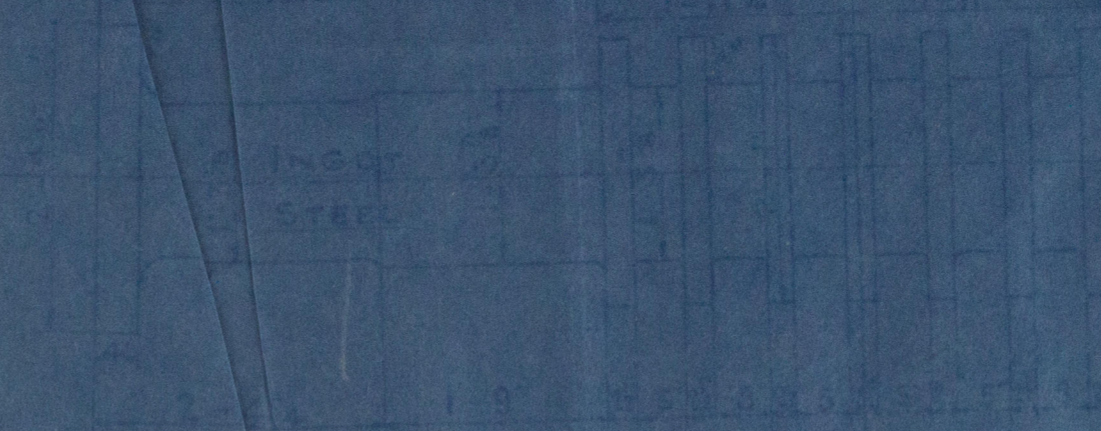

THIS BEARING ON N° 5 SH-1

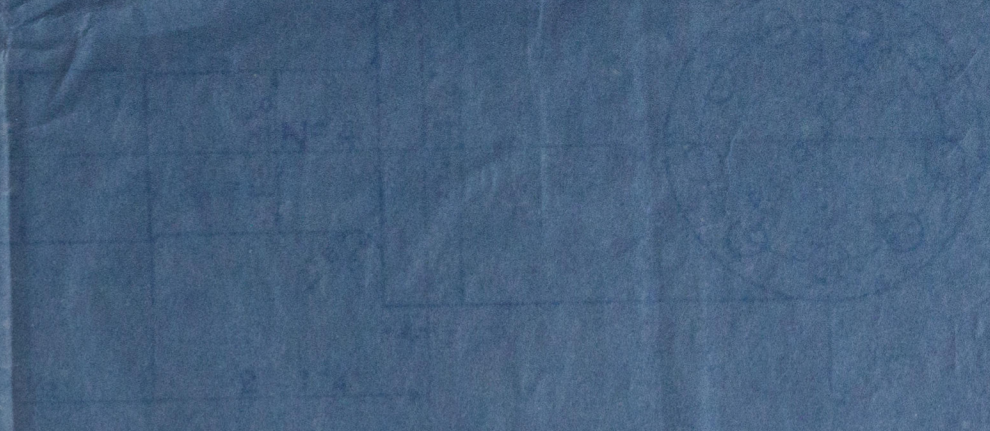

THIS BEARING ON N° 5 SH-1

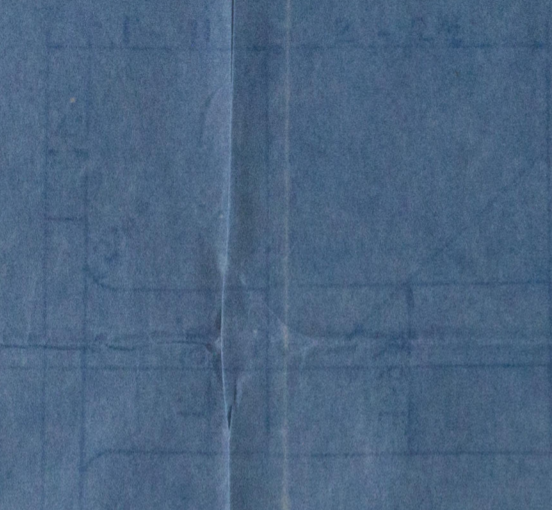

THIS BEARING ON N° 5 SH-1

THIS BEARING ON N° 5 SH-1

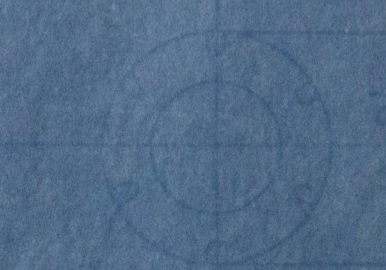
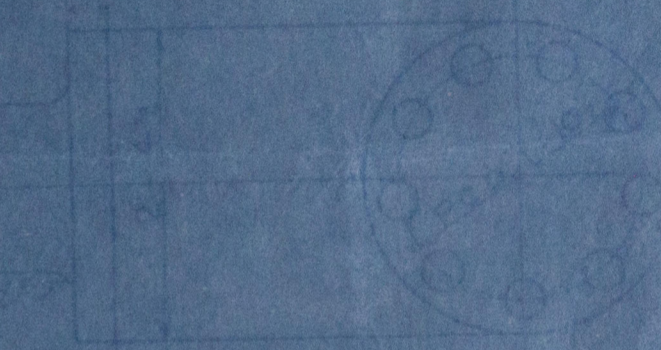

THIS BEARING ON N° 5 SH-1

THIS BEARING ON N° 5 SH-1

THIS BEARING ON N° 5 SH-1

THIS BEARING ON N° 5 SH-1

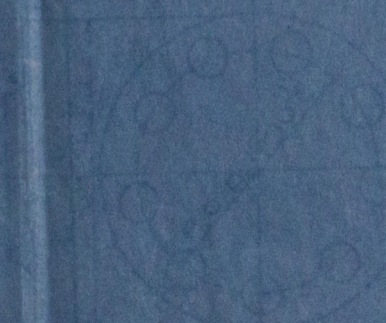

THIS BEARING ON N° 5 SH-1

Col. M.-I-6668
 Deutsche Schiff- und Maschinenbau
 Aktien-Gesellschaft
 Werft AG. Ges. "Weser"
 9.1.30

Noted
 29/1/30

NORTHUMBERLAND ENGINE WORKS N°22-47

S. S. "CLAN MACKENZIE"



© 2019
 Lloyd's Register
 Foundation

s.s. "Clan Mackenzie"
Straight Shipping
Bremen After E. 22.1.30.

Brun 1275

WS15-0027

Clan Mackenzie

Cl. M. - I - 6668
Deutsche Schiff- und Maschinenbau Aktiengesellschaft
Werk: Act. Ges. "Weser"
Anlage zum Schreiben vom 11.1.30
Geschäftszeichen: Nr. 2079
an Herrn Obering. Bahr
Vorgesetzter des Lloyd's Register of Shipping