

## Report of Survey for Repairs, &amp;c., of Engines and Boilers.

(Received at London Office)

Date of writing Report 30<sup>th</sup> Nov 1933 When handed in at Local Office 21 Dec 1933 19 33 Port of London  
No. in Reg. Book. 34862 Survey held at London Date, First Survey 9 Last Survey 22<sup>nd</sup> Nov 1933  
(No. of Visits one)  
on the Machinery of the Wood, Iron or Steel Sc. "SHELDRAKE"  
Tonnage Gross 462 Vessel built at Liverpool By whom Calby Bros & Co When 1920 10  
Net 195 Engines made at Sunderland By whom MacColl & Pollock & Co When 1920  
Nominal Horse Power 83 Boilers, when made (Main) 1920 (Donkey) 1920  
No. of Main Boilers 13B Owners General Steel Nav Co Ltd Owners' Address London  
No. of Donkey Boilers 1 Managers General Steel Nav Co Ltd Port London Voyage London  
Steam Pressure in Main Boilers 180 lb If Surveyed Afloat or in Dry Dock Onboard 10 10  
in Donkey Boilers 100 lb (State name of Dock.)

Last Report No. PortParticulars of Examination and Repairs (if any) Nil

Periodical Surveys, when held, must be reported in detail and serially in the terms of the Rules. State clearly the cause of repairs, if any, and, in detail, the nature and extent of examinations and subsequent repairs. Repairs on account of damage (the cause of which must be stated) should be separated from repairs due to other causes; and besides being detailed in the body of the report, should be briefly summarised at the end of the report. State also the dates and initials of any letters respecting this case.

In damage cases where the Surveyor has not made a special damage report he is required to state whether he offered his services for this purpose, and why they were declined.

Was a damage report made by anyone else? If so, by whom?

Did the Surveyor personally go inside each Main Boiler separately and make a thorough examination at this time? NO

Do. " Donkey " " " NO

If this was not done, state for what reasons? B.S. not due

And what parts of the Boilers could not be thus thoroughly examined?

Also what special means, in the absence of internal examination, were adopted by the Surveyor to assure himself of the thorough efficiency of those parts of each Boiler?

State latest date of internal examination of each boiler

Did the Surveyor examine the Safety Valves of the Main Boiler?

To what pressure were they afterwards adjusted under steam?

Did the Surveyor examine the Safety Valves of Donkey Boiler?

To what pressure were they afterwards adjusted under steam?

Did the Surveyor examine all the manholes, doors and their fastenings of the Main Boilers?

, and of the Donkey Boilers?

Did the Surveyor examine the drain plugs of the Main Boilers?

, and of the Donkey Boiler?

Did the Surveyor examine all the mountings of the Main Boilers?

, and of the Donkey Boiler?

Has screw shaft now been drawn and examined? NO Is it fitted with continuous liner?

Is an approved appliance fitted at the after end of the shaft to permit of it being efficiently lubricated?

Has shaft now been changed? NO If so, state reasons

Has the shaft now fitted been previously used? NO Has it a continuous liner?

Is an approved appliance fitted at the after end of the shaft to permit of it being efficiently lubricated?

State date of examination of Screw Shaft 1/8" State the distance between lignum vitae or bearing metal of stern bush and top of after bearing of screw shaft

Engine parts, when referred to by numbers, should be counted from forward.

If the Survey is not complete, state what arrangements have been made for its completion and what remains to be done. Completed

Vessel placed in dry dock, fastenings of propeller stem tube and sea connections examined.

## General Observations, Opinion, and Recommendation:—

(State clearly what alteration, if any, is suggested to be made in the existing classification of the vessel's machinery in the Register Book, consequent upon this survey, and also any alteration required to be made in the records of the vessel's machinery, boilers, working pressures, &c.; thus, for example, D.S. 9, 11, B.&M.S. 9, 11, or L.M.C. 9, 11, 140 lb., E.D., &c.)

Eligible in my opinion to remain as classed without fresh record of survey

Survey Fee (per Section 29) L 10 Fees applied for  
Special Damage or Repair Fee (if any) L 10 Received by me,  
(per Section 29.)  
Travelling expenses (if chargeable) L 10

Committee's Minute

Assigned

Particulars of Classification (which must be inserted precisely as in Register Book & Supplements).

CHARACTER, &c. for Special Survey, Date of last Survey and of Periodical Surveys.	Years since last survey, or since last periodical survey.	Machinery and Boiler Surveys (including date of N.B., if any).
<u>+100A1</u>	<u>11.32</u>	<u>+LMC 10.32</u>
<u>SS Lon N's</u>	<u>11.32</u>	<u>BS 9.33</u>
		<u>TS (24) 11.32</u>
<u>Propeller not fitted</u>		

Insert Character of Ship and Machinery precisely as in the Register Book.

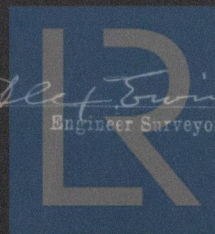

© 2020

Engineer Surveyor to Lloyd's Register of Shipping.

Lloyd's Register Foundation