

# LONGITUDINAL SECTION

S. S. Nos 113 and 114 and 115 (contd)

SCALE 1/4" = 1 FOOT.

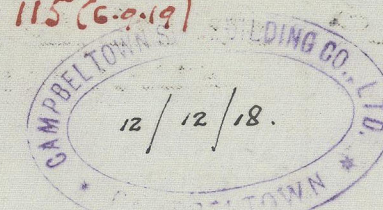

NOTE: IF ANY SCANTLING, STRENGTHENING ETC. WHICH WE HAVE HEREON SUBMITTED, BE IN EXCESS OF YOUR MINIMUM REQUIREMENT KINDLY AMEND SAME

19.12.18  
22.1.19

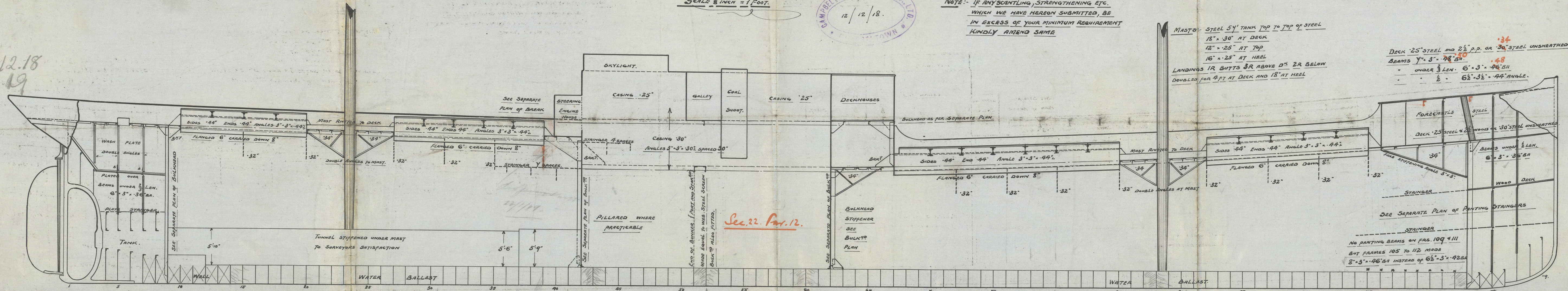

RIVETS THRU FRAMES AND SHELL IN AFTER PEAK SPACED 5 1/2 DIAMTS APART.

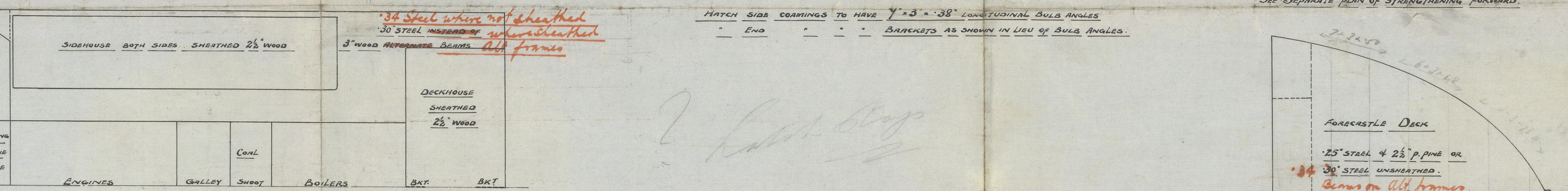

SEE SEPARATE PLAN OF BREAK

EVERY 2 1/2\"/>

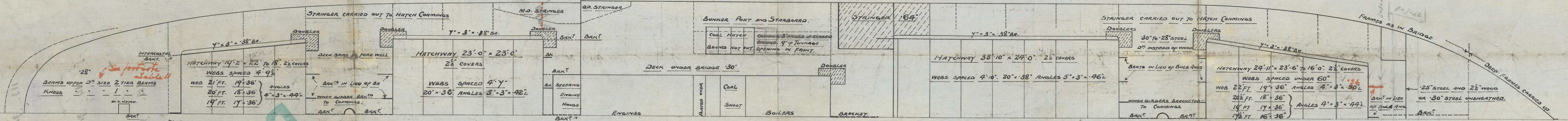

APPROVED  
LLOYD'S REGISTER OF SHIPPING

DATE

Ct.  
19.12.18

APPROVED  
LLOYD'S REGISTER OF SHIPPING

DATE

for 45 ft  
8.7.19



LONGITUDINAL SECTION.

S. S. N<sup>os</sup> 113 AND 114.

113.  $\frac{1}{2}$  "Firth of Clyde"

Report No 17577

---

114  $\frac{1}{2}$  "Hillglen"

Report No 17592

---

115.  $\frac{1}{2}$  "Akerside"

Report No. 17973

RESERVED

© 2020

Lloyd's Register  
Foundation

W467-0317