

S/S „SCOTIA“.

289'-10" x 42'-1 1/4" x 21'-9"

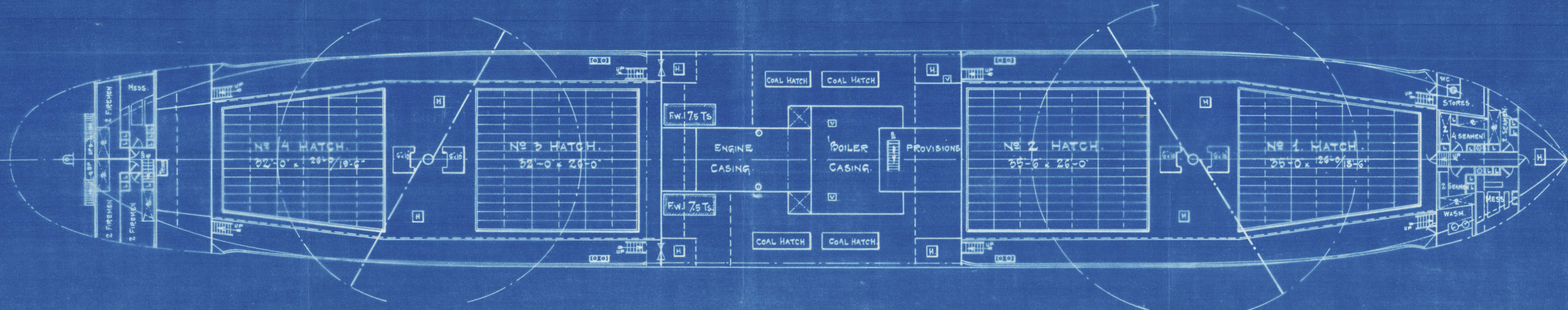
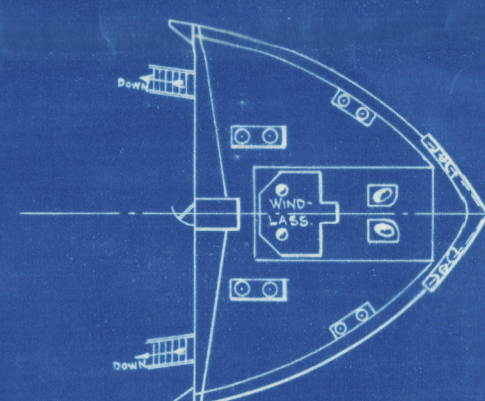
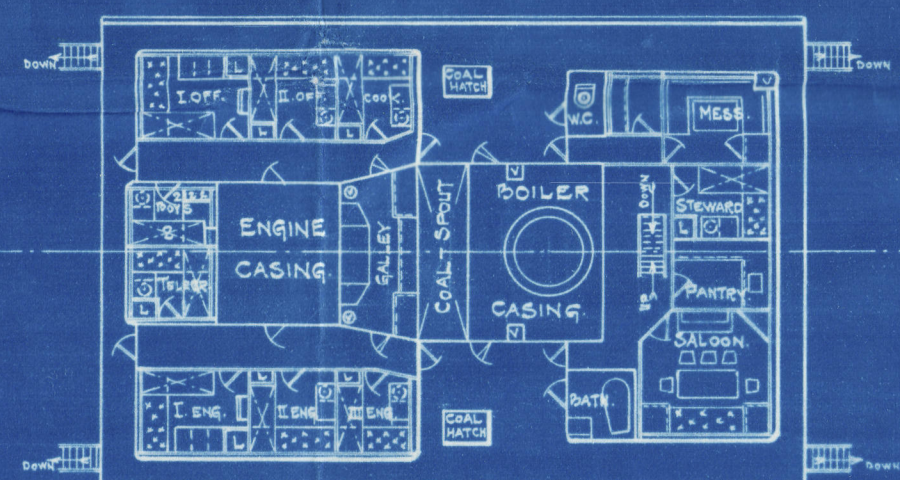
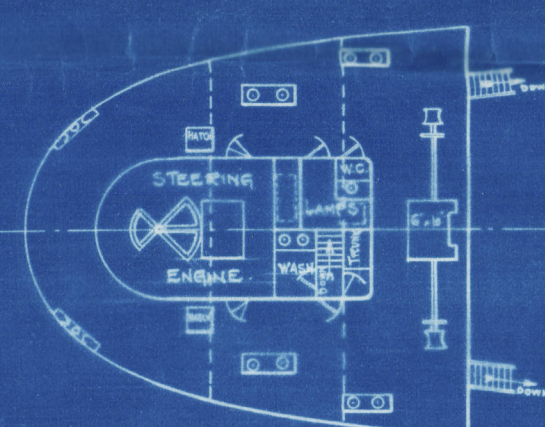
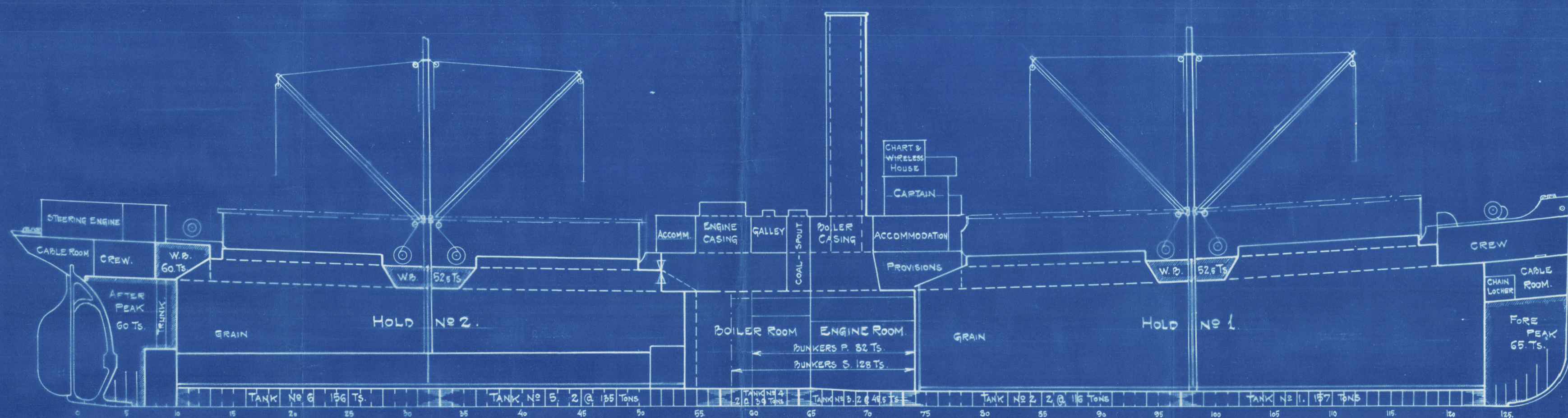

CAPACITIES OF CARGO SPACES.

ITEM.	BETWEEN FRAMES	GRAIN.
No 1 HOLD FORW.	95-123	41000
No 1 --- AFT.	74-98	43700
No 2 --- FORW.	55-82	36900
No 2 --- AFT.	32-10	28500
TOTAL HOLDS		150100
No 1. TRUNK	101-119	4980
No 2 ---	74-95	6220
No 3 ---	35-52	5550
No 4 ---	13-29	5015
TOTAL TRUNKS		21835
TOTAL HOLDS AND TRUNKS		171935
BRIDGE	52-78	10500
GRAND TOTAL		182435

CAPACITIES OF TANKS

ITEM.	BETWEEN FRAMES	SW.	FW.
No 1 DB TANK SB & PS	97-123	1570	
No 2 --- SB.	73-97	1160	
No 2 --- PS	73-97	1160	
No 3 --- SB	64-73	455	
No 3 --- PS	64-73	455	
No 4 --- SB	57-64	390	
No 4 --- PS	57-64	390	
No 5 --- SB	33-57	135	
No 5 --- PS	33-57	135	
No 6 --- SB & PS.	10-33	1560	
TOTAL IN DB TANKS.		9840	
No 1. TRUNK TANK	94-102	525	
No 2 ---	28-36	525	
POOP TANK	18-13	600	
TOTAL IN TRUNK AND POOP TANK.		1650	
FORE PEAK TANK	123 To STEM	650	
AFTER ---	1-10	600	
TOTAL IN PEAK TANKS		1250	
GRAND TOTAL		12740	

CAPACITIES OF BUNKERS

TAKEN TO OUTSIDE OF FRAMES AND UNDERSIDE OF BEAMS
AT 45 CUB. FT. PR TON

ITEM.	BETWEEN FRAMES	TONS
PERMANENT COAL BUNKER SB	58-74	128
--- PS	60-74	82
TOTAL PERMANENT COAL BUNKERS		210
RESERVE BUNKER ON MAINDECK	52-78	233
COAL SHOOT	63-65	14
TOTAL RESERVE BUNKER		247
GRAND TOTAL		457

THE COPENHAGEN FLOATING DOCK
AND SHIPBUILDING COMPANY LTD.

General Arrangement,
"G. G. Scotia" of
Copenhagen.

(Unofficial Plan).
for guidance.

Cym. Rpt. No. 6737.

RETAIN



© 2020

Lloyd's Register
Foundation

W463-0045