

SCALE $\frac{1}{8} = 1 \text{ FOOT}$

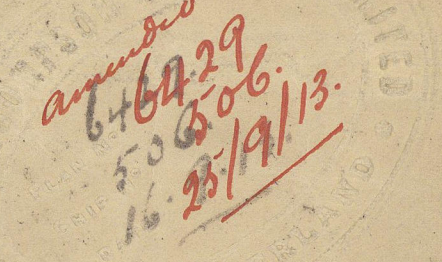
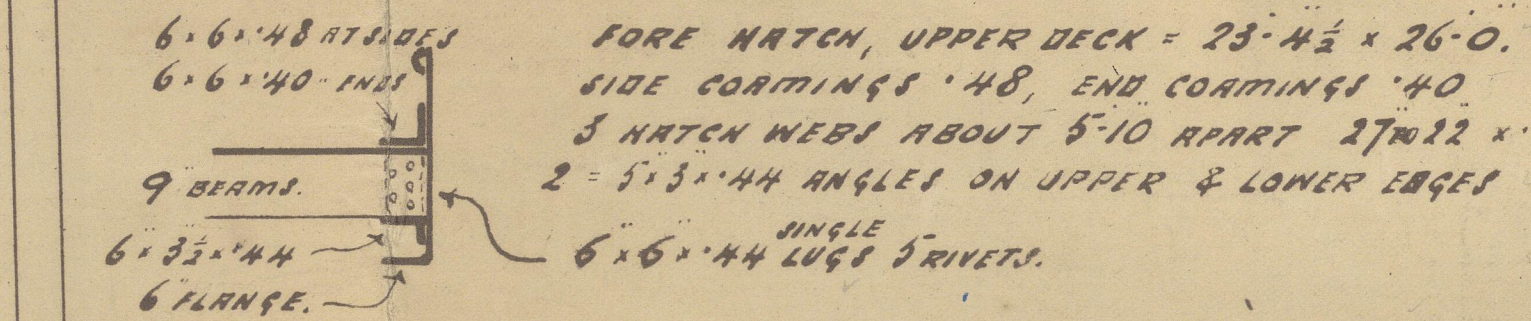
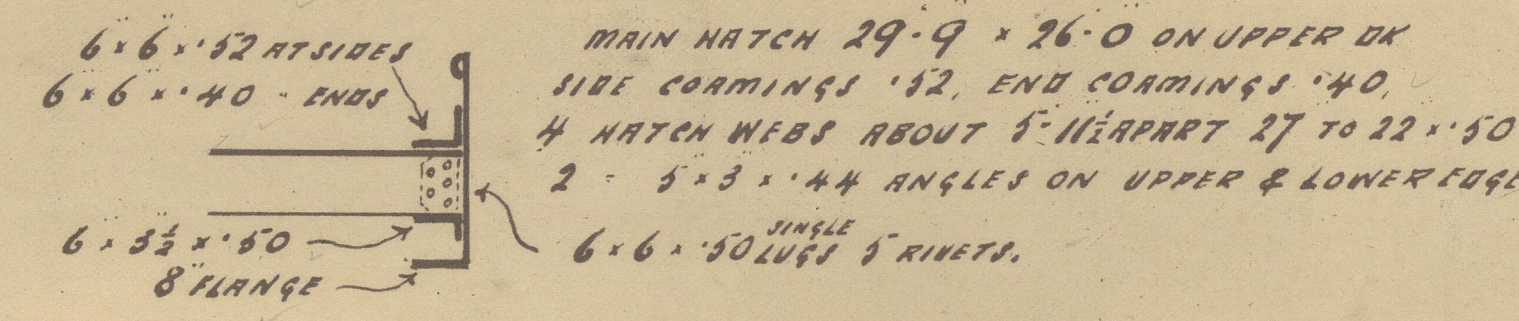
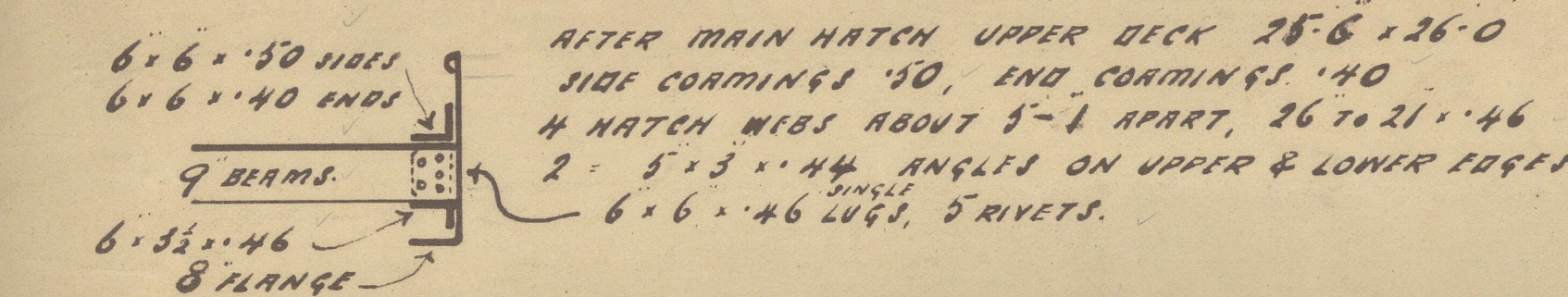

BULKHEAD N^o 172 28 to 30, 12 to 13.
36 to DREP TANK TOP 34 to 30 OR ALL 32
ABOVE. FRAM 5' x 5' 32, SK. BARS 4' x 4' 36
B.A. STIFFS 7' x 3' 44 24 APART. IN TRNK.
6' x 3' 40 B.A. STIFFS. ABOVE W.T. FLAT
24' APART. STIFFS BRACKETED AT SHOWN.
ALSO SEMI BOX BEAM AT SHOWN & 3 HORIZONTAL
STIFFS. 8' x 3' x 42 B.A.

S.S. No 506 TM

Amended
Profile

See later plan of profile

J. L. Thompson done

RETAIN

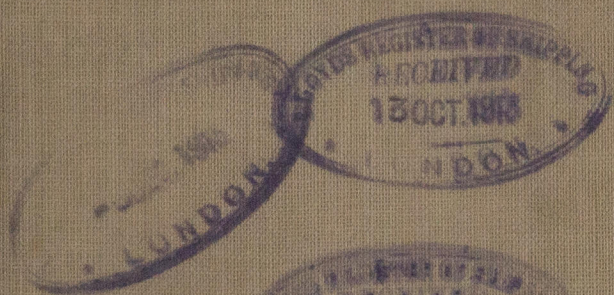
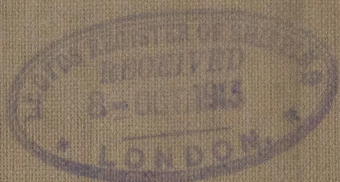

506

S.S. 'Podem'

Sld. Rpt. No. 26116

507

S.S. 'NARVIK'

SUNDERLAND RPT. No. 26161



© 2020

Lloyd's Register
Foundation

W4550139