

15/12/13

CIRCUMF. SEAMS - DOUBLE RIVETED
1 1/16" HOLES 3 1/4" PITCH

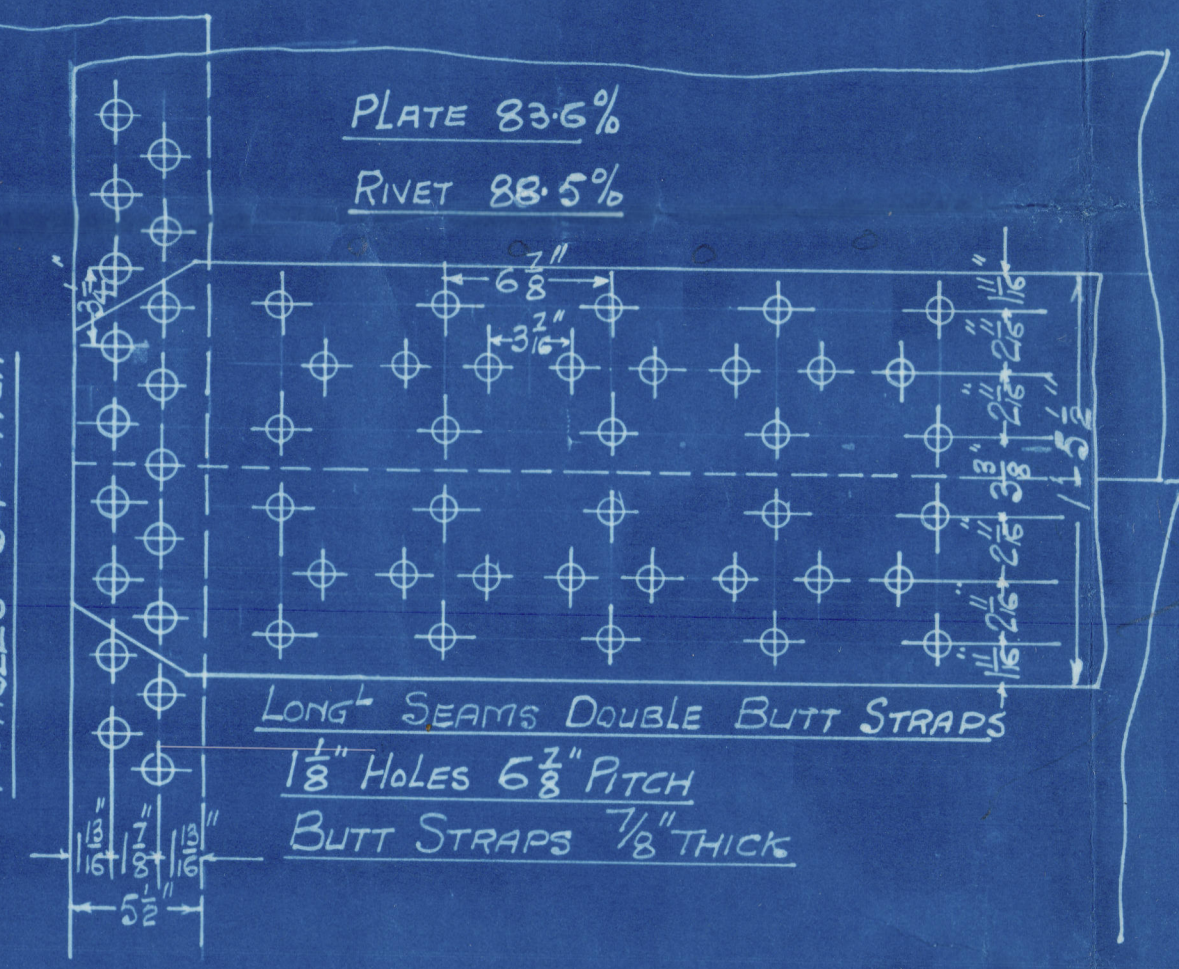

STEEL PLATES, BARS & RIVETS
IRON TUBES & GIRDERS
ALL HOLES DRILLED IN PLACE

Tensile Strength of Shell - Butt Straps & Manhole Ring
28 to 32 Tons per sq inch.

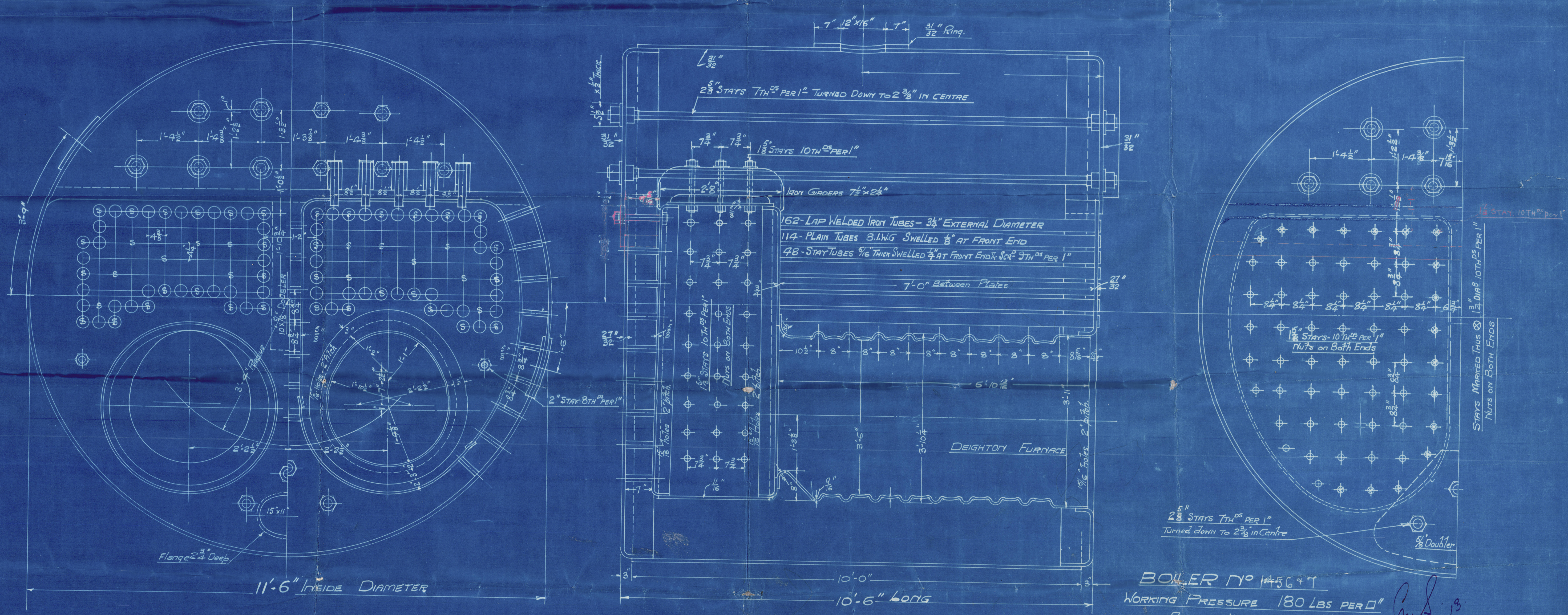

TO HAVE LLOYDS CERTIFICATE

BOILER NO 145697
WORKING PRESSURE 180 LBS PER SQ IN
SCALE 1/4" = 1 FOOT

Gross Surface (5'6" BAR)	39 1/2 #
Tube Heating Surface	965 #
Other " "	228 #
Total " "	1193 #
Ratio G.S. to H.S.	= 1 : 30

15-12-13
APR
15-12-13

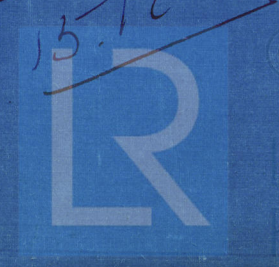

W439-0090

P & D. Engine 7⁰ 965.
Boiler 7⁰ 1456 & 4.

Campbell & Co Shipbuilding Co
S/S. 7⁰ 99.

W. P. 180 lbs per sq. inch

~~M. "CLIO"~~

S.S. "CATO"

Grk 16701.

MARK ON BOILER. No 1456-7

No 12695

LLOYD'S TESTS.
360 lbs.

5. 1914 P.T.B.

GLASGOW REPORT No. 34127.

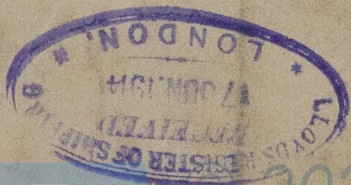

© 2020

Lloyd's Register
Foundation 0090



© 2020

Lloyd's Register
Foundation