

PARTICULARS OF PROTECTION TO OPENINGS, ETC.

HATCHWAYS ON FREEBOARD AND SUPERSTRUCTURE DECK										
VAPER DECK → 1 → BRIDGE DECK → 2 →										
Description of Hatchway	No. 1.	No. 2.	No. 3.	No. 4.	No. 5.	No. 2.	No. 3.	No. 4.	No. 5.	No. 6.
Dimensions of Hatchway	26' 6" x 20'	26' 4" x 20'	22' 5" x 20'	25' 4" x 20'	26' 6" x 20'	26' 7" x 20'	23' 5" x 20'	26' 4" x 20'	26' 4" x 20'	6' 1" x 1' 6"
COAMINGS	Height above Deck ...	48"	12	12	12	same	36	36	36	39
	Thickness Sides44	.44	.44	.44	same	.44	.44	.44	.44
	Thickness Ends44	.44	.44	.44	same	.44	.44	.44	.44
	Stiffeners ...	Planned	same	same	same	same	same	same	same	same
	Brackets, Stays	same	same	same	same	same	same	same	same	same
HATCH BEAMS	Number ...	5	5	5	5	5	5	5	5	5
	Spacing ...	24' 5"	24' 9"	32' 9"	42' 9"	42' 5"	42' 9"	42' 9"	42' 9"	42' 9"
	Scantling and Sketch	Plate 17 x 38	20 x 38	20 x 38	20 x 38	same	same	same	same	same
	Angle	4 x 3 x 4	4 x 3 x 4	4 x 3 x 4	4 x 3 x 4	same	same	same	same	same
	Bearing Surface	3	3	3	3	same	same	same	same	same
FORE AND AFTERS	Number
	Spacing
	Unsupported Lengths
	Scantling* and Sketch
	Bearing Surface
HATCH COVERS	Material ...	wood	wood	wood	wood	same	same	same	same	wood
	Thickness ...	3	3	3	3	same	same	same	same	2 1/2
	How fitted	F. fast	F. fast	F. fast	F. fast	same	same	same	same	Planned
	Bearing Surface	3	3	3	3	same	same	same	same	2
Spacing of Cleats	...	24	24	24	24	same	same	same	same	24
Number of Tarpaulins	...	4	4	4	4	same	same	same	same	2

* Are wood fore and afters steel shod at all bearing surfaces?

Are battens and wedges efficient and in good condition?

Are tarpaulins in good condition and in accordance with rule requirements?

Are lashings provided in accordance with rule requirements?

Particulars of fiddley, funnel and ventilator coamings:—

Particulars of fiddle, funnel and ventilator coamings. The fiddle^{cover} and funnel are situated 10 ft. above the bridge deck. They are of steel, in accordance with the Rules, and in satisfactory condition. The ventilator is situated above the level of the fiddle and satisfactory. The engine room skylight has shingled

Particulars of Flush Bunker Scuttles:—

Particulars of Companionways :—

Particulars of Ventilators in exposed positions on freeboard and superstructure decks :—

Particulars of Ventilators in exposed positions on freeboard and superstructure decks :—

The ventilators were in plan and from 8" to 18" and are in accordance with the rules. The closings are in general in accordance with the rules as to height & thickness.

Particulars of Air Pipes in exposed positions on freeboard, raised quarter, or superstructure decks:—

Particulars of Air Pipes in exposed positions on freeboard, raised quarter, or superstructure decks :-

The air pipes on the forecable deck to the storage are 5" beam and 10" in height (4 off). There are four air pipes on top of the aft head. The owners have been requested there to 15" (see copy of letter attached). All other air pipes are

Particulars of Gangway Cargo and Coaling Ports:—

Particulars of Gangway Cargo and Coaling Ports:—

State what compartments

has this been done. (See letter)

None

s of Scuppers and Sanitary Discharge Pipes

There are no scupper and sanitary discharge pipes from spaces below the level of the foreboard deck; nor are there any sanitary discharge pipes from spaces below the foreboard deck. The sanitary discharges fitted are of cast iron, and have valves.

s of Side Scuttles :

s of Guard Rails :—

s of Gangways, Lifelines, etc. :—

Languey on starboard side over forward
and after wells. Languey made of wood,
and supported by 2" steel supports spaced about
10 ft.

Particulars of Freeing Arrangements.

	Length of Bulwark	Height of Bulwark	Size of Freeing Ports	Number each side	Area each side	Rule area each side
all	$32' 8''$	$4' 10''$	$3' 9'' \times 2' 0''$	$\frac{4}{2} = 2$	$15' 6''$	9.6
Well	$32' 8''$	$4' 10''$	$3' 9'' \times 2' 0''$	$\frac{4}{2} = 2$	$15' 6''$	9.6

position of each freeing port { After Well :- *One near each end - 10" above deck to lower edge*
A. position and height above deck edge) { Forward Well :- *ditto* ✓

whether the freeing ports are fitted with shutters, bars, or rails, and give particulars of such:— *Shutters and rails (2 trees).*

al area where sheer is less than standard.

Particulars of Superstructures, Trunks, Casings, Deckhouses.

	Coaming	Plating	Stiffeners	Spacing	End Attachments of Stiffeners	Size of Openings	Height of Sills	Height of Casings
Head31 -	.31 -	not accessible	26"	bracketed 1/2" x 1/2"	none	✓	4 1/2"
Quarter Deck Bulkhead ...	✓							
After Bulkhead31 -	.31 -	5 1/2" x 1 1/2" angle	24"	ditto	4' 6" x 3' 0"	12"	4 1/2"
Forward Bulkhead31 -	.31 -	5 1/2" x 1 1/2" angle	20"	ditto	2' 6" x 2' 0"	4 1/2"	4 1/2"
Bulkhead31 -	.31 -	6 x 1 x 1/2" angle	31"	ditto	4' 0" x 1' 0" x 1' 8" 2' 0" x 2' 0" 2' 0" x 2' 6"	18" 26" 18"	4 1/2" 4 1/2" 4 1/2"
... ..	✓							
Forward	✓							
Machinery Casings on Freeboard Raised Quarter Decks ...	✓							
Machinery Casings on Superstructure Decks25 -	.25 -	4 x 1 x 1/2" angle	26"	to brackets	two half doors 4' 6" x 4' 10"	18"	4 1/2"
Casings within Superstructure fitted with Class I Closing	✓							
on Flush Deck Ships ...	✓							

Particulars of Closing Appliances (state if capable of being manipulated from both sides).

[illegible]

Superstructure bulkheads, trunks, deckhouses, casings, cargo and coaling hatchways, extent and thickness of sheathing on the freeboard deck, gangway, cargo coaling ports, and any other openings, etc., which would affect the seaworthiness of the ship, are to be shewn on the following sketches:— (not to scale)

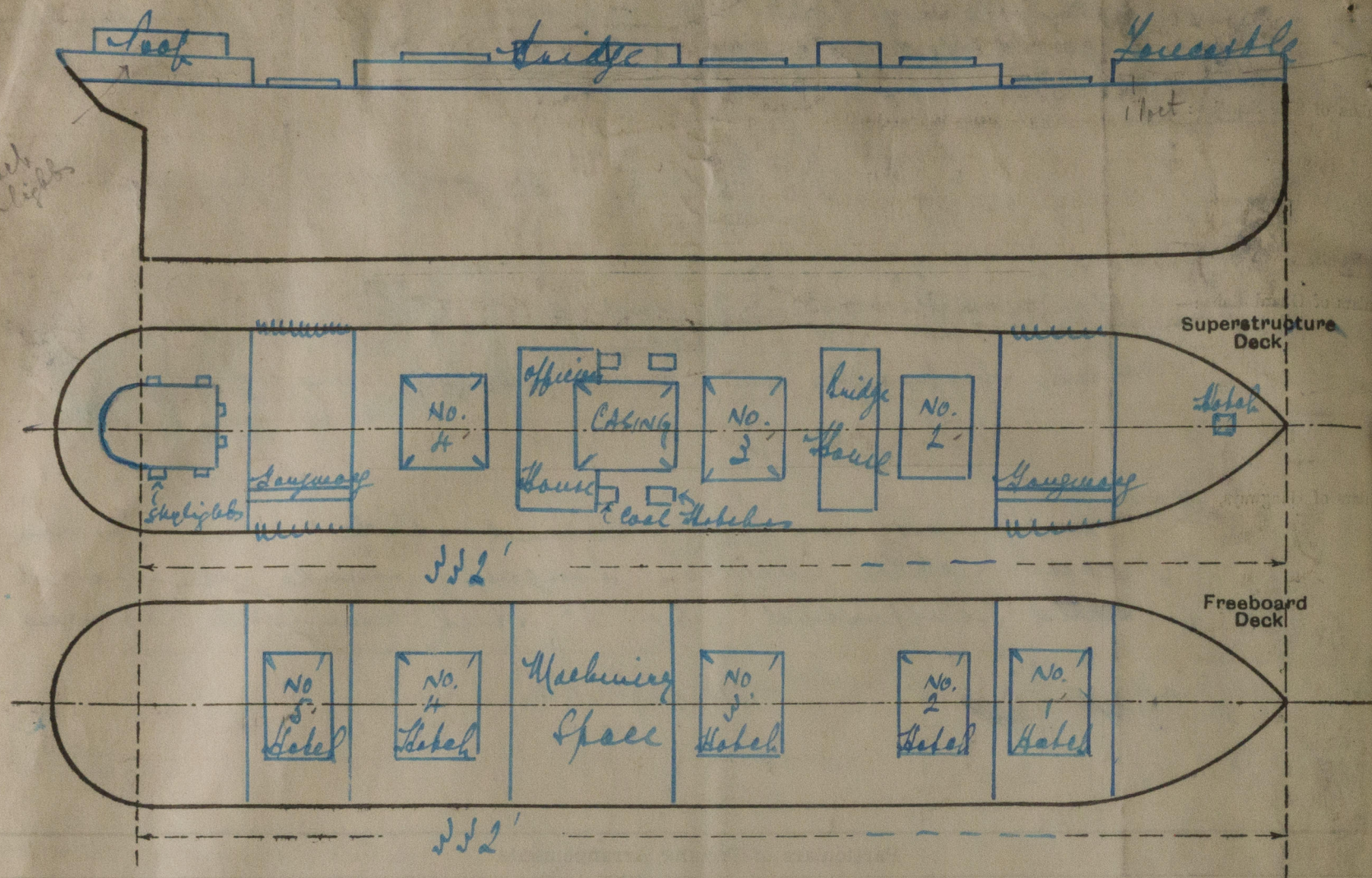

State any special features in the construction of the ship:—

There is an ash chest leading from above the bridge (starboard side) through the shell, and comes out about one foot above the present centre of deck. The trunk is water-tight and the opening in the shell is fitted with a sliding shutter on the outside.

Timber deck cargoes:— Rules 82, 83, 86 and 87 are satisfactorily complied with in this vessel. Regarding Rules 88 and the arrangements of uprights and lashings are shown on plan attached, which was taken direct from the ship. The absence of the Captain, the mate was requested to give information regarding the usual height of timber cargo. He stated this was usually carried to a height of about 10 above the bridge deck & similar height in wells. Previous cargoes have been fit traps and deals from Archangel.

Builder's name and yard number Schpw. v. Jan Swit.

Names of sister ships ✓

Owners Aht. Lampskib. Sannenberg

Fee £ 60 00
11 00
20 00

Received by me

Particulars shown to be found
 an not reference to any



© 2019

Lloyd's Register
 Foundation