

15.5.05
 08/05
 15.5.05

now 97.5 feet

MIDSHIP SECTION
 S. S. N° 180
 85 FT x 20 FT x 9 FT MLD
 TO CLASS 100 A
 RAISED Q'S DECK 2.8 HIGH
 FORECASTE 5.0

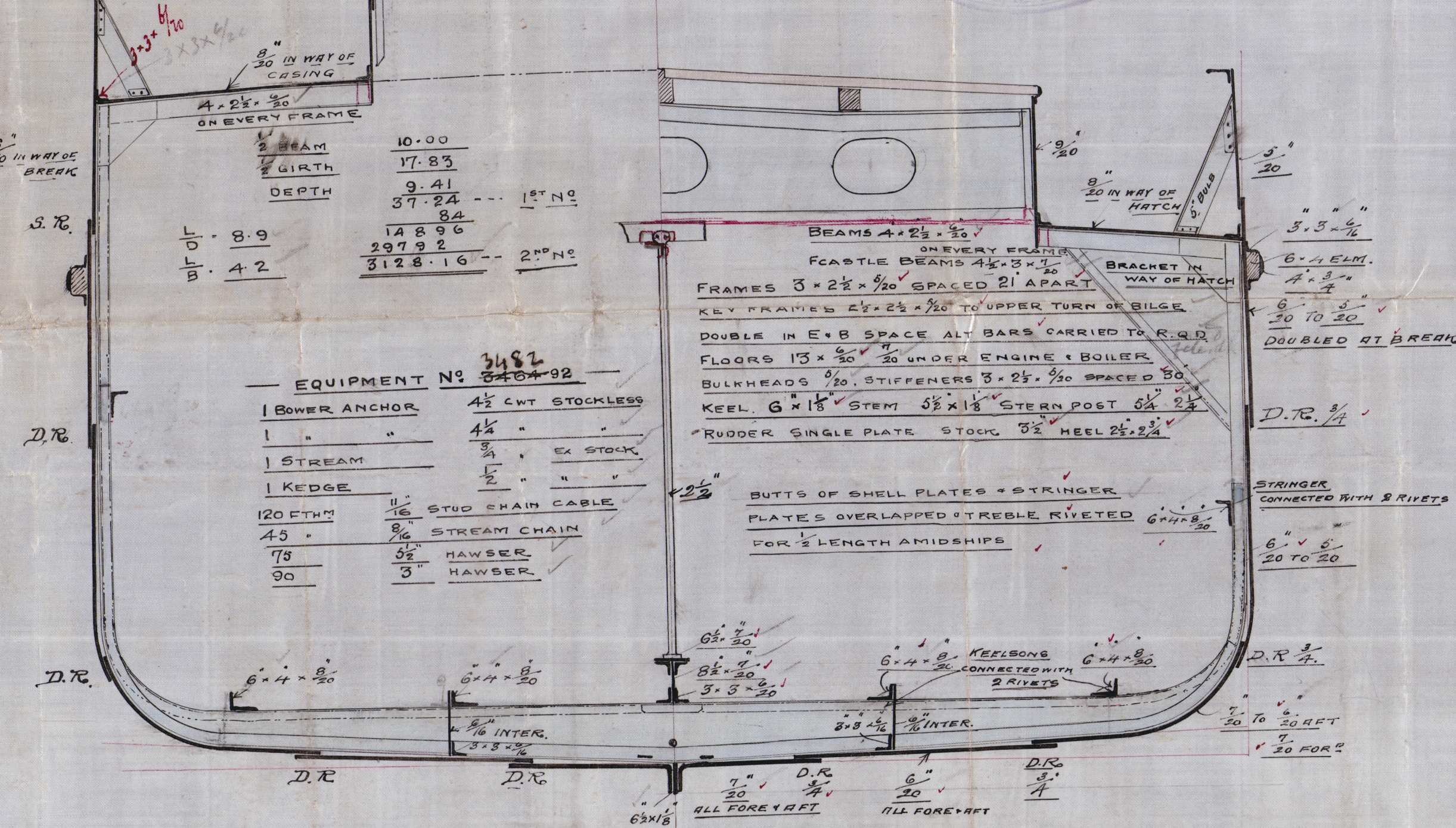

S. S. N° 180
 85 FT x 20 FT x 9 FT MLD
 SCALE 1/4" = ONE FOOT
 TO CLASS 100 A

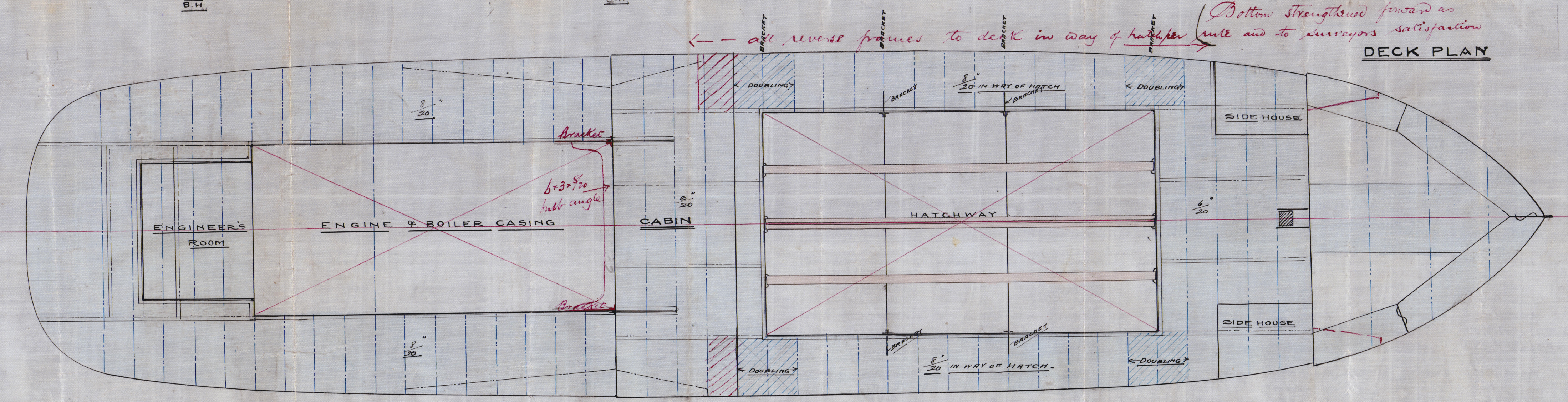
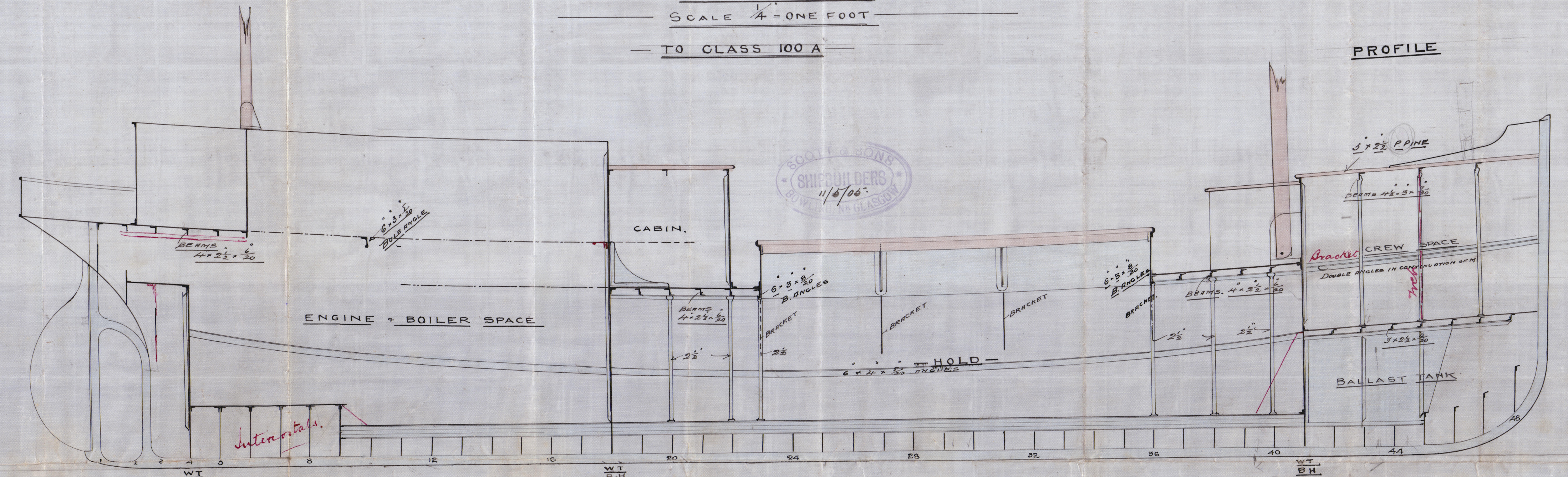

T.W.
 13/5/05

J.H.
 13/5/05

Section & Profile

Scott & Sons

No 180

"Hamilton"

Gls. Mt. 23620

70221

RETAIN

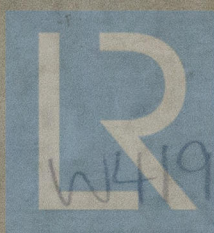
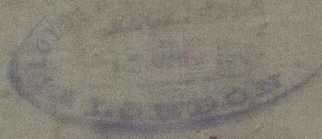

© 2019

Lloyd's Register
Foundation