

# PRESENT ARRANGEMENT OF HATCHWAYS

Scale  $\frac{1}{4} = 1 \text{ FT}$

FOR ELLERMAN'S WILSON LINE, LIMITED  
per H. H. H. H. H.

## Nº 4 HATCH

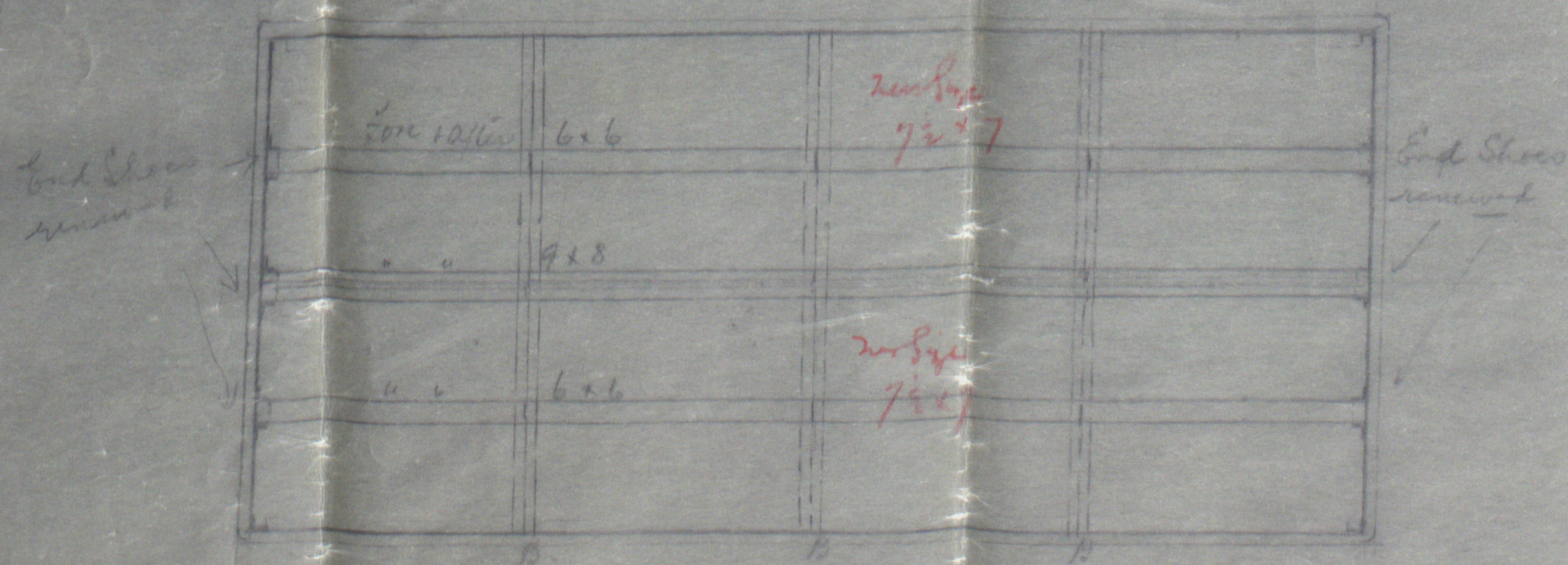

## Nº 2 HATCH BRIDGE DECK

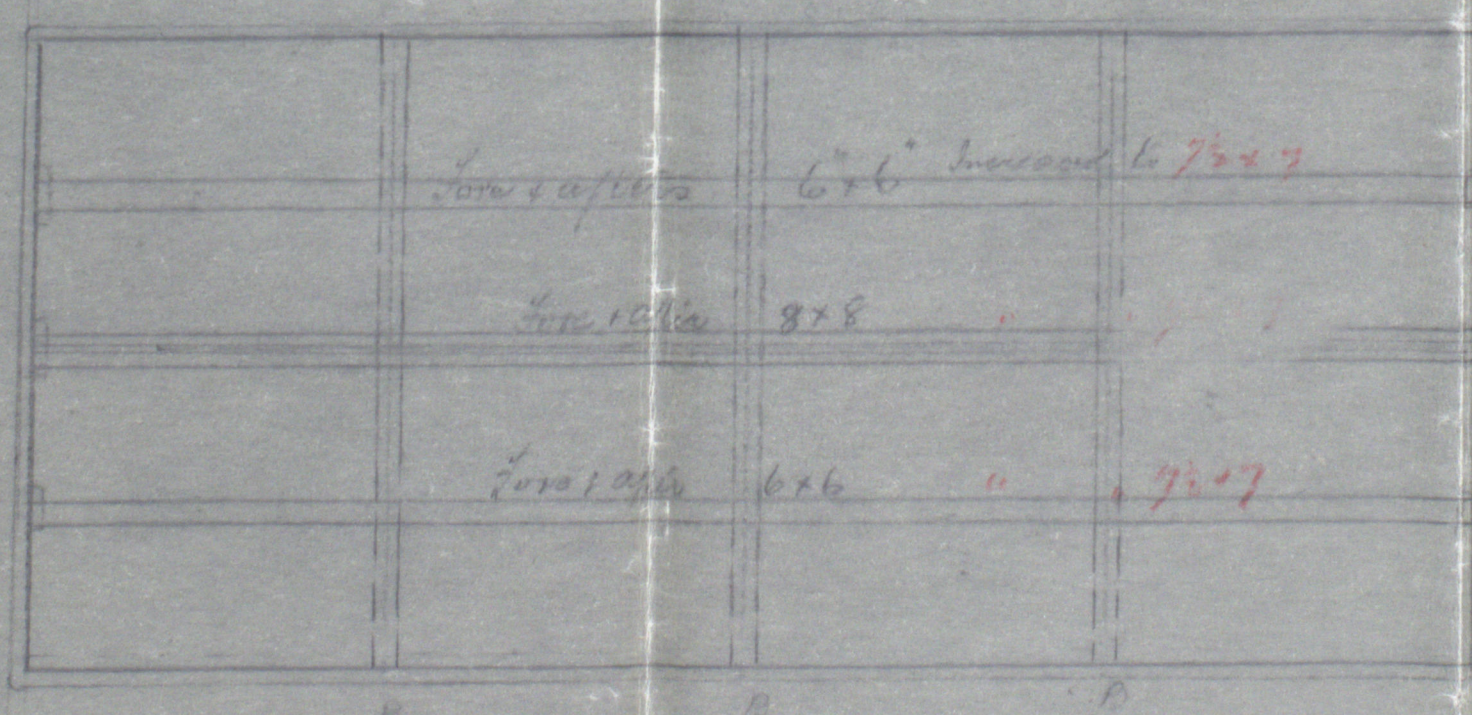

## PRESENT SECTION OF BEAMS ALL HATCHES

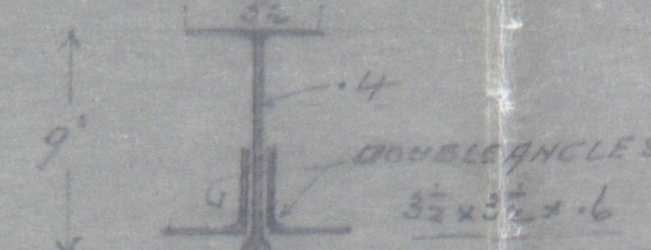

SKETCH SHOWING PROPOSED WEB TO BE ADJ. TO MEET CONVENTION REQUIRE

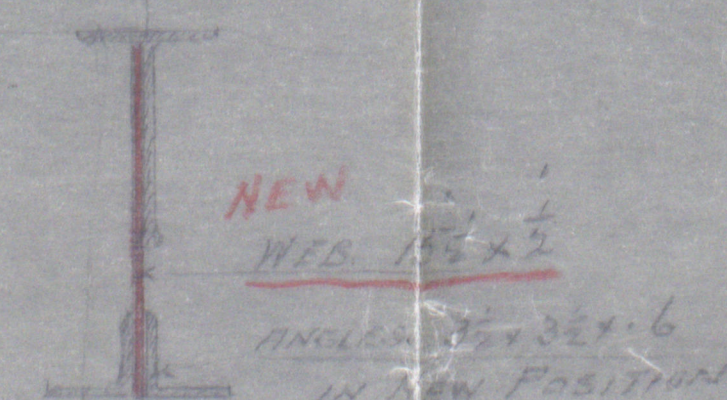

## Nº 2 HATCH UPPER DECK

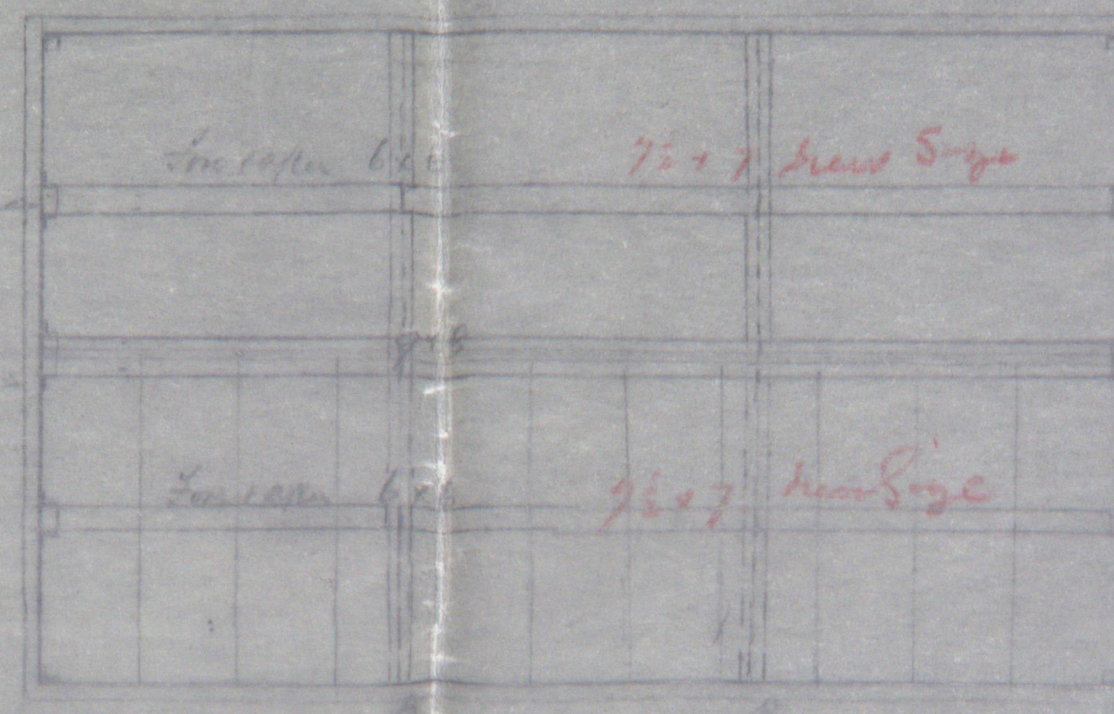
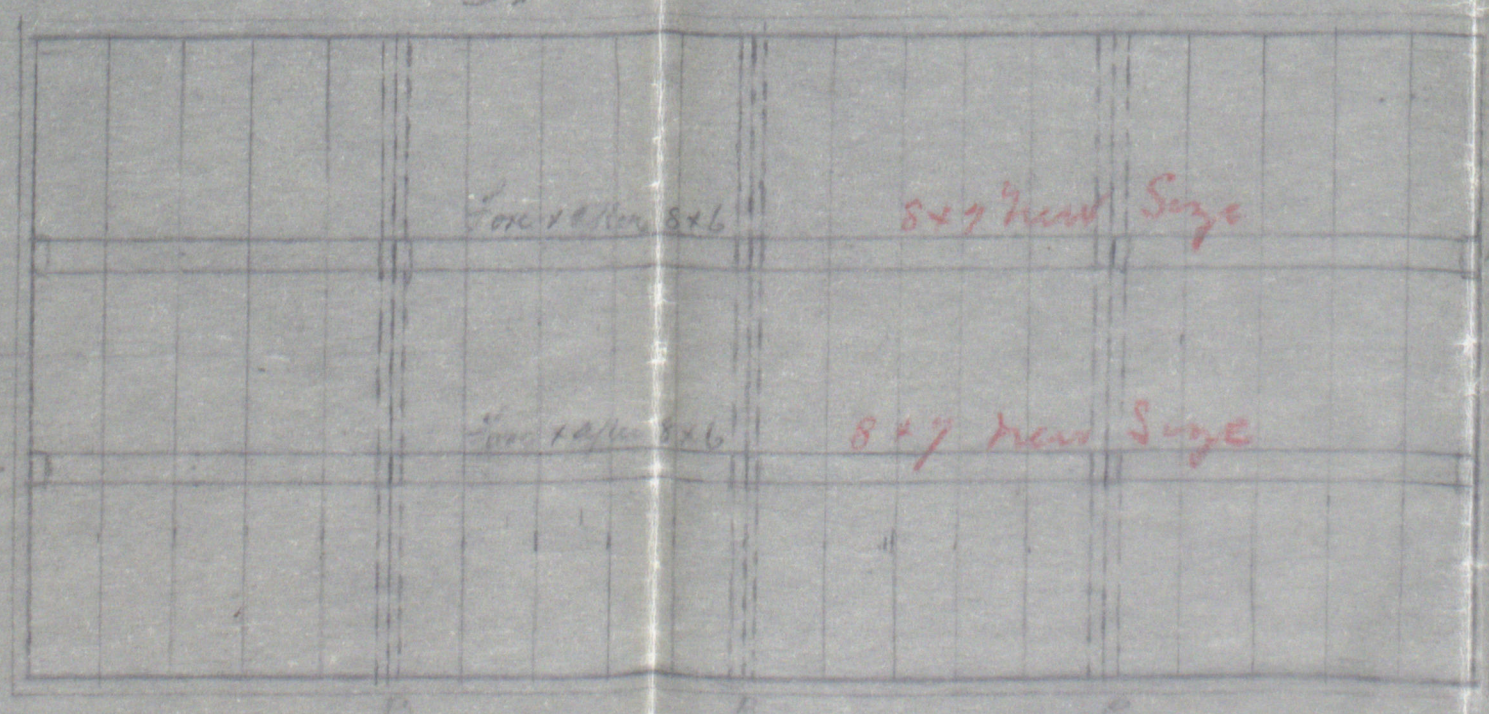

## S. S. LEO

## PROPOSED ARRANGEMENT OF HATCHES TO SUIT LOAD LINE CONVENTION RULES

I.E. ADDITIONAL BEAMS 1 FOR HATCH COVERS

SCALE  $\frac{1}{4} = 1 \text{ FT}$

FOR ELLERMAN'S WILSON LINE, LIMITED.

August 8/1932

## SECTION OF HATCH BEAMS Nº 2 + F.

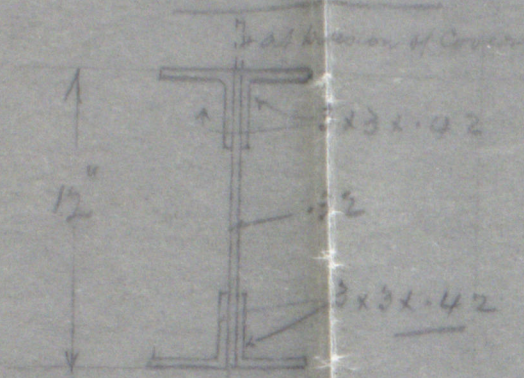

## SECTION AT Nº 1

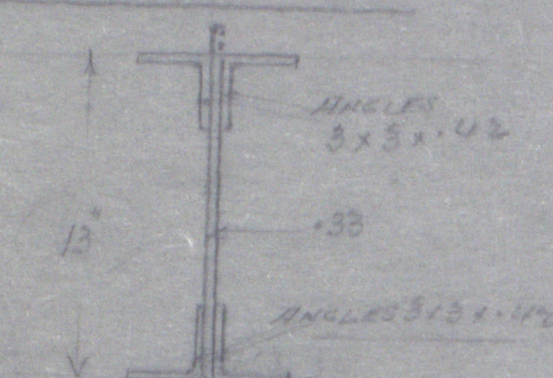

## Nº 4 HATCH QUARTER DECK

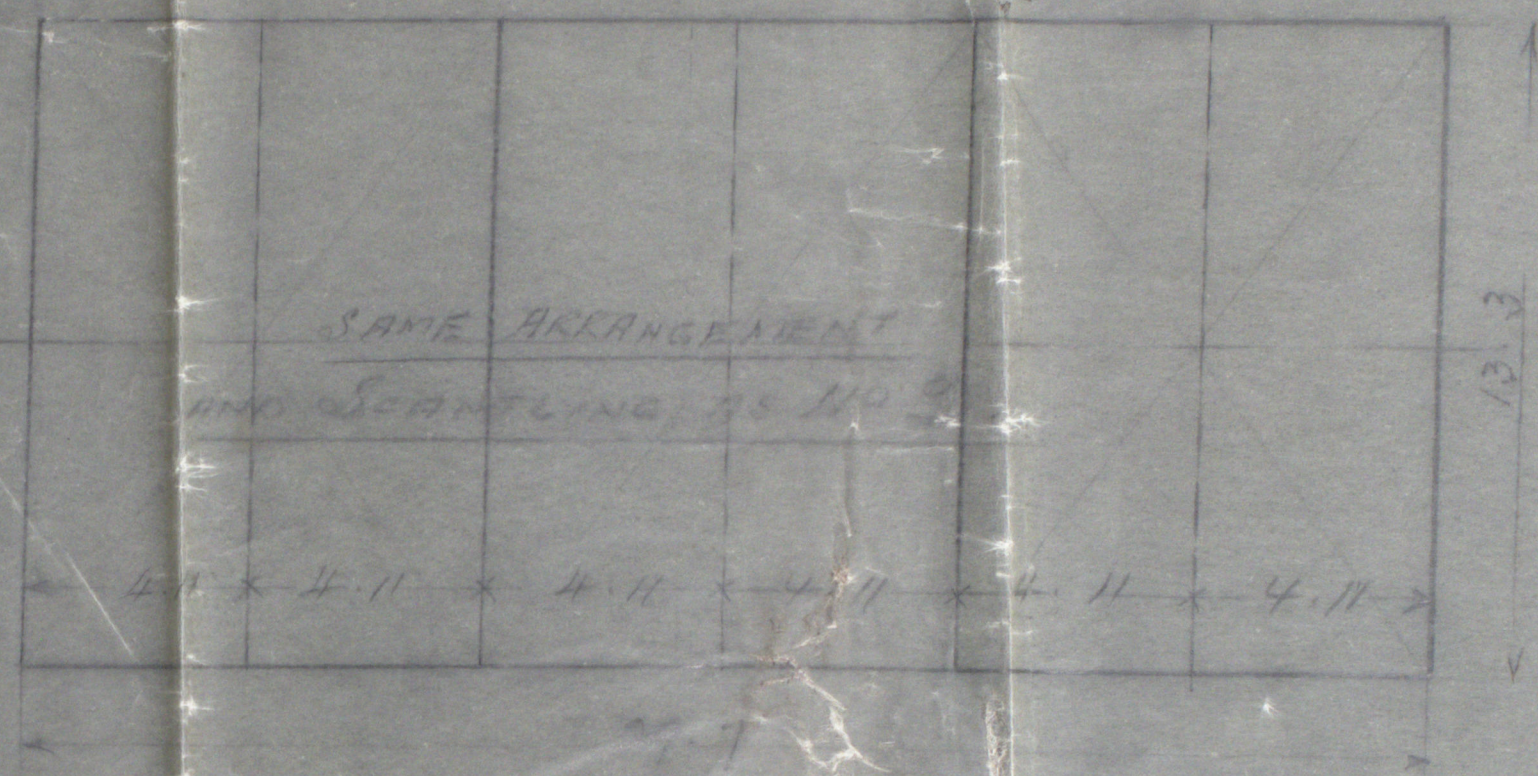

## Nº 2 HATCH UPPER BRIDGE DECK

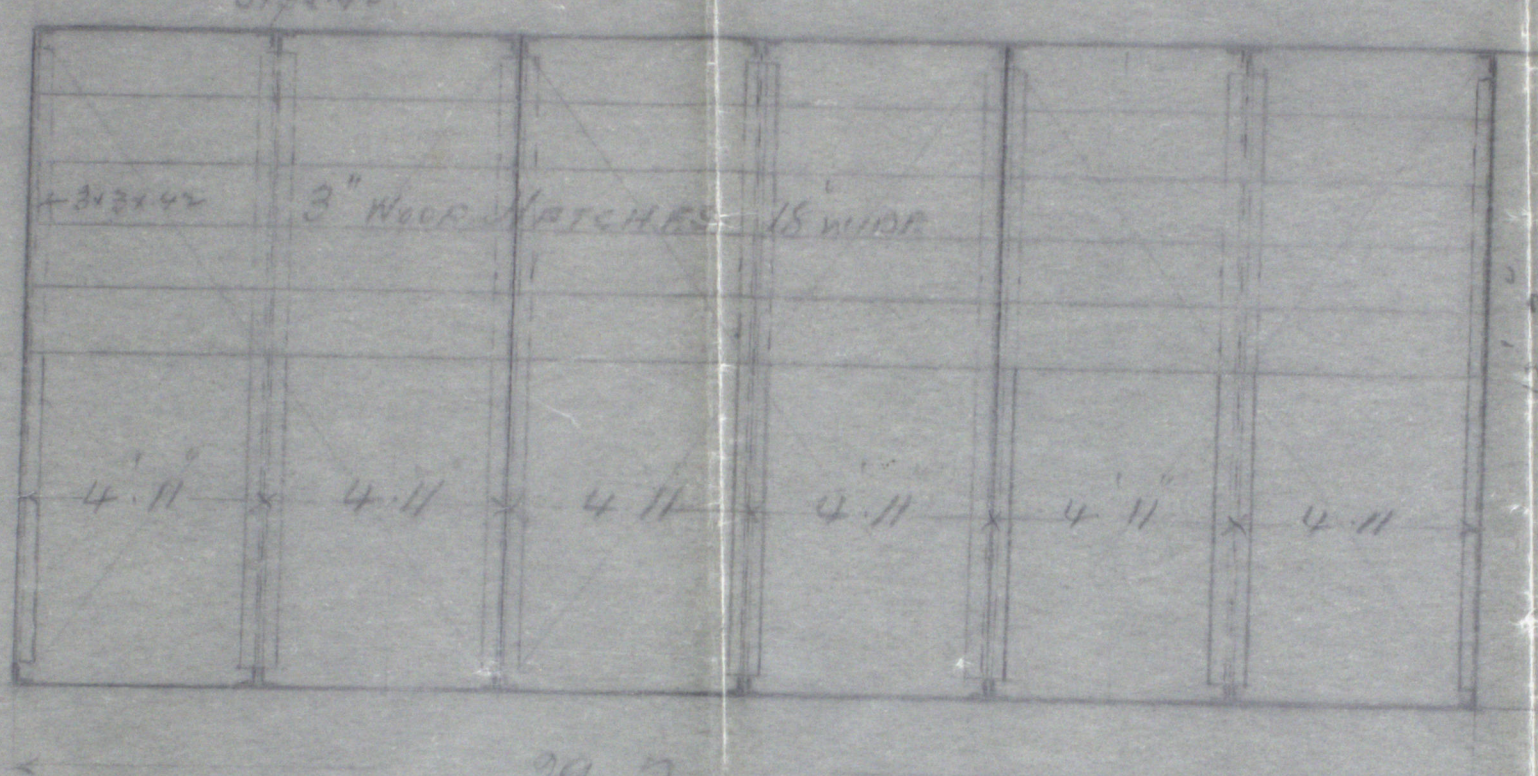

## Nº 1 HATCH

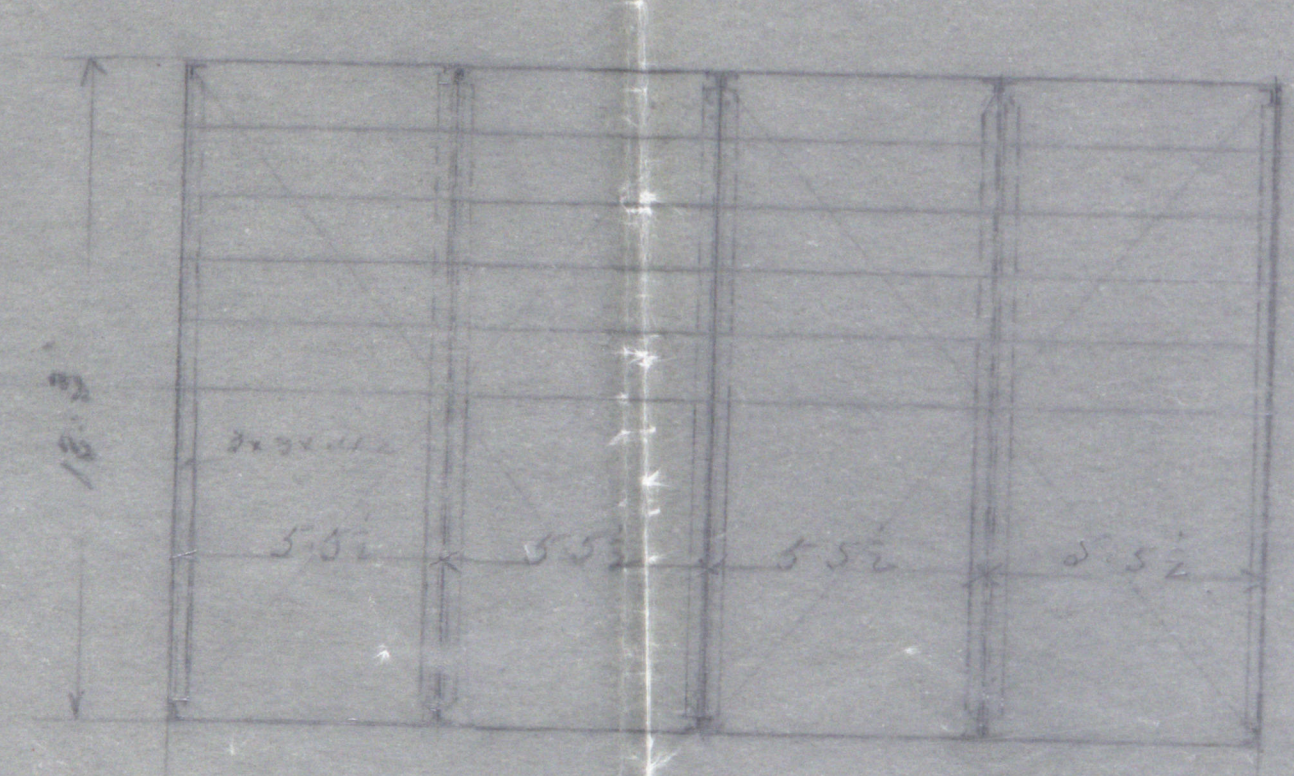



Leo

Alterations to Hatchway  
beams on account of  
Freeboard Regulations;

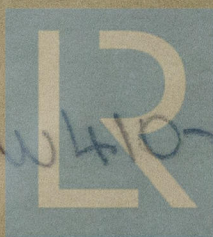

© 2019

W410-0157

Lloyd's Register  
Foundation