

Lloyd's Register
Foundation

Csarda

W409-0127 $2\frac{1}{2}$

None.

Stakehold gratings covered by strong hinged steel covers
Funnel and Fidler ventilation in good condition
E.R. Skylight of steel - strongly constructed.

None.

One strong steel companion on ports sh. with strong hinged wood door
3'-8" x 23" wide operated from both sides. -

Freecall Sh.: One 6" dia, 18" Creamy, .25" thick & F. Peak
 One 15" dia 36" " .38 " N°1 Hord.
 For well.: One 15" dia 36" " .38 " N°1 Hord.
 2 15" dia 36" " .38 " N°2 Hord.
 All nests are strongly constructed and are closed by wood plugs & canvas covers.

Freeboard Deck: One 3" dia 6' clear of deck to fore peak tank
One 3" dia 8' " " " No D.B. Tank.

Forward Well: Two 1½ dia 32' " " " N° 2 D.B. Tank.

Bridge Deck: Two 1½ dia 20' clear of deck to the room tank } fitted outside
Two 2½ " 6' 4½ " " Eng. room tank } to tanks.
Two 2 " 10' " " " N° 3 D.B. Tanks
Aft Well: Two 1½ " 32' " " " N° 4 D.B. Tank
Porto: One 4 " 6 " " " Aft peak tank

No safty holes in air pipes and no means of clearing same.

None.

There are no scupper or sanitary pipes led below the foreboard deck. ✓
Sanitary pipes led overboard above foreboard deck, through G.M. Stern
valve on ship's side. Scuppers are well led from Bridge House to
Hold Belge.

Side scuttles in poop and forecattle of substantial construction and fitted with deadlights permanently attached.

~~NOTE: 4 Deadlights in poop broken.~~

Forecastle: Open rails, 2 tier 3'-0" high stanchions 4'-9" apart.
 Bridge deck: Strong steel bulwark 3'-0" high supported by 3'-3" angle stays 5'-0" apart.
 Poop: Open rails, 2 tier, 3'-3" high, stanchions 4'-6" apart.
 are fitted in steel decks 4'-7" high supported by 6" B.P. stays, 6'-3" apart.

Substantial provision made for rigging, caulking, which
are available for use in any part of the ship
which might have to be used by the crew in the regular
evolving of the ship.

NOTE: A number of bars in I series kept bent

Particulars of Closing Appliances (state if capable of being manipulated from both sides).

Particulars of Closing Appliances (State in Caps of Being Impaired from Fire)	
Coop Bulkhead	"Strong hinged steel door operated from both sides"
Raised Quarter Deck Bulkhead	"Hinged steel door to steam engine room - operated from both sides"
Bridge, After Bulkhead	"Portable steel plate closed by wedge shaped bolts - operated from outside only"
Bridge, Forward Bulkhead	"Hinged steel door secured by wedge shaped bolts & lugs - operated from outside only"
Forecastle Bulkhead	"Hinged steel door operated from outside only"
Exposed Machinery Casings on Free-board or Raised Quarter Decks	One
Exposed Machinery Casings on Super-structure Decks	"Hinged steel door operated from both sides"
Machinery Casings within Superstructures not fitted with Class I Closing Appliances	"Steel hinged doors operated from both sides"
Deckhouses on Flush Deck Ships	

Csardas

Superstructure bulkheads, trunks, deckhouses, casings, cargo and coaling hatchways, extent and thickness of sheathing on the freeboard deck, gangway, cargo and coaling ports, and any other openings, etc., which would affect the seaworthiness of the ship are to be shewn on the following sketches:—

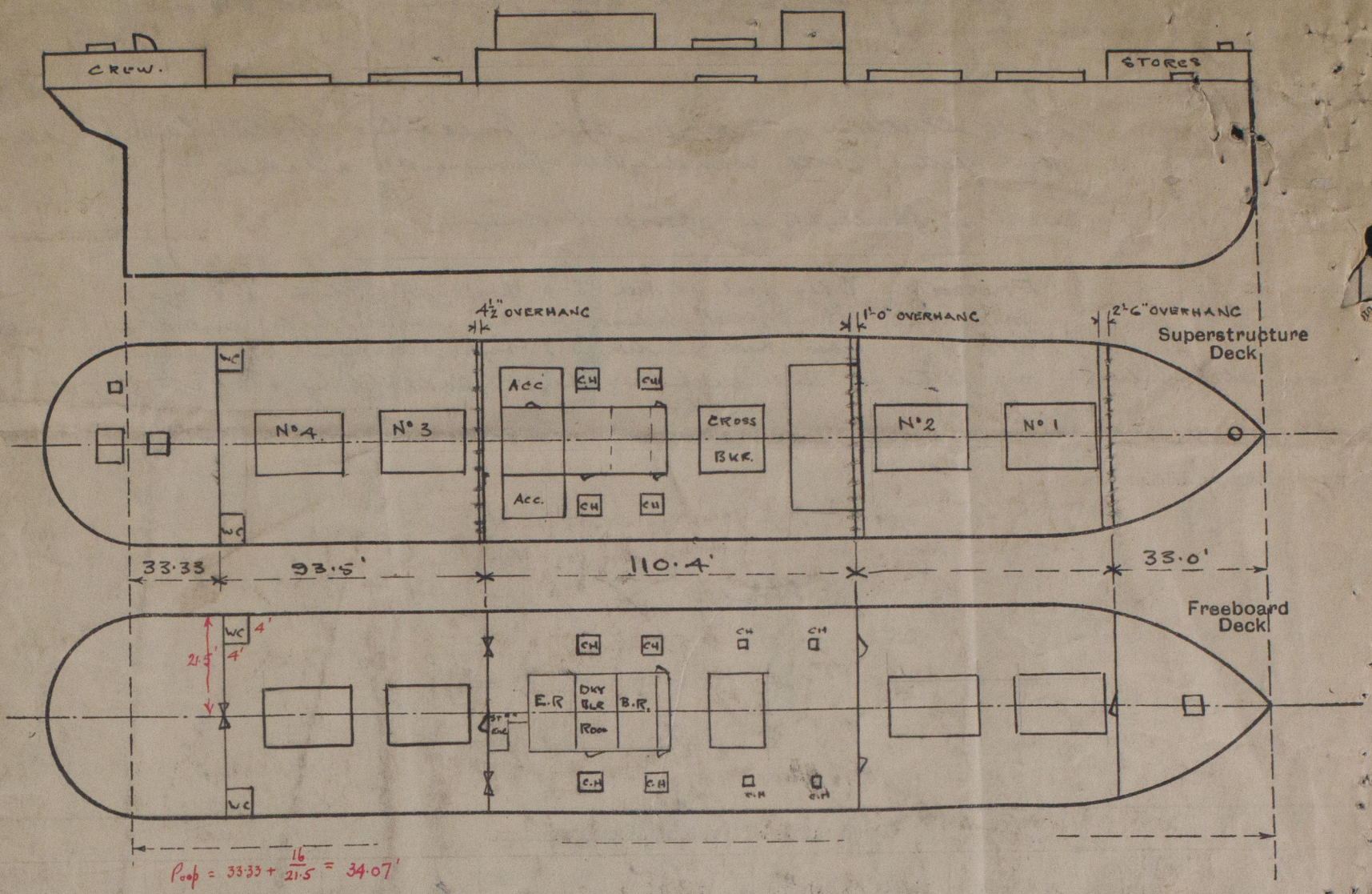

State any special features in the construction of the ship:—

Vessel surveyed for convention freeboard purposes and collision damage.

Builder name and yard number *Robert Thompson & Sons Ltd. S.S. N° 291.*

Names of sister ships

Owners *Anglo-Hungarian Shipping Co Ltd.*

Fee £ *11 : 18 : 0*

Received by me



© 2019
Lloyd's Register
Foundation

Lloyd's Register of Shipping.

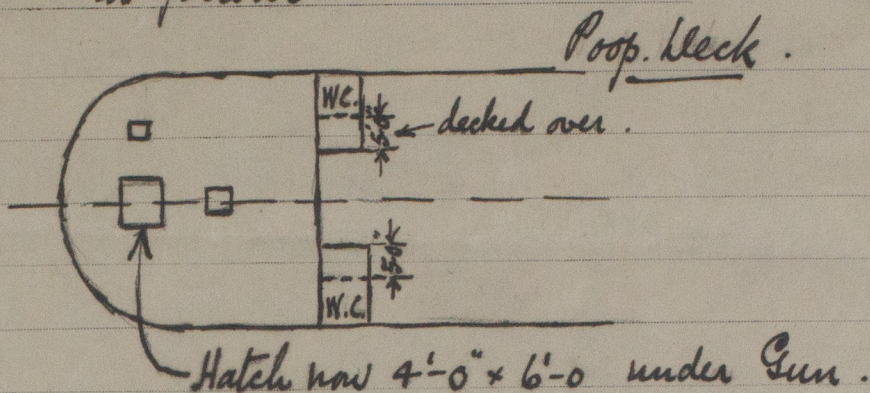
Ship's Name S.S. "Vinriver" ex "Csarda"Official No. 139456Memorandum of alterations reported since ship was surveyed for assignment of Load Lines
in as follows:-Arthur Scullard.
27.3.42.Noted Rob
30/3/42.

RETAIN

2.2.1919

Pop. Book

RETAILED

Arthur G. S. S. S.

