

Lloyd's Register of Shipping. SURVEYS FOR FREEBOARD. (CONDITIONS OF ASSIGNMENT.)

Hd 3189

Ship's Name "OAKWOOD" EX "COLIN H. LIVINGSTONE" Port of Survey LIVERPOOL

Official Number — Surveyor's Signature R. Welch & W. Robinson

Nationality and Port of Registry BRITISH, LONDON Date of Survey 10th April 1940 & Interguent

Disposition and dimensions of superstructures, trunks, deckhouses and machinery casings to be inserted in the diagrams and tabular statement:—

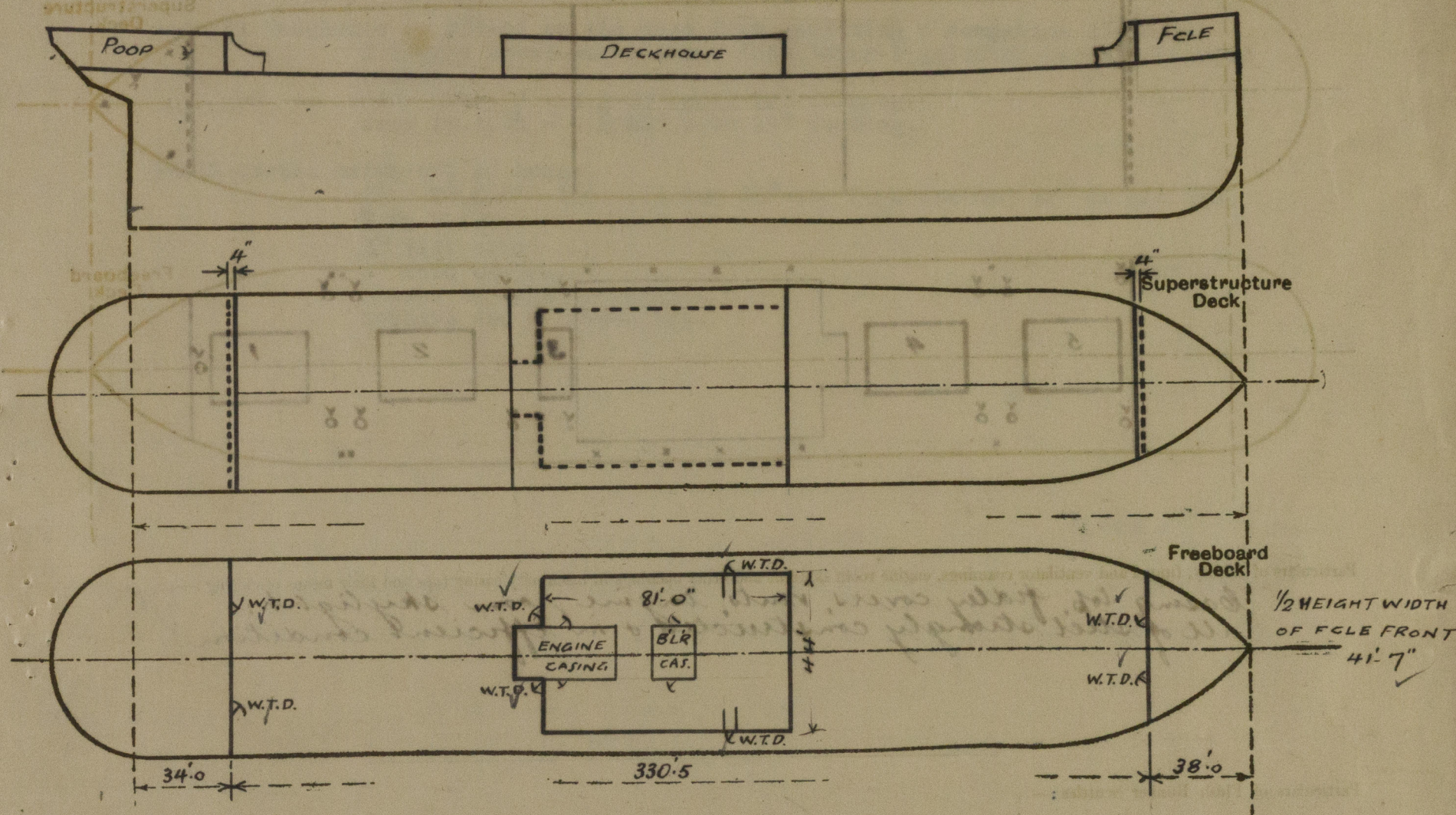

Particulars of Superstructures, Trunks, Casings, Deckhouses.

	Coaming	Plating	Stiffeners	Spacing	End Attachments of Stiffeners	Size of Openings	Height of Sills	Height of Casings
Poop Bulkhead ...	19 x 7/20	7/20	8 x 3 1/2 x 3 1/2 x 7/20 CH	30"	BKTS @ TOP & BOTTOM	2 @ 4'-8" x 24"	19"	8'-0" 7'9"
Raised Quarter Deck Bulkhead ...								
Bridge, After Bulkhead ...								
Bridge, Forward Bulkhead ...								
Forecastle Bulkhead ...	20 x 7/20	7/20	3 1/2 x 3 x 7/20	36"	BKTS @ TOP	2 @ 4'-8" x 24"	20"	7'-9" 7'6"
Trunk, Aft ...								
Trunk, Forward ...								
Exposed Machinery Casings on Freeboard or Raised Quarter Decks ...	Enclosed in strong steel deck house							
Exposed Machinery Casings on Superstructure Decks ...								
Machinery Casings within <u>DECKHOUSE</u> structures fitted with Class I Closing Appliances ...	30	30	4 x 3 x 7/20 CH	27	BKTS @ TOP	4 @ 5'-0" x 24"	18"	8'-0"
Deckhouses on Flush Deck Ships ...	7/20	7/20	cleaded?			2 @ 5'-2" x 24" (SIDES) 17" 2 @ 5'-3" x 27" (AFT) 15"		8'-0"

Particulars of Closing Appliances (state if capable of being manipulated from both sides).

Poop Bulkhead ...	2 hinged steel w. f. doors operated from both sides secured by toggles
Raised Quarter Deck Bulkhead ...	✓
Bridge, After Bulkhead ...	✓
Bridge, Forward Bulkhead ...	✓
Forecastle Bulkhead ...	2 hinged steel w. f. doors operated from both sides secured by toggles
Exposed Machinery Casings on Freeboard or Raised Quarter Decks ...	✓
Exposed Machinery Casings on Superstructure Decks ...	✓
Machinery Casings within <u>DECKHOUSE</u> structures fitted with Class I Closing Appliances ...	4 hinged steel doors operated from both sides ✓
Deckhouses on Flush Deck Ships ...	4 hinged steel w. f. doors operated from both sides secured by toggles

PARTICULARS OF PROTECTION TO OPENINGS, ETC.

The following diagrams should be used to indicate the positions of cargo and coaling hatchways, gangway, cargo and coaling ports, ventilators, companionways, etc., which would affect the seaworthiness of the ship:—

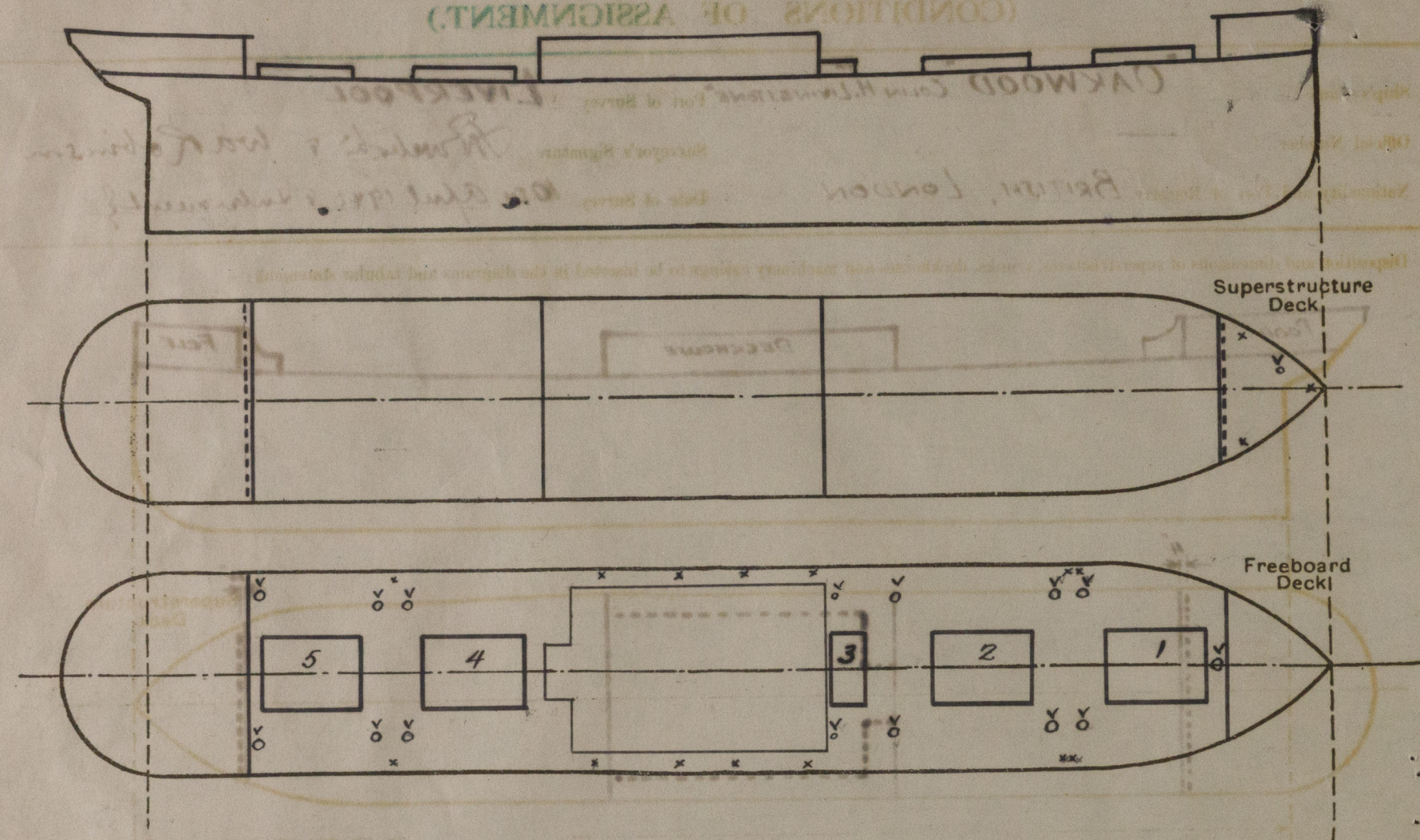

Particulars of fiddle, funnel and ventilator coamings, engine room skylight and other openings in machinery casing tops and their means of closing:—

Casing top, fiddle covers, vents, engine room skylight: all of steel strongly constructed & in efficient condition.

Toggle of stone covers to free

Particulars of Flush Bunker Scuttles:—

Particulars of Companionways:—

Deck House on poop. Companionway with 2 hinged steel w.t. doors with latches operated from both sides. Door aft 5'-0" x 1'-22" with 16" coaming. Door fore 5'-0" x 1'-24" with 16" coaming.

Particulars of Ventilators in exposed positions on freeboard and superstructure decks:—

Jch - 1 @ 12" diam x 3'-0" coaming. Main Dk. fwd - 1 @ 24" x 10'-0" x 3'-3". Main Dk. aft - 2 @ 12" x 4'-0" x 3'-3". Poop - 10 @ 10" x 15" coaming.

Particulars of Air Pipes in exposed positions on freeboard, raised quarter, or superstructure decks:—

On Jch - 1 @ 3 1/2" diam. 3'-0" to top, 2'-6" to mouth. Fore Dk - 4 - 3" x 3'-9" x 3'-0". Abreast house - 8 - 3" x 3'-9" x 3'-0". Aft. Dk - 2 - 3" x 3'-9" x 3'-0". Poop - 2 - 3" x 2'-10" x 2'-7".

Closing appliances

Particulars of Gangway Cargo and Coaling Ports:—

Particulars of Scuppers and Sanitary Discharge Pipes:—

Foreboard deck scuppers - Collinson type through deck & shell. All sanitary & discharge pipes fitted with storm valves just above 2nd Deck.

Particulars of Side Scuttles:—

In forecath & poop spaces fitted with hinged deadlights of substantial construction. Main light to remain.

Vertical distance of Sill of lowest Side Scuttle above top of keel

all above foreboard deck

Particulars of Guard Rails:—

Jch - 3'-6" high, open rails 3 rods, stanchions 4'-9" apart. Main Dk - 3'-6" high, open rails 3 rods, stanchions 4'-6" to 5'-0" apart with steel bulwarks 8'-0" long at jch front & poop front. Poop - 3'-6" high open rails, 2 rods, stanchions 4'-9" apart.

Particulars of Gangways, Lifelines, etc.:—

Provision made for regaining lifelines in accordance with regulation.

Particulars of Freeing Arrangements.

	Length of Bulwark	Height of Bulwark	Size of Freeing Ports	Number each side	Area each side	Rule area each side
After Well			none			
Forward Well			none			

State position of each freeing port ... (After Well:—) (F. and A. position and height above deck edge) (Forward Well:—)

State whether the freeing ports are fitted with shutters, bars, or rails, and give particulars of such:—

Additional area where sheer is less than standard.

W389-019713/3

PARTICULARS OF PROTECTION TO OPENINGS, ETC.

HATCHWAYS ON FREEBOARD AND SUPERSTRUCTURE DECKS.										
Description of Hatchway		ON FREEBOARD DECK								
		N°1	N°2	N°3	N°4	N°5				
Dimensions of Hatchway		33' x 20'	33' x 20'	8' x 20'	33' x 20'	33' x 20'				
COAMINGS	Height above Deck	33"		33"						
	Thickness { Sides	50	as	50	as	as				
	{ Ends	44	no	44	no	no				
	Stiffeners	1. 6 x 3 1/2 x 3 1/2 x 3/8 each.	no	6 x 3 1/2 x 3 1/2 x 3/8 each. & 1 stay on fore end	no					
HATCH BEAMS	Number	5		1						
	Spacing	6' 6"								
	Scantling and Sketch	4 x 3 x 3/8 20 x 3/8 Should be 2 1/2"	as no	as N°1.	as no	as no				
	Bearing Surface	3 1/2		3 1/2						
FORE AND AFTERS	Number									
	Spacing									
	Unsupported Lengths									
	Scantling* and Sketch									
HATCH COVERS	Material	W.P.								
	Thickness	3"	as	as	as	as				
	How fitted	F&A	no	no	no	no				
	Bearing Surface	4 x 3 1/2								
Spacing of Cleats		24"	24"	24"	24"	24"				
Number of Tarpaulins		2	2	2	2	2				
<p>*Are wood fore and afters steel shod at all bearing surfaces? <input checked="" type="checkbox"/> yes</p> <p>Are battens and wedges efficient and in good condition? <input checked="" type="checkbox"/> yes</p> <p>Are tarpaulins in good condition and in accordance with rule requirements? <input checked="" type="checkbox"/> yes</p> <p>Are lashings provided in accordance with rule requirements? <input checked="" type="checkbox"/> yes, fittings for same.</p>										

Particulars of any special features:— ☒ Small access hatchway on poop aft. of new deck house 14'-0" x 3'-1 1/2" Coaming 2 1/2" at fore end and 18" at after end. 8/20 thick 3" rest bars. 3" wood covers. Cleats 2 1/2" x 18" apart battens & 2 trips.

Endorsement at first survey and at surveys for renewal of Certificate:—

The fittings and appliances are in accordance with the particulars shown on this form (or as now modified) and are in good condition.

See Provisional Cert. issued in Philadelphia



© 2020
Lloyd's Register
Foundation

Lloyd's Register of Shipping.

74d 3228

Ship's Name "OAKWOOD"

Official No.

Memorandum of alterations reported since ship was surveyed for assignment of Load Lines
in

Poop deck particulars - steel.

10 ventilators - 10" diam, 15" coamings all strongly constructed.
2 air pipes 2- 10 to top, 2 - 1 to mouth, 3" diam.
1 -do- 3 - 0 to top 2 - 6 to mouth 3 1/2" diam.

A small deckhouse is fitted on the poop deck enclosing a companion having:-
2 hinged steel water tight doors with toggles operated from both
sides.
door aft - 5 - 0 X 22" with 18" coaming.
door (p.s.) 5 - 0 X 24" with 18" coaming.

Small access hatch aft of house.

4' - 0" X 3' - 1 1/2", coaming 21" at fore end and 18" at aft end
8/20 thick.
3" rest bars.
3" wood covers.
cleats 26" and 18" apart.
battens and 2 tarpaulins.

Noted on Rpt. 11

S.W.S.
6/5/40W.A. Robinson
Liverpool
2nd May 40