

# Lloyd's Register of Shipping.

## SURVEYS FOR FREEBOARD.

10 JUN 1932

how named Coast Wing (8/2/40)  
how of London. & Bros. - 861.98 (28/8/37)

Computation of Freeboard for Steamer, Sailing Ship, Tanker

having R.O.D. BRIDGE - FORECASTLE.

Port of Survey NEWCASTLE - ON - TYNE

SURREY BROOK

(Type of Superstructures.)

Date of Survey 8<sup>TH</sup> JUNE /32

Ship's Name

Nationality and Port of Registry

Official Number

Gross Tonnage

Date of Build

AYRESOME

British

142362

859

1916-4

MIDDLESBROUGH.

Name of Surveyor John A. Lawson.

Moulded Dimensions: Length 180.00' Breadth 30.00' Depth 14.00'

Moulded displacement at moulded draught = 85 per cent. of moulded depth 1480. tons

Coefficient of fineness for use with Tables .806

Particulars of Classification + 100.A.1.

20.5-1228.

## Depth for Freeboard (D)

Moulded depth ... .. 14.00'

Stringer plate ... .. .03'

Sneathing on exposed deck

$$T \left( \frac{L-S}{L} \right) =$$

Depth for Freeboard (D) =

14.03'

## Depth correction

(a) Where D is greater than Table depth  
(D-Table depth) R = (14.03-12.00) 1.385'  
= 2.03 x 1.385 = 2.81'(b) Where D is less than Table depth (if allowed)  
(Table depth-D) R =

If restricted by superstructures

## Round of Beam correction

Moulded Breadth (B)

$$\text{Standard Round of Beam} = \frac{B \times 12}{50} = 7.2'$$

$$\text{Ship's Round of Beam} = 7.2'$$

Difference

Restricted to

$$\text{Correction} = \frac{\text{Diff}}{4} \times \left( 1 - \frac{S_1}{L} \right) = \frac{3}{4} (2.158) = .02'$$

## DEDUCTION FOR SUPERSTRUCTURES.

	Mean Covered Length (S)	Equivalent Enclosed Length (S <sub>1</sub> )	Height	Height Correction	Effective Length (E)
Poop enclosed ... ..					
" overhang ... ..					
R.Q.D. enclosed ... ..	108.16	108.16	4.50	4.46	108.16
" overhang ... ..					
Bridge enclosed ... ..	12.83	12.83	10.0		12.83
" overhang aft ... ..					
" overhang forward ... ..					
Fore enclosed ... ..	20.16	20.16	7.0		20.16
" overhang ... ..					
Trunk aft ... ..					
" forward ... ..					
Tonnage opening aft ... ..					
" forward ... ..					
Total ... ..	141.15	141.15			141.15

Standard Height of Superstructure 6.0'

" " R.Q.D. 3.53'

Deduction for complete superstructure 24.0'

Percentage covered  $\frac{S}{L} = 78.42\%$ " "  $\frac{S_1}{L} = 78.42\%$ " "  $\frac{E}{L} = 78.42\%$ Percentage from Table, Line A. 73.35%  
(corrected for absence of forecastle (if required))Percentage from Table, Line B.  
(corrected for absence of forecastle (if required))

Interpolation for bridge less than 2L (if required)

Deduction = 17.60'

## SHEER CORRECTION.

Station	Standard Ordinate	S M	Product	Actual Ordinate	Effective Ordinate	S M	Product
A.P. ... ..	28.0	1	28.00	34	34.0	1	34.00
1/4 L from A.P. ... ..	12.46	4	49.84	14 1/2	14.25	4	57.00
1/2 L " ... ..	3.08	2	6.16	8 1/2	8.50	2	17.00
Amidships ... ..		4				4	
3/4 L from F.P. ... ..	6.16	2	12.32	8 1/4	7.70	2	15.40
1/4 L " ... ..	24.92	4	99.68	31 1/4	30.81	4	123.24
F.P. ... ..	56.0	1	56.00	62	62.0	1	62.00
Total ... ..			252.00				345.52

$$\text{Correction} = \frac{\text{Difference between sums of products}}{18} \left( .75 - \frac{S}{2L} \right) =$$

If limited on account of midship superstructure.

If limited to maximum allowance of 1 1/2 ins. per 100 ft.

## Deduction for Tropical Freeboard.

## Addition for Winter and Winter North Atlantic Freeboard.

R.Q.

Depth to Freeboard Deck = 13.53'

Summer freeboard = 4.92'

Moulded draught (d) = 13.61'

## Deduction for Tropical freeboard and addition for

Winter freeboard =  $\frac{d}{4}$  inches = 3.40 = 3 1/2

## Addition for Winter North Atlantic Freeboard (if

required = 5.40 = 5 1/2

## Deduction for Fresh Water.

Displacement in salt water at summer load water line

Δ =

Tons per inch immersion at summer load water line

T =

Deduction =  $\frac{\Delta}{40 T}$  inches

= 3 1/2

## TABULAR FREEBOARD corrected for Flush Deck (if required)

Correction for coefficient

$$\frac{806 + 68}{1.36} = \frac{1.426}{1.36}$$

Depth Correction ... .. 2.81'

Deduction for superstructures ... .. 17.60'

Sheer correction ... .. 1.86'

Round of Beam correction ... .. .02'

Correction for Thickness of Deck amidships ... ..

Other corrections, scantlings, etc. ... .. R.O.D.

54.00

56.81 19.48 + 37.85

Summer Freeboard = 58.96'

## SUMMER FREEBOARD amidships from Centre of Disc to top of Deck Line, Wood, Steel, Deck:—

Tropical Fresh Water Line above Centre of Disc ... .. 6 1/2

Fresh Water Line " " " " " " 3 1/2

Tropical Line " " " " " " 3

Winter Line below " " " " " " 5 1/2

Winter North Atlantic Line " " " " " " 5 1/2

Tropical Fresh Water Freeboard ... .. 4-4 1/2

Fresh Water " " " " " " 4-3 1/2

Tropical " " " " " " 4-3 1/2

Winter " " " " " " 5-2 1/2

Winter North Atlantic " " " " " " 5-2 1/2



# PARTICULARS OF PROTECTION TO OPENINGS, ETC.

HATCHWAYS ON FREEBOARD AND SUPERSTRUCTURE DECKS									
			FREEBOARD DECK	R&Q D.	BRIDGE	FORE DECK	FREEBOARD DECK	CASING TOP	
Description of Hatchway			Nº 1	Nº 2.	2 OFF. 7'-4" x 5'-2"	To STORE.	To C. LOCKER. IN CROWN SPACE.	COAL HATCH.	
Dimensions of Hatchway			29'-6" x 21'-0"	33'-10" x 21'-0"		1'-6" x 1'-7"	1'-6" x 1'-6"	3'-6" x 13'-7"	
COAMINGS	{	Height above Deck	39	39	18" ABOVE WOOD.	8" ABOVE WOOD.	1" ABOVE WOOD DECK.	22" ABOVE CASING.	
		Thickness	.50	.54	.36	.25	.25	.36	
		Sides	.44	.40	.36	.25	.25	.36	
		Stiffeners	6" BA	6" BA.	✓	✓	✓	✓	
		Brackets, Stays	✓	✓	✓	✓	✓	✓	
HATCH BEAMS	{	Number	5	6	✓	✓	✓	✓	
		Spacing	4'-10"	4'-10"					
		Scantling and Sketch	27"-22" 40 4 x 3 x 40 ANGLES	27"-22" 40 4 x 3 x 40 ANGLES.	✓	✓	✓	✓	
		Bearing Surface	3½	3½	✓	✓	✓	✓	
FORE AND AFTERS	{	Number	✓	✓	✓	✓	✓	✓	
		Spacing	✓	✓	✓	✓	✓	✓	
		Unsupported Lengths	✓	✓	✓	✓	✓	✓	
		Scantling* and Sketch	✓	✓	✓	✓	✓	✓	
		Bearing Surface	✓	✓	✓	✓	✓	✓	
HATCH COVERS	{	Material	W.P.	W.P.	W.P.	STEEL PL.	STEEL PL.	W.P.	
		Thickness	3	3	2½"	¼"	¼"	2½"	
		How fitted	F.A.	F.A.	HINGED.			F.A.	
		Bearing Surface	2¾ x 4	2¾ x 4	2"	✓	✓	2"	
Spacing of Cleats			24	23	23	2 HINGES	4 Toggles.	24	
Number of Tarpaulins			3	3	3	2 Toggles.	W.T.	2	
<p>*Are wood fore and afters steel shod at all bearing surfaces? ✓</p> <p>Are battens and wedges efficient and in good condition? YES ✓</p> <p>Are tarpaulins in good condition and in accordance with rule requirements? YES.</p> <p>Are lashings provided in accordance with rule requirements? YES. ✓</p>									

Particulars of fiddle, funnel and ventilator coamings:— FIDDLE GRATINGS COVERED BY STRONG HINGED COVERS OF STEEL. ✓  
 FUNNEL AND FIDDLE VENTS IN EFFICIENT CONDITION. ✓  
 ENGINE SKYLIGHT OF STEEL STRONGLY CONSTRUCTED. ✓

Particulars of Flush Bunker Scuttles:— NONE.

Particulars of Companionways:— THROUGH WOOD DOOR AT AFT END OF CASING TO ENGRS ACCOM. ✓  
 DOOR OF HARDWOOD. ~~WE "FRAMING" PANELS 3/8" (THIS DOOR IS IN BAD CONDITION)~~  
 DOOR SILL. 18" : DOOR 5'-0" x 2'-4" ✓

Particulars of Ventilators in exposed positions on freeboard and superstructure decks:—  
 FORECASTLE DECK: 1 VENT. 11" DIA. COAMING 36" x ¼" TO HOLD. ✓  
 BRIDGE DECK: 2 " 11" " 36" x ¼" TO HOLD. ✓  
 R&Q D.: 1 " 11" " 36" x ¼" TO HOLD. ✓  
 2 G.N. VENTS. 4½" TO LIP. 9" TO BEND x 3" DIA. TO ENGRS ACCOM. ✓  
 1 " " 9" " 11" " 3" " " " ✓  
 ALL VENTS ARE IN ACCORDANCE WITH RULES AND HAVE WOOD PLUGS AND CANVAS COVERS. ✓  
 NO MEANS OF CLOSING G.N. VENTS. ✓

Particulars of Air Pipes in exposed positions on freeboard, raised quarter, or superstructure decks:—  
 Fore Deck: 1 G.N. AIR PIPE. 4" TO LIP. 8" TO BEND x 2½" DIA. TO FORE PEAK. ✓  
 Aft Well: 2 " " 21" " 27" " 2" " TO D.B. TANKS. ✓  
 1 " " \* 23" " 28" " 2" " " " ✓  
 1 " " \* 20" " 23" " 2" " " " ✓  
 1 " " 25 30. 9" " 3" " APEAK. ✓  
 AIR PIPES HAVE NO MEANS OF CLOSING. ✓  
 \* AIR PIPES HAVE NO SNIFTING HOLES. ✓

Particulars of Gangway Cargo and Coaling Ports:— NONE.





AUG 23 1937

## Lloyd's Register of Shipping.

Ship's Name Surreybrook.Official No. 142362.Memorandum of alterations reported since ship was surveyed for assignment of Load Lines  
in 8<sup>th</sup> June 1932.

RETAIN

Hold on Foreboard Deck now fitted out as crew accommodation.Hatches on Bridge Deck now deleted and 1 small hatch fitted to Starboard side 3'-7" x 3'-7" - coaming 18" x 40". 2 1/2" W.P. covers, 2 1/2" bearing surface. Cleats spaced 15" to 18" apart and 3 tarpaulins fitted.A steel coamingway .30" thick has been fitted on the port side 4'-0" high x 25 1/2" fitted with steel door 3'-9" x 25" operated from both sides.3-5" diam. ventilators and 2-5" swan neck vents (coamings 20" x 30") have been fitted to the spaces below.All vents are in accordance with the Rules and have wood plugs and canvas covers.W.C. discharge has been fitted with storm valve of substantial constructionAll side scuttles have hinged deadlights fitted and are of substantial construction.Scupper P's previously led to bilge have now been deleted.

Superstructure Deck.

Freeboard Deck

New tonnages are as follows

Gross	862
Net	566
Net.	377.64.

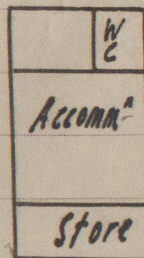
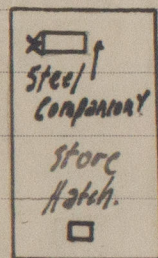

*Noted*  
*23/8/37.*

*g.h.R.*

W373-0096 2/3



BOTH SIDES ENG. <sup>RM</sup> 2020

LR Lloyd's Register Foundation



*Handwritten: Surveybook*

Superstructure bulkheads, trunks, deckhouses, casings, cargo and coaling hatchways, extent and thickness of sheathing on the freeboard deck, gangway, cargo and coaling ports, and any other openings, etc., which would affect the seaworthiness of the ship are to be shewn on the following sketches:—

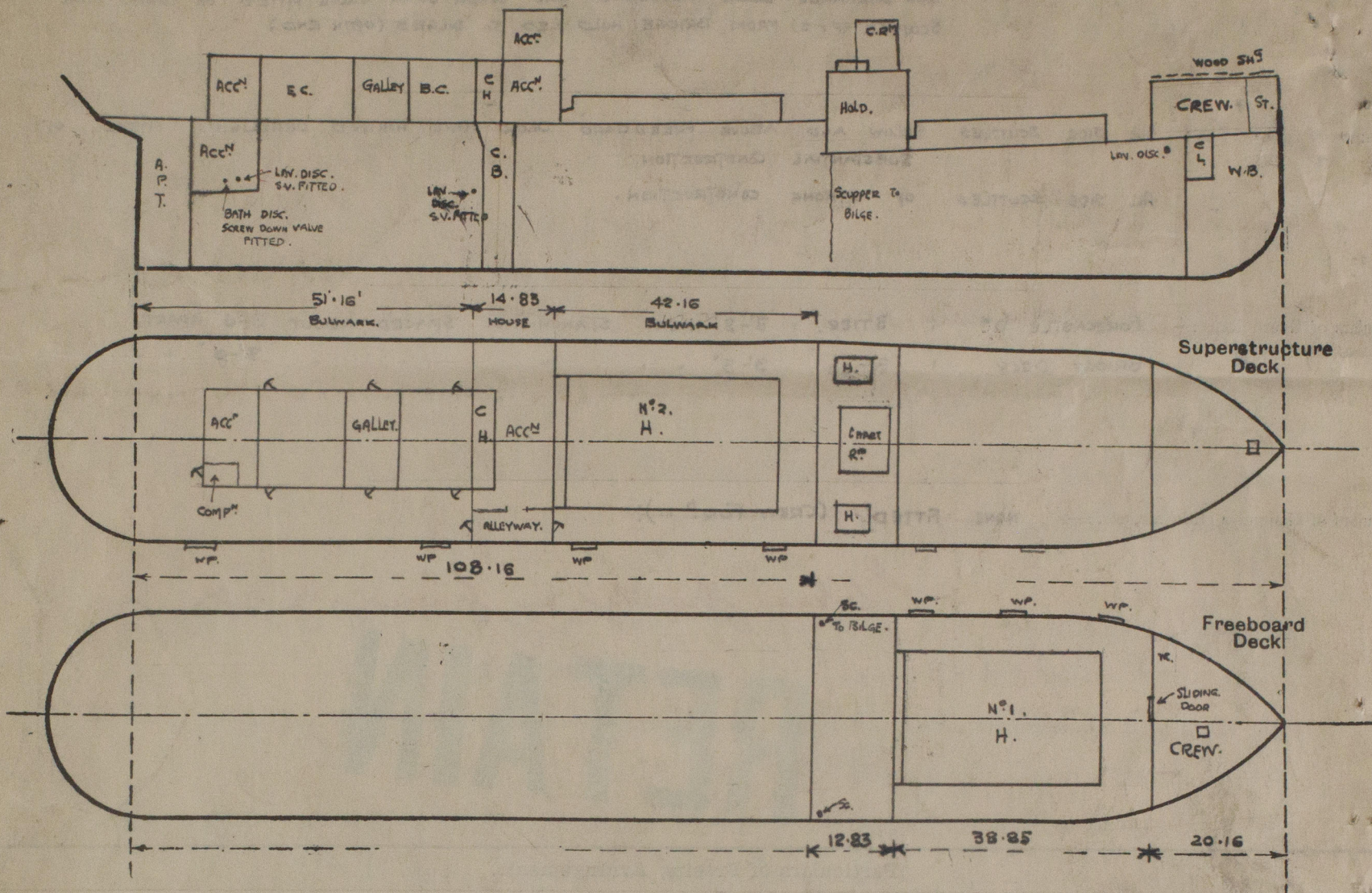

State any special features in the construction of the ship:— VESSEL EXAMINED IN DRY DOCK.

VESSEL UNDER SURVEY FOR DAMAGE AND SPECIAL SURVEY. IT IS EXPECTED SPECIAL SURVEY WILL BE COMPLETED AT THIS TIME.

TIMBER ASSIGNMENT NOT REQUIRED.

*Handwritten: gmt*

Builder's name and yard number N.V. BURGERHOUTS MSCHFB. Schip. ROTTERDAM.

Names of sister ships

Owners TYNE-TEES STEAM SHIPPING CO. LTD.

Fee £ 6 : 16 : 0

Received by me



© 2020

Lloyd's Register Foundation