

MIDSHIP SECTION
SCREW STEAMERS NO 352-5
SCALE 1/2 INCH = 1 FOOT
TO CLASS 100A

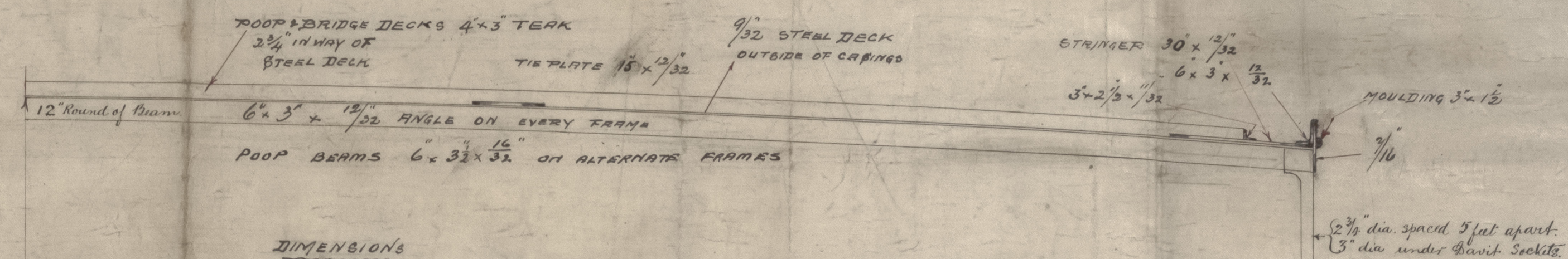
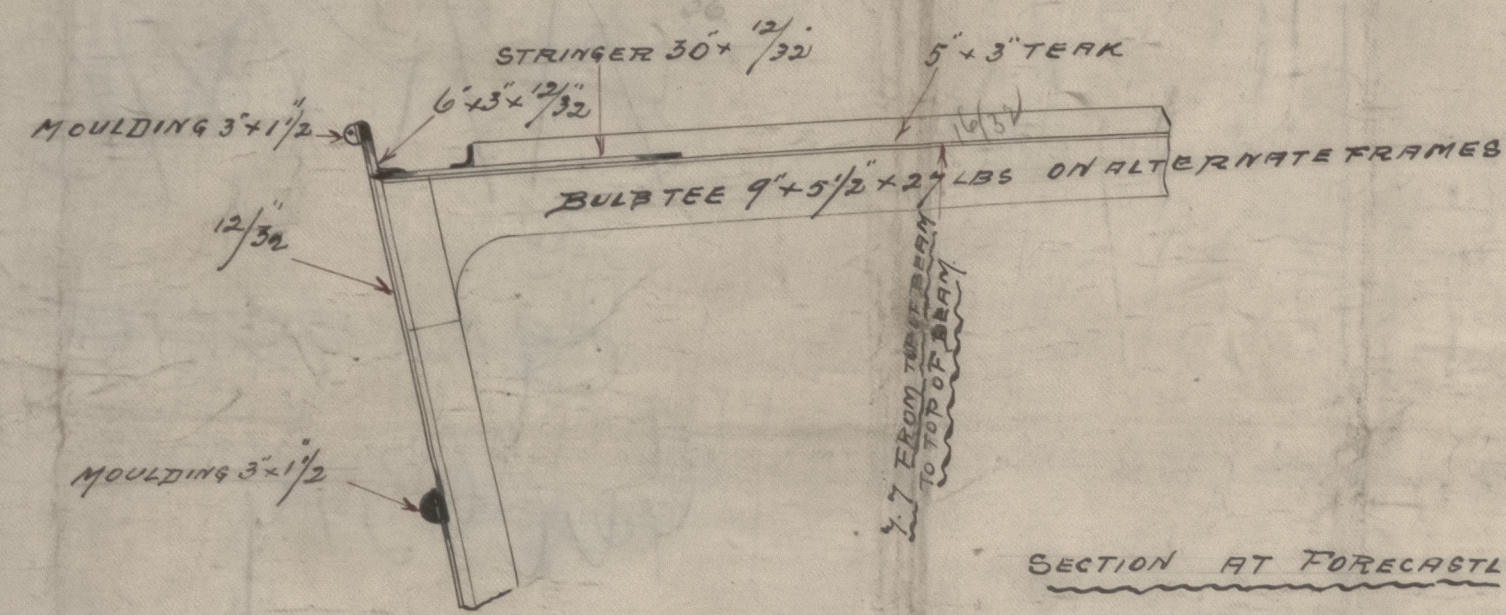

DIMENSIONS

| | |
|-------------------------------|--------|
| LENGTH BETWEEN PERPENDICULARS | 41' 0" |
| BREADTH MOULDED | 48' 0" |
| DEPTH | 33' 0" |

EQUIPMENT

| | |
|-------------------------------------|----------|
| 2 BOWER ANCHORS | 45 CWT |
| 1 " " | 43 " |
| 1 " " | 40 " |
| 1 STREAM " | 15 1/4 " |
| 1 KEDGE " | 7 1/2 " |
| 1 " " | 3 1/2 " |
| 300 FATHOMS 2 1/4" STUD CHAIN CABLE | |
| 90 " 1 1/2" STEEL CHAIN | |

UPPER DECK SHEERSTRAP, DOUBLE STRAP FOR 1/4" LENGTH (MONT) STRAP, SET WITH UPPER SHEERSTRAP, AND TABLE RIVETTED. THE REMAINING STRAPS (EXCEPT FLAT NEEL PLATE) TO BE LAPPED, BUTTED WITH NOT LESS THAN THREE COMPLETE JOINTS OF RIVETS.

RIVETTING UPPER SHEERSTRAP WITH DOUBLE BUTT STRAPS TREBLE RIVETTED FOR 1/2" LENGTH. THE THICKNESS OF THE PLATES, THE REMAINDER OF THE BUTT STRAPS ARE TO BE TREBLE RIVETTED. THE REMAINDER OF THE BUTT STRAPS ARE TO BE TREBLE RIVETTED. THE REMAINDER OF THE BUTT STRAPS ARE TO BE TREBLE RIVETTED.

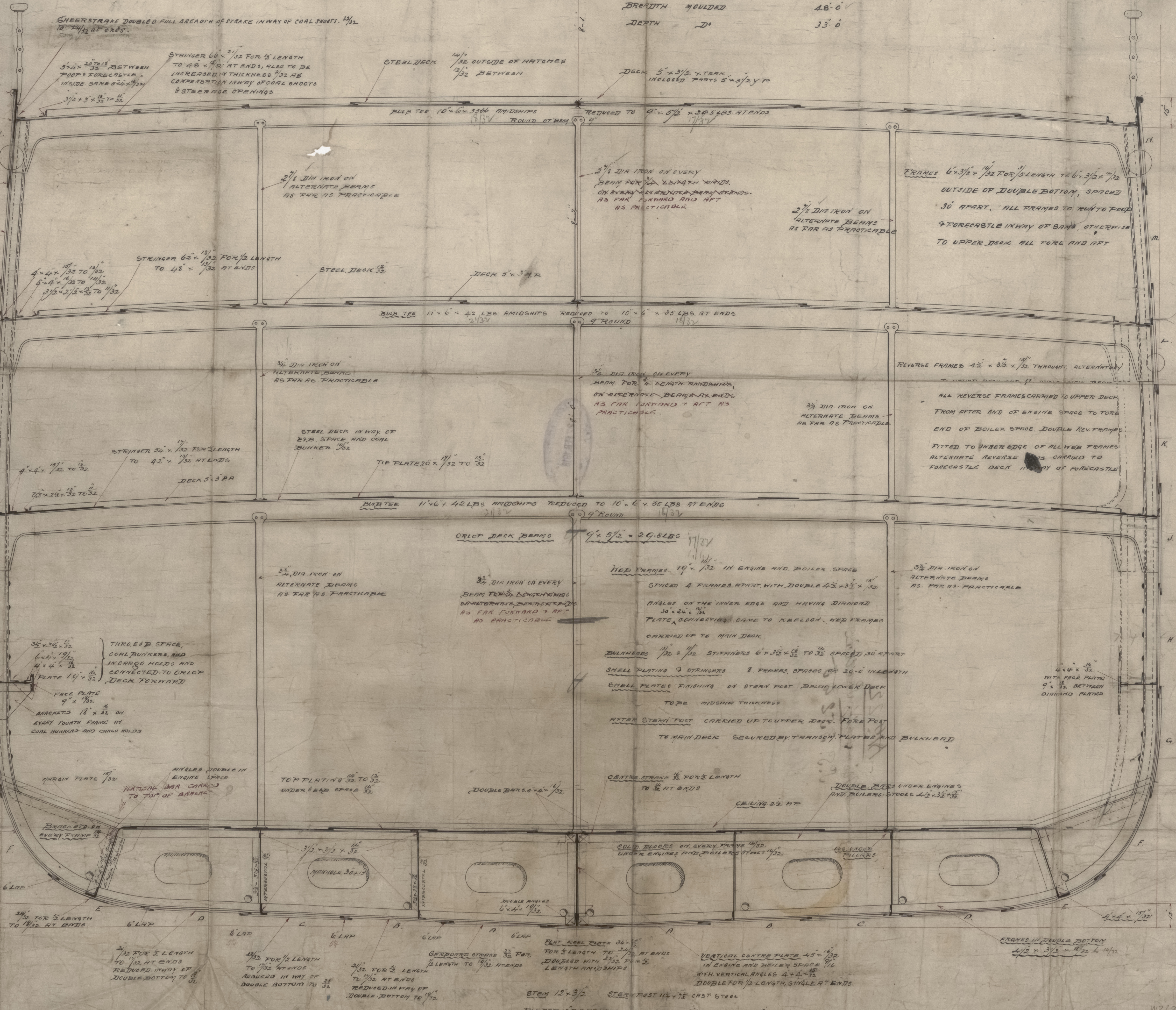
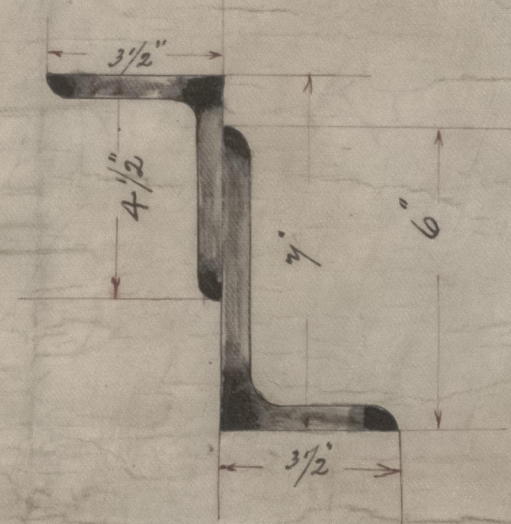

STEM 15 x 3 1/2" STEEL POST 1 1/2" x 1 1/2" CAST STEEL
RUDDER 10 INCH THICK, UPPER RIVET 5" STEEL, LOWER 4"

W363816-0033

ARMONIA

Book
400319

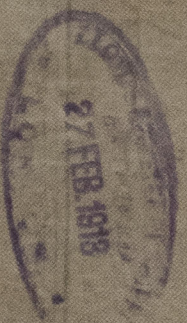

0038

Ms. A. 2.
Manuscript Book
No. 362 & 3

0033

No 22
Midship Section
S.S. 352 & 3

Virginia No 352