

T.S.S. "ORAMA"

PROPOSED MODIFICATIONS ON 'H' DECK FRAMES 147-163.

SCALES - PROFILES $\frac{1}{8}$ INCH = 1 FOOT. PLANS $\frac{1}{16}$ INCH = 1 FOOT.

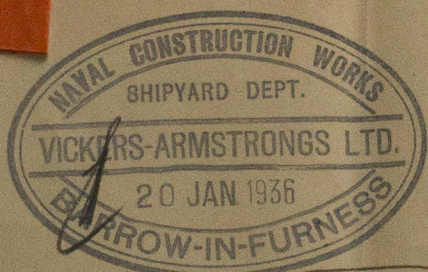

ELEVATION 8'-0" P.S.S.

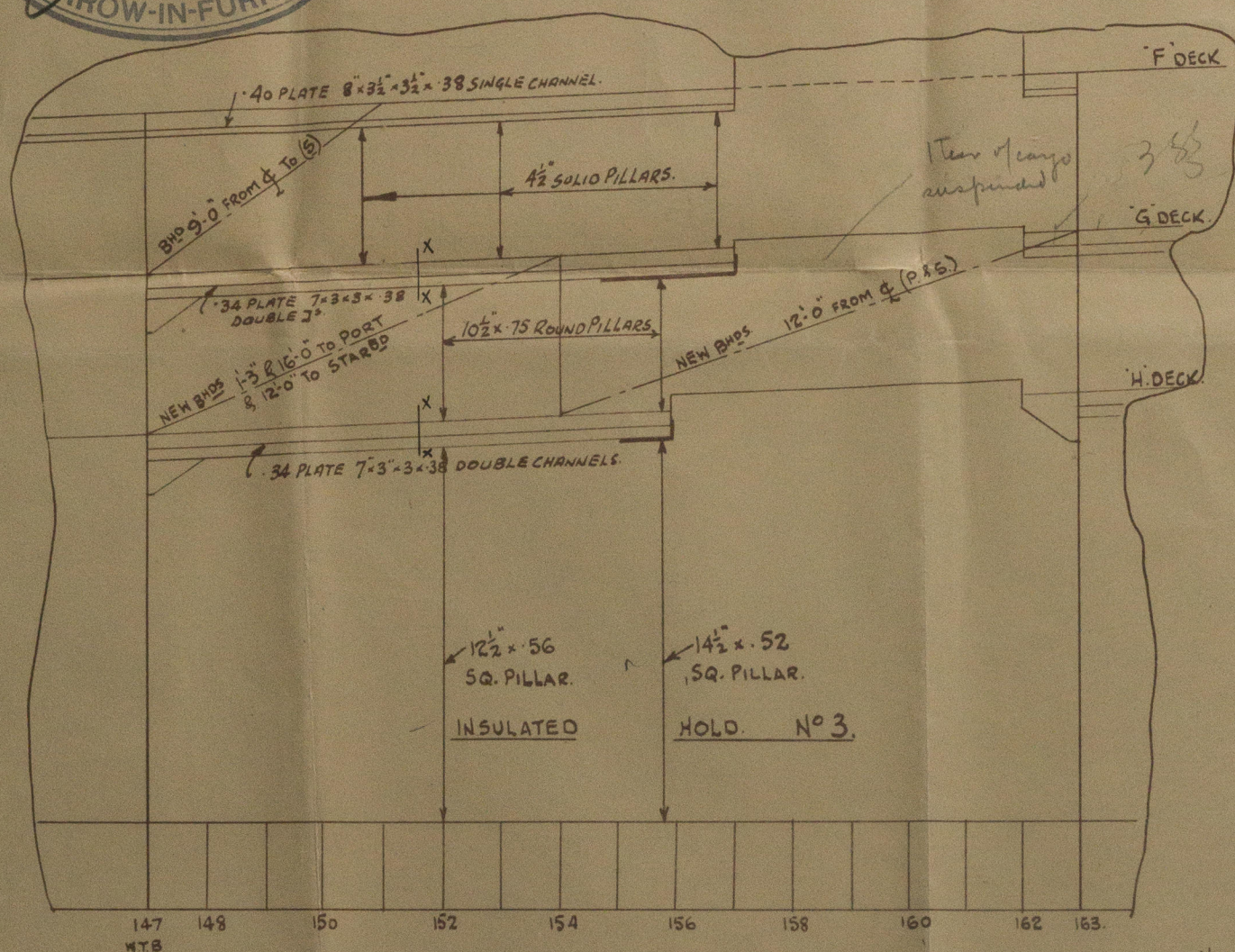

Beams 8' x 7 1/2" x 3/8" for
span not exceeding 16'-0"
+ rows of pillars
(new span 12'-0" +
beams suitable for
1 tier of chiller mgs)

4.75
18.75 = 23.3
16' = 19.9
for new span of 12'-0" $\frac{14.9}{19.9} = 75\%$
19.87
i.e. original beams of G deck suitable for 12'-0" span

G DECK

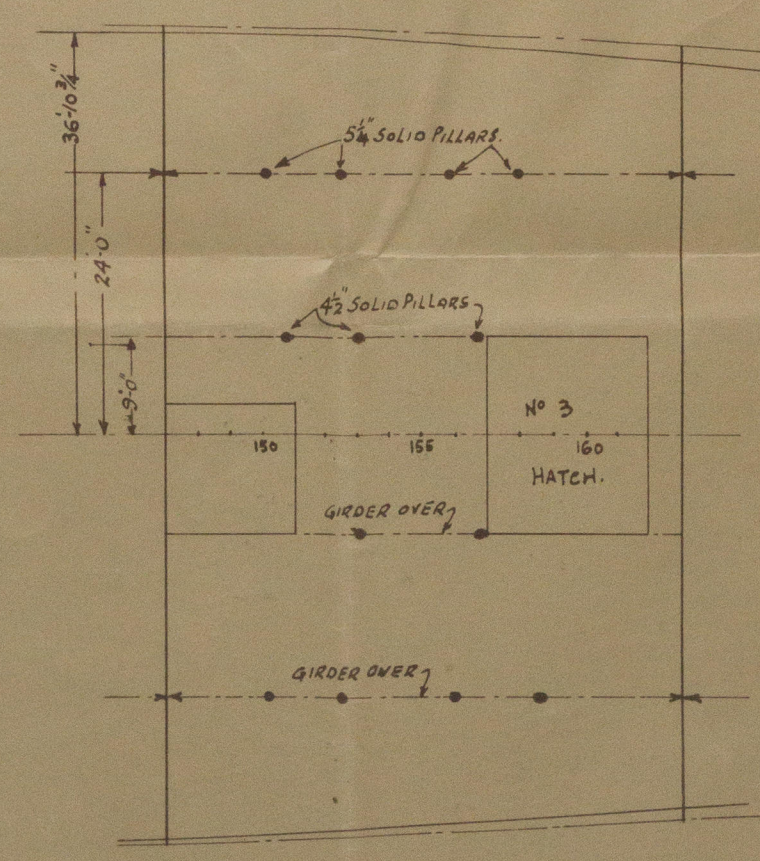

- NOTES - 1. 3RD CLASS ACCOMMODATION OR CARGO ON G DECK
2. INSULATED CARGO CHAMBERS ARRANGED ON H DECK
WITH 1 TIER HANGING CARGO UNDER G DECK.
3. HATCH SPACE NOT INSULATED.
4. SPACES FOR HANGING CARGO TINTED IN RED.

ELEVATION 24'-0" P.S.S.

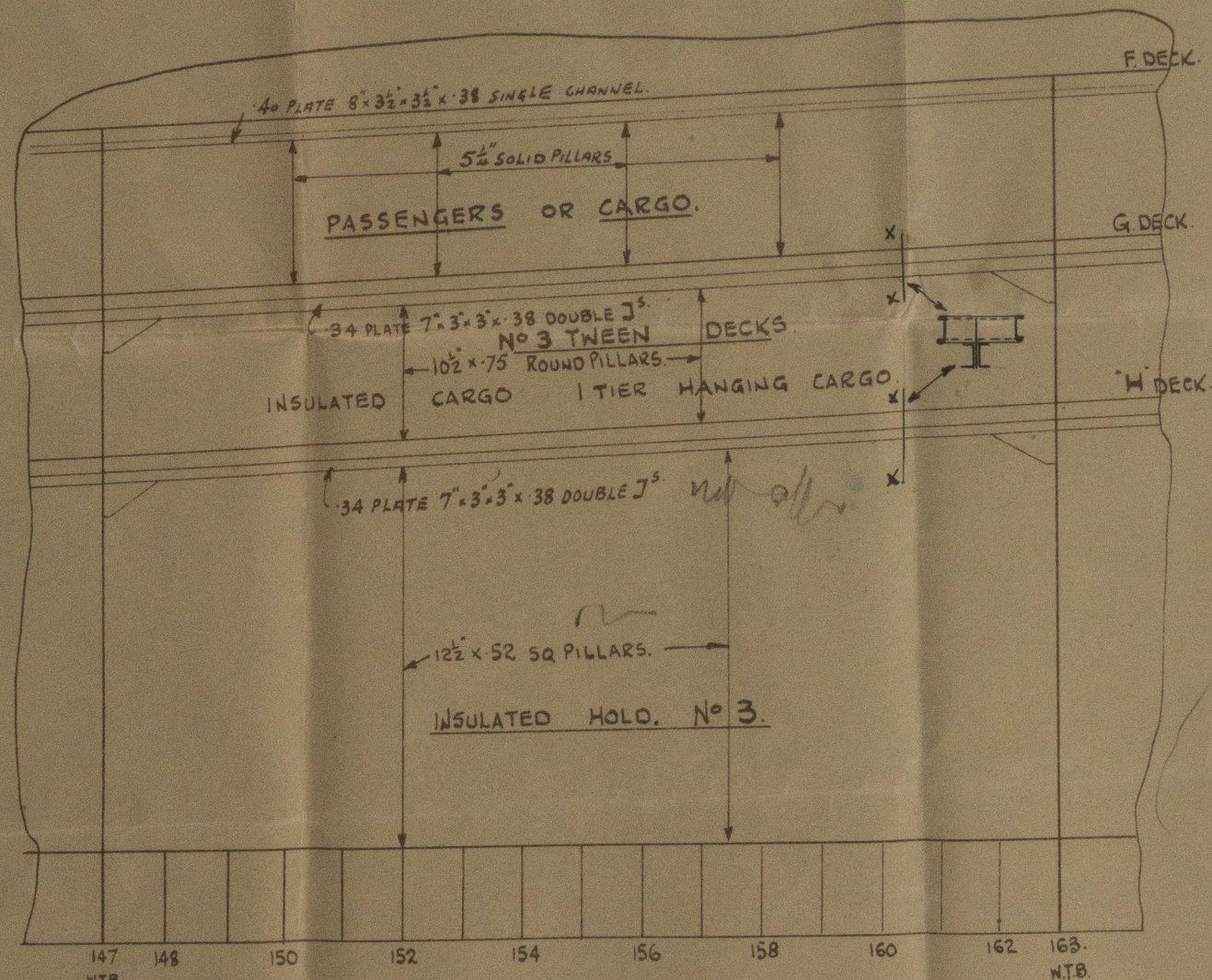

H DECK

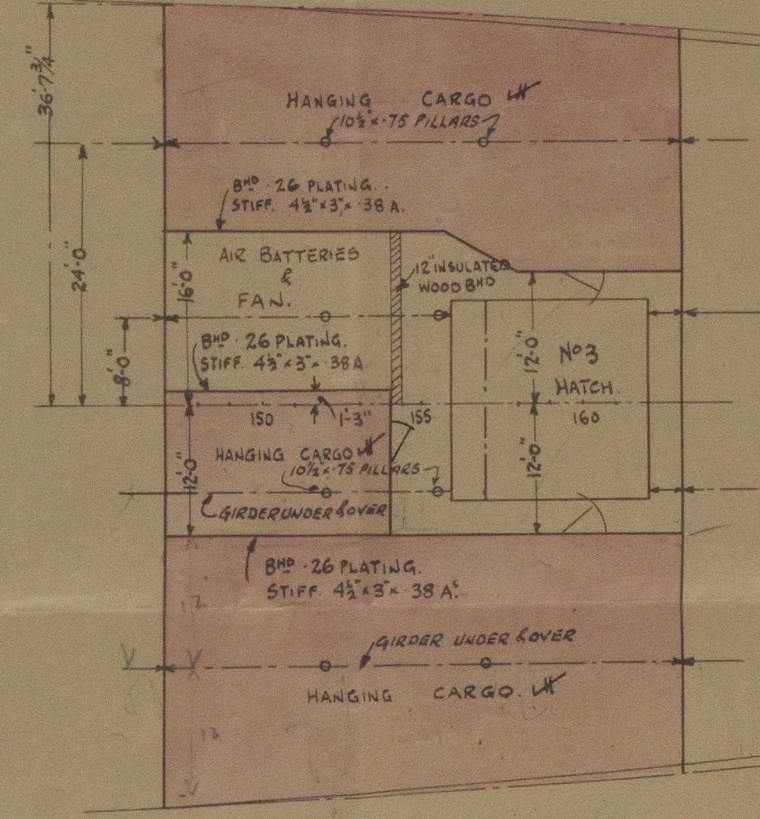

Bulkheads New

Load increased for hanging cargo
in ratio
 $\frac{8+24}{8} = \frac{10}{8} = 1.31 = 31\%$
Load decreased by removal of
 $\frac{16}{12} = 1.33 = 33\%$

W GASTIGHT CHAMBERS.

LONG BULKHEADS New.

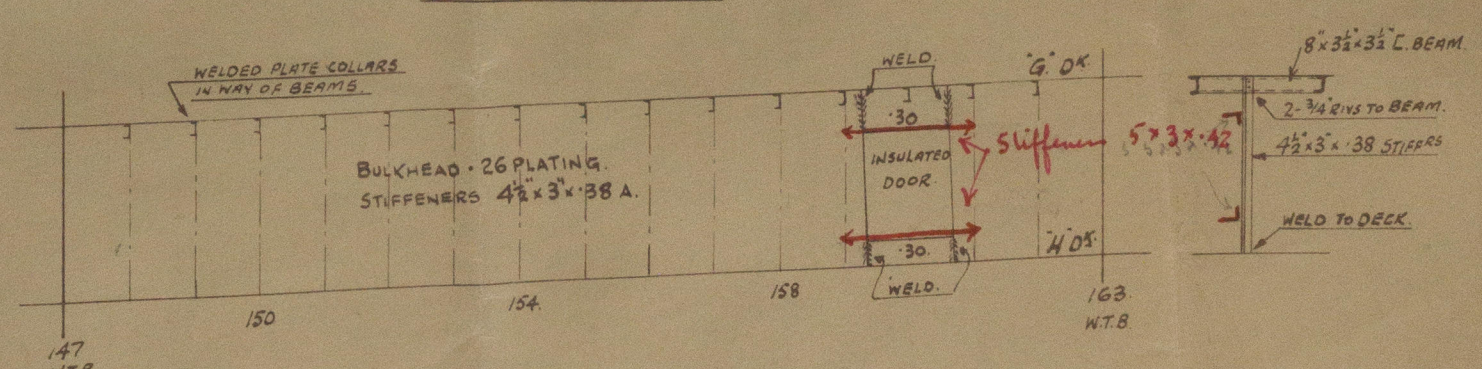

PLAN NO. 8.

27. 1. 26

W348-0028

10.000 | 10 | 34

From VICKERS-ARMSTRONGS Limited,
BARROW-IN-FURNESS.

ENCLOSURE

To.....

19

NAVAL WORKS
SHIPYARD DEPT

T.S.S. 'ORAMA'

Proposed Modifications to
Lower Oweindecks H to 6 decks
N° 3 Aven

Drawn repl. No 2600

Office



© 2020

W348-0028 Lloyd's Register
Foundation