

N<sup>o</sup> 437  
LEN<sup>th</sup> 210'-0" ON L.W.L. x 27'-6" x 16'-2" M<sup>at</sup> AT LLOYD'S LEN<sup>th</sup>

PROFILE *as built from*  
SCALE  $\frac{1}{4}$  = 1 FOOT

LLOYD'S NUMERALS

1<sup>st</sup> N<sup>o</sup> 92-56

2<sup>nd</sup> N<sup>o</sup> 52317-832



OLD SHIPBUILDING & ENGINEERING  
SHIP DRAWING OFFICE  
No. 57-10  
11 MAR 1909  
GLASGOW  
*Raydo*



The Fairfield S. B. & Co

No 437

Profile as built

Guine<sup>ex</sup>  
"A arcissus" 9622597.

~~Glasgow No. 22597.~~

Yt. 7027.

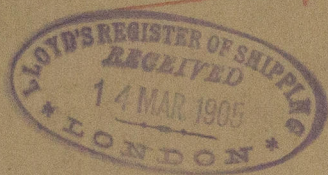

© 2020

Lloyd's Register  
Foundation

W316-0262