

PROFILE N° 255. S.S. "USKMOUTH."

SCALE $\frac{1}{8}$ = 1 FOOT

DIMENSIONS.
 LENGTH B.P. 230'-0"
 BREADTH EXT. 40'-9"
 DEPTH MLD. 20'-6"

JOHN PRIESTMAN & Co.

SHIPBUILDERS,

SUNDERLAND

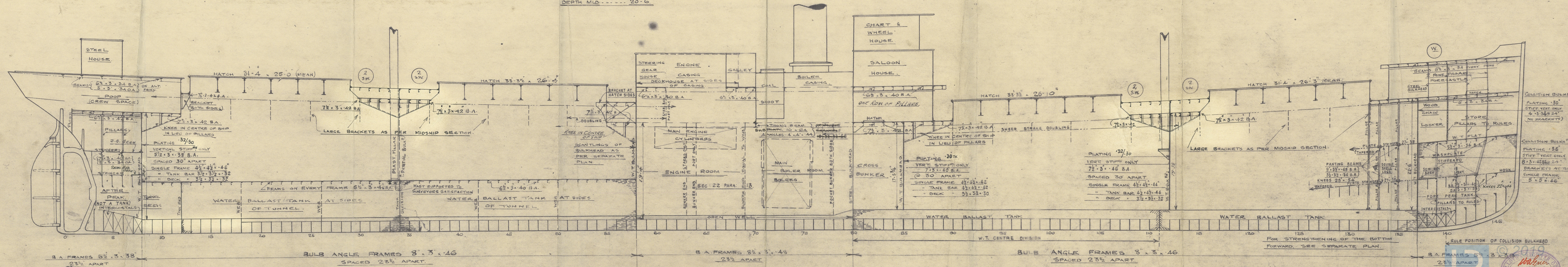

COLLISION BULKHEAD
 PLATING .30
 STIFF NEXT ONLY
 4 x 3 3/4 x 24"
 NO BRACKETS

COLLISION BULKHEAD
 PLATING .36
 STIFF VERT ONLY
 8 x 3 3/4 x 24"
 BRACKETS AT 70'
 SINGLE FRAME
 5 x 5 x 46"

RULE POSITION OF COLLISION BULKHEAD

FOR STRENGTHENING OF THE BOTTOM

FORWARD, SEE SEPARATE PLAN

B.A. FRAMES 5 1/2 x 3 x 38"

23 1/2" APART

W263-0141

'Sellinge'

(ex S.S. USKMOUTH)

PRIESTMANS N^o 255

PROFILE (AS FITTED)

SLD RPT N^o 26167

n.n. 'Sellinge'

Wreck Section 362

W263-0141



© 2019

Lloyd's Register
Foundation