

8" x 3 1/2" BA. BEAMS - ALTERNATES
 REINFORCED WITH 3" x 7/16" F.B. RIDER TBLS.

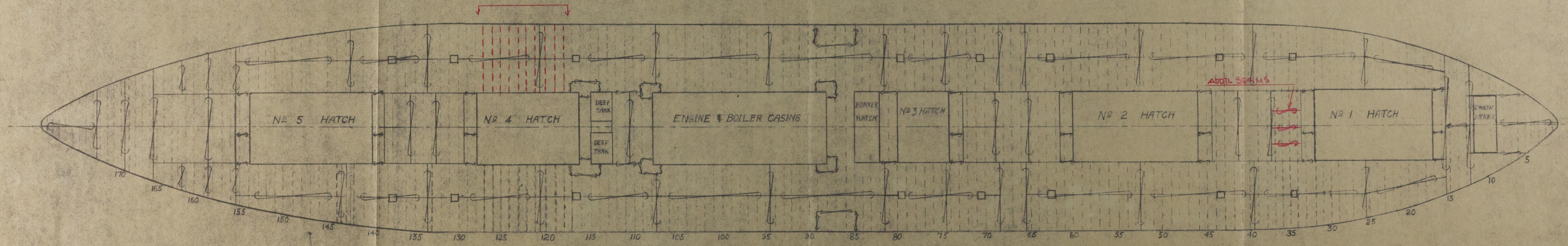

SECOND DECK SUBSTITUTIONS & REINFORCEMENTS
 HULL No. 28 (otherwise built as approval plan)

DATE 12-24-42
 DRAWN BY F.D.

SCALE 1/8" = 1'

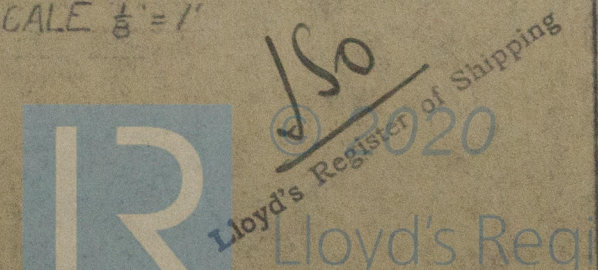

W254-0024

Lloyd's Register
 Foundation

Todd Bath S.S. Corp.
Hull #28

"Ocean Crusader"

N.Y.K. 43159.

2nd Deck Substitutions & Reinforcements
(Otherwise built as approved plan)

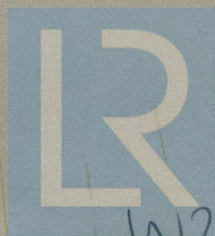

© 2020

Lloyd's Register

W254-0024