

SINGLE SCREW STEAMERS Nos. 389-90.

IRONWORK PROFILE & STEEL DECK PLAN

DIMENSIONS 240'0" B.P. 36'0" 21'3" M.L.D.

SCALE 1/8" = ONE FOOT

Carling 42' 32"

BULKHEAD PLATING 34' 44"
BULKHEAD STIFFENERS 8' 3" 44"
SPACED 30' APART

may be 28' 32"
BULKHEAD STIFFENERS 8' 3" 44"
SPACED 30' APART

Carling 36' 32"
BULKHEAD PLATING 34' 44"
BULKHEAD STIFFENERS 8' 3" 44"
SPACED 30' APART

BULKHEAD PLATING 30' 40"
BULKHEAD STIFFENERS 7' 3" 44" to 6' 3" 36"
SPACED 24' APART

Connections with painting arrangement.

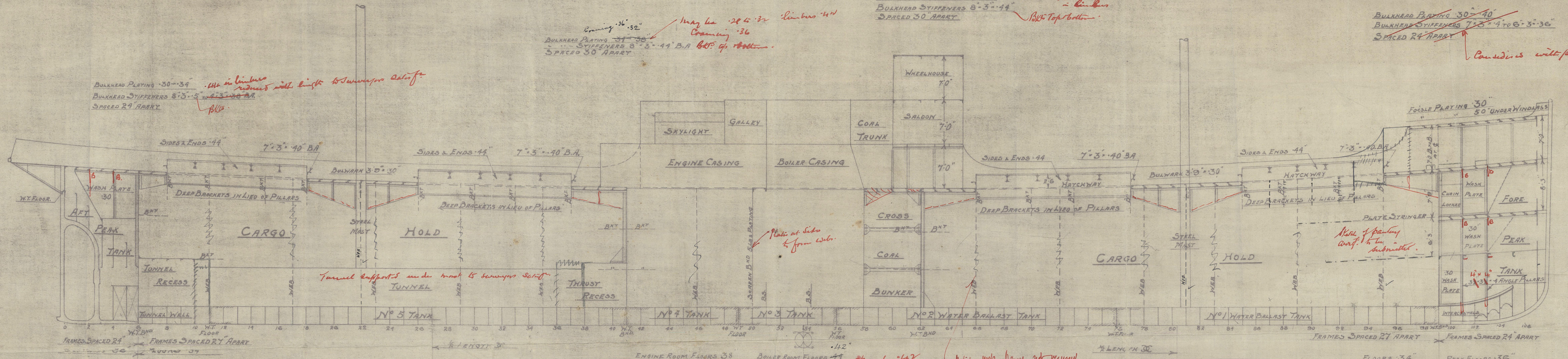

PEAK FRAMES 6' 3" 35' BA. FRAMES IN DOUBLE BOTTOM 3' 3" 34. ELSEWHERE 3' 3" 40 BA

FRAMES IN DOUBLE BOTTOM 3' 3" 34. ELSEWHERE 3' 3" 40 BA. PEAK FRAMES 6' 3" 35 BA.

BEAMS 6' 3" 50 BA. CARLINGS 6' 3" 40 BA. CARLINGS ON DEEP BRACKETS 3' 3" 40. BEAMS ON DEEP BRACKETS 6' 3" 50 BA.

BEAMS 6' 3" 50 BA. CARLINGS 6' 3" 40 BA. CARLINGS ON DEEP BRACKETS 3' 3" 40.

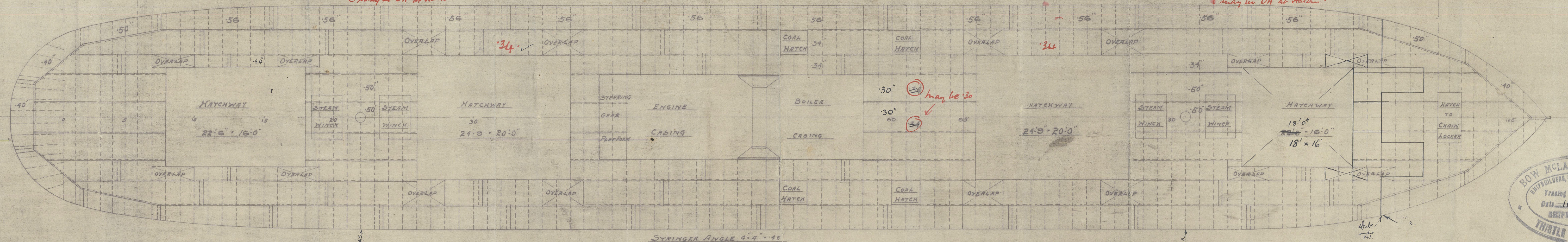

STRINGER ANGLE 4' 4" 48

APPROVED
LLOYD'S REGISTER OF SHIPPING
J. H. G. G. G.
DATE 4.1.20

Returned
BOW McLACHLAN & CO. LTD.
TRADING M. 389-90
Date 11.2.20
SHIPBUILDING

BOW McLACHLAN & CO. LTD.
TRADING M. 389-90
Date 31.12.19
SHIPBUILDING

Lloyd's Register
UK 253 015

— BOW. McLACHLAN & Co. —

— PROFILE & DECK PLAN. —

— N^{os} 389-90 —

Cancelled

GLASGOW REPORT No. # 1131

SS "Maria Thyrskides"

N. N. "Newlands"

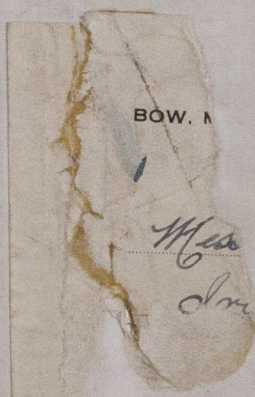

W253-0115



© 2020

Lloyd's Register
Foundation