

GENERAL ARRANGEMENT
R.F.A. "OLEARY."

SCALE 1/8" = 1 FOOT.

SUMMARY OF OIL FUEL

Boiler No. 1 (20 to 25)	135 Tons
Boiler No. 2 (20 to 25)	135 Tons
Boiler No. 3 (20 to 25)	135 Tons
Boiler No. 4 (20 to 25)	135 Tons
Boiler No. 5 (20 to 25)	135 Tons
Boiler No. 6 (20 to 25)	135 Tons
Boiler No. 7 (20 to 25)	135 Tons
Boiler No. 8 (20 to 25)	135 Tons
Boiler No. 9 (20 to 25)	135 Tons
Boiler No. 10 (20 to 25)	135 Tons
Boiler No. 11 (20 to 25)	135 Tons
Boiler No. 12 (20 to 25)	135 Tons
Boiler No. 13 (20 to 25)	135 Tons
Boiler No. 14 (20 to 25)	135 Tons
Boiler No. 15 (20 to 25)	135 Tons
Boiler No. 16 (20 to 25)	135 Tons
Boiler No. 17 (20 to 25)	135 Tons
Boiler No. 18 (20 to 25)	135 Tons
Boiler No. 19 (20 to 25)	135 Tons
Boiler No. 20 (20 to 25)	135 Tons
Boiler No. 21 (20 to 25)	135 Tons
Boiler No. 22 (20 to 25)	135 Tons
Boiler No. 23 (20 to 25)	135 Tons
Boiler No. 24 (20 to 25)	135 Tons
Boiler No. 25 (20 to 25)	135 Tons
Boiler No. 26 (20 to 25)	135 Tons
Boiler No. 27 (20 to 25)	135 Tons
Boiler No. 28 (20 to 25)	135 Tons
Boiler No. 29 (20 to 25)	135 Tons
Boiler No. 30 (20 to 25)	135 Tons
Boiler No. 31 (20 to 25)	135 Tons
Boiler No. 32 (20 to 25)	135 Tons
Boiler No. 33 (20 to 25)	135 Tons
Boiler No. 34 (20 to 25)	135 Tons
Boiler No. 35 (20 to 25)	135 Tons
Boiler No. 36 (20 to 25)	135 Tons
Boiler No. 37 (20 to 25)	135 Tons
Boiler No. 38 (20 to 25)	135 Tons
Boiler No. 39 (20 to 25)	135 Tons
Boiler No. 40 (20 to 25)	135 Tons
Boiler No. 41 (20 to 25)	135 Tons
Boiler No. 42 (20 to 25)	135 Tons
Boiler No. 43 (20 to 25)	135 Tons
Boiler No. 44 (20 to 25)	135 Tons
Boiler No. 45 (20 to 25)	135 Tons
Boiler No. 46 (20 to 25)	135 Tons
Boiler No. 47 (20 to 25)	135 Tons
Boiler No. 48 (20 to 25)	135 Tons
Boiler No. 49 (20 to 25)	135 Tons
Boiler No. 50 (20 to 25)	135 Tons
Boiler No. 51 (20 to 25)	135 Tons
Boiler No. 52 (20 to 25)	135 Tons
Boiler No. 53 (20 to 25)	135 Tons
Boiler No. 54 (20 to 25)	135 Tons
Boiler No. 55 (20 to 25)	135 Tons
Boiler No. 56 (20 to 25)	135 Tons
Boiler No. 57 (20 to 25)	135 Tons
Boiler No. 58 (20 to 25)	135 Tons
Boiler No. 59 (20 to 25)	135 Tons
Boiler No. 60 (20 to 25)	135 Tons
Boiler No. 61 (20 to 25)	135 Tons
Boiler No. 62 (20 to 25)	135 Tons
Boiler No. 63 (20 to 25)	135 Tons
Boiler No. 64 (20 to 25)	135 Tons
Boiler No. 65 (20 to 25)	135 Tons
Boiler No. 66 (20 to 25)	135 Tons
Boiler No. 67 (20 to 25)	135 Tons
Boiler No. 68 (20 to 25)	135 Tons
Boiler No. 69 (20 to 25)	135 Tons
Boiler No. 70 (20 to 25)	135 Tons
Boiler No. 71 (20 to 25)	135 Tons
Boiler No. 72 (20 to 25)	135 Tons
Boiler No. 73 (20 to 25)	135 Tons
Boiler No. 74 (20 to 25)	135 Tons
Boiler No. 75 (20 to 25)	135 Tons
Boiler No. 76 (20 to 25)	135 Tons
Boiler No. 77 (20 to 25)	135 Tons
Boiler No. 78 (20 to 25)	135 Tons
Boiler No. 79 (20 to 25)	135 Tons
Boiler No. 80 (20 to 25)	135 Tons
Boiler No. 81 (20 to 25)	135 Tons
Boiler No. 82 (20 to 25)	135 Tons
Boiler No. 83 (20 to 25)	135 Tons
Boiler No. 84 (20 to 25)	135 Tons
Boiler No. 85 (20 to 25)	135 Tons
Boiler No. 86 (20 to 25)	135 Tons
Boiler No. 87 (20 to 25)	135 Tons
Boiler No. 88 (20 to 25)	135 Tons
Boiler No. 89 (20 to 25)	135 Tons
Boiler No. 90 (20 to 25)	135 Tons
Boiler No. 91 (20 to 25)	135 Tons
Boiler No. 92 (20 to 25)	135 Tons
Boiler No. 93 (20 to 25)	135 Tons
Boiler No. 94 (20 to 25)	135 Tons
Boiler No. 95 (20 to 25)	135 Tons
Boiler No. 96 (20 to 25)	135 Tons
Boiler No. 97 (20 to 25)	135 Tons
Boiler No. 98 (20 to 25)	135 Tons
Boiler No. 99 (20 to 25)	135 Tons
Boiler No. 100 (20 to 25)	135 Tons

CAPACITIES AT 30 SCOFF PER TON.

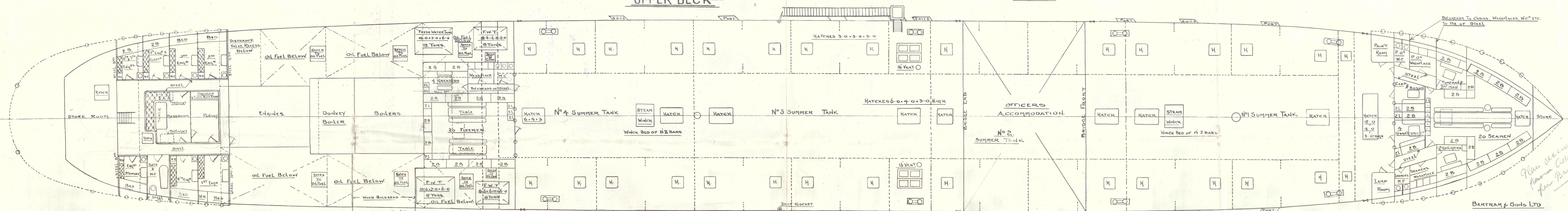
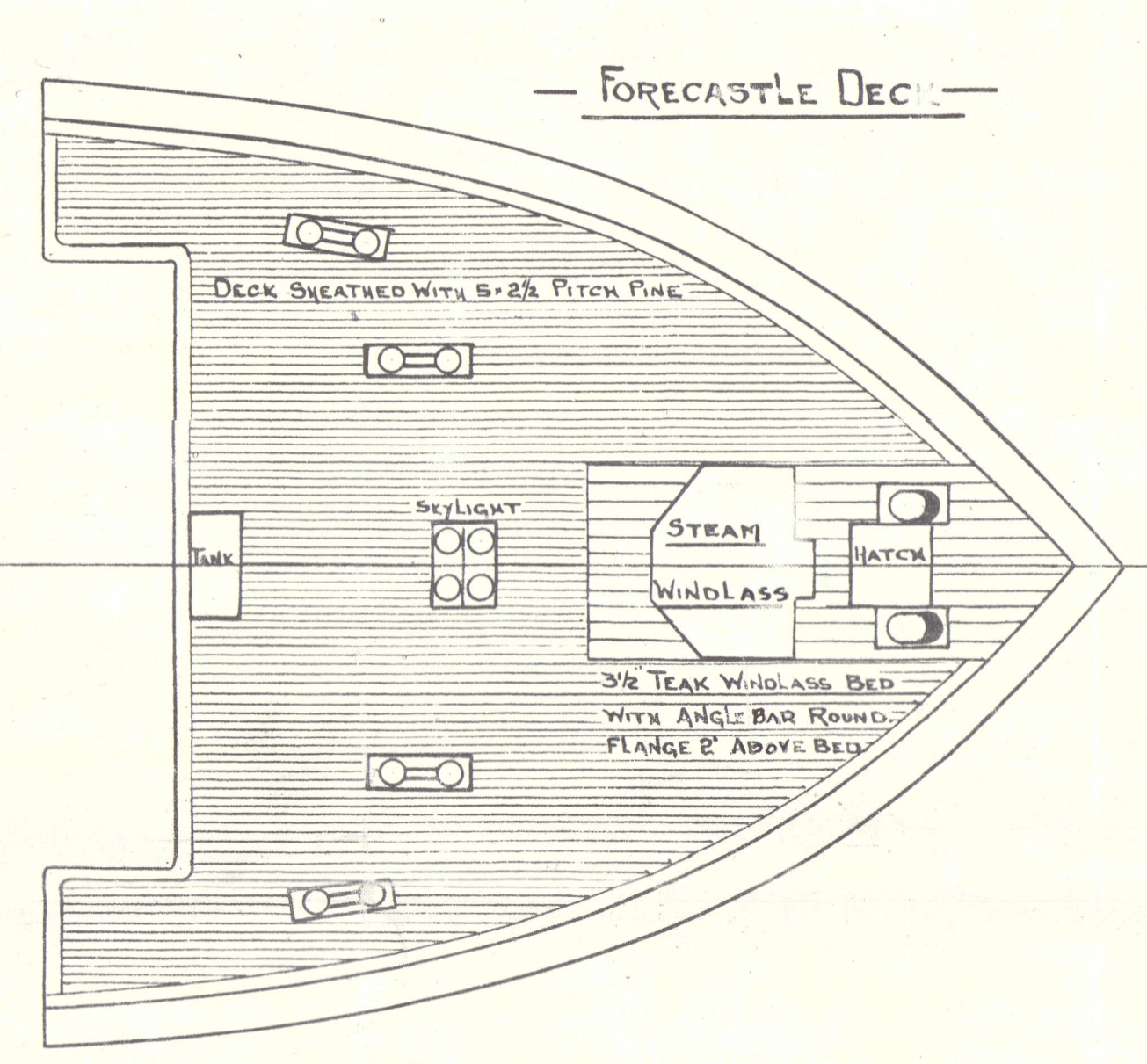
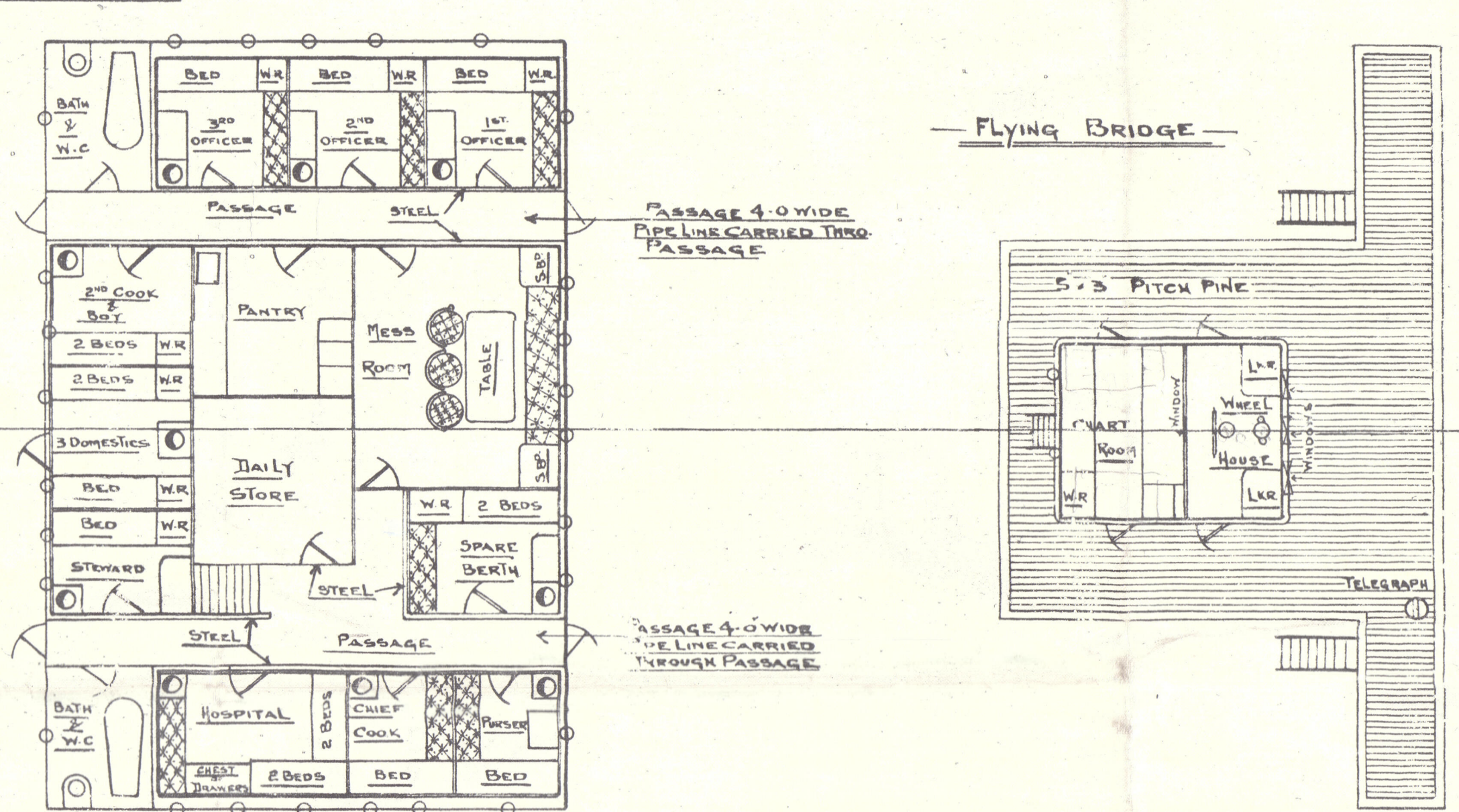
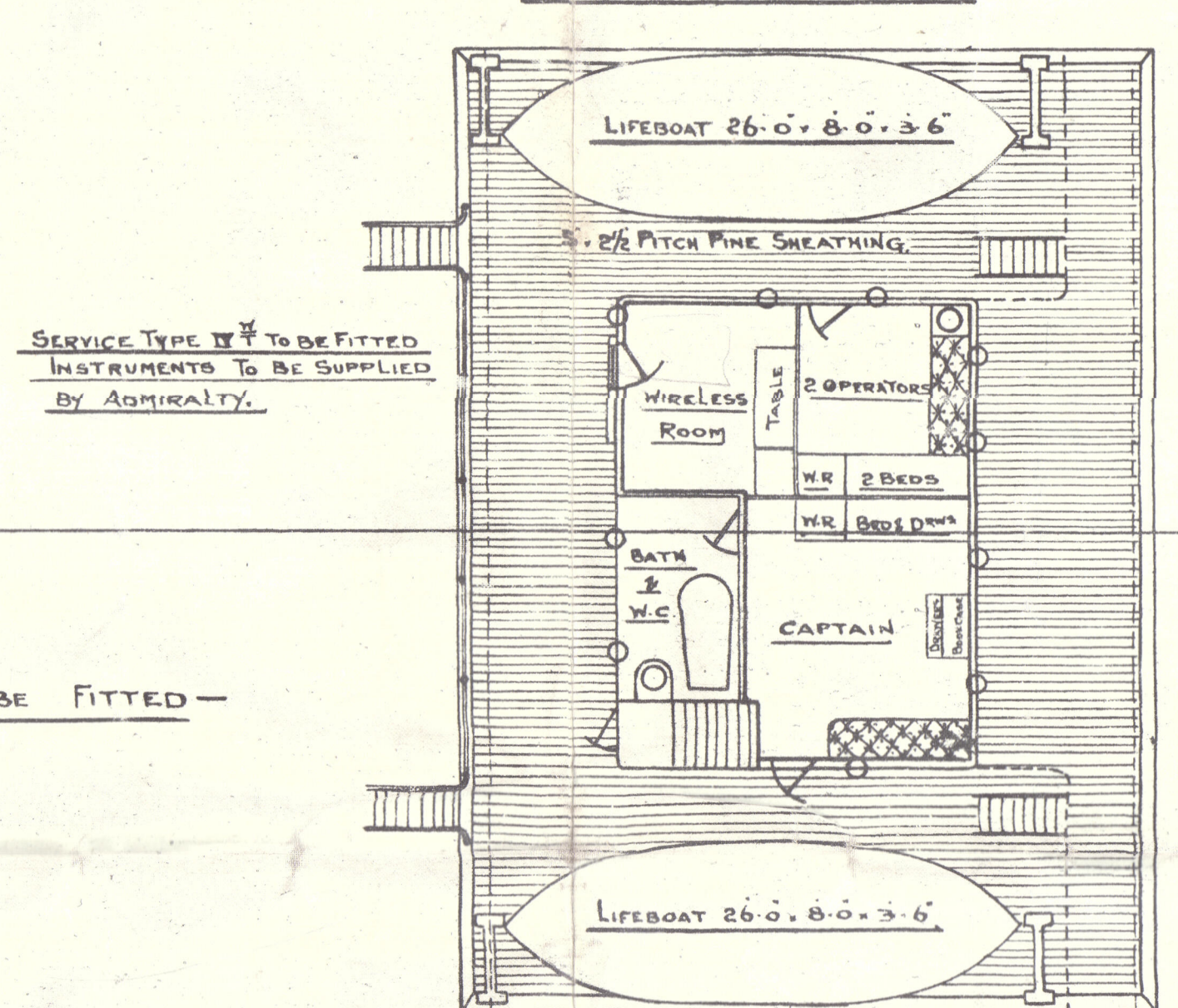
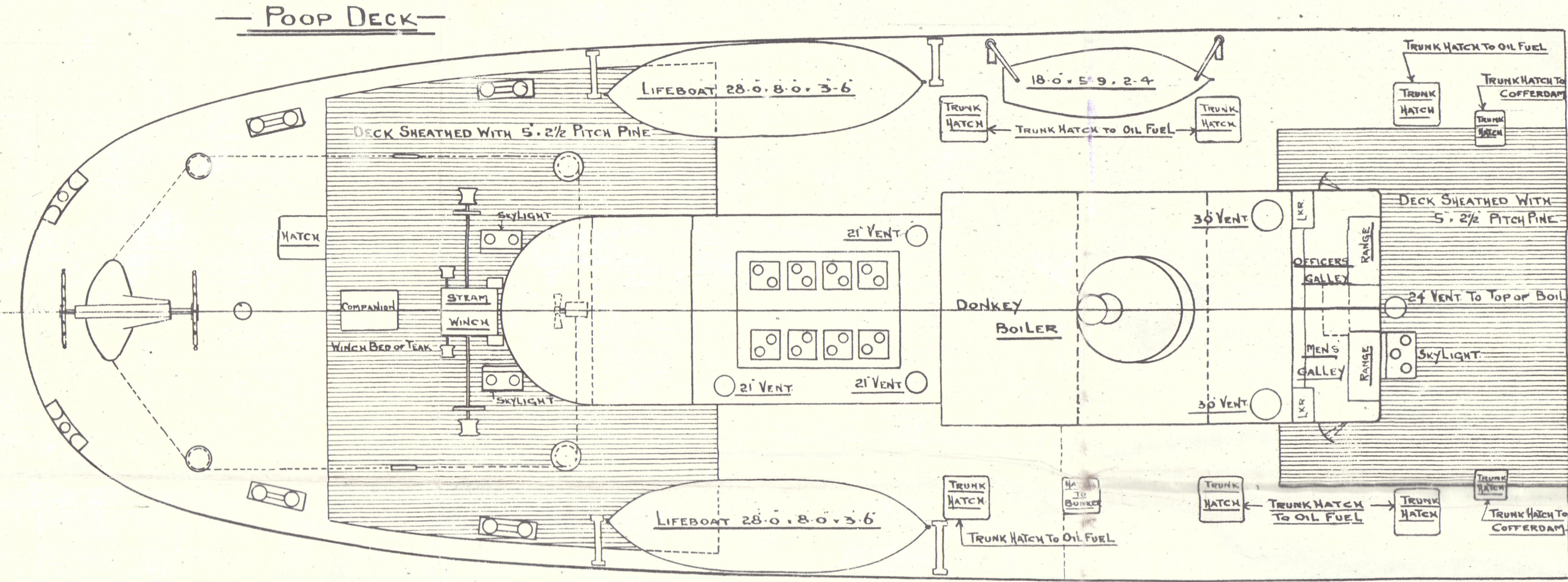


SHIPBUILDERS
SUNDERLAND.

Plan approved
from Admiralty
for service
1918

P. P. OLEARY

Barham & Sons No 238

Official
Profile & LK. Plans

Converted Oil

of Dockleaf

SUNDERLAND RPT. No. 26955



NOW

—*—LITIOPA—*—

W1250-0175



© 2020

Lloyd's Register
Foundation