

S. S. N<sup>o</sup> 471.

ALL STEEL DECKS

PLAN OF BRIDGE DECK

PLAN OF UPPER DECK.

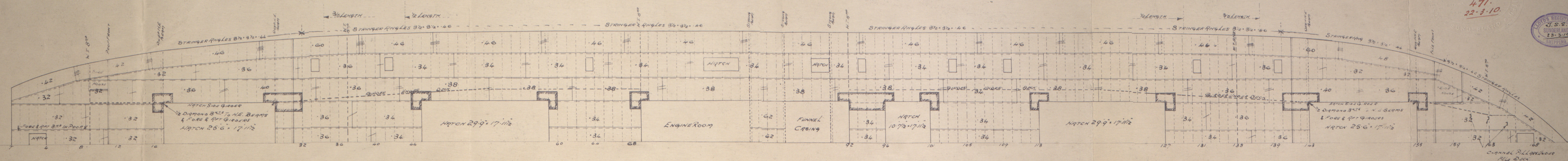

4707.  
471.  
22-3-10.





J L Thompson & Son's

No 471

SS "Elisabeth Dal"  
Maresfield ex

Deck Plans  
(as built)

Sld. Rpt. 24383

W241-0205



© 2019

Lloyd's Register  
Foundation