

S. S. N^o 471.

NOTE:-
ALL STEEL DECKS

NOTE:- POSITION OF BUTTS ARE APPROXIMATE
D. = CORNER DOUBLINGS.

PLAN OF BRIDGE DECK

PLAN OF UPPER DECK

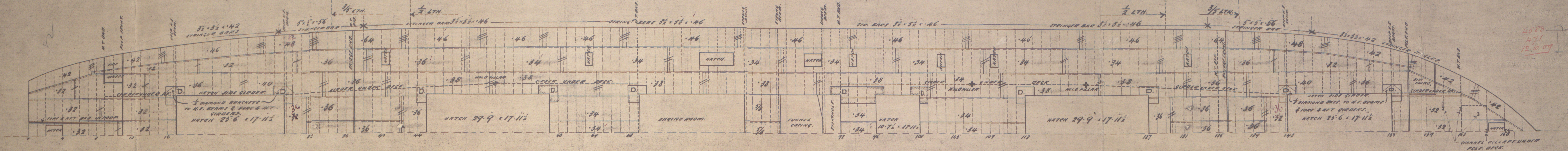

Lloyd's Register Foundation

J. L. Thompson & Sons Ltd.

477 Amund

D.K. Lane

W241-0204



"Elizabeth Dal"

8/5 Maresfield ex

Std Rpt 74383



© 2019

Lloyd's Register
Foundation