

S/S "ROSE SCHIAFFINO."

SCHEMAS D'INSTALLATION DE CHAUFFE AU MAZOUT.

SCHEMA TUYAUTAGE MAZOUT.

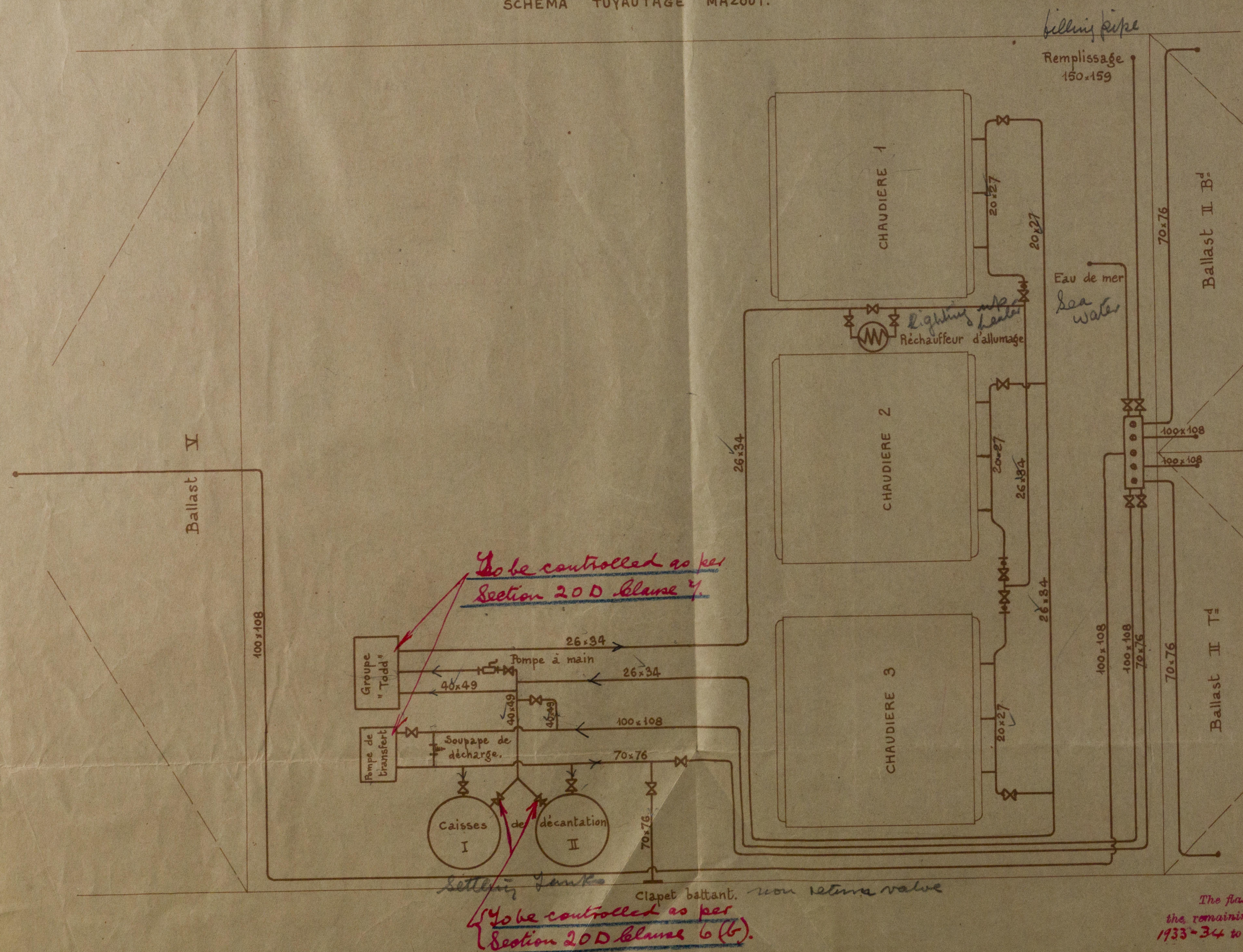

SCHEMA TUYAUTAGE VAPEUR.

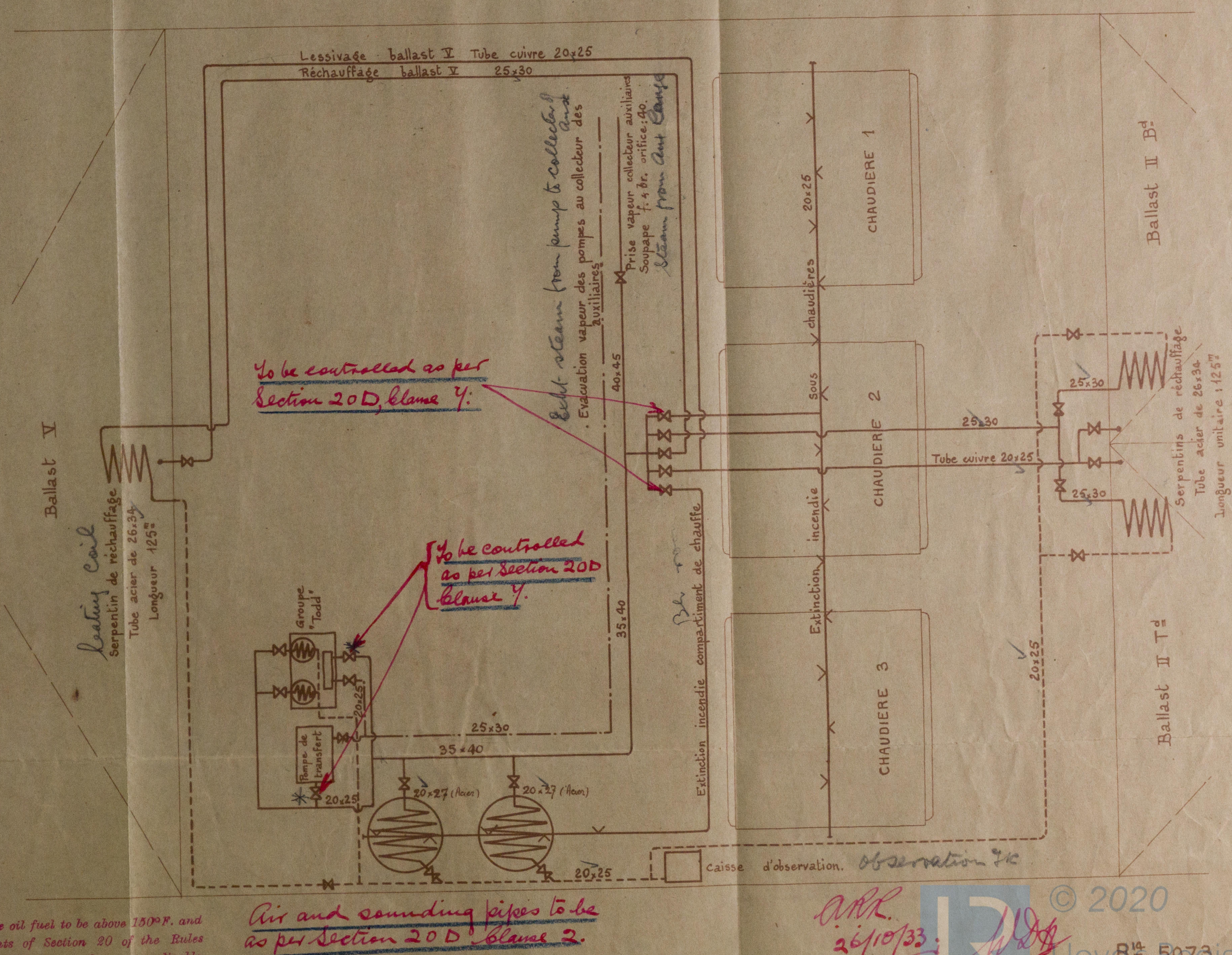

The flash point of the oil fuel to be above 150°F. and the remaining requirements of Section 20 of the Rules 1933-34 to be complied with, so far as they are applicable.

Air and sounding pipes to be as per Section 20 D clause 2.

APR 26/10/33

W.D.

© 2020

Lloyd's Register

0277-0236

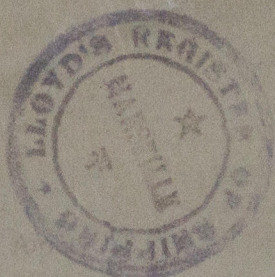

21.10.33

SOCIÉTÉ des ATELIERS TERRIN
40, Boul. Maritime, MARSEILLE

DESSIN : SÉRIE R¹⁴
N° 5073
Date 19 OCT. 1933

s/s "Rose Schiaffino" Mol. repr.

Schéma du tuyautage Mazout - Vapeur

Compartiments "Chaudière" & Machine

No 1556

Oil Fuel Burning & Fire Extinguishing Arrangements

LONDON COPY

VX/212-0236



© 2020

Lloyd's Register
Foundation