

Nº 1229.

PROFILE & DECKS.

DIMENSIONS:- 284'-0" B.P. x 42'-0" B. EXT. x 21'-9 1/2" D.M. to UPPER DK.

To CLASS LLOYDS 100 A.1.

SCALE - 1/8" = 1 FOOT.

WINCHES WINDLASS ETC. SUPPORTED TO SURVEYORS SATISFACTION

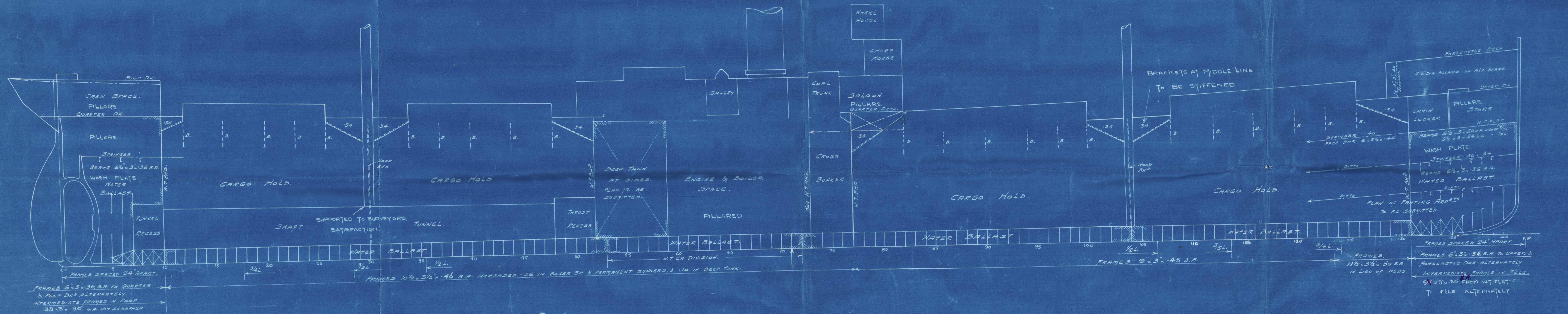

QUARTER DECK.

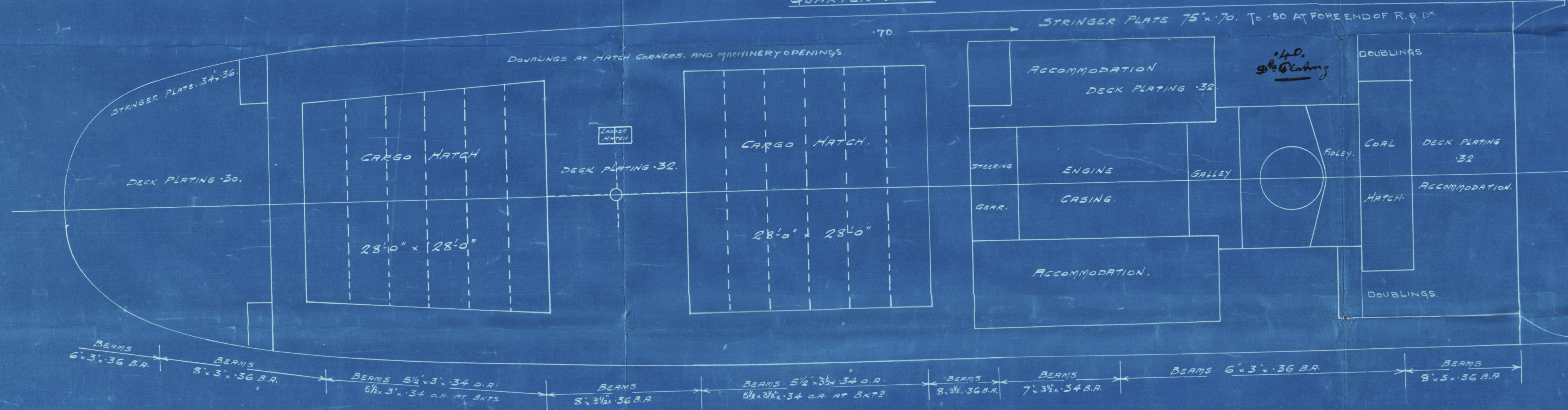

UPPER DECK.

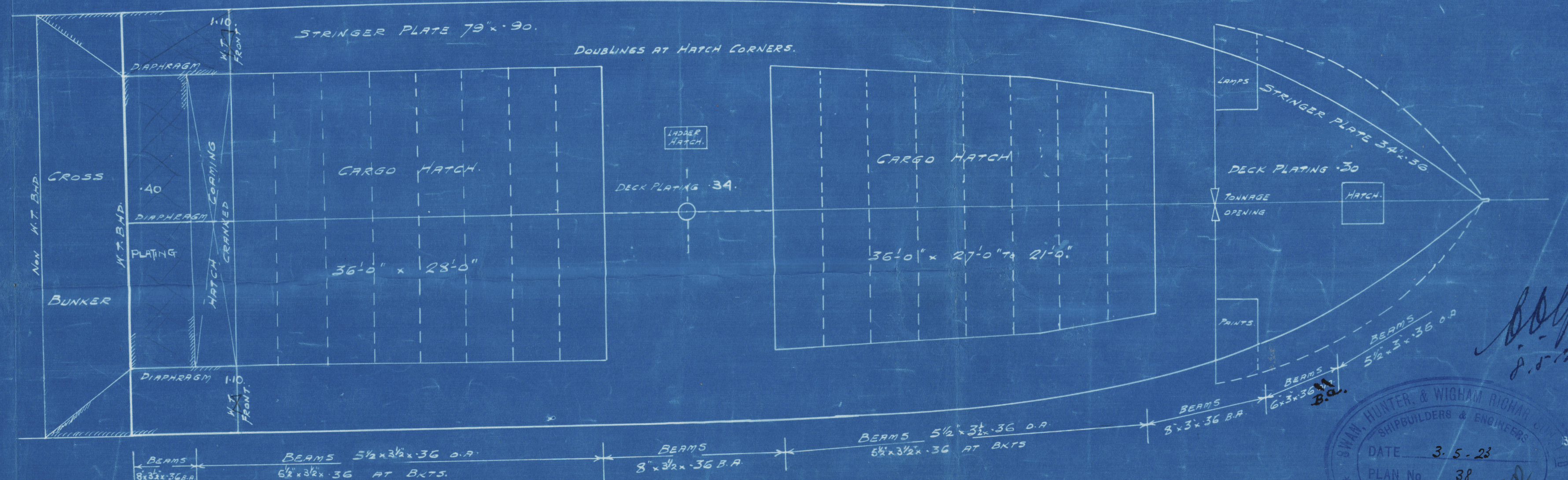

(2)

Swan & Humber.

No 1229.

Profile & Deck.

"Cordene".

Nwc Rept No. 78003.

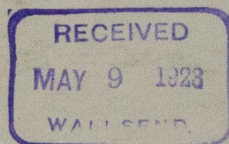

1229

CORDENE
NEWCASTLE ON TYNE.
Report No. 78003.

W20-0145



© 2019

Lloyd's Register
Foundation