

PROFILE & DECK PLAN
S. S. N^{os.} 261 & 2.

SCALE 1/8" = 1 FOOT.

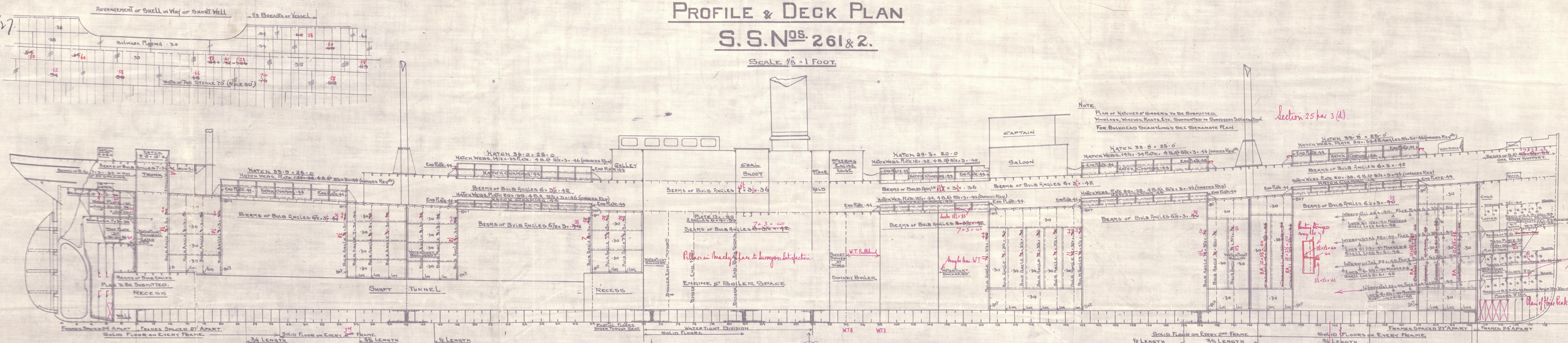

NOTE.
PLAN OF HATCHES & GIRDERS TO BE SUBMITTED,
WINDLASS, WINCHES, MASTS, ETC. SUPPORTED TO SURVEYORS SATISFACTION.
FOR BULKHEAD SCANTLING SEE SEPARATE PLAN

Section 25 par 3(d).

Pillars in Machy face to surveyors satisfaction.

Maybe non-W.T. = 2

Stringer $35' \times 34'$
Shell Connections $5' \times 5'$

Plan of Horse Peak to be submitted.

NOTE. BOTTOM STRENGTHENED FORWARD
AS PER RULE. PLAN TO BE SUBMITTED.
PLAN OF PAINTING ARRANGEMENT TO BE
SUBMITTED.

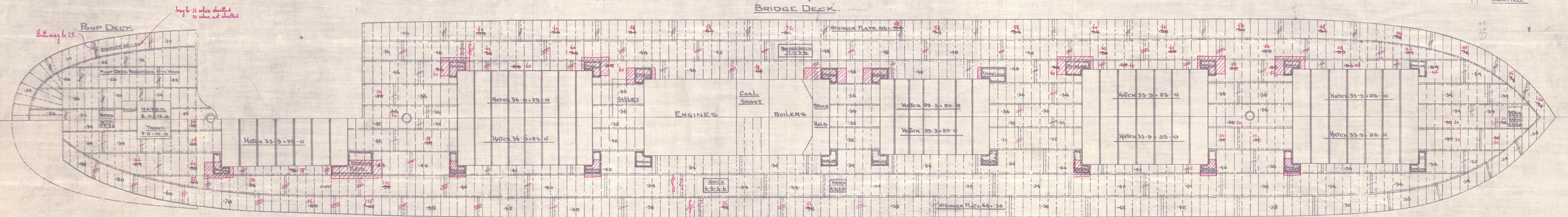

May be .26 where sheathed
.30 where not sheathed.

Butto may be S.R.

SUNDERLAND.

Bartrams 261-2-3-4.

Profile & Decks

S.S. * "LHANOVER" No. 261.

SUNDERLAND RPT. NO. 29659

S.S. "LHANDILO" No. 262

SUNDERLAND RPT. NO. 29707

S.S. "LLANFAIR" No. 263.

SUNDERLAND RPT. NO. 29779

S.S. "LLANWERN" No. 264.

SUNDERLAND RPT. NO. 29850



© 2020

Lloyd's Register
Foundation