

Hand-drawn architectural section of a window frame. The drawing includes the following dimensions and specifications:

- Overall width: 60"
- Top left corner: Wood 9" x 6"
- Top center: Wood 6" x 6"
- Top edge: Wood covers 1/2" THICK.
- Top right corner: 5" x 1 1/2" COPE IRON.
- Right edge: SIDE COAMINGS 3/80 THICK.
- Bottom right corner: END 3/80.
- Bottom center: 8" x 1 1/2" COPE IRON.
- Bottom edge: 8" x 3" x 3/80.
- Bottom left corner: 8" x 1 1/2" COPE IRON.
- Left edge: 8" x 1 1/2" COPE IRON.
- Center: WOOD PLATE 8" x 1 1/2" COPE IRON.
- Bottom center: 8" x 3" x 3/80 DOUBLE.
- Bottom right corner: BEAM.
- Bottom right corner: SINGLE LUGS.
- Bottom right corner: 3/80 "BRACKET."
- Bottom right corner: 3/80 "COPE IRON DOUBLE."

SECTION TWO KATCHES.

DEEP BRACKET IN LIEU OF FILLARS AT SIDES
OF 12" x 12" KATCHES.

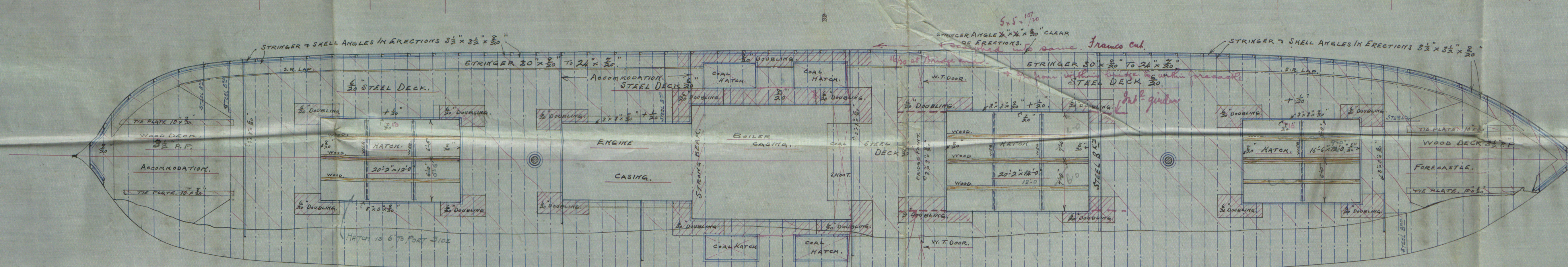
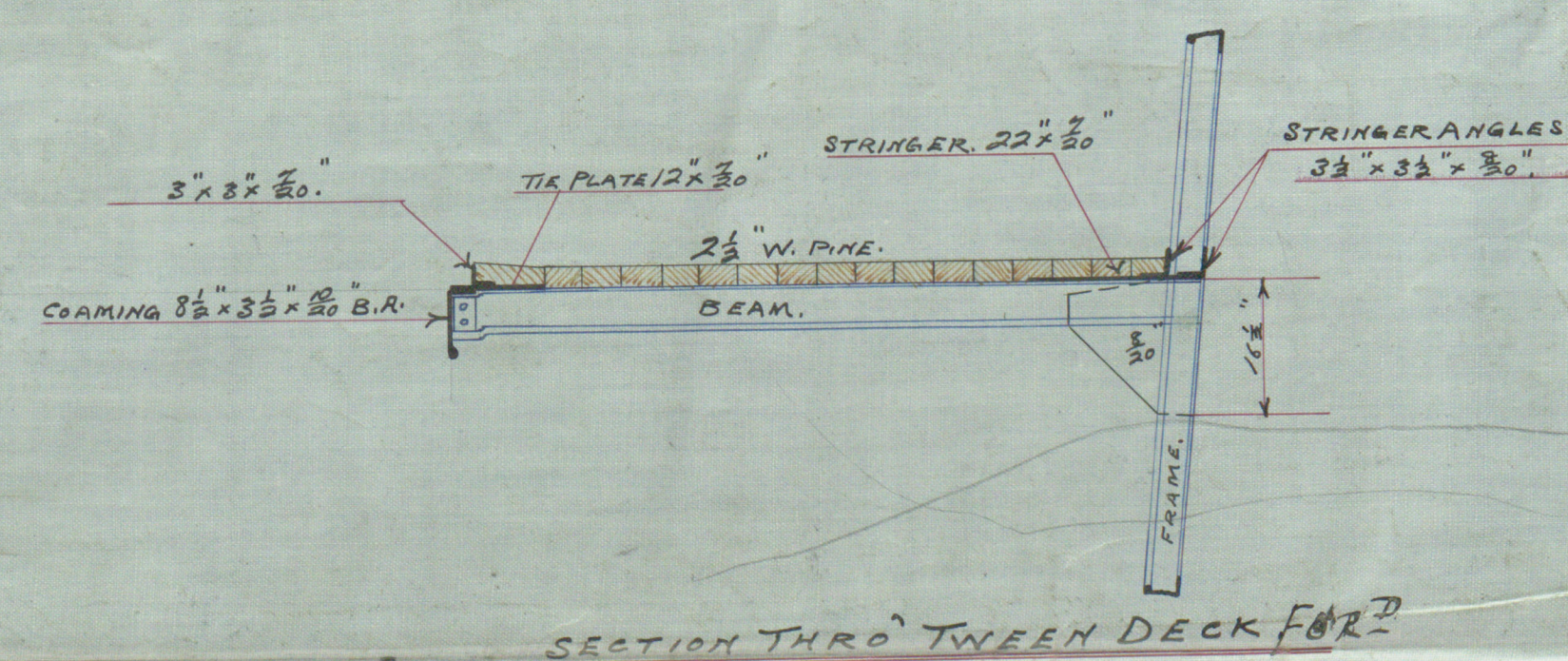

LLOYDS PROFILE.
S.S. NOS 216 & 217.
SCALE $\frac{1}{8}$ " = 1 FOOT.

LLOYDS DIM. 213.83' x 31.33' x 15.32
TO CLASS 100 A.1.

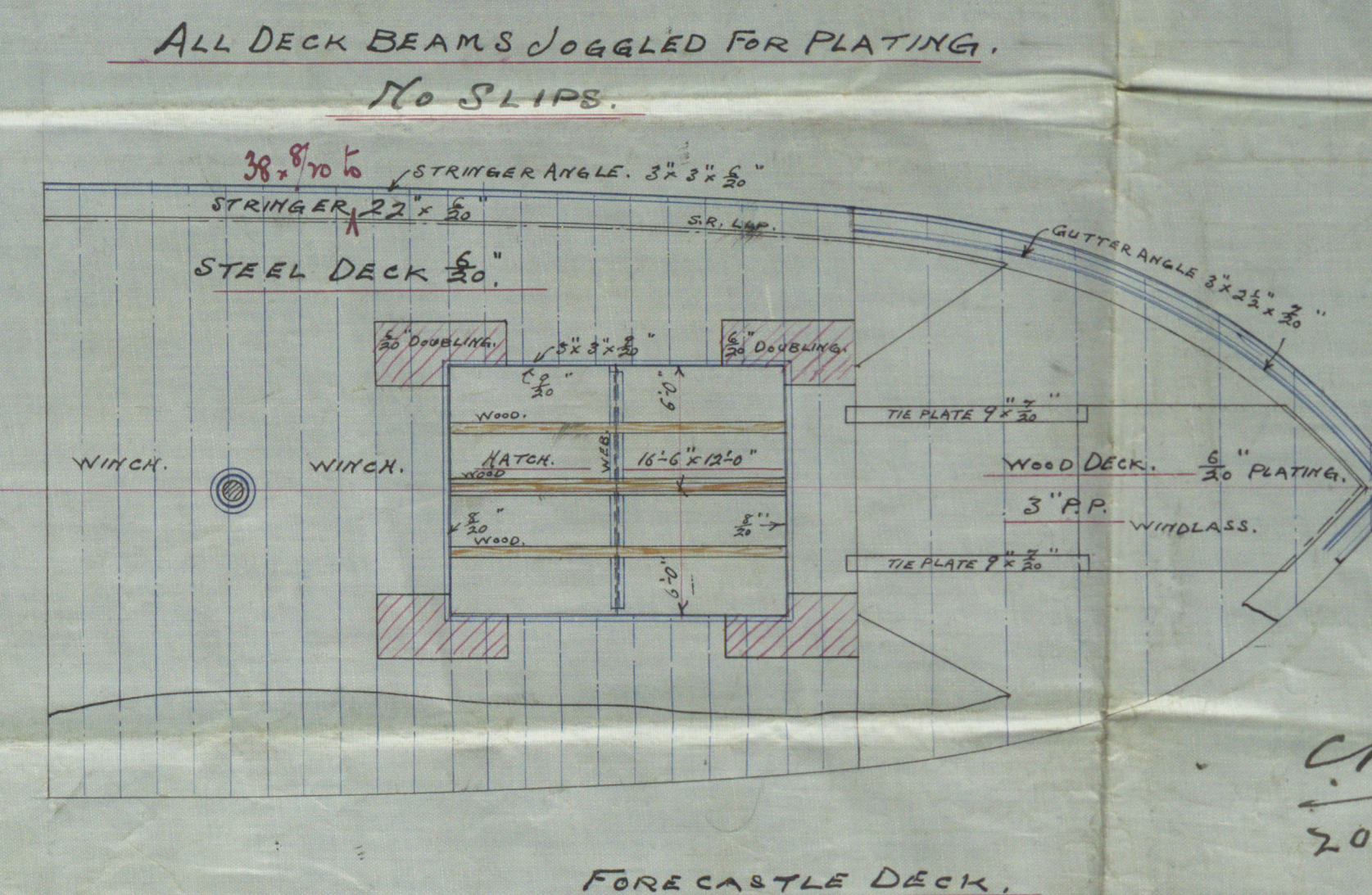
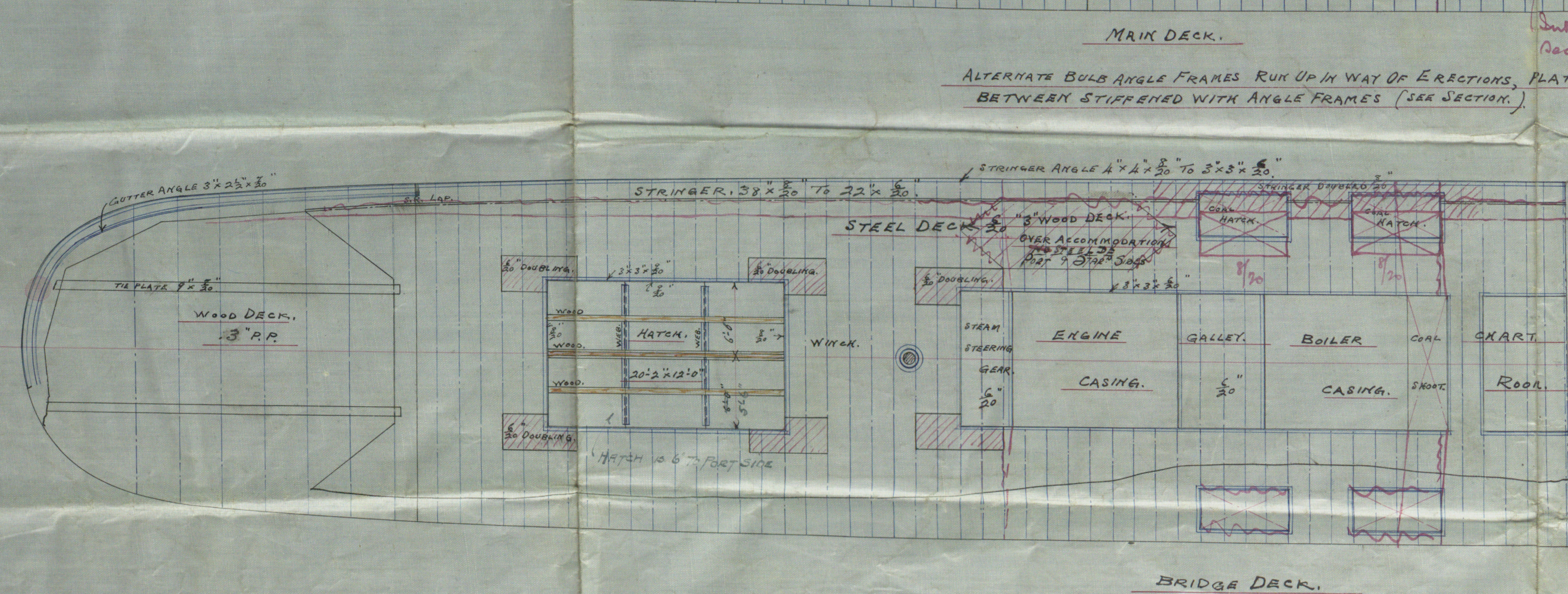

C.B.
20.7.08.

S. S. 8° 2/6 + 214

Amundid.

Propiti Plan

Messrs Ramage &

Ferguson
Leith

Inaki

Lth. 12574.



© 2019

Lloyd's Register
Foundation