

# TWIN SCREW NORTH ATLANTIC STEAMER.

N<sup>o</sup> 528-9

DIMENSIONS 644'-0" ON LNL x 77'-6" x 53'-6"

TO CLASS 100 A.1. AT LLOYD'S WITH FREEBOARD

SCALE 1/16" = 1 FOOT.

17-1-18

TOPS OF RAISED ROOF

BOAT DECK.

PROMENADE DECK

BRIDGE DECK

SHELTER DECK

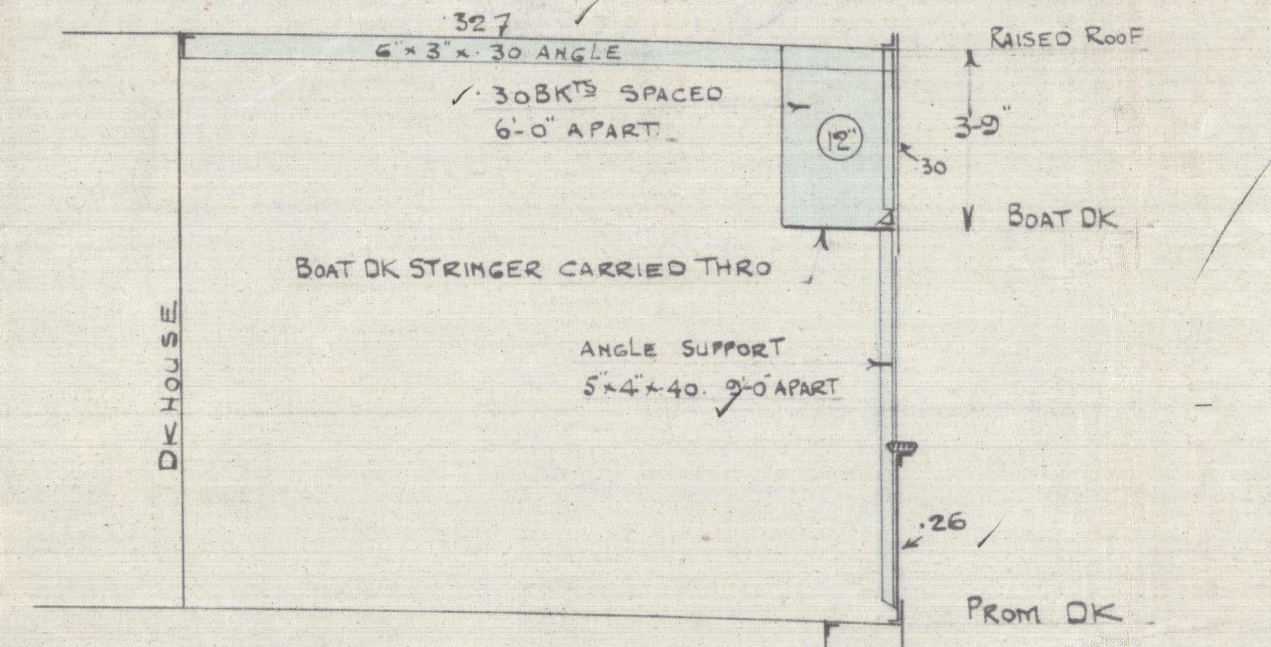
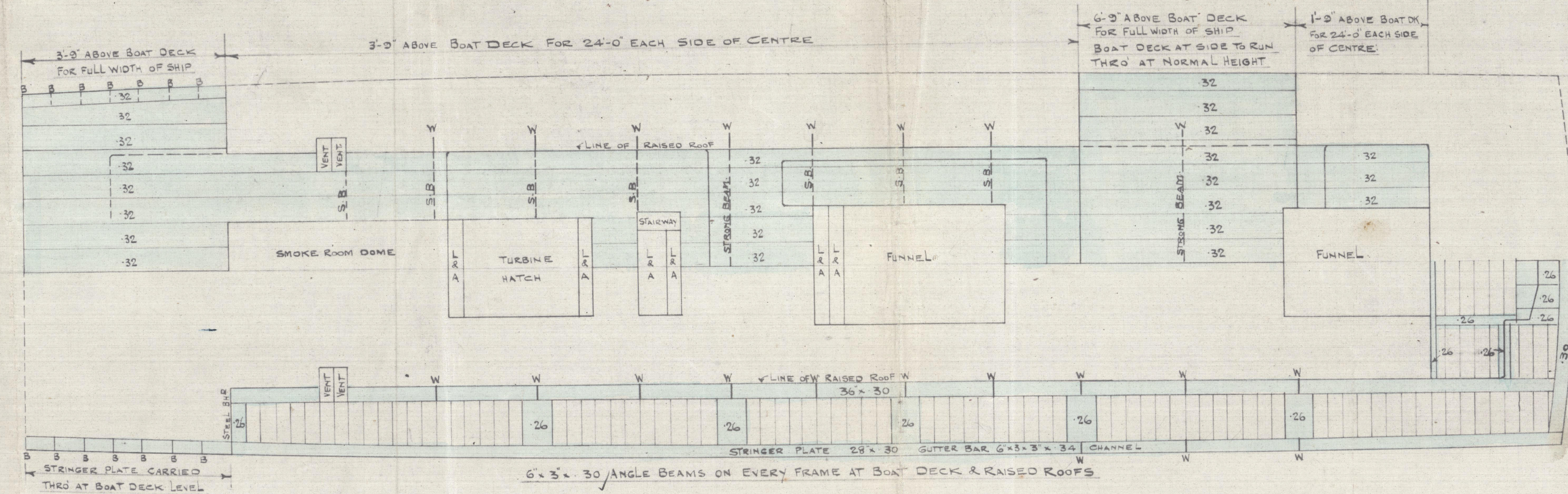

SECTION IN WAY OF RAISED ROOF AT AFT END OF BOAT DECK  
SCALE 1/4" = 1 FOOT.

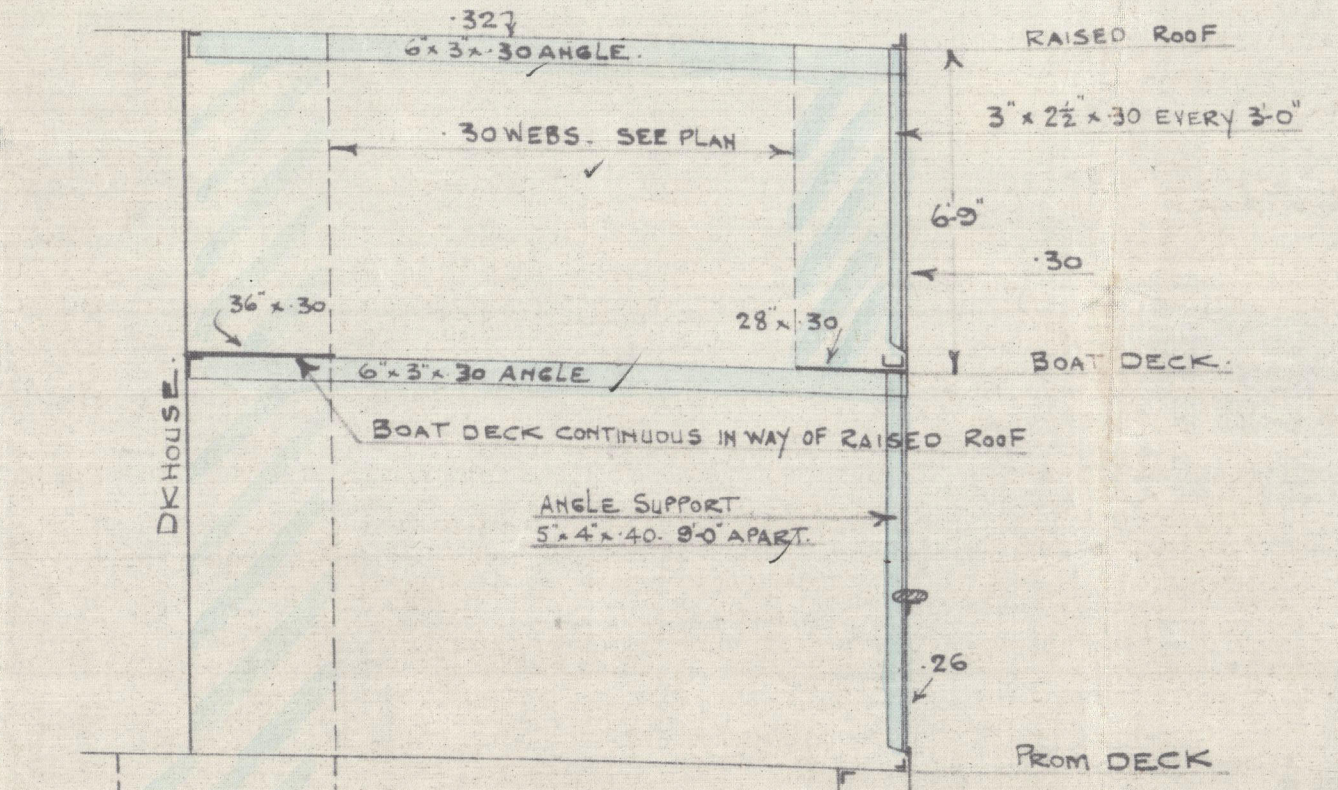

SECTION IN WAY OF RAISED ROOF AT FORE END OF BOAT DECK  
SCALE 1/4" = 1 FOOT.

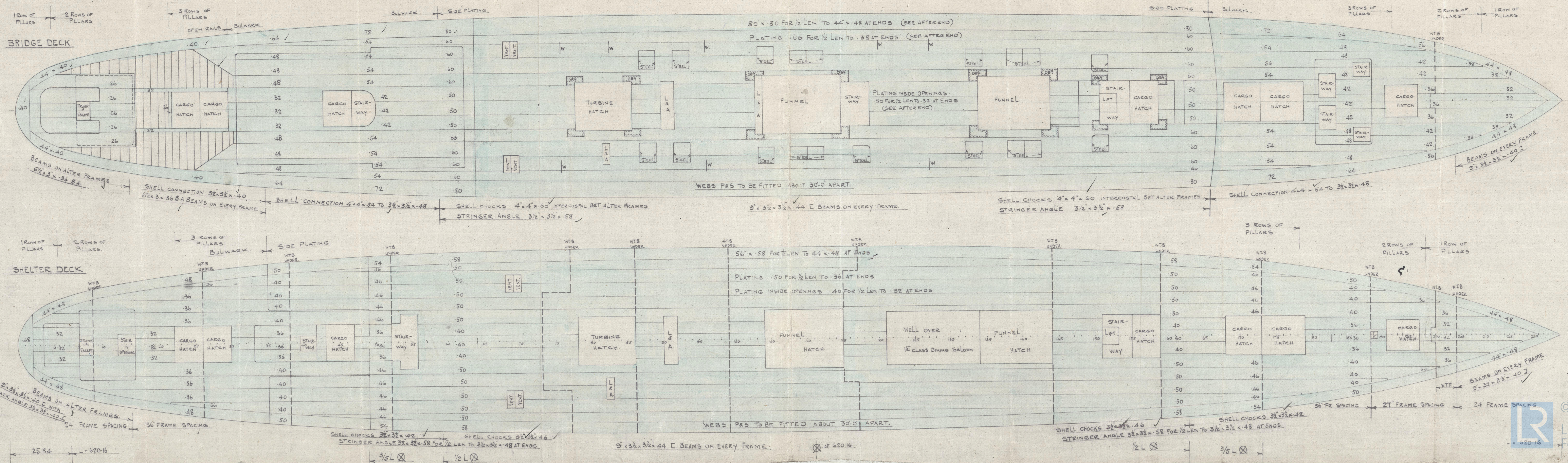

W166-0039



BUILDERS. *The Fairfield Ship & Eng Co*

YARD NO.S *528 & 529*

PLAN. *Deck*



SHIP'S NAME, .....

GLASGOW REPORT NO. ....



GLASGOW REPORT No. *41917*

*Noted*

*8/5 Empress of Canada*

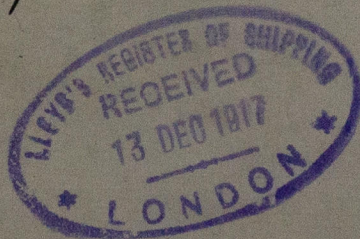

*W166-0039*



© 2020

Lloyd's Register  
Foundation