

TOP OF AFTER HOUSE

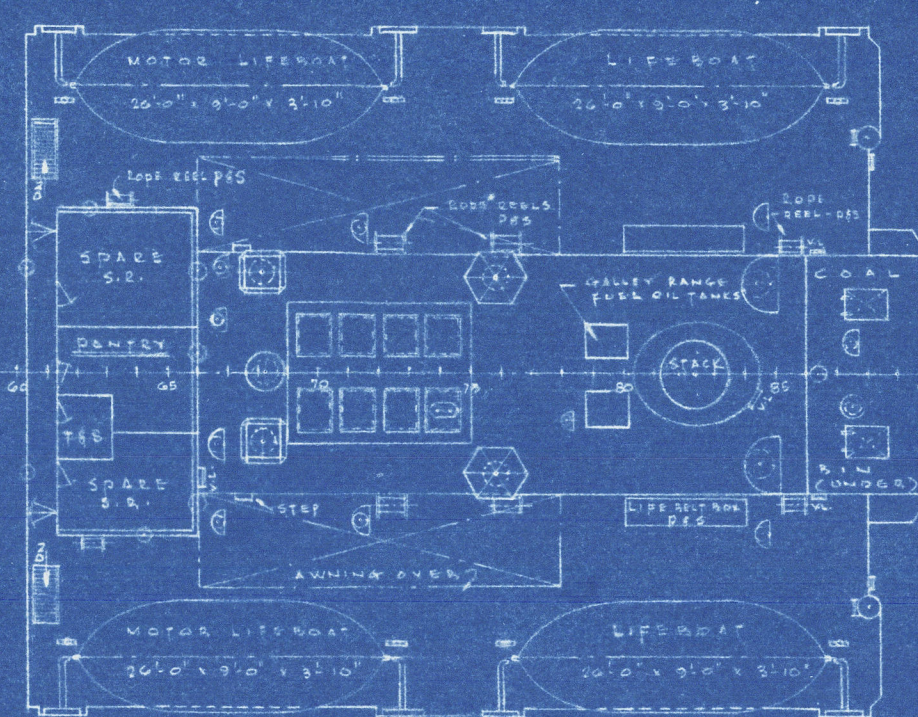

BOAT DECK

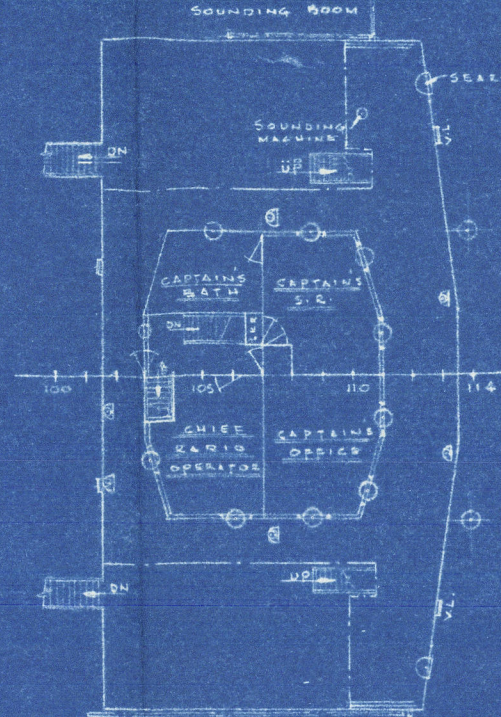

BRIDGE DECK

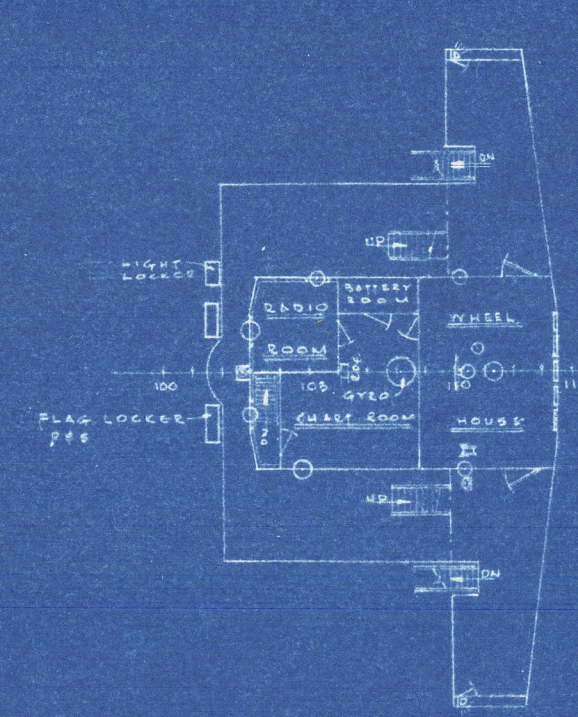

NAVIGATING BRIDGE DECK

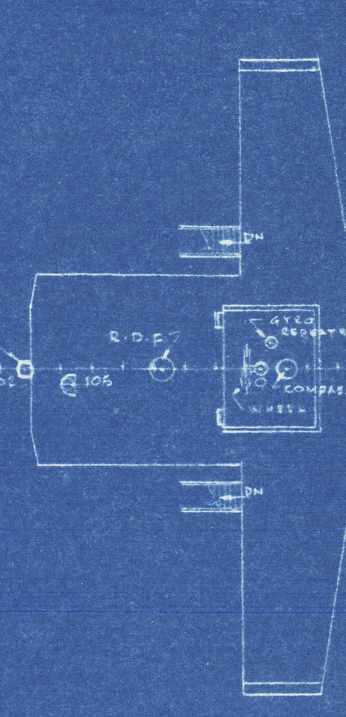

WHEELHOUSE TOP

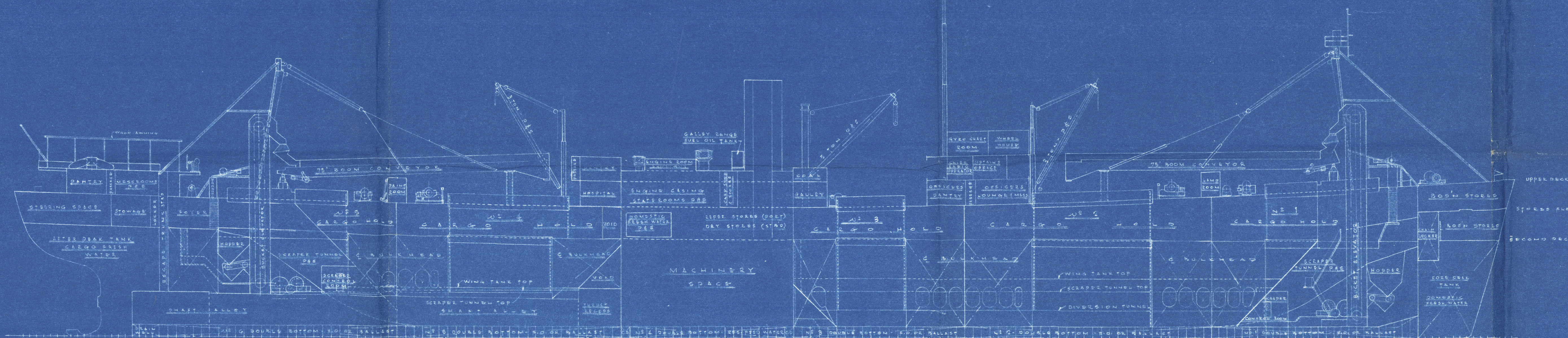

INBOARD PROFILE

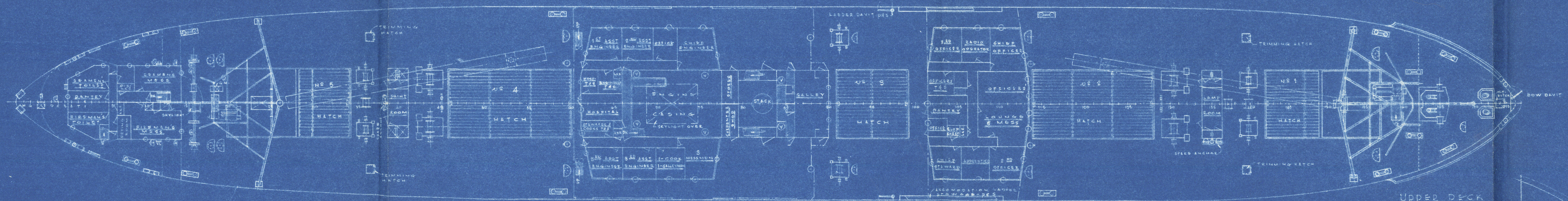

UPPER DECK

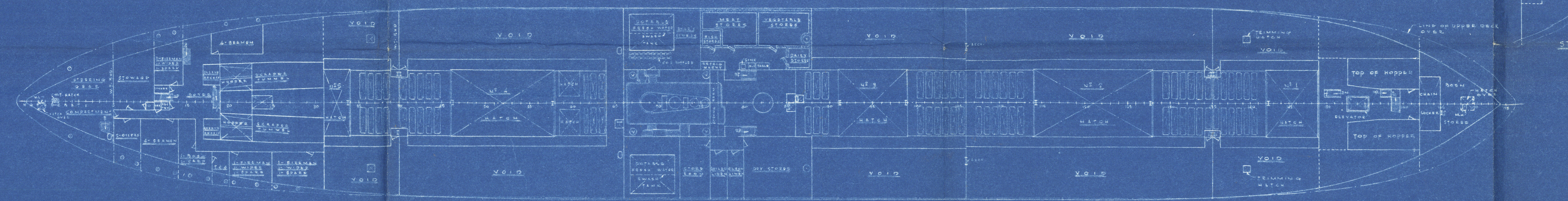

SECOND DECK

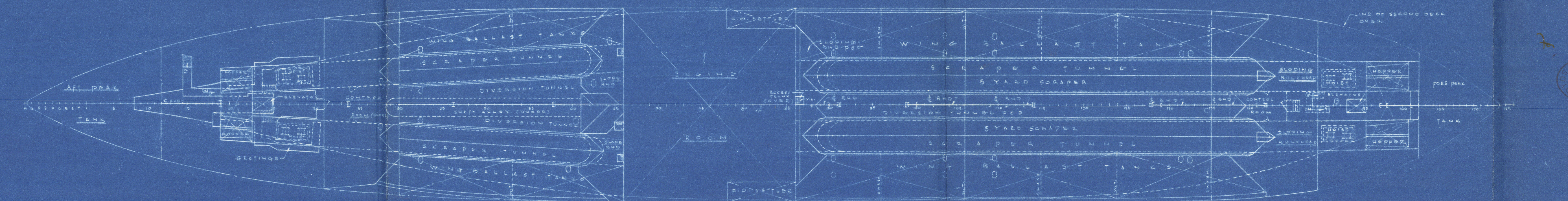

TANK TOP

ALTERATIONS

GENERAL NOTES

REFERENCE PLANS

PRINTS ISSUED

NO.	DATE	BY	REVISION
1			
2			
3			
4			
5			
6			
7			
8			
9			
10			

PLAN APPROVALS

OWNERS
USCG
ABE

MOORE DRY DOCK COMPANY
OAKLAND, CALIFORNIA
HULL DESIGN DEPARTMENT

HULL NO. 55 PHOPO - 5-F-APT. 90

GENERAL ARRANGEMENT

SCALE 1/8" = 1'-0"

DATE MARCH 13, 1950

DRAWN BY [Signature]

CHECKED BY [Signature]

APPROVED BY [Signature]

DRAWING NUMBER
207-12665

Information
189

Harry Lundeborg



"PHOTO"

General Angt.

S. 70.

9520.

RETAIN

RECORDS DEPT.
LONDON

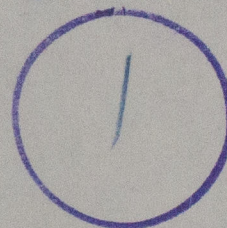

© 2021

Lloyd's Register
Foundation

W1648 70110