

16.8.12
7.11.12
19.11.12
24.12.12
4.3.13
6.5.13
24.11.13

S.S. N° 233.

MIDSHIP SECTION OF A TWIN SCREW OIL CARRYING VESSEL.

DIMENSIONS:- 344'-7" x 46'-0" MLD x 27'-7" MLD
To CLASS 100 A.I. AT LLOYDS.
SCALE 1/2" = 1 FOOT

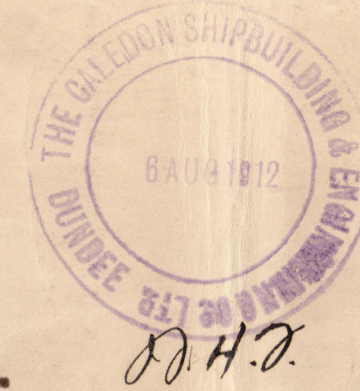

NUMERALS

TRANSVERSE NUMBER 46.04 + 27.58 = 73.62
LONGITUDINAL NUMBER 73.66 x 344.58 = 25381
d = 16.96
7/8 TO UPPER DECK = 12.49

EQUIPMENT

HULL 25381 2381
POOP 72'-0" x 7.5' x 7.5' 40.5 40.5
FORECASTLE 36'-7.5' x 7.5' 191
MIDSHIP HOUSE 34'-32'-6" x 7.5' x 50' 192
DECK HOUSES ON BRIDGE 39'-39' x 7.5' x 50' 107
ART. 42'-33' x 7.5' x 5' 225
NUMBER 2649 2436

1 BOWER ANCHOR STOCKLESS 48 3/4 CWTs + 10% OWNERS.
REQUIREMENTS = 53 3/4 CWTs.
1 BOWER ANCHOR 48 3/4 CWTs STOCKLESS ✓
1 (FOREMAN) 33 " EX STOCK (OWNERS REQUIREMENTS) ✓
1 STREAM ANCHOR 13 " EX STOCK ✓
1 KEDGE 5 1/2 " ✓
270 FATHOMS 2" STUD CHAIN CABLE ✓
90 FATHOMS OF 1/2" STEEL STREAM LINE ✓
120 " " 4" TON LINE ✓
2 @ 90 " " 7" MANILLA OR 2 1/2" STEEL WIRE WITH OWNERS CONSENT ✓
2 @ 90 " " " OR 2 1/2" " " FOR STEEL WIRE ✓

RIVETING

BUTTS OF PLAT KEEL PLATE TO BE OVERLAPPED & QUADRUPLE RIVETED (IN WAY OF OIL COMPARTMENTS) TO BE OVERLAPPED 1 1/2" AND QUINTUPLE RIVETED WITH 1 1/2" RIVETS.
BUTTS OF BOTTOM AND SIDE SHELL PLATING TO BE OVERLAPPED & TREBLE RIVETED ALL FORE & AFT. ✓ AND QUADRUPLE RIVETED FOR 1/2" WHERE OVER RULE WIDTH. ✓
SEAMS OF SHELL PLATING IN OIL COMPARTMENTS TO HAVE 7-1/2" RIVETS IN EACH ROW BETWEEN FRAMES. ✓
BUTTS OF SHEERSTRAKE TO BE OVERLAPPED & QUADRUPLE RIVETED FOR 1/2" TO TREBLE AT ENDS. ✓
UPPER DECK STRINGER PLATE TO BE OVERLAPPED & TREBLE RIVETED IN WAY OF OIL COMPARTMENTS & DOUBLE RIVETED AT ENDS. ✓
BUTTS OF TANK DECK STRINGER PLATE TO BE OVERLAPPED & TREBLE RIVETED TO DOUBLE RIVETED ✓
BUTTS OF UPPER & TANK DECK PLATING CLEAR OF OIL COMPARTMENTS TO BE OVERLAPPED & DOUBLE RIVETED FOR 1/2" TO SINGLE AT ENDS. ✓
BUTTS & SEAMS OF UPPER DECK PLATING, TANK DECK PLATING, EXPANSION TRUNK PLATING, PLATING OF TRANSVERSE & MIDDLE LINE BULKHEADS & CORRUGATED BULKHEADS (IN WAY OF OIL COMPARTMENTS) TO BE OVERLAPPED & DOUBLE RIVETED. ✓
BUTTS & SEAMS OF M.T. BULKHEADS AS PER RULE ✓
BUTTS OF VERTICAL KEEL PLATE & SIDE VERNON PLATING TO BE OVERLAPPED & TREBLE RIVETED ✓
RIVETS IN SEAMS OF OUTRIG PLATING TO BE SPACED 3/4" DIAMETERS APART ✓
RIVETS IN CORNER BARS OF OUTRIG WORK TO BE SPACED 4" DIAMETERS APART ✓
RIVETS CONNECTING BRACKET KNEES TO FLOORS, SIDE STRINGERS & BULKHEAD STIFFENERS TO BE SPACED 5 DIAS APART ✓
RIVETS ATTACHING BARS TO PLATING EXPOSED TO OIL PRESSURE TO BE SPACED 6 DIAS APART ✓ (FRAMES TO SHELL, STIFFENERS TO BULKHEADS &c)
RIVETS ATTACHING BARS TO PLATING NOT EXPOSED TO OIL PRESSURE TO BE SPACED 7 DIAS APART ✓ (FRAMES TO FLOORS & SIMILAR WORK) ✓

C.B.
16.8.12

SECTION AT WEB FRAMES.

SCALE 1/2" = 1 FOOT.

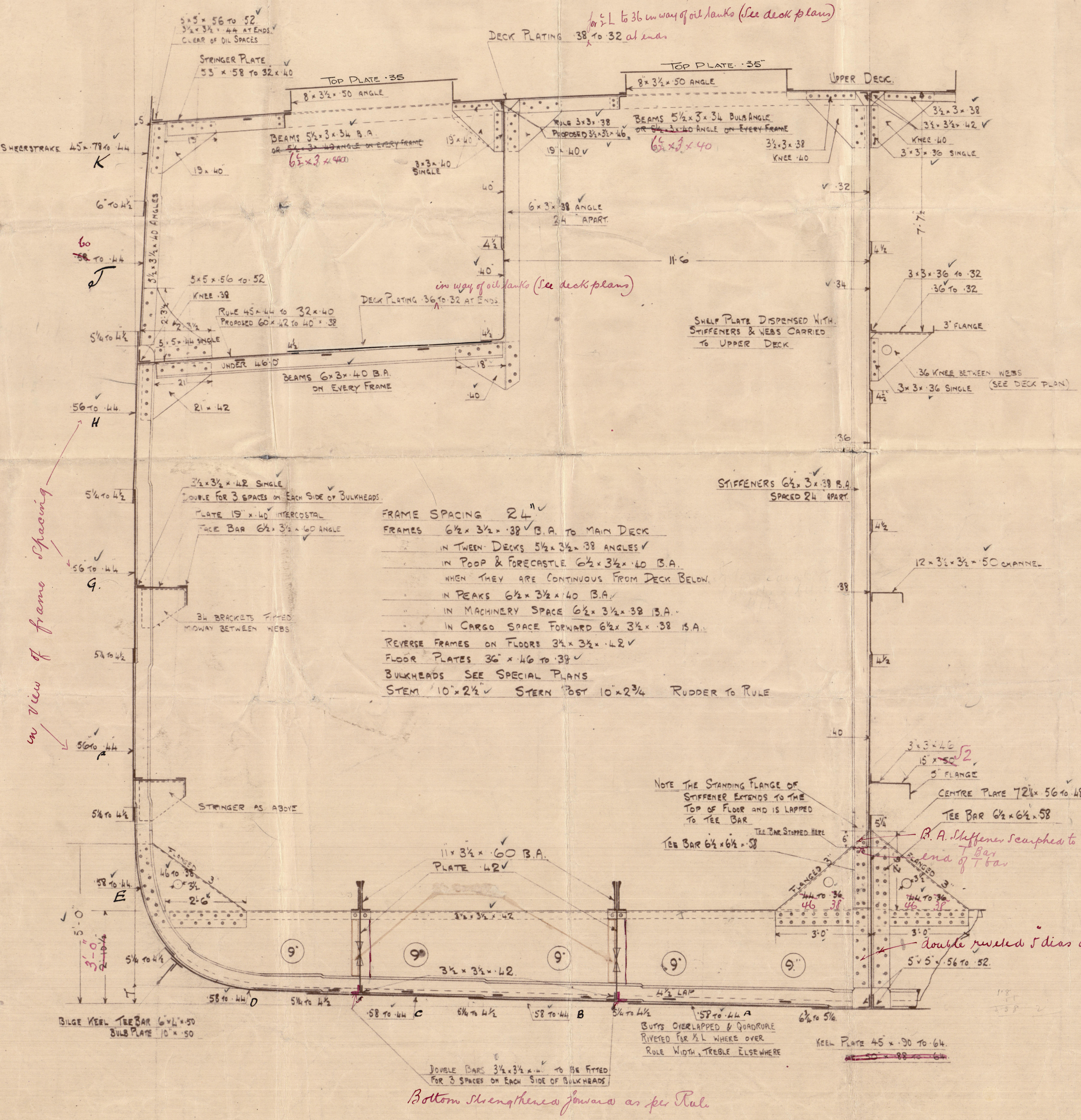
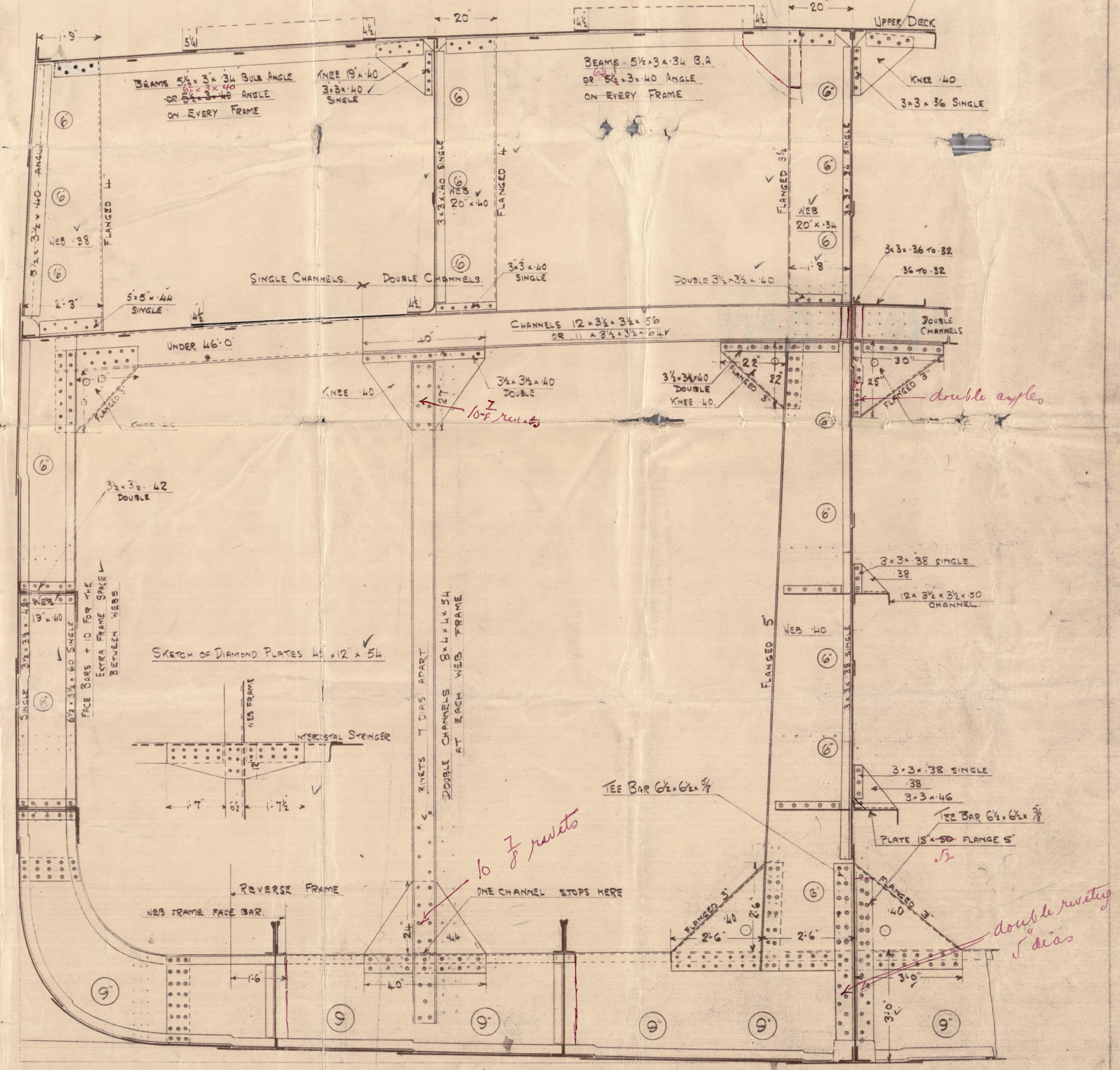

MIDSHIP SECTION
CALEDON S.B. & E.C. LTD

Nº 233 *faunus*

S.S. SELENE *Est*

DUN. RPE Nº 7818

LLOYD'S REGISTER OF SHIPPING
RECEIVED
1 MAY 1913
LONDON

LLOYD'S REGISTER OF SHIPPING
RECEIVED
24 OCT. 1913
LONDON

28 JUL 1912
LONDON

28 DEC. 1912
LONDON

LLOYD'S REGISTER OF SHIPPING
RECEIVED
25 FEB. 1913
LONDON

LLOYD'S REGISTER OF SHIPPING
RECEIVED
20 DEC. 1912
LONDON

LLOYD'S REGISTER OF SHIPPING
RECEIVED
16 NOV. 1912
LONDON

LLOYD'S REGISTER OF SHIPPING
RECEIVED
30 JUN. 1913
LONDON

FAUNUS

w1664-0122