

Stoomketels SS Deelsum

Schaal 1/50

Boilers SS Deelsum

18.7.98

Heating Surface in Square Feet

Main- and Staytubes	1134.5
Purnaces	70.4
Fire-bricks	48.5
Tubeplates	27.2
Backplates	45.9
Total per Boiler	1326.8
2 Boilers	2653.6

Nieuw. Oppervlak in vierkante Meters

Nieuw. en Stuurpijpen	105.4
Nuurgangen	6.57
Nuurnasten	4.5
Krijplaten	2.53
Achterplaten	4.27
Totaal per Ketel	123.27
in 2 Ketels	246.54

Scale 1/50

Nieuw. Oppervlak	32.872
Rooster Oppervlak	4.341
Doorticht Pijpen	

Stoomdruk	11-16 per atm
Roosteroppervlak	375 M ²

Heating Surface	32.872
Grate Area	4.341
Tube Area	

Steam pressure 160 lbs per sq. in.
Grate Area 40.36 sq. ft.



17 July 1898

Langinaad
Diam. Nagelgat 22.4
Nagels 23.81
 $3 \times 25.4 \times 0.7054 \times 175 \times 85 = 85.94$
 $104.15 \times 22.5 \times 100 = 23.81$
Stijpafte 23.81

Longitudinal Seam
Diam. of Rivets 1"
Rivets 1"
 $5 \times 1" \times 0.2834 \times 175 \times 85 = 85.94$
 $104.15 \times 22.5 \times 100 = 23.81$
Thickness of Rivet straps 75%

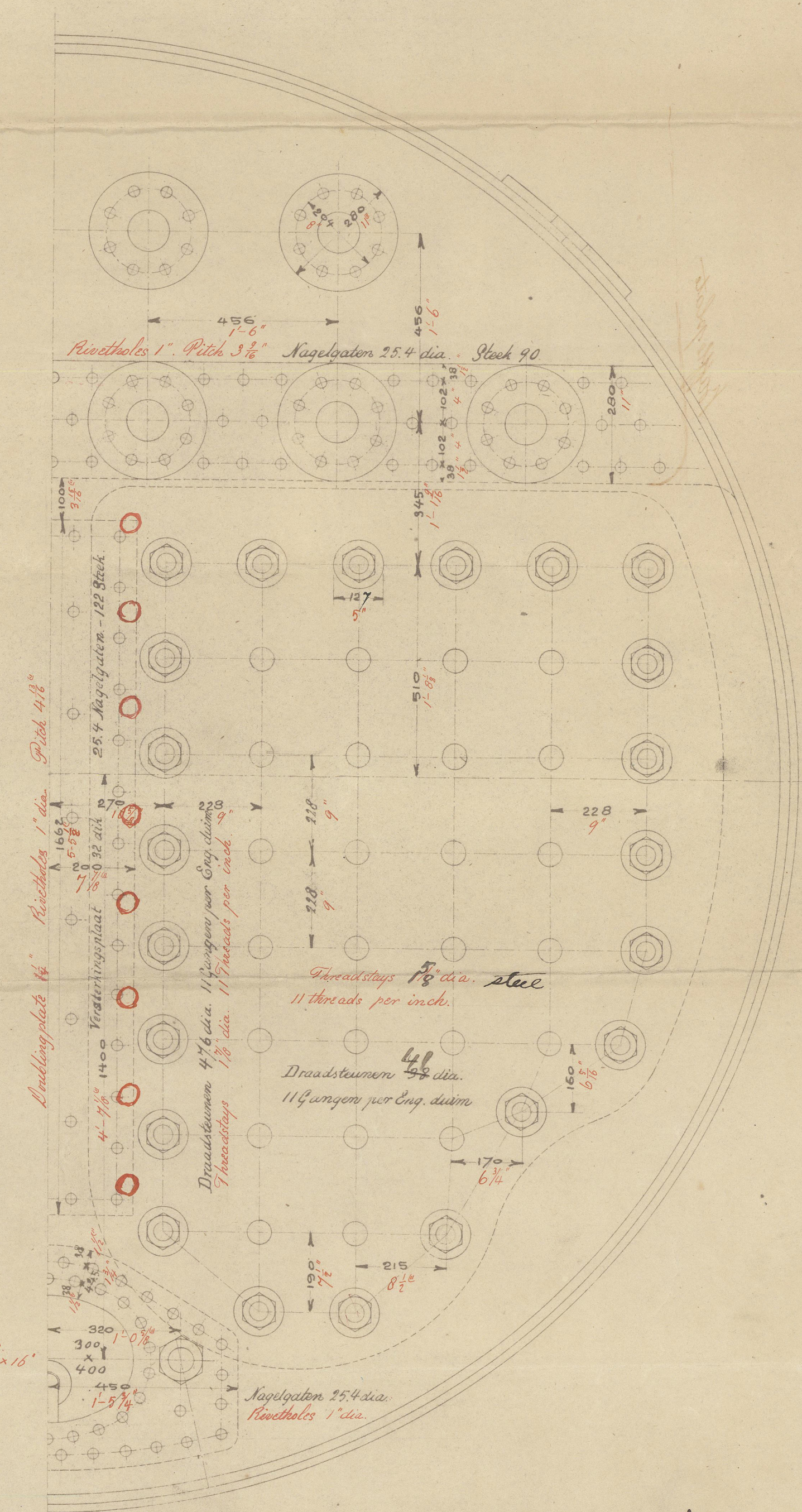
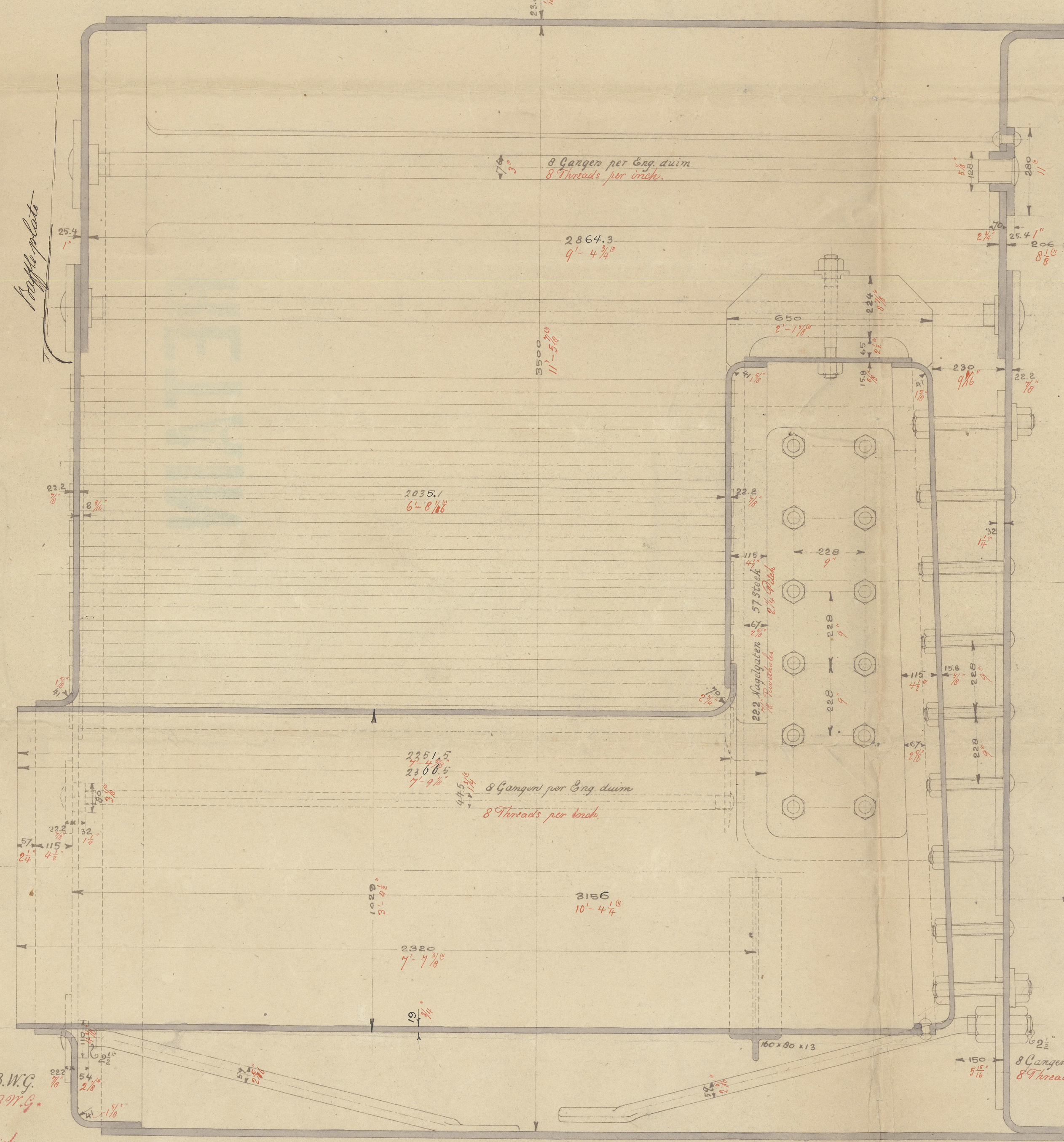
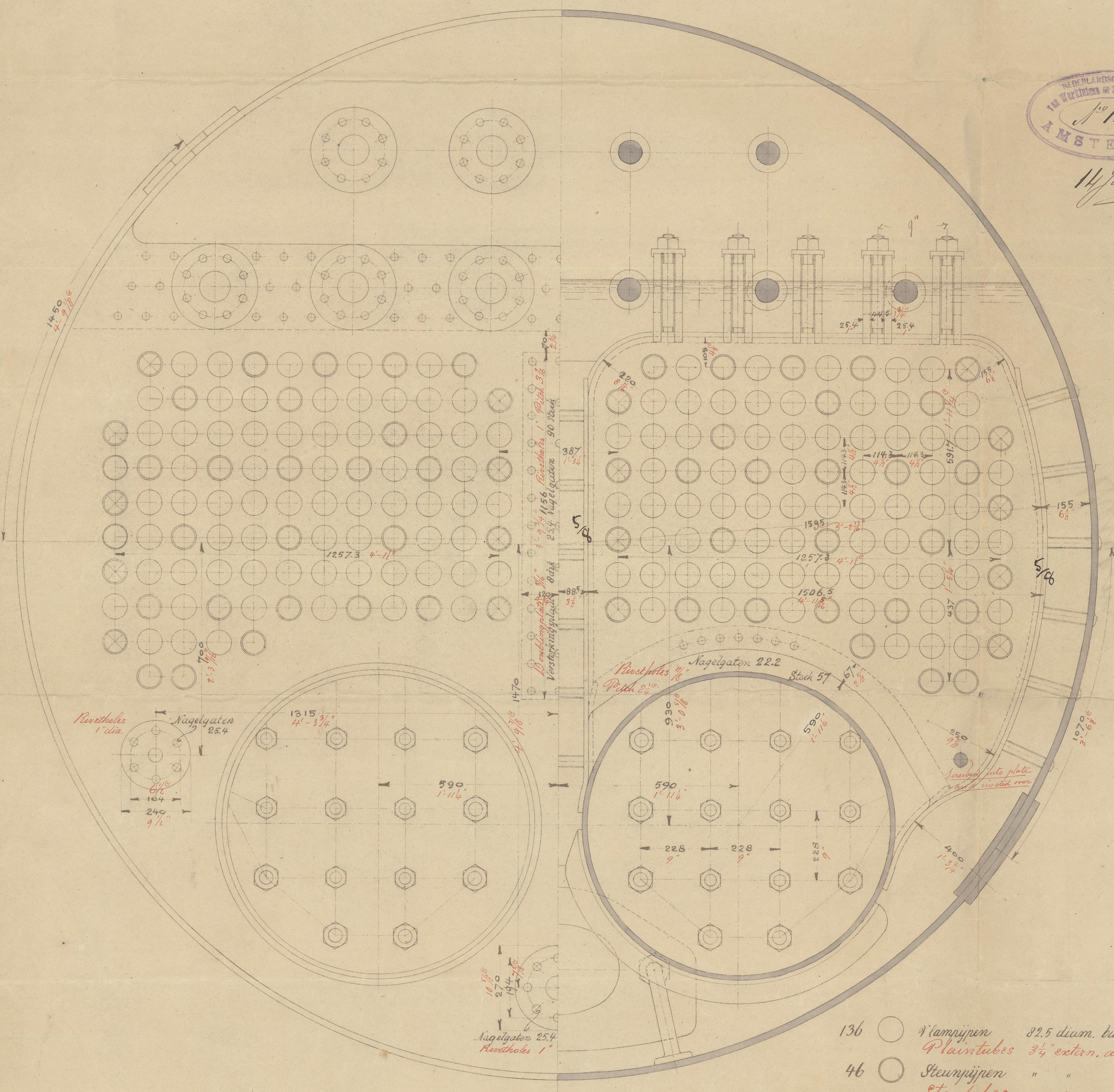

- 136 ○ Nuurnasten 22.5 diam. buitenw. N° 8 B.M.C.
- 46 ○ Stuurpijpen 3 1/2" exten. diam. N° 8 B.M.C.
- 18 ○ Staytubes " " 8 dik.
- " " " " 1/2" dik.
- " " " " 9.5 "
- " " " " 3 1/2 "
- " " " " 11 Gangen per Eng. duim.
- " " " " 11 Threads per inch.

18 July 1898

© 2020

Lloyd's Register Foundation

Bortles

of Helsam

Ans. 2094^e

RETAIN



© 2020

Lloyd's Register
Foundation

W1641-0149