

SHELL CONNECTION ANGLES IN DOUBLE BOTTOM COVERED WITH CEMENT.

KEEL PLATE BUTTS OVERLAPPED & QUADRUPLY RIVETED FOR $\frac{1}{2}$ L. TO TREBLE AT ENDS.
SHEERSTRAKE BUTTS OVERLAPPED & QUADRUPLY RIVETED FOR $\frac{1}{2}$ L. TO TREBLE AT ENDS.
STRAKE BELOW SHEERSTRAKE BUTTS OVERLAPPED & QUADRUPLY RIVETED FOR $\frac{1}{2}$ L. TO TREBLE AT ENDS.
REMAINDER OF SHELL PLATING BUTTS OVERLAPPED & TREBLE RIVETED THROUGHOUT.
CENTRE GIRDER BUTTS OVERLAPPED & TREBLE RIVETED THROUGHOUT.
TANK TOP CENTRE STRAKE BUTTS OVERLAPPED & TREBLE RIVETED FOR $\frac{1}{2}$ L. TO DOUBLE AT
ENDS WHERE NOT EXCEEDING '48'.
REMAINDER OF TANK TOP PLATING BUTTS OVERLAPPED & DOUBLE RIVETED FOR $\frac{1}{2}$ L. TO SINGLE AT ENDS
TREBLE RIVETED IN ENGINE ROOM.
MARGIN PLATE BUTTS OVERLAPPED & TREBLE RIVETED THROUGHOUT.
2ND DECK STRINGER PLATE BUTTS OVERLAPPED & DOUBLE RIVETED THROUGHOUT.
2ND DECK PLATING BUTTS OVERLAPPED & DOUBLE RIVETED FOR $\frac{1}{2}$ L. TO SINGLE AT ENDS.
UPPER DECK STRINGER PLATE BUTTS OVERLAPPED & TREBLE RIVETED FOR $\frac{1}{2}$ L. TO DOUBLE AT
ENDS WHERE NOT EXCEEDING '42'.
UPPER DECK PLATING BUTTS OVERLAPPED & DOUBLE RIVETED FOR $\frac{1}{2}$ L. TO SINGLE AT ENDS
WHERE NOT EXCEEDING '42'.
SHELL PLATING LANDINGS AS MARKED ON SECTION.
TANK TOP PLATING LANDINGS AS MARKED ON SECTION.
DECK PLATING & STRINGER LANDINGS SINGLE RIVETED THROUGHOUT.

EQUIPMENT NUMERAL :- 2ND LONGITUDINAL NUMBER = 35976
ADD :- E. & B. CASING $65 \times 7.5 \times .50$ = 244
SALOON HOUSE $21.5 \times 7.5 \times .50$ = 81
36301

- | | | | | |
|-----|----------------|---|--------------------------------|-------|
| 2 | BOWER | ANCHORS (STOCKLESS) EACH | 63 ³ / ₄ | CWTS. |
| 1 | " | ANCHOR | 54 ¹ / ₂ | " |
| 1 | STREAM | " (EX. STOCK) | 17 ¹ / ₂ | " |
| 1 | KEDGE | " | 10 | " |
| 270 | FATHOMS | 2 ¹ / ₂ " STUD CHAIN CABLE. | | |
| 120 | " | 4 ¹ / ₂ " DIA. STREAM WIRE. | | |
| 120 | " | 5" STEEL WIRE TOWLINE. | | |
| 2 | AT 120 FATHOMS | 3 ¹ / ₂ " STEEL WIRE HAWKERS. | | |
| 2 | " 120 " | 3" " " " | | |
| 2 | " 30 " | 3" FLEXIBLE STEEL WIRE ROPE. | | |
| 2 | " 30 " | 8" MANILA HAWKERS. | | |
| 4 | " 90 " | 7" WARPS. | | |

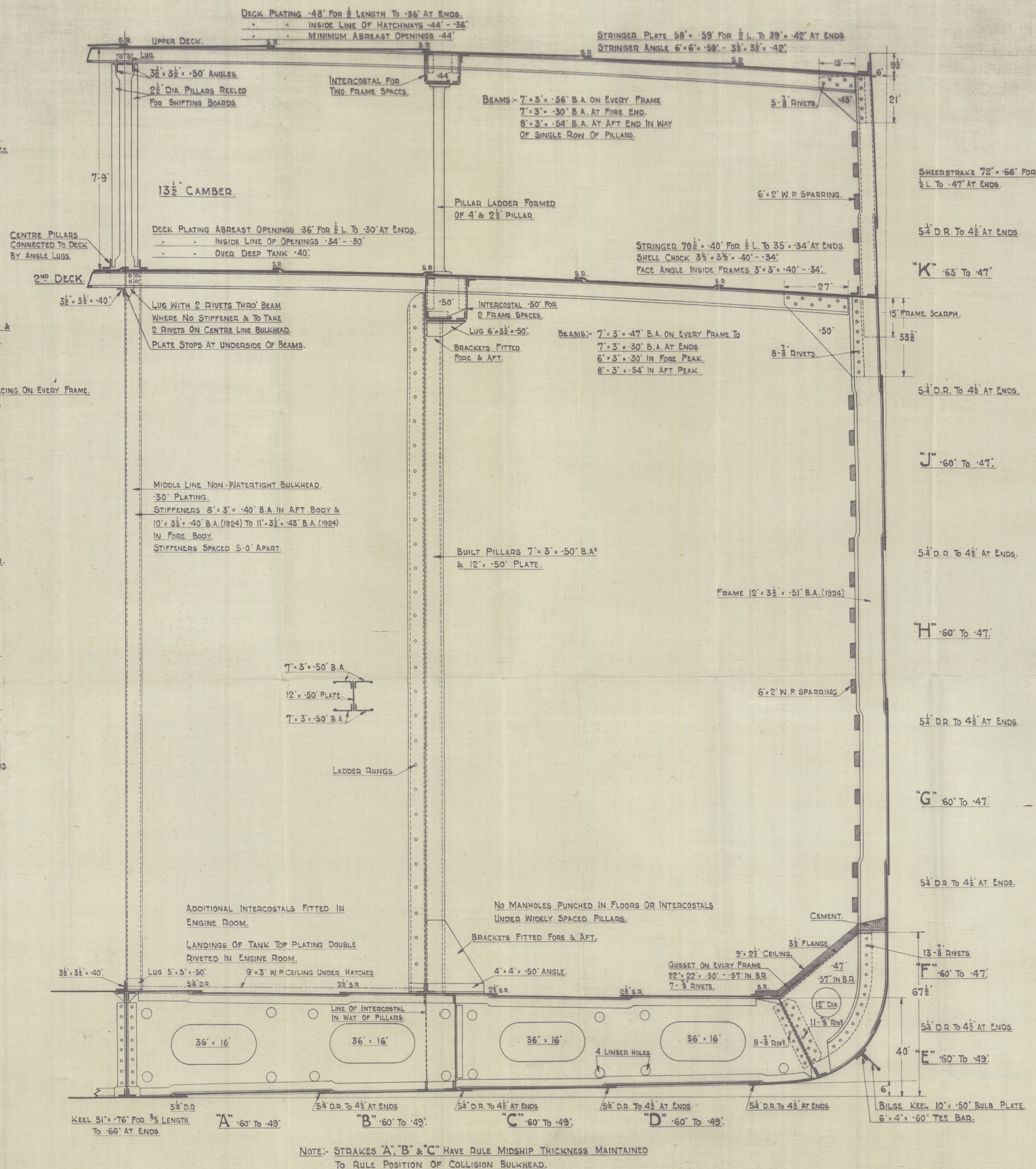

SECTION THRO' BRACKET FLOOR.

MIDSHIP SECTION. OF SHIP
AS BUILT.

SCOTT'S. S. B & E CO'S. No 545.

S.S. 'DALCROY'

GRK. RPT. No. 19161.

X1162-0219



© 2021

Lloyd's Register
Foundation