

4.10.15

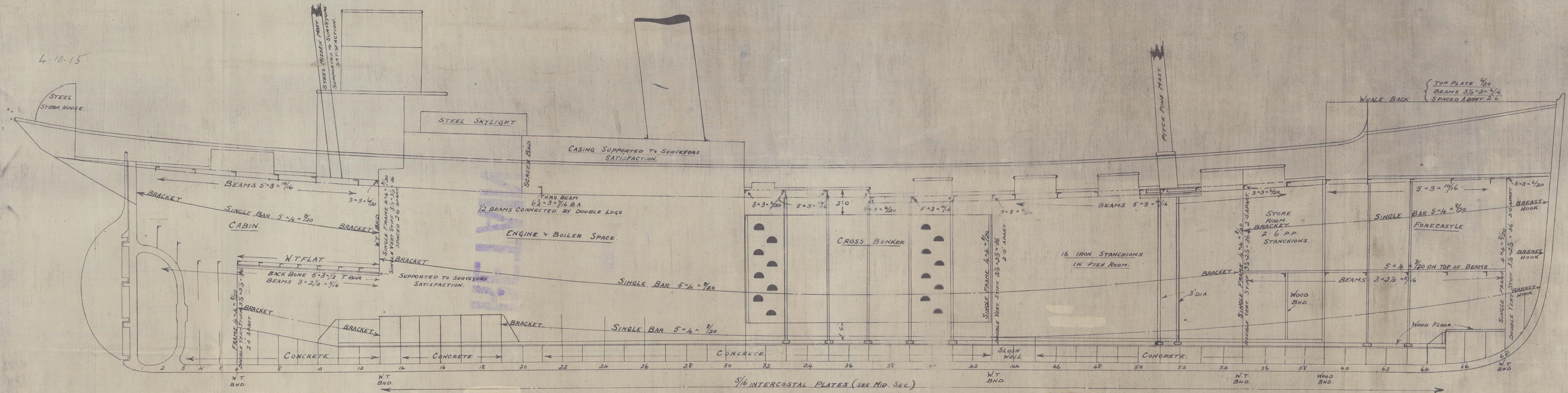

BEAM ARRANGEMENT.

5/16 INTERCOSTAL PLATES (SEE MID. SEC.)
PILLARING TO SURVEYORS SATISFACTION

SCALE 1/4" = 1 FOOT.

SUBMITTED TO LLOYDS
APPROVED BY LLOYDS

N^o 372

COOK, WELTON & GEMMELL LTD
SHIPBUILDERS
BEVERLEY.

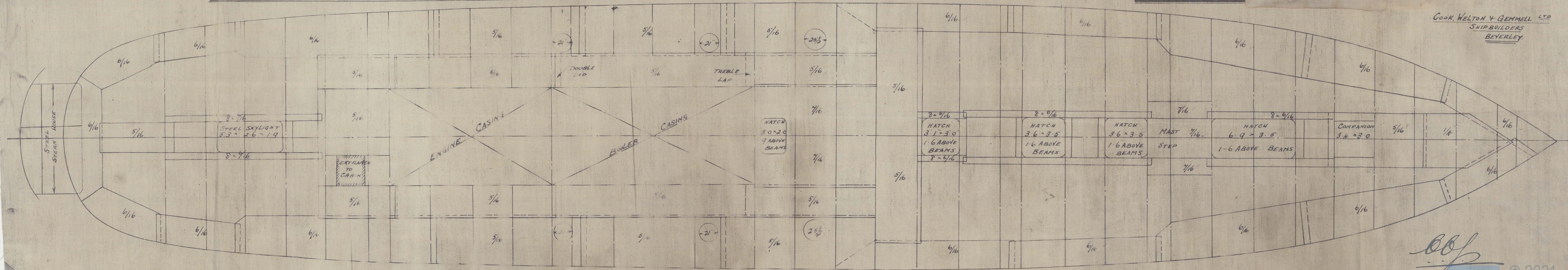

4.10.15

Nº 372

PROFILE + DECK.

COOK WELTON + GEMMELL

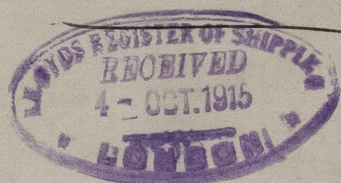

"S. S. Raymond" Hull Rpt No. 29461.

RETAIN

W1572-0028



© 2021

Lloyd's Register
Foundation