

**Nº 147.**

## SECTION IN WAY OF N° 2 HOLD

SCALE  $\frac{1}{2}$  INCH TO ONE FOOT.

6.8.02

卷之四

卷一百一十七

五ノ二

2/2 *Myrica*

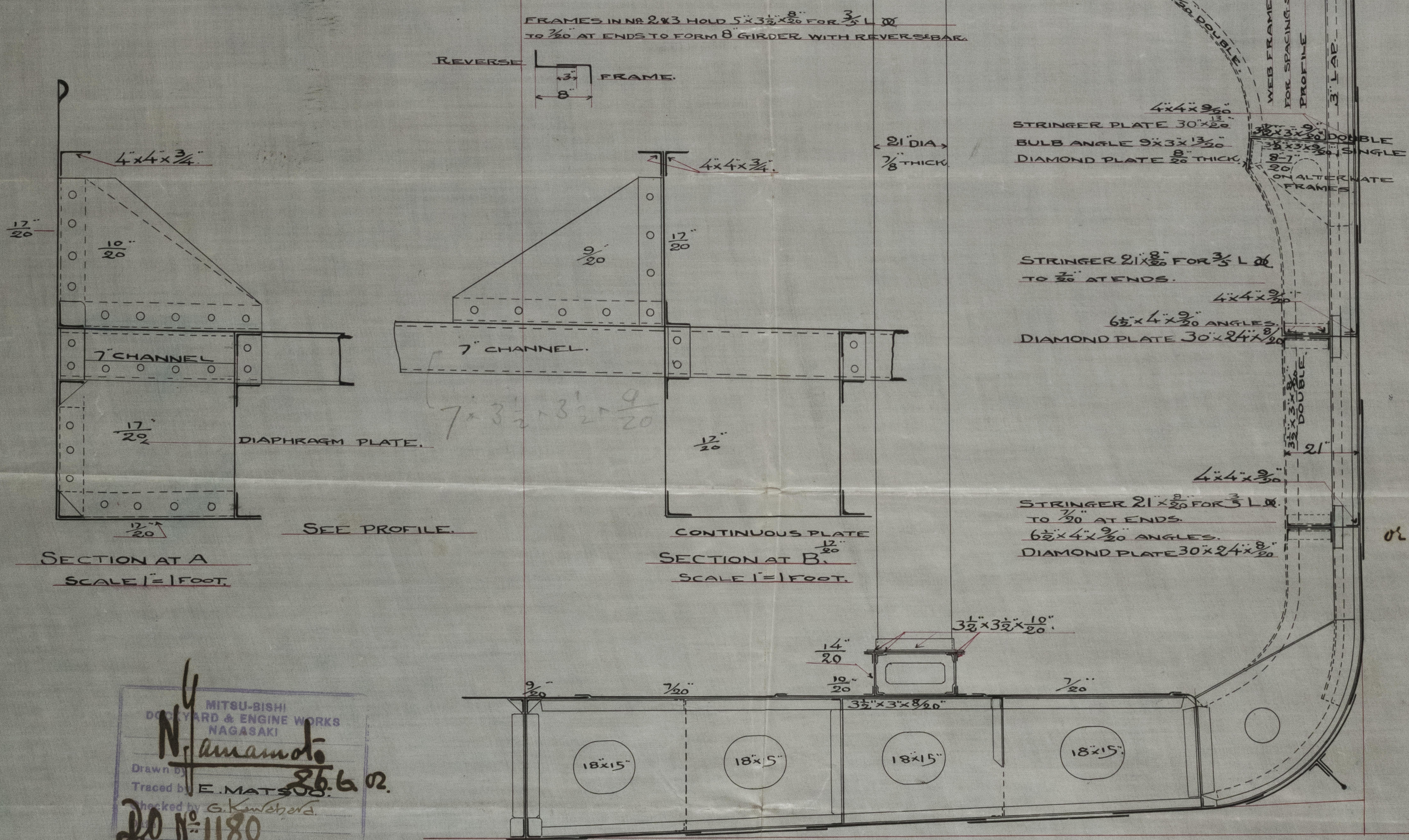

4  
N. amamoto.  
MITSU-BISHI  
DOCK YARD & ENGINE WORKS  
NAGASAKI  
Drawn by 856  
Traced by E. MATSUO  
checked by G. Kawabara.  
D.O. N. 1180  
Y. Sugitani.

J. P. L.  
6/8/02



Milka Bisho

No 147

Hold Section

S/S "Nigala Maru"

6.8.05

Nag 278

RETAIN

SECTION IN M/V

SECTION IN M/V

No 147

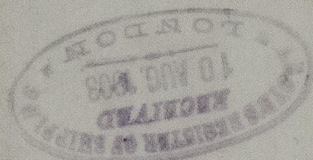

From A. BROWN, McFARLANE & CO., Ltd.,  
34 West George Street, GLASGOW.  
FOR ENCLOSURE TO  
Messrs. [illegible]  
[illegible]  
[illegible]

© 2021

Register  
Foundation

2310-8451M