

DIM 125'-0" x 22'-0" x 12'-6"

31.3.06

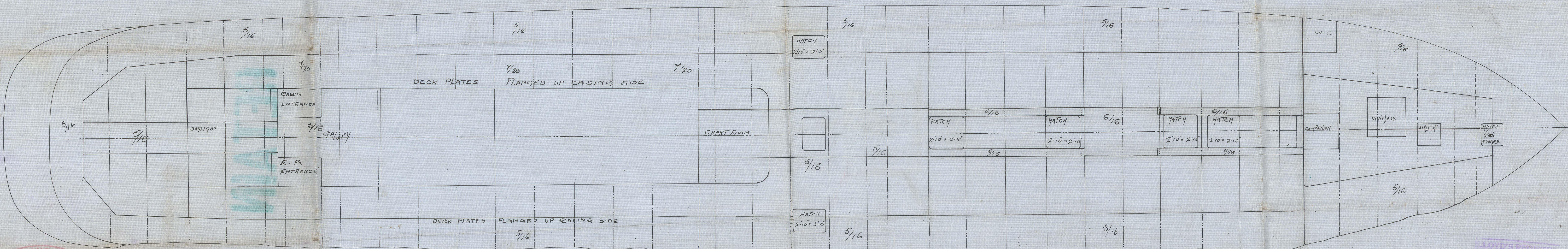
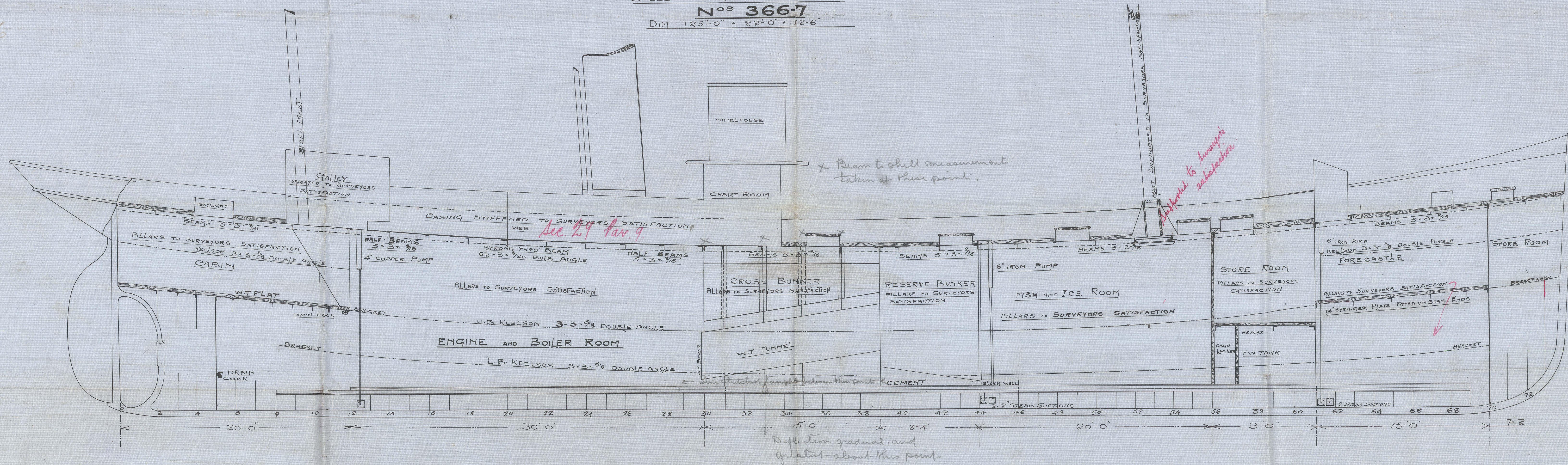

OOHRAHE & SONS
IRON AND STEEL
5/73 26.3.06
SHIPBUILDERS
8 ELBY.

C.R.
31.3.04

Cochrane & Sons.

N^o. 366 & 367.

Profile & Deck Plan

of Libera

Hull Report No. 18285

of Ormonde.

Hull Report No. 18435



© 2021

Lloyd's Register
Foundation

W1486-0113