

16.8.15.

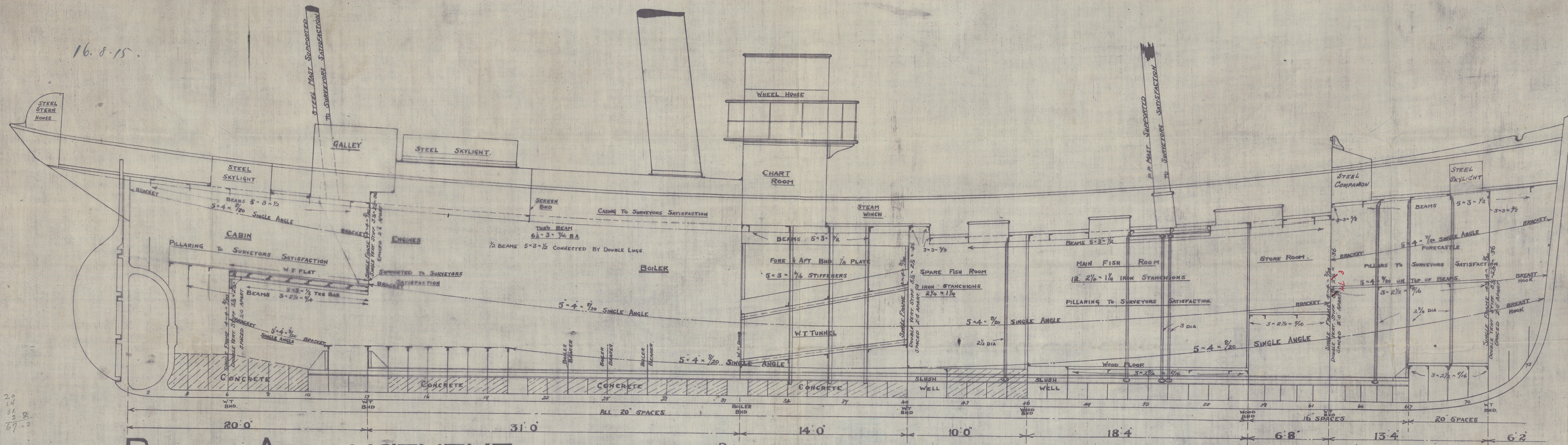

BEAM ARRANGEMENT

SCALE 1/4" = 1 FOOT

SUBMITTED TO LLOYDS 1915
APPROVED BY " 1915

Nº 351-2-3-4-5&6

COOK, WELTON & GEMMELL LTD
SHIPBUILDERS
BEVERLEY

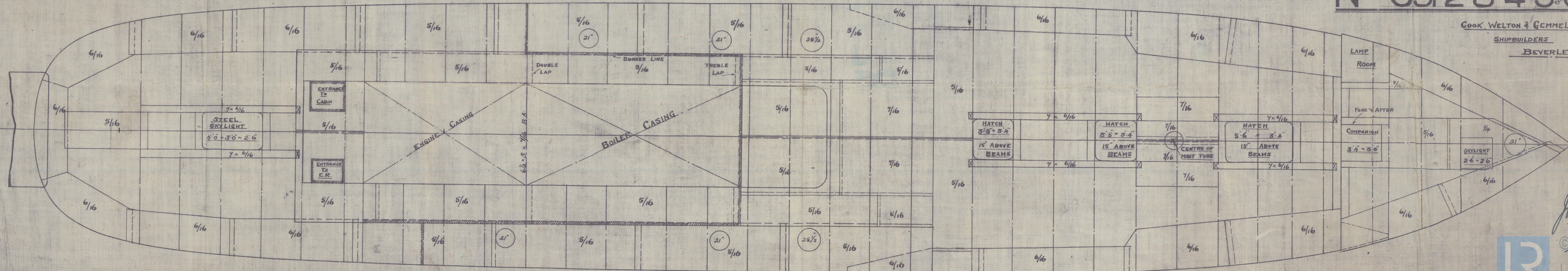

16.8.15.
© 2022

N^{os} 351- 2- 3. 4. 5 + 6

PROFILE & DECK

COOK WELTON & GEMMELL



DJ97



$\frac{1}{5}$ - Lusacan	Hull No 29833
$\frac{1}{5}$ - Simpson	29867
$\frac{1}{5}$ - Deluetia	29910
$\frac{3}{5}$ - Olympia	30103
$\frac{3}{5}$ - Oswaldcan	30,191
$\frac{3}{5}$ - Mitres	30,227



Lloyd's Register
Foundation

W1335 0058