

PILLAR AT SIDE										REMARKS
POSITION	L	B	H	N _Q	ℓ	SIZE	FACE BAR			
14	8.8	23.5	50	15.5	6.5	5	23.0	7 × 3/4 × 3/4	46	U/L ATTACHMENT AT BOTTOM
53	25.0	10.0	17.0	5	22	55.7	18.0	11 × 3/4 × 3/4	11	
80	7.5	25.0	17.0	4	5	26.3	18.5	4 × 3/4 × 3/4	9 × 3/4	
120	23.0	6.75	14.5	15.0	5	21.8	19.0	4 × 3/4 × 3/4	9 × 3/4	

HATCH END BEAMS BETWEEN HATCH SIDE COAMINGS.							REMARKS
POSITION	L	b	B	H	WEB PLATE	FACE BAR	
14	8.8	17.0	21.0	6.5	12 x 44	8 FLANGE	14 UNDER WHICH DECK
53	7.5	10.5	21.0	22	12 x 44	4 FLANGE	
120	6.7	15.5	21.0	5	12 x 44	7 FLANGE	
80	7.5	10.5	21.0	4	12 x 44	6 FLANGE	
23					4 1/2"	4 x 32 x 44 L	
33					"	10 x 32 x 48 L	"
45					"	"	"
105					"	4 x 32 x 44 L	"

DECK GIRDERS									
POSITION	S	B	H	N _Q	SIZE			REMARKS	
					WEB	FACE BAR	FLG.		
7-14 (2)	17.5	16.0	6.5	(115) 500	12" x 40	5/8" x 3/4" x 3/4"	16 x 56	9 FLG.	HATCH COAMING
14-33 (2)	47.5	16.0	5						
23-38	AS PER PLAN								
33-53 (2)	50.0	17.0	5		14" x 56	10 FLG.			HATCH COAMING
53-61 (2)	20.0	11.6	22	1021	16" x 44	11" x 3/4" x 3/4"			
53-59 (2)	15.0	10.5	22	(115) 750	16" x 44	4" x 3/4" x 3/4"			
74-80 (2)	15.0	10.5	4	(115) 163	12" x 40	6 FLG.			HATCH COAMING
33-105 (2)	50.0	17.0	5		16" x 56	10 FLG.			
45-105	AS PER PLAN								
100-120 (2)	46.3	15.5	5		16" x 56	8 FLG. ^{21"}			HATCH COAMING
120-126 (2)	13.5	13.7	5	(115) 158	12" x 40	5" x 3/4" x 3/4"			
74-30 (2)	15.0	11.8	4	106	16" x 42	4" x 3/4" x 3/4"			

M.S. KONSAN MARU. CONSTRUCTION PROFILE, DECKS & INNER BOTTOM PLAN.

SCALE 1/8" = 1'-0"

HATCH END BEAMS AT FR. NO. 28, 38, 45, 105

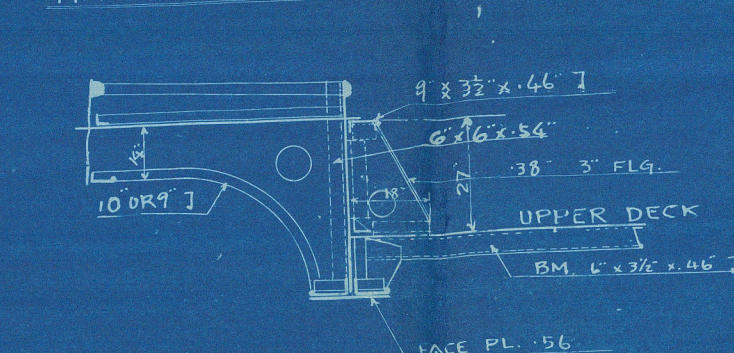

HALF BEAM CONNECTION IN WAY OF WINCH DECK AT ALT. FRAME

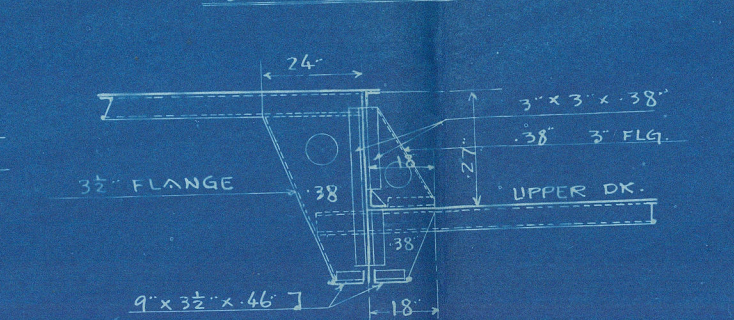

UPPER DECK GIRDER AT HATCH SIDE (BKT ALT. FR.)

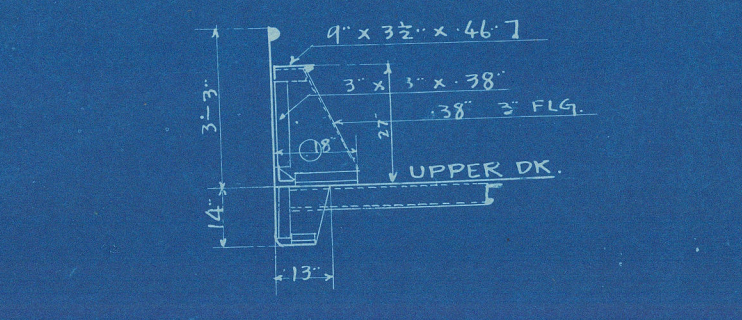

PLAN OF HATCH CORNER IN WAY OF WINCH DECK

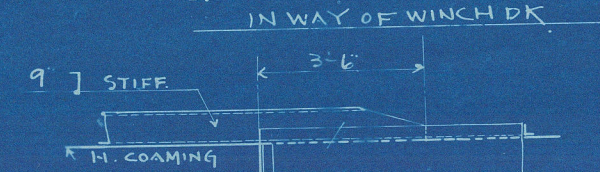

CENTRE GIRDER AT WINCH DECK

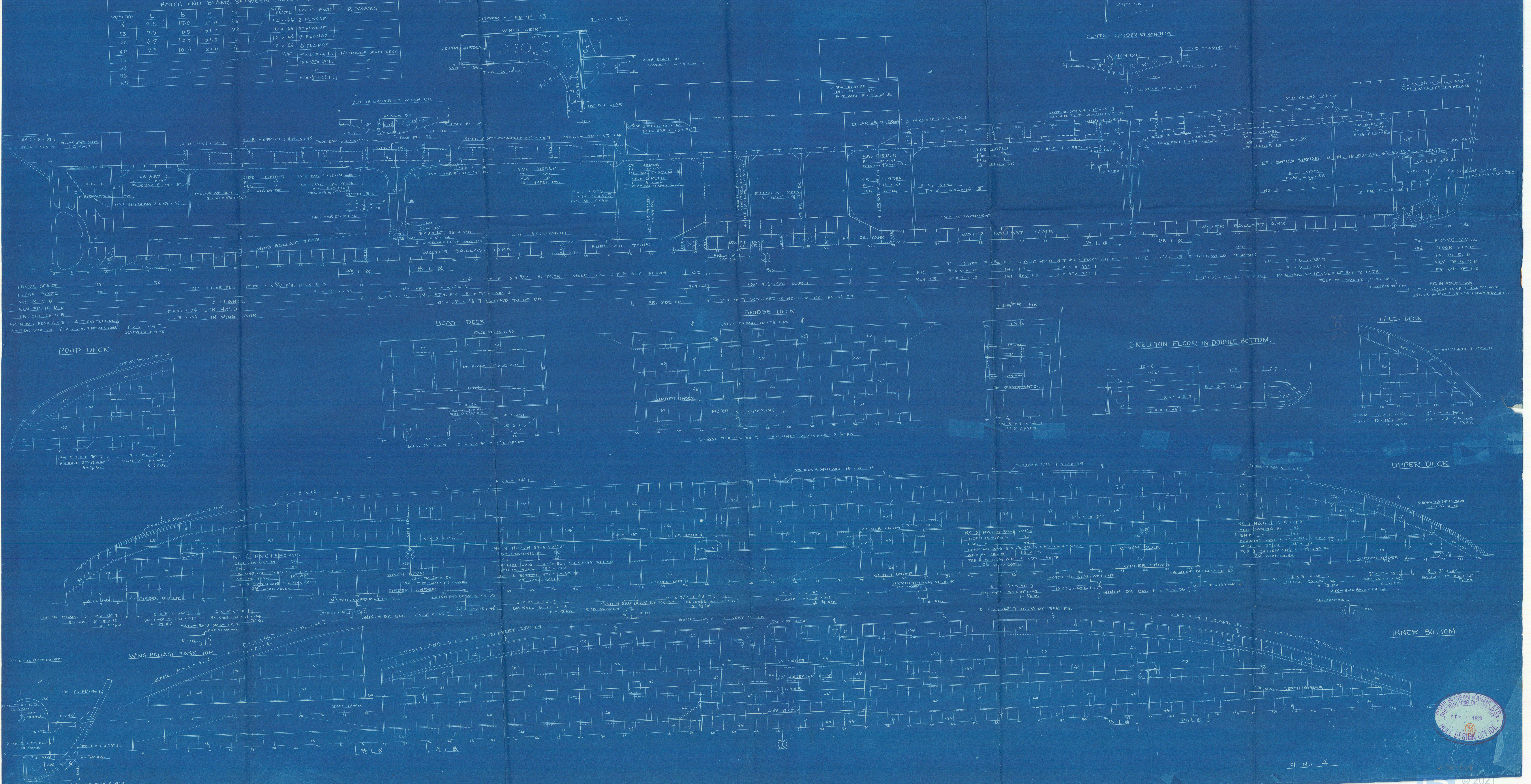
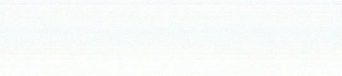
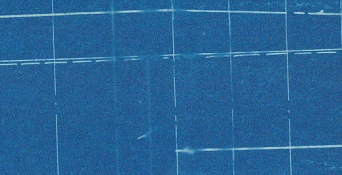
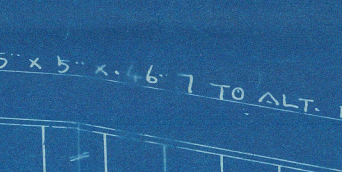
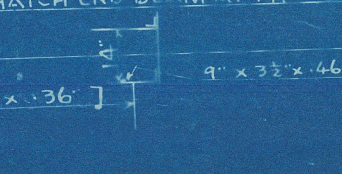
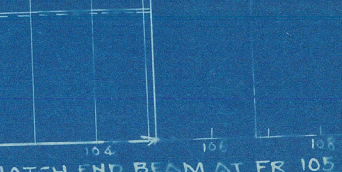
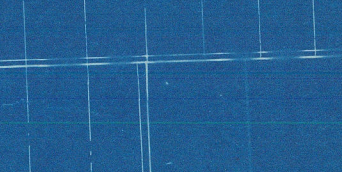
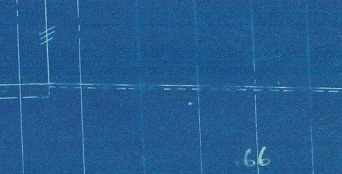
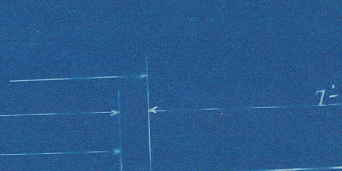
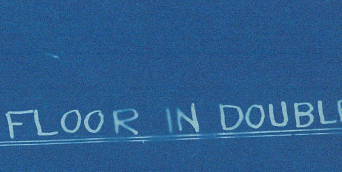
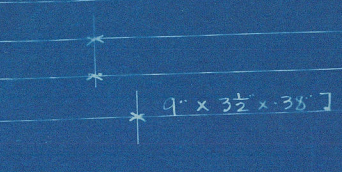
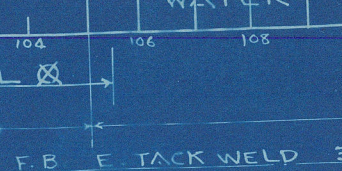
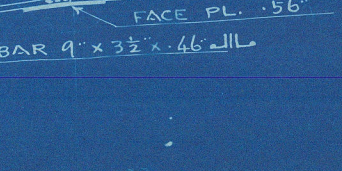
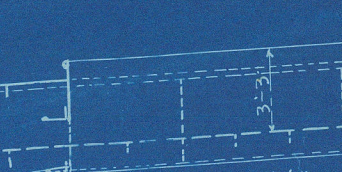
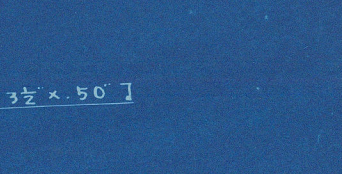
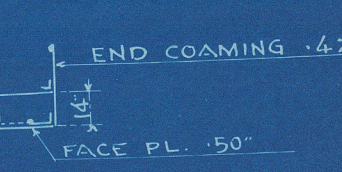

Construction Profile

m/v "Konsan Maru"



London Office

© 2021

Lloyd's Register
Foundation

W1310 0218