

SCALE $\frac{1}{8}$ TO ONE FOOT.

SKETCH SHOWING DECK GIRDER
IN WAY OF CARGO HATCH.

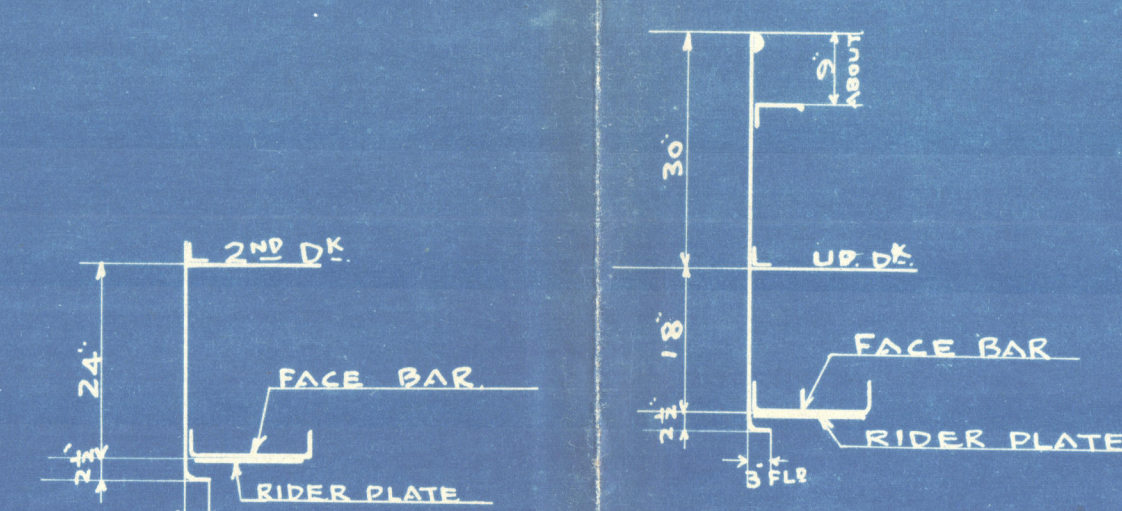

— PANTING STRINGER —
IN FORE PEAK — IN HOLD — 1ST PANTING STRINGER.

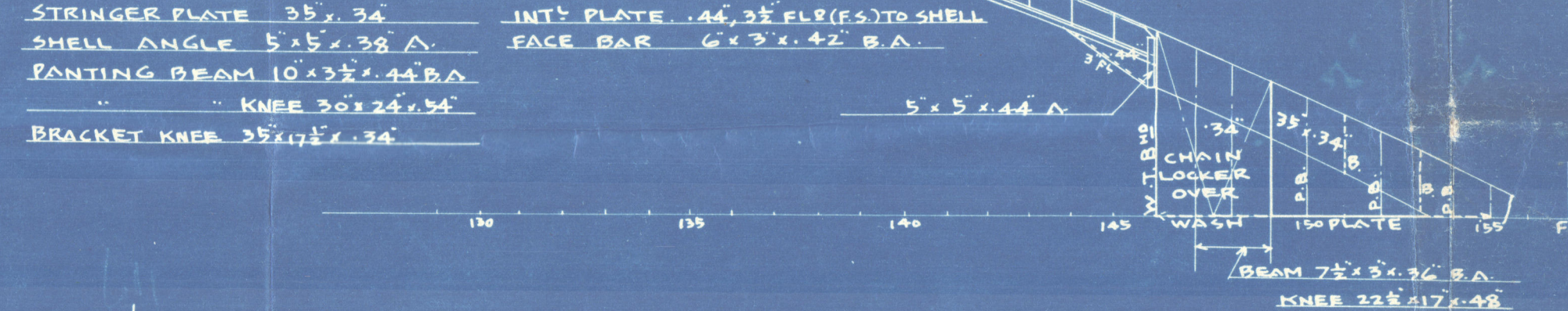

(SEE "MIDSHIP SECTION")

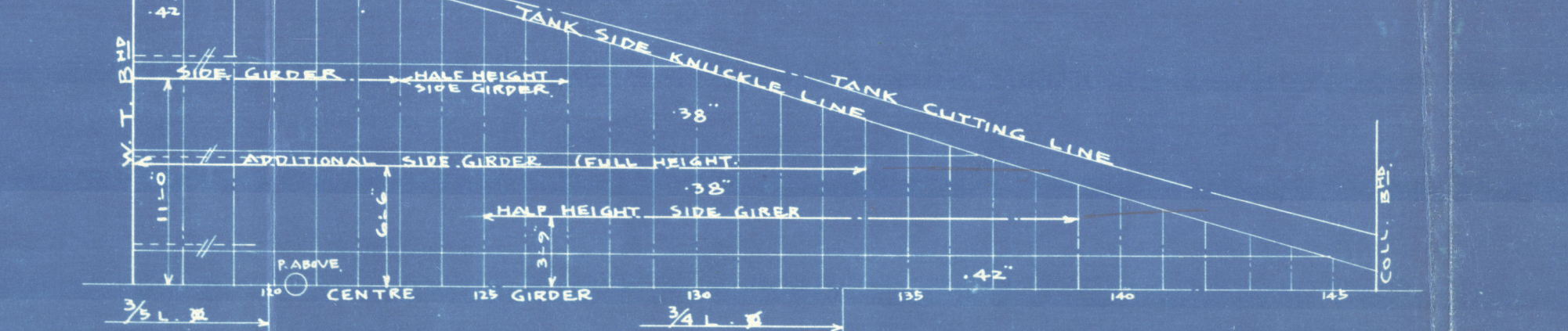

CARGO HATCH											
HATCH NO.	SWL	SH OF HATCH	DECK	WBS TOP PLATE BEARING	WEB BEARING PLATE	TRANSVERSE SHEAR PLATE	CARRIER ANGLE	GOVING ANGLE	GOVING MIN. STIFF ANGLE	REMARK	
N#1	12136	33°5'20"00"	UP DR	1	193-38	4°35'44"	30°	50°44'	3°35'44"	73°55'40"	SIDEWATER
	12137	33°5'20"00"	UP DR	1	193-38	4°35'44"	30°	50°44'	3°35'44"	73°55'40"	SIDEWATER
N#2	12118	33°5'20"00"	UP DR	1	193-38	4°35'44"	30°	50°44'	3°35'44"	73°55'40"	SIDEWATER
	19513	33°5'20"00"	2 ND DR	6	193-38	4°35'44"	30°	50°44'	3°35'44"	73°55'40"	SIDEWATER
N#3	8432	22°0'20"00"	BR. DR	3	193-38	4°35'44"	30°	44°44'	3°35'44"	73°55'40"	SIDEWATER
	8433	24°5'20"00"	UP DR	4	123-36	4°35'44"	30°	50°44'	3°35'44"	73°55'40"	SIDEWATER
N#4	12133	33°5'20"00"	UP DR	4	193-38	4°35'44"	30°	50°44'	3°35'44"	73°55'40"	SIDEWATER
	12135	33°5'20"00"	UP DR	4	193-38	4°35'44"	30°	46°44'	3°35'44"	73°55'40"	SIDEWATER
N#5	3830	33°0'20"00"	UP DR	5	193-38	4°35'44"	30°	46°44'	3°35'44"	73°55'40"	SIDEWATER
	3845	33°0'20"00"	2 ND DR	4	213-38	4°35'44"	30°	50°44'	3°35'44"	73°55'40"	SIDEWATER
N#6	2133	33°5'20"00"	UP DR	5	193-38	4°35'44"	30°	46°44'	3°35'44"	73°55'40"	SIDEWATER
	2133	33°5'20"00"	UP DR	5	193-38	4°35'44"	30°	46°44'	3°35'44"	73°55'40"	SIDEWATER
N#7	912	85°3'12"00"	PS*	1	100-30	10°00'00"	18°	44°44'	3°35'44"	3°35'44"	

WIDELY SPACED PILLAR GIRDERS.

[illegible]

WIDELY SPACED PILLARS.					
CENTRE	FRAME				LENGTH THRU LANE

SR	SIZE	NUMBER	S	B	H	D	FLANK	OR	CHANNEL	P
HOLD										
SIDE	21	28.88	16.5	15.9	76	20.5	16	5.8		
SP	66	18.18	15.5	15.7	13.6	18.0	8	3.5	2.5	1.5
SP	72	15.12	12.5	12.7	13.1	16.5				
SP	70	20.00	16.25	9.0	14.5	17.0	2.5	1.5	1.5	1.5
CENTRE	84	23.28	4.50	5.5	10.7	13.5				
SIDE	136	28.15	15.8	16.1	72	23.8	16	5.6		
CENTRE	112	26.00	14.00	14.00	24.00	17	17.58			
SP	121	29.28	23.00	14.00		18	16	5.8		
UPPER DE --- BRIDGE DE										
CENTRE	84		.40	15.2			6	4.40		
SIDE 14-15										
2" DE --- UPPER DE										
SIDE	12	17.88	16.00	11.50	33	7.5	9	4.40		
CENTRE	51	23.88	16.75	5.00	27.5	7.5	8	4.40		
SIDE	55	13.75	10.45	6.2	23.1	7.5	7.42			
SIDE	66	15.13	14.50	8.00	13	8.0				
SIDE	72	15.13	16.00	8.00	13	8.0				
CENTRE	84	22.00	34.77	11.50	33.75	11	11	5.2		
SIDE	136	28.15	16.0	71.0	39	7.5				
SP	121	27.25	22.50	20.00	19.5	8.0	23.5	10.40	1.5	
SIDE 14-15										
CENTRE	118	28.75	29.50	5.00	27.00	7.5	9	4.40		
CENTRE	121	29.75	29.50	5.00	24.00	7.5	9	4.40		

HATCH END BEAM & STRONG BEAM.

FRAME NUMBER	L	✓	B	H	7/16" DEEP	DEPTH	THICK	FACE	BAR	REMARKS
					BRIDGE		DECK			
84	27.0	18.13	26.25	4.0	425	12	40	113.33'-60.8A		HATCH BEAM BEAM
91	27.0	18.13	26.25	4.0	456	12	40	113.33'-60.8A		BEAM BEAM
					LIPPER		DECK			
33	35.0	18.40	26.50	5.0	775	18	46	10.33'-50.8A		9.58' HATCH PLATE
38	30.0	18.50	26.00	5.0	775	18	46	10.33'-50.8A		9.58'
50	35.0	18.54	27.17	5.0	698	18	46	11.33'-56.8A		
52	37.5	18.54	27.17	5.0	155	18	46	4.0'-44.4A		
55	35.25	"	"	"	155	18	46	4.0'-44.4A		
84	24.75	18.54	27.17	7.5	926	18	46	10.33'-50.8A		9.58' HATCH PLATE
91	24.75	18.54	27.17	7.5	1005	18	46	10.33'-50.8A		9.58'
92	35.50	18.54	27.17	7.5	1005	18	46	10.33'-50.8A		9.58'
113	35.0	18.50	26.25	5.0	870	18	46	10.33'-50.8A		
121	37.75	18.40	26.25	5.0	707	18	46	11.33'-56.8A		
					HATCH END BEAM		DECK			
								34.56'-47.8A	23 FLR	
								DECK		
33	35.0	18.30	26.50	9.0	1360	30	10	10.33'-50.8A		9.58' HATCH PLATE
38	34.50	18.55	27.20	9.0	1580	24	30	11.33'-62.08A		10.6'-60"
84	27.0	18.75	27.50	9.0	1450	24	30	10.33'-50.8A		9.80'
94	27.50	18.75	27.50	9.0	1310	24	30	10.33'-50.8A		9.64'
99	35.5	18.75	27.50	9.0	1690	24	30	11.33'-62.08A		10.70'
113	36.5	18.40	27.10	9.0	1550	24	30	11.33'-62.08A		10.60'
121	37.75	18.00	25.50	9.0	1200	24	30	11.33'-62.08A		9.46'
					HATCH END BEAM		DECK			
								48.28'-60.8A	23 FLR	

M.S. "SHUNTEN-MARU."
CONSTRUCTION PROFILE
& DECK PLAN (FINISHED PLAN)

SCALE $\frac{1}{8}"$ - 1 FT

G STE
ECK
HAT

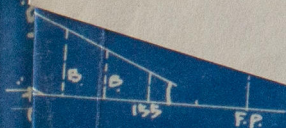

TRINGER.

RETAIN

© 2020

W 1247-0216

Lloyd's Register
Foundation